

TIE POINT
POL 1501+09.99

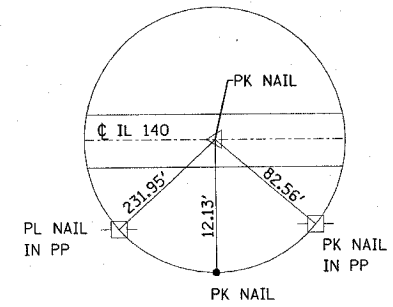

TIE POINT
POL 1524+62.25

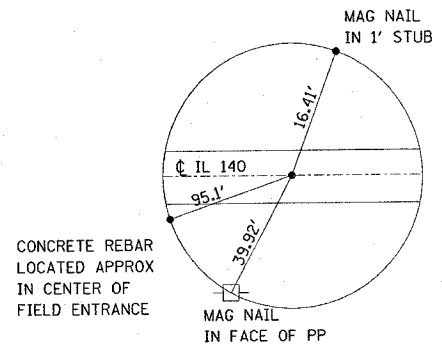

TIE POINT
PC STA. 1536+00.00

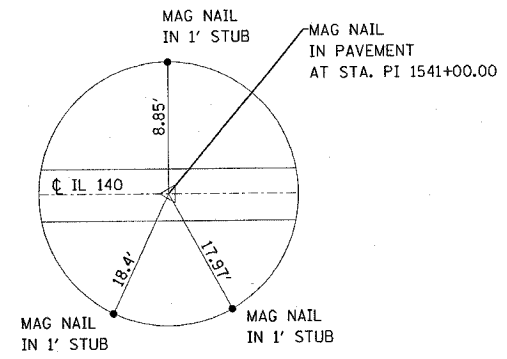

TIE POINT
PI STA. 1541+00.00

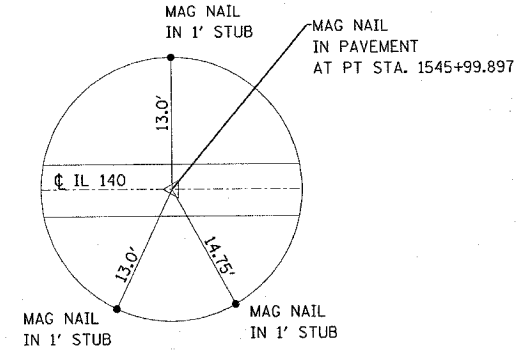

TIE POINT
PT STA. 1545+99.897

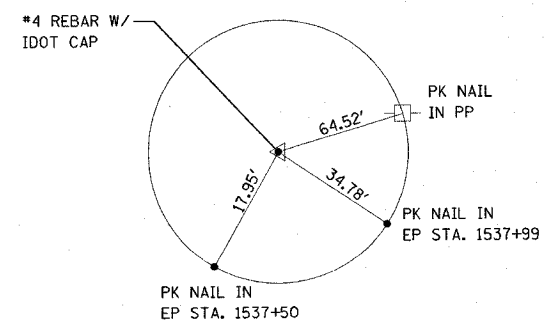

CONTROL POINT #4

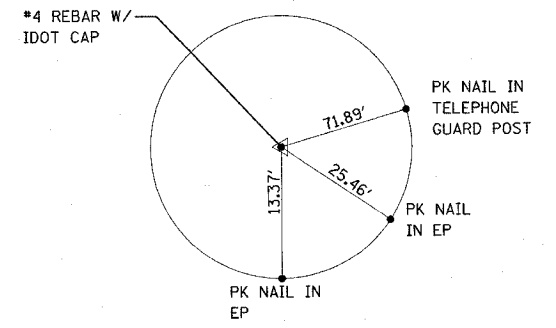

CONTROL POINT #3

PLOT DATE = 4/2/2007
FILE NAME = c:\projects\76279\plan\pin623.dgn
PLOT SCALE = 28.8000 / IN.
USER NAME = csmartin

REVISIONS	
NAME	DATE

ILLINOIS DEPARTMENT OF TRANSPORTATION
**ALIGNMENT, TIE POINTS,
AND BENCHMARKS**
FAP ROUTE 785
SECTION 137BR
BOND COUNTY