

| F.A. RTE.                 | SECTION | COUNTY        | TOTAL SHEETS     | SHEET NO. |
|---------------------------|---------|---------------|------------------|-----------|
| *                         | 120R-1  | ST. CLAIR     | 74               | 14        |
| STA. _____                |         | TO STA. _____ |                  |           |
| FED. ROAD DIST. NO. _____ |         | ILLINOIS      | FED. AID PROJECT |           |
| * FAP 592/FAU 9251        |         |               |                  |           |

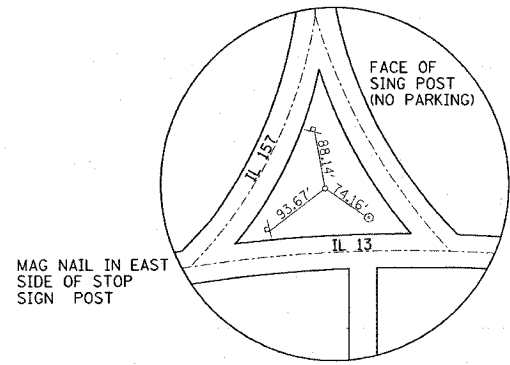

PIN W/CAP  
 STA. 421+61.96 (PROPOSED IL 13)  
 STA. 1273+05.41 (PROPOSED IL 157)

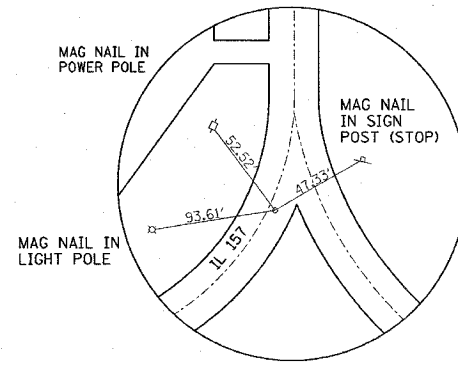

MAGNAIL  
 STA. 1274+56.27 (PROPOSED IL 157)

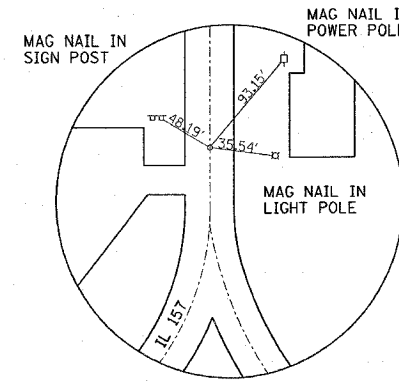

MAGNAIL  
 STA. 1276+16.21 (PROPOSED IL 157)

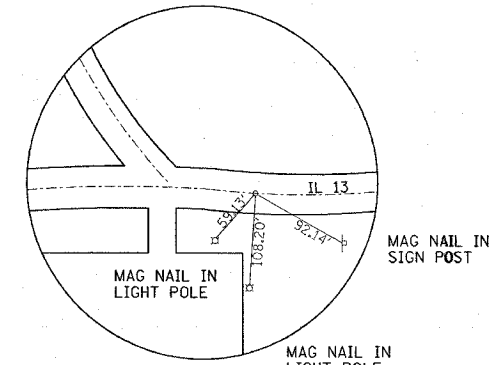

MAGNAIL  
 STA. 416+74.07 (PROPOSED IL 13)

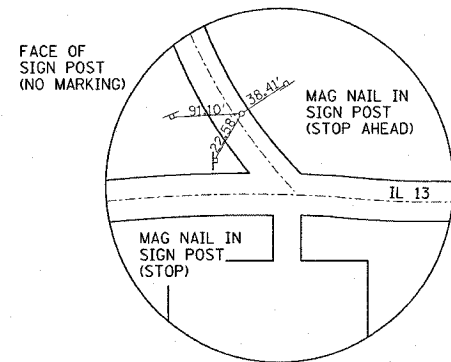

MAGNAIL  
 STA. 419+35.20 (PROPOSED IL 13)

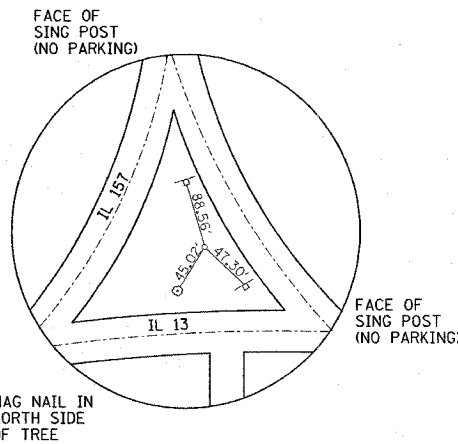

PIN W/CAP  
 STA. 419+35.20 (PROPOSED IL 13)

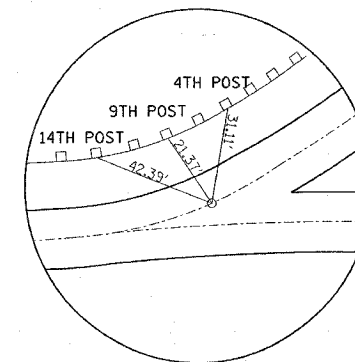

MAGNAIL  
 P.C. 423+29.60 (PROPOSED IL 13/157)

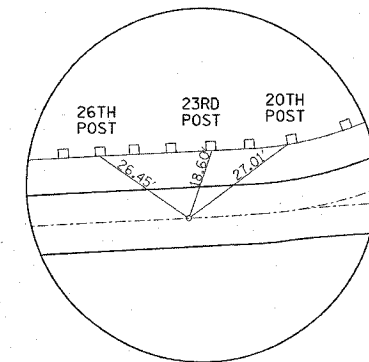

MAGNAIL  
 P.C. 424+27.20 (PROPOSED IL 13/157)

**BM 1**  
 CUT "□" ON WINGWALL @ NE CORNER  
 OF IL157 BRIDGE OVER SLOUGH.  
 SN 082-0087  
 ELEVATION: 423.805'

PLOT DATE = 3/22/2007  
 PLOT SCALE = 43.5000 / IN.  
 USER NAME = danielmny

| REVISIONS |      |
|-----------|------|
| NAME      | DATE |
|           |      |
|           |      |
|           |      |
|           |      |
|           |      |
|           |      |
|           |      |
|           |      |
|           |      |
|           |      |

ILLINOIS DEPARTMENT OF TRANSPORTATION

**TIE POINTS**

FAP ROUTE 592/FAU 9251  
 SECTION 120R-1  
 ST. CLAIR COUNTY

SCALE: VERT. \_\_\_\_\_  
 HORIZ. \_\_\_\_\_

DATE \_\_\_\_\_ DRAWN BY \_\_\_\_\_  
 CHECKED BY \_\_\_\_\_