

F.A.P. RTE.	SECTION	COUNTY	TOTAL SHEETS	SHEET NO.
*	120R-1	ST. CLAIR	74	15
STA. _____		TO STA. _____		
FED. ROAD DIST. NO. ILLINOIS FED. AID PROJECT				
* FAP 592/FAU 9251				

- (A) PRECAST REINFORCED, CONCRETE FLARED END SECTIONS 15"  
STA. 416+71.57 19.32' LT  
GRATE ELEV. 426.63'  
FL. ELEV. 426.61'
- (B1) INLETS TYPE A, TYPE 8 GRATE  
STA. 416+71.57 19.32' LT  
GRATE ELEV. 428.63'  
FL. ELEV. 426.38'
- (B2) INLETS TYPE A, TYPE 8 GRATE  
STA. 417+76.00 26.20' LT  
GRATE ELEV. 427.05'  
FL. ELEV. 424.80'
- (B3) INLETS TYPE A, TYPE 8 GRATE  
STA. 418+85.25 42.81' LT  
GRATE ELEV. 425.09  
FL. ELEV. 422.84'
- (C) STONE RIPRAP, CLASS A1, 12 SQ YDS  
FILTER FABRIC, 12 SQ YDS

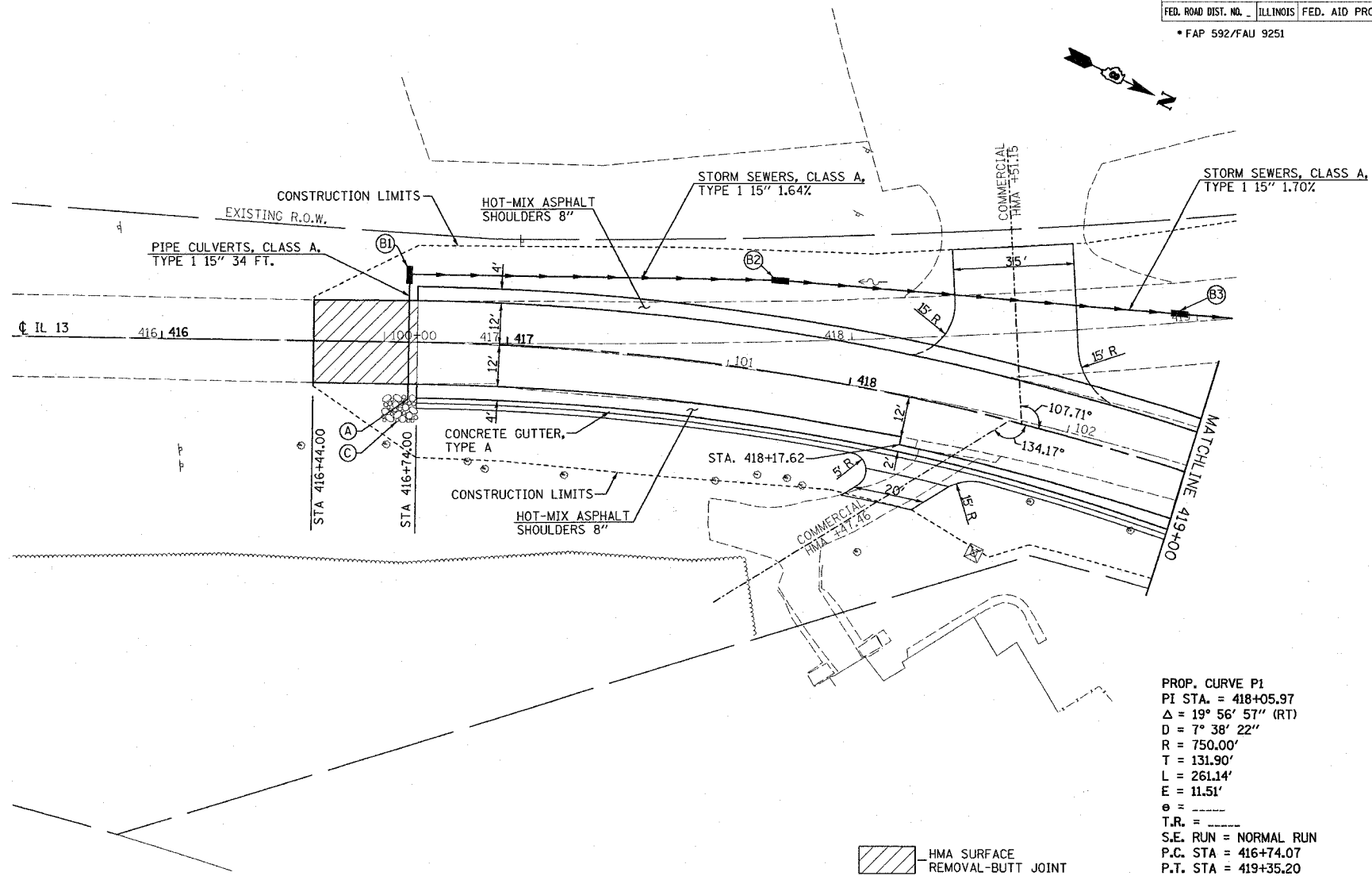

PROP. CURVE P1  
 PI STA. = 418+05.97  
 $\Delta = 19^\circ 56' 57''$  (RT)  
 $D = 7^\circ 38' 22''$   
 $R = 750.00'$   
 $T = 131.90'$   
 $L = 261.14'$   
 $E = 11.51'$   
 $e = \text{---}$   
 $T.R. = \text{---}$   
 $S.E. \text{ RUN} = \text{NORMAL RUN}$   
 $P.C. \text{ STA} = 416+74.07$   
 $P.T. \text{ STA} = 419+35.20$

HMA SURFACE  
 REMOVAL-BUTT JOINT



PLAN	REVIEWED	DATE
NO.	BY	
NO.	BY	
NO.	BY	

PROFILE	REVIEWED	DATE
NO.	BY	
NO.	BY	
NO.	BY	

PILOT DATE = 4/16/2007  
 FILE NAME = c:\p12\mets\ad\10005\plan\join\10005.dgn  
 PLOT SCALE = 20.0000' / IN.  
 REFERENCE = #REF#

