

F.A.P. RTE.	SECTION	COUNTY	TOTAL SHEETS	SHEET NO.
*	120R-1	ST. CLAIR	74	17
STA.		TO STA.		
FED. ROAD DIST. NO. ILLINOIS FED. AID PROJECT				
* FAP 592/FAU 9251				

PROP. CURVE FOURCOR-1  
 PI STA. = 101+25.52  
 $\Delta = 55^\circ 47' 47''$  (LT)  
 $D = 98^\circ 24' 45''$   
 $R = 58.22'$   
 $T = 30.82'$   
 $L = 56.70'$   
 $E = 7.66'$   
 $e = \text{---}$   
 $T.R. = \text{---}$   
 S.E. RUN = NORMAL CROWN  
 P.C. STA = 100+94.69  
 P.T. STA = 101+51.39

PROP. CURVE 157A  
 PI STA. = 1275+36.81  
 $\Delta = 16^\circ 39' 42''$  (LT)  
 $D = 10^\circ 25' 03''$   
 $R = 550.00'$   
 $T = 80.54'$   
 $L = 159.94'$   
 $E = 5.87'$   
 $e = \text{---}$   
 $T.R. = \text{---}$   
 S.E. RUN = NORMAL CROWN  
 P.C. STA = 1274+56.27  
 P.T. STA = 1276+16.21

HMA SURFACE REMOVAL-BUTT JOINT



PLAN	DATE
SURVEYED	
PLOTTED	
CHECKED	
NO. OF MAY CHECKED	
NO. OF FILE NAME	

PROFILE	DATE
SURVEYED	
PLOTTED	
CHECKED	
NO. OF MAY CHECKED	
NO. OF FILE NAME	

PLOT DATE = 4/6/2007  
 FILE NAME = c:\projects\76959\plan\120R-1.dgn  
 PLOT SCALE = 28.0000" / IN.  
 REFERENCE = SHEET

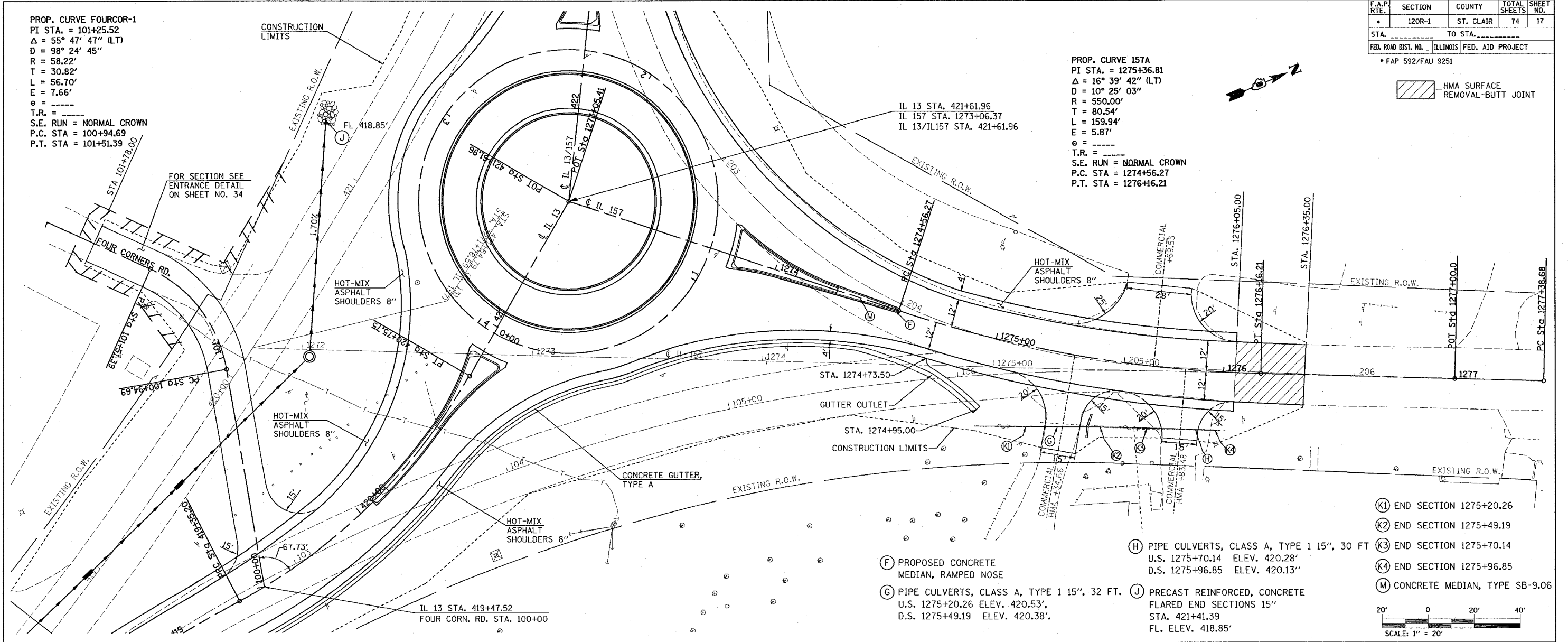

- (K1) END SECTION 1275+20.26
- (K2) END SECTION 1275+49.19
- (K3) END SECTION 1275+70.14
- (K4) END SECTION 1275+96.85
- (M) CONCRETE MEDIAN, TYPE SB-9.06
- (H) PIPE CULVERTS, CLASS A, TYPE 1 15", 30 FT  
 U.S. 1275+70.14 ELEV. 420.28'  
 D.S. 1275+96.85 ELEV. 420.13"
- (F) PROPOSED CONCRETE MEDIAN, RAMPED NOSE
- (G) PIPE CULVERTS, CLASS A, TYPE 1 15", 32 FT.  
 U.S. 1275+20.26 ELEV. 420.53',  
 D.S. 1275+49.19 ELEV. 420.38'
- (J) PRECAST REINFORCED, CONCRETE FLARED END SECTIONS 15"  
 STA. 421+41.39  
 FL. ELEV. 418.85'

