

F.A.P. RTE.	SECTION	COUNTY	TOTAL SHEETS	SHEET NO.
*	120R-1	ST. CLAIR	74	22
STA. _____		TO STA. _____		
FED. ROAD DIST. NO. _____		ILLINOIS FED. AID PROJECT		

* FAP 592/FAU 9251

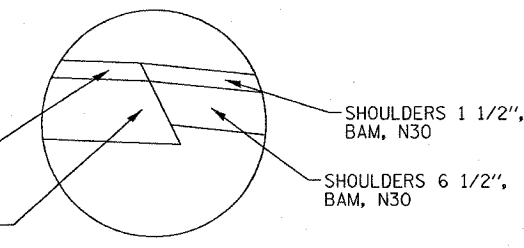
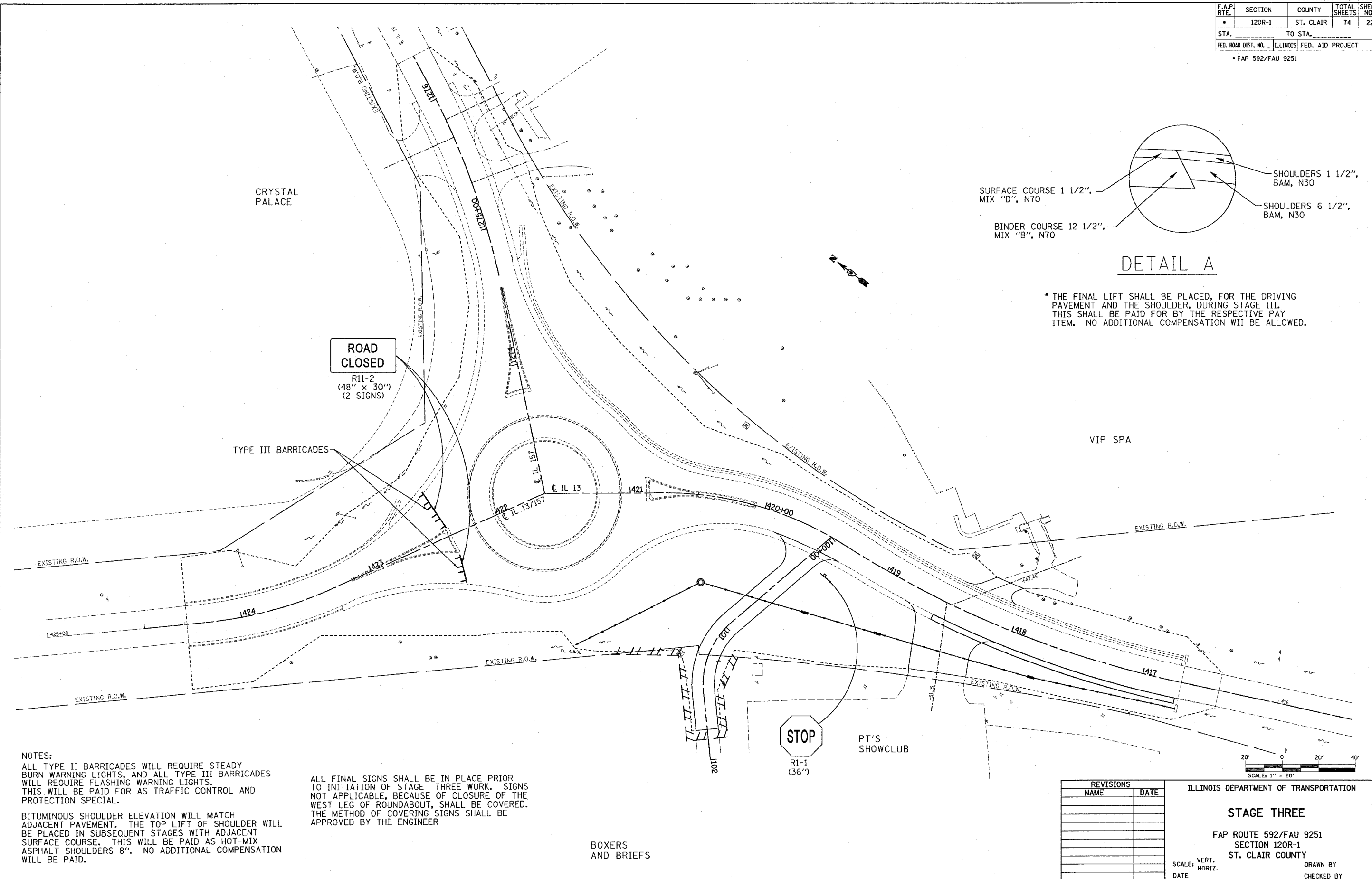

DETAIL A

* THE FINAL LIFT SHALL BE PLACED, FOR THE DRIVING PAVEMENT AND THE SHOULDER, DURING STAGE III. THIS SHALL BE PAID FOR BY THE RESPECTIVE PAY ITEM. NO ADDITIONAL COMPENSATION WILL BE ALLOWED.

ROAD CLOSED
R11-2
(48" x 30")
(2 SIGNS)

TYPE III BARRICADES

STOP
R1-1
(36")

PT'S SHOWCLUB

BOXERS AND BRIEFS

NOTES:
ALL TYPE II BARRICADES WILL REQUIRE STEADY BURN WARNING LIGHTS, AND ALL TYPE III BARRICADES WILL REQUIRE FLASHING WARNING LIGHTS. THIS WILL BE PAID FOR AS TRAFFIC CONTROL AND PROTECTION SPECIAL.
BITUMINOUS SHOULDER ELEVATION WILL MATCH ADJACENT PAVEMENT. THE TOP LIFT OF SHOULDER WILL BE PLACED IN SUBSEQUENT STAGES WITH ADJACENT SURFACE COURSE. THIS WILL BE PAID AS HOT-MIX ASPHALT SHOULDERS 8". NO ADDITIONAL COMPENSATION WILL BE PAID.

ALL FINAL SIGNS SHALL BE IN PLACE PRIOR TO INITIATION OF STAGE THREE WORK. SIGNS NOT APPLICABLE, BECAUSE OF CLOSURE OF THE WEST LEG OF ROUNDABOUT, SHALL BE COVERED. THE METHOD OF COVERING SIGNS SHALL BE APPROVED BY THE ENGINEER

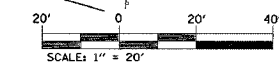

REVISIONS	
NAME	DATE

ILLINOIS DEPARTMENT OF TRANSPORTATION
STAGE THREE
FAP ROUTE 592/FAU 9251
SECTION 120R-1
ST. CLAIR COUNTY
SCALE: VERT. _____
HORIZ. _____
DATE _____ DRAWN BY _____
CHECKED BY _____

PLOT DATE = 4/6/2007
FILE NAME = c:\projects\120r01\120r01.dgn
USER NAME = jshelton