

FAP592/FAU9251		CONTRACT NO. 76959		
F.A.P. RTE.	SECTION	COUNTY	TOTAL SHEETS	SHEET NO.
*	120R-1	ST. CLAIR	74	69
STA. 1275+83.48		TO STA. 1276+00.00		
FED. ROAD DIST. NO. ILLINOIS		FED. AID PROJECT		

FINAL SURVEY	SUPERVISOR	DATE
NOTE BOOK	PLOTTED	
NO.	TEMPLATE	
	AREAS CHECKED	

ORIGINAL SURVEY	SUPERVISOR	DATE
NO.	PL	
	TEMPLATE	
	AREAS CHECKED	

PLOT DATE = 3/22/2007
 FILE NAME = c:\projects\val18005\val18005\sheet18005.dwg
 PLOT SCALE = 5.0000 / 1" = 50.0000'
 USER NAME = drc@manly.com

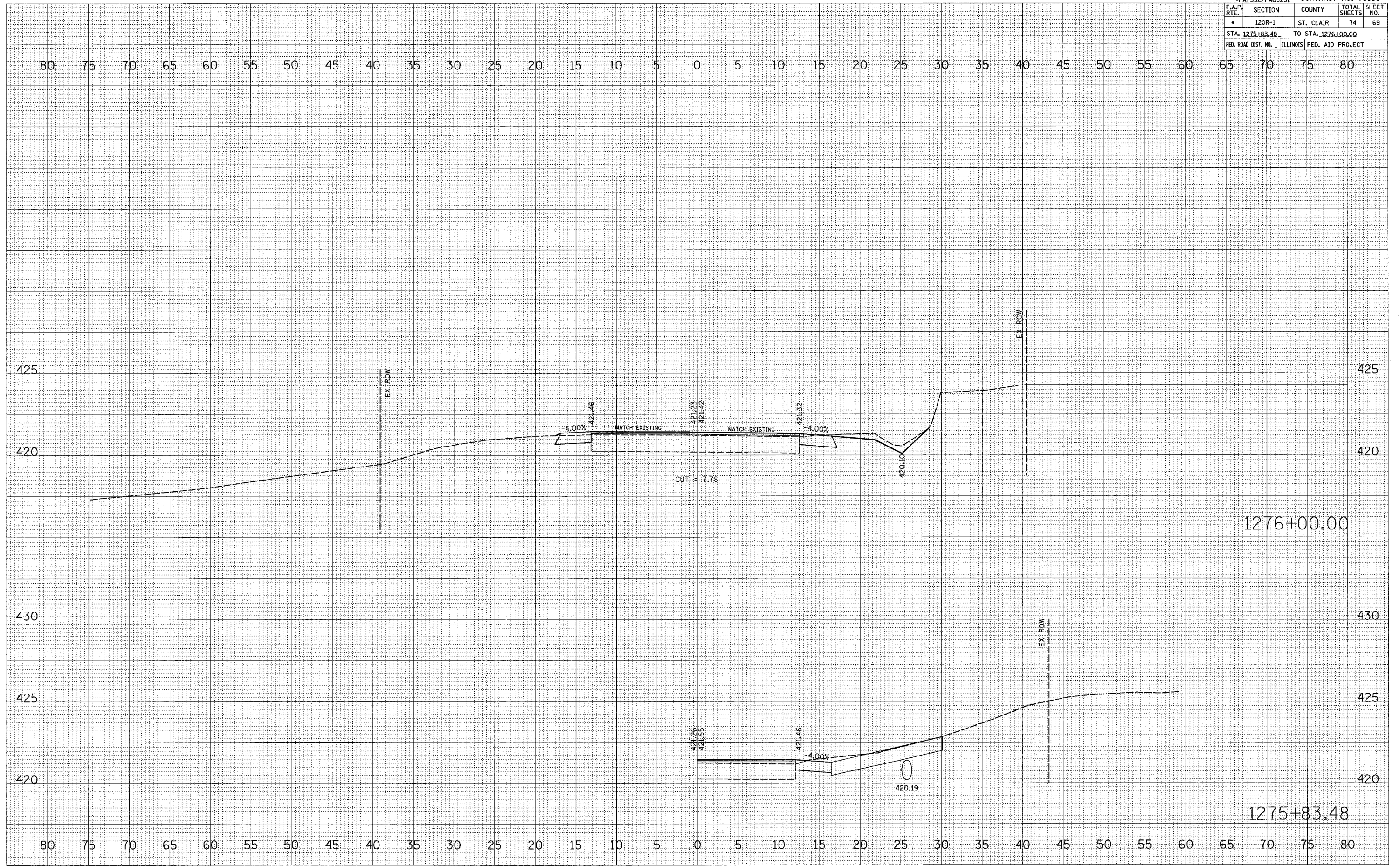

1276+00.00

1275+83.48