

F.A.P. RTE.	SECTION	COUNTY	TOTAL SHEETS	SHEET NO.
582	6-31	MADISON	18	1

STATE OF ILLINOIS
DEPARTMENT OF TRANSPORTATION
DIVISION OF HIGHWAYS

**PROPOSED
HIGHWAY PLANS**

FAP ROUTE 582
SECTION 6-31
~~PROJECT F-582()~~
PATCHING & RESURFACING
MADISON COUNTY
C-98-079-07

FOR INDEX OF SHEETS, SEE SHEET NO. 2

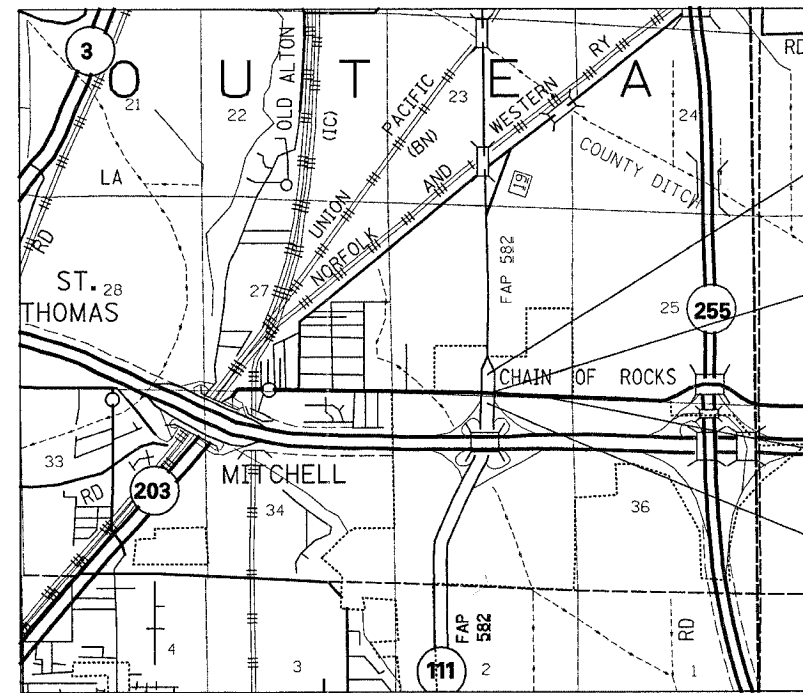
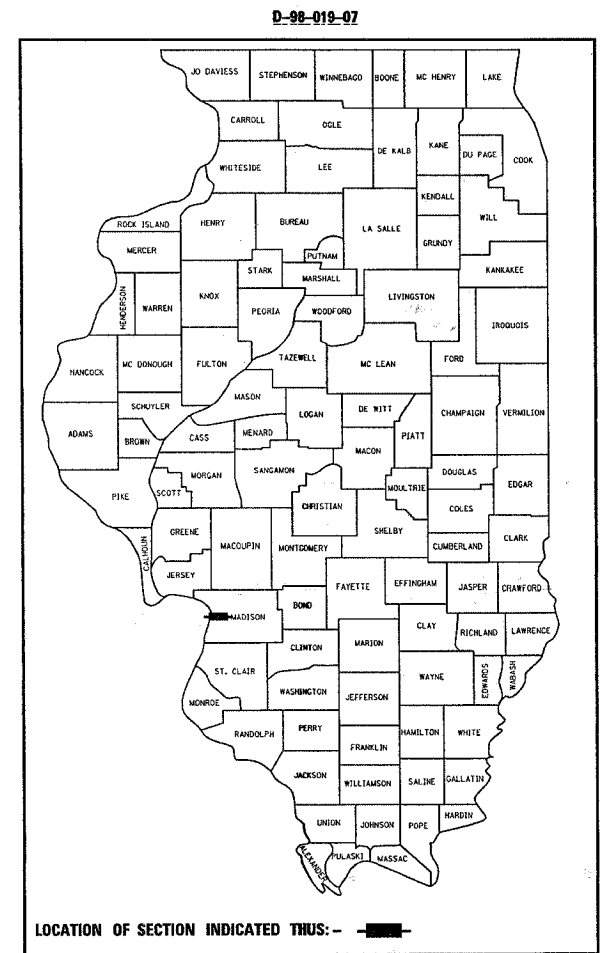

ILL RTE. 111
END PROJECT
STA. 213+44
LAT. = 38° 45' 45.1"
LONG. = -90° 03' 59.5"

CHAIN OF ROCKS ROAD
STA. 30+40

CHAIN OF ROCKS ROAD
STA. 37+00
LAT. = 38° 45' 40.9"
LONG. = -90° 03' 53.1"

ILL RTE. 111
BEGIN PROJECT
STA. 202+95
LAT. = 38° 45' 26.9"
LONG. = -90° 04' 00.97"

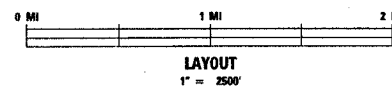

MICROFILMED _____
REEL NUMBER _____
AWARDED _____
RESIDENT ENGINEER _____
AS BUILT CHANGES WERE MADE
ON THE FOLLOWING SHEETS

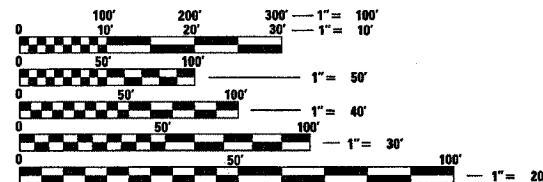

FULL SIZE PLANS HAVE BEEN PREPARED USING STANDARD ENGINEERING SCALES. REDUCED SIZED PLANS WILL NOT CONFORM TO STANDARD SCALES. IN MAKING MEASUREMENTS ON REDUCED PLANS, THE ABOVE SCALES MAY BE USED.

J.U.L.I.E.
JOINT UTILITY LOCATION INFORMATION FOR EXCAVATION
1-800-892-0123

ILL RTE 111- OTHER PRIME ARTERIAL
2007 ADT= 21,300 (ACTUAL)
2027 ADT= 28,700 (ESTIMATED)
SU=6.7%
MU=14.3%

CHAIN OF ROCKS RD-MINOR ARTERIAL
2007 ADT= 8,700 (ACTUAL)
2027 ADT= 11,700 (ESTIMATED)
SU=6.7%
MU=14.3%

GROSS LENGTH = 0.151 MILES
NET LENGTH = 0.141 MILES

PROJECT ENGINEER: PATRICK LEBEAU (618)346-3179
SQUAD LEADER: CHERYL KEPLAR (618)346-3186

STATE OF ILLINOIS
DEPARTMENT OF TRANSPORTATION
DIVISION OF HIGHWAYS

SUBMITTED March 30, 2007

Mary C. James
DEPUTY DIRECTOR OF HIGHWAYS
REGION FIVE ENGINEER

May 11, 2007
Eric E. Horn
ENGINEER OF DESIGN AND ENVIRONMENT

May 11, 2007
Milton R. See
DIRECTOR, DIVISION OF HIGHWAYS

PRINTED BY THE AUTHORITY
OF THE STATE OF ILLINOIS

F.A.P. RTE.	SECTION	COUNTY	TOTAL SHEETS	SHEET NO.
582	6-3I	MADISON	18	2
STA. _____		TO STA. _____		
FED. ROAD DIST. NO. _____		ILLINOIS FED. AID PROJECT		

INDEX OF SHEETS

- 1 COVER SHEET**
- 2 INDEX OF SHEETS, GENERAL NOTES, STANDARDS**
- 3 SUMMARY OF QUANTITIES**
- 4 TYPICALS**
- 5-6 SCHEDULES**
- 7-9 PLAN SHEETS**
- 10 PAVEMENT MARKING SHEET**
- 11-18 STAGING AND TRAFFIC CONTROL SHEETS**

GENERAL NOTES

1. THE STANDARDS AND REVISIONS LISTED APPLY TO THIS PROJECT.
2. ALL BUSINESS ENTRANCES SHALL BE OPEN DURING THE DURATION OF THIS CONTRACT. THE COORDINATION OF THIS PROJECT WITH THE MANAGEMENT OF "FLYING J TRUCK STOP" WILL BE THE CONTRACTOR'S RESPONSIBILITY. THE MANAGEMENT OF "FLYING J TRUCK STOP" WILL BE CONTACTED SEVEN (7) WORKING DAYS IN ADVANCE OF LANE CLOSURES WITH THE LOCATION AND ESTIMATED DURATION OF THE CLOSURE.
3. ILLINOIS STATE LAW REQUIRES A 48-HOUR NOTICE TO BE GIVEN TO UTILITIES BEFORE DIGGING. FIELD MARKING OF FACILITIES MAY BE OBTAINED BY CONTACTING J.U.L.I.E. OR FOR NON-MEMBERS, THE UTILITY COMPANY DIRECTLY. AGENCIES KNOW TO HAVE FACILITIES WITHIN THE PROJECT AREA ARE AS FOLLOWS:
 - AMERENCIPS (ELECTRIC)
 - AMERENIP (GAS)
 - BUCKEYE PARTNERS L.P. - WOOD RIVER PIPELINE
 - CHARTER COMMUNICATIONS, INC. (CABLE)
 - VILLAGE OF GLEN CARBON (WATER AND SANITARY SEWER)
 - ILLINOIS AMERICAN WATER CO. (WATER)
 - MADISON COUNTY SPECIAL SERVICE AREA #1 (SEWER)
 - MITCHELL PUBLIC WATER DISTRICT (WATER)
 - PONTON BEACH WATER DISTRICT (WATER)
 - AT&T ILLINOIS (COMMUNICATIONS)
 - LEVEL 3 COMMUNICATIONS (COMMUNICATIONS)

MEMBERS OF J.U.L.I.E. (800) 892-0123 ARE INDICATED BY *

NON J.U.L.I.E. MEMBERS MUST BE NOTIFIED INDIVIDUALLY.

4. IF SECTION OR SUB-SECTION MONUMENTS ARE ENCOUNTERED, THE ENGINEER SHALL BE NOTIFIED BEFORE SUCH MONUMENTS ARE REMOVED. THE CONTRACTOR SHALL PROTECT AND CAREFULLY PRESERVE ALL PROPERTY MARKERS AND MONUMENTS UNTIL THE OWNER, AN AUTHORIZED SURVEYOR, OR AN AGENT HAS WITNESSED OR OTHERWISE REFERENCED THEIR LOCATION.
5. ALL AREAS DISTURBED FOR ANY REASON SHALL BE SEEDED WITH CLASS 2 SEEDING AS DIRECTED BY THE ENGINEER AT THE EXPENSE OF THE CONTRACTOR. FERTILIZER NUTRIENTS SHALL ALSO BE APPLIED AT THE EXPENSE OF THE CONTRACTOR. FERTILIZER NUTRIENTS SHALL CONFORM TO ARTICLE 250.04.
6. THE CONTRACTOR SHALL VERIFY ALL DIMENSIONS AND CONDITIONS IN THE FIELD PRIOR TO CONSTRUCTION AND PLACEMENT OF PAVEMENT MARKINGS.
7. SAW CUTS ALONG THE EDGES OF THE HMA RESURFACING AREAS TO THE DEPTH SPECIFIED IN THE TYPICAL SECTIONS SHALL BE INCLUDED IN THE COST OF THE REMOVAL ITEM PER SECTION 440 OF THE STANDARD SPECIFICATIONS.
8. THE THICKNESS OF THE HMA MIXTURES SHOWN IN THE PLANS IS THE NOMINAL THICKNESS. DEVIATIONS FROM THE NOMINAL WILL BE PERMITTED WHEN SUCH DEVIATIONS OCCUR DUE TO IRREGULARITIES IN THE EXISTING SURFACE ON WHICH THE HMA MIXTURE IS PLACED.
9. THE FOLLOWING MIXTURE REQUIREMENTS ARE APPLICABLE TO THIS PROJECT.

MIXTURE USE	Surface (Southbound IL 111)	Curb & Gutter Resurfacing (Northbound IL 111+ Chain of Rocks Road)
AC/PG	SBS PG 76-22	SBS PG 76-22
RAP % (MAX)	0%	10%
DESIGN AIR VOIDS	4.0% @ Ndes=80	4.0% @ Ndes=90
MIX		
COMPOSITION (GRADATION MIXTURE)		IL 12.5
FRICTION AGG	MIXTURE SMA	Mixture D

10. HIGH EARLY STRENGTH CONCRETE MIX SHALL BE USED FOR ALL CLASS B PATCHES.
11. THE HMA SURFACING MATERIAL THAT COVERS THE CURB & GUTTER FLAG SHALL BE REMOVED TO ALLOW THE RE-ESTABLISHMENT OF THE PAVEMENT SLOPE. THIS WORK IS INCLUDED IN THE COST OF THE CLASS B PATCH, TYPE IV.
12. ALL TRANSVERSE JOINTS IN THE NEW PCC PAVEMENT PATCHES SHALL ALIGN WITH ADJOINING PAVEMENT JOINTS OR SHALL BE SPACED AT 15' CENTERS AS PER IDOT STANDARD 420101. PAVEMENT JOINTS SHALL BE INSTALLED AS PER IDOT STANDARD 420001. DOWEL BAR ASSEMBLIES SHALL BE INSTALLED AT ALL TRANSVERSE JOINTS THAT FALL INSIDE THE AREA OF A PCC PAVEMENT PATCH AND AT TRANSVERSE JOINTS THAT FALL BETWEEN ADJOINING PATCH AREAS. LOCATIONS OF THE TRANSVERSE JOINTS ARE TO BE REVIEWED AND APPROVED BY THE ENGINEER.
13. PAVEMENT REMOVAL FOR IL 111 NORTHBOUND SHALL CONSIST OF REMOVING ALL OF THE EXISTING LAYERS OF HOT MIX ASPHALT TO THE SURFACE OF THE UNDERLYING PORTLAND CEMENT PAVEMENT. REMOVAL MAY BE DONE BY ANY MEANS AS LONG AS THE UNDERLYING PORTLAND CEMENT PAVEMENT IS NOT DAMAGED OR CRACKED. A PAVEMENT CORE REPORT IS ATTACHED TO THE SPECIAL PROVISIONS FOR REFERENCE TO ALLOW THE CONTRACTOR TO DETERMINE THE BEST METHOD OF REMOVAL AND MUST BE APPROVED BY THE ENGINEER. IF DURING THE SURFACE REMOVAL THE UNDERLYING PAVEMENT IS DAMAGED, THE METHOD OF REMOVAL MUST BE MODIFIED TO PREVENT THE DAMAGE BY THE CONTRACTOR AND APPROVED BY THE ENGINEER.
14. THE PATCHING SCHEDULES INCLUDED IN THE PLANS REPRESENT THE BEST INFORMATION AVAILABLE AT THE TIME OF COMPLETION OF THE PLANS FOR LETTING. VARIATIONS IN EXISTING PAVEMENT THICKNESSES AND COMPOSITION MAY EXIST. A PAVEMENT CORE REPORT IS IN THE SPECIAL PROVISIONS FOR REFERENCE.
15. ALL CLASS B PATCH SURFACES SHALL BE TINED TO MATCH SURROUNDING PAVEMENT PER ARTICLE 442.06(f).
16. FOUR (4) CHANGEABLE MESSAGE BOARDS SHALL BE INSTALLED AT VARIOUS LOCATIONS DESIGNATED BY THE RESIDENT. CHANGEABLE MESSAGE BOARDS SHALL BE IN PLACE A MINIMUM OF ONE (1) WEEK PRIOR TO START OF CONSTRUCTION. DURING THE DURATION OF THE CONTRACT, THE LOCATIONS OF THE CHANGEABLE MESSAGE BOARDS COULD CHANGE DUE TO THE VARIOUS STAGES OF CONSTRUCTION AND CHANGING TRAFFIC PATTERNS.
17. CONTRACTOR MAY ONLY REMOVE WHAT CAN BE REPLACED DURING WORK HOURS. ALL EXCAVATIONS SHALL BE FILLED WITH AGGREGATE AND FORMED CONSTRUCTION JOINTS SHALL BE PROTECTED UNTIL THE NEXT WORK DAY.
18. 48" x 48" "ROAD CONSTRUCTION AHEAD" SIGNS SHALL BE PLACED AT ENTRANCES AND SIDE STREETS PRIOR TO THE BEGINNING OF WORK AS DIRECTED BY THE RESIDENT ENGINEER. ALL CONSTRUCTION SIGNS SHALL BE FLORESCENT ORANGE. THIS SHALL BE INCLUDED IN THE COST OF THE TRAFFIC CONTROL AND PROTECTION.
19. NO DROP OFF GREATER THAN 3 INCHES AT THE EDGE OF AN OPEN TRAVEL LANE SHALL BE LEFT OPEN AT THE END OF THE WORKDAY. DROP OFFS SHALL BE FILLED WITH AGGREGATE AT THE END OF THE WORKDAY.
20. ALL EXCAVATIONS ADJACENT TO THE EDGE OF PAVEMENT SHALL BE PROTECTED WITH EXTENDED LEG BARRICADES AND APPROPRIATE LIGHTS DURING LANE CLOSURE.
21. ALL SHORT TERM PAVEMENT MARKINGS SHALL BE PLACED IN SUCH A MANNER SO AS NOT TO INTERFERE WITH THE PLACEMENT OF PERMANENT PAVEMENT MARKINGS.
22. FLAGMEN SHALL BE PRESENT DURING ALL WORK HOURS, INCLUDING LUNCH HOUR. THE SUGGESTED NUMBER OF FLAGMEN IS SHOWN IN THE STAGING AND TRAFFIC CONTROL PLANS. ANY ADDITIONAL FLAGGERS BASED ON THE CONDITIONS PRESENT OR THE CONTRACTOR'S METHOD OF PROCEDURES SHALL BE INCLUDED IN THE COST OF "TRAFFIC CONTROL & PROTECTION (SPECIAL)". THE NUMBER OF FLAGGERS SHALL BE APPROVED BY THE RESIDENT ENGINEER. NO ADDITIONAL COMPENSATION SHALL BE APPLIED.

HIGHWAY STANDARDS

- 000001-04
- 001001-01
- 001006
- 420001-06
- 420101-03
- 420701-01
- 442101-06
- 701426-02
- 702001-06
- 780001-01
- 781001-02

PLOT DATE = 5/14/2007
 FILE NAME = c:\projects\76b02\76b02.dgn
 PLOT SCALE = 56.8000 / IN.
 REFERENCE = #REF#

REVISIONS		ILLINOIS DEPARTMENT OF TRANSPORTATION INDEX OF SHEETS, GENERAL NOTES STANDARDS FAP ROUTE 582 SECTION 6-3I MADISON COUNTY
NAME	DATE	
		SCALE: VERT. HORIZ. DATE
DRAWN BY		CHECKED BY

SUMMARY OF QUANTITIES

F.A.P. RTE.	SECTION	COUNTY	TOTAL SHEETS	SHEET NO.
582	6-3I	MADISON	18	3
STA.		TO STA.		
FED. ROAD DIST. NO.		ILLINOIS FED. AID PROJECT		

SUMMARY OF QUANTITIES			URBAN TOTAL QUANTITIES	CONSTRUCTION TYPE CODE		
CODE NO	ITEM	UNIT		1000 100% STATE		
35101300	AGGREGATE BASE COURSE, TYPE A 14"	SQ YD	1543	1543		
40600200	BITUMINOUS MATERIALS (PRIME COAT)	TON	1	1		
40603545	POLYMERIZED HOT-MIX ASPHALT SURFACE COURSE, MIX "D", N90	TON	6.4	6.4		
44000167	HOT-MIX ASPHALT SURFACE REMOVAL, 4 1/2"	SQ YD	2111	2111		
44200976	CLASS B PATCHES, TYPE IV, 10 INCH	SQ YD	491	491		
44213100	PAVEMENT FABRIC	SQ YD	3247	3247		
44213200	SAW CUTS	FOOT	2578	2578		
67000400	ENGINEER'S FIELD OFFICE, TYPE A	CAL MO	3	3		
67100100	MOBILIZATION	L SUM	1	1		
70101800	TRAFFIC CONTROL AND PROTECTION (SPECIAL)	L SUM	1	1		
70106800	CHANGEABLE MESSAGE SIGN	CAL MO	0	0		
70300100	SHORT-TERM PAVEMENT MARKING	FOOT	1010	1010		
70301000	WORK ZONE PAVEMENT MARKING REMOVAL	SQ FT	337	337		
78000100	THERMOPLASTIC PAVEMENT MARKING - LETTERS AND SYMBOLS	SQ FT	47	47		
78000200	THERMOPLASTIC PAVEMENT MARKING - LINE 4"	FOOT	1693	1693		
78000650	THERMOPLASTIC PAVEMENT MARKING - LINE 24"	FOOT	44	44		
78005100	EPOXY PAVEMENT MARKING - LETTERS AND SYMBOLS	SQ FT	78	78		
78005110	EPOXY PAVEMENT MARKING - LINE 4"	FOOT	2748	2748		
78005150	EPOXY PAVEMENT MARKING - LINE 12"	FOOT	85	85		
78005180	EPOXY PAVEMENT MARKING - LINE 24"	FOOT	77	77		
78100100	RAISED REFLECTIVE PAVEMENT MARKER	EACH	60	60		
78300200	RAISED REFLECTIVE PAVEMENT MARKER REMOVAL	EACH	56	56		
X4066580	POLYMERIZED HOT-MIX ASPHALT SURFACE COURSE, STONE MATRIX ASPHALT, N80	TON	532	532		

SUMMARY OF QUANTITIES			URBAN TOTAL QUANTITIES	CONSTRUCTION TYPE CODE		
CODE NO	ITEM	UNIT		1000 100% STATE		
Z0017202	DOWEL BARS 1 1/2"	EACH	40	40		
Z0075310	TIE BARS 3/4"	EACH	1280	1280		
44201294	CLASS B EXPANSION JOINT	FOOT	52	52		
40600300	AGGREGATE (PRIME COAT)	TON	3.2	3.2		
44200964	CLASS B PATCH, TYPE II, 9 INCH	SQ YD	1213	1213		
44201080	CLASS B PATCH, TYPE IV	SQ YD	1543	1543		
48101200	AGGREGATE SHOULDERS, TYPE B	TON	38	38		
Z0017099	DOWEL BAR ASSEMBLY	EACH	125	125		

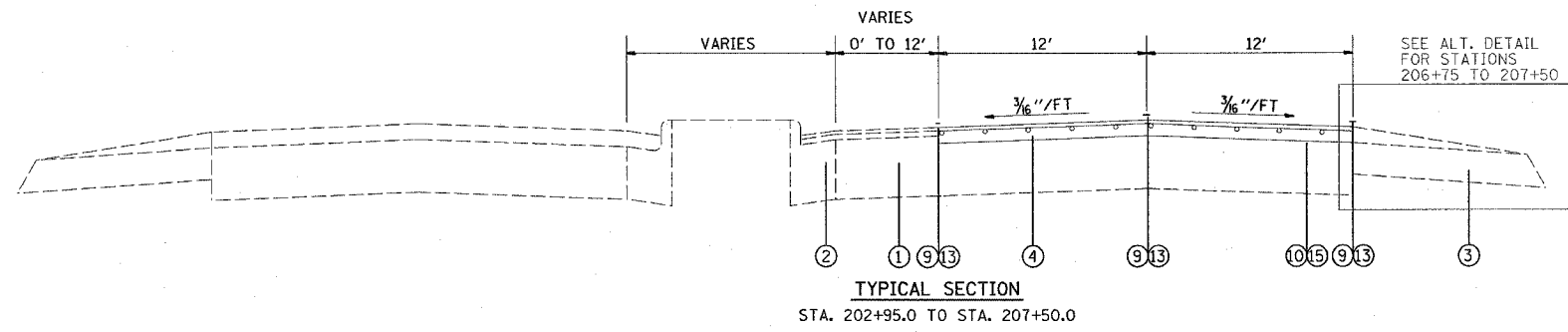

TYPICAL SECTION
STA. 202+95.0 TO STA. 207+50.0

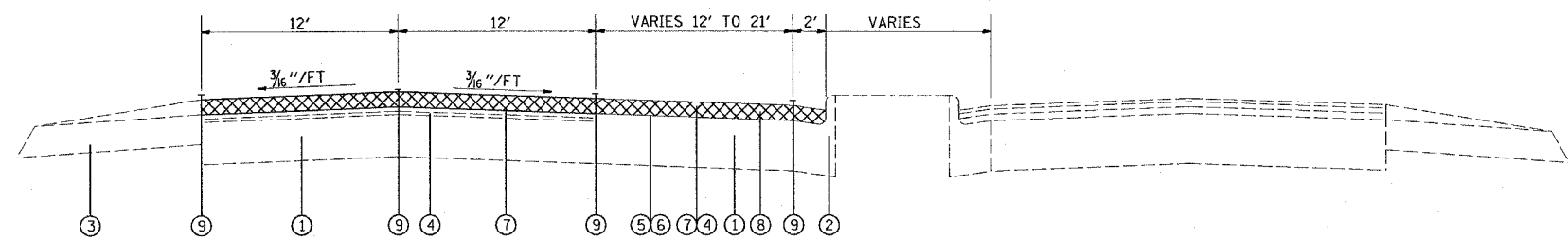

TYPICAL SECTION
STA. 208+00.0 TO STA. 210+46.7

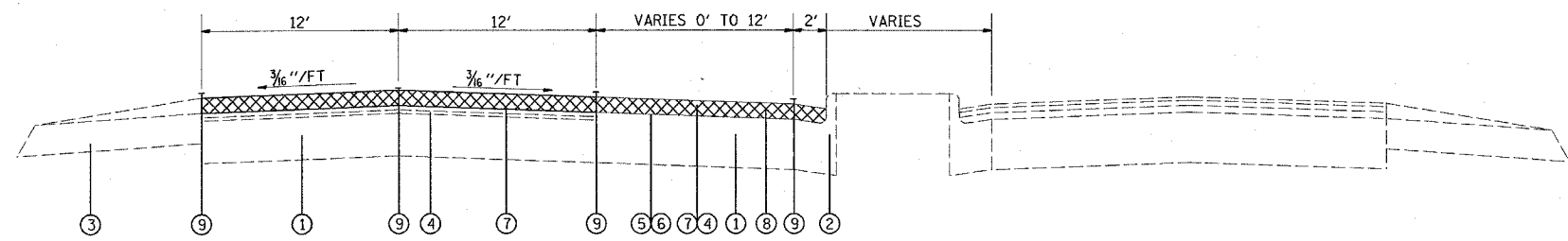

TYPICAL SECTION
STA. 210+46.7 TO STA. 213+44.0

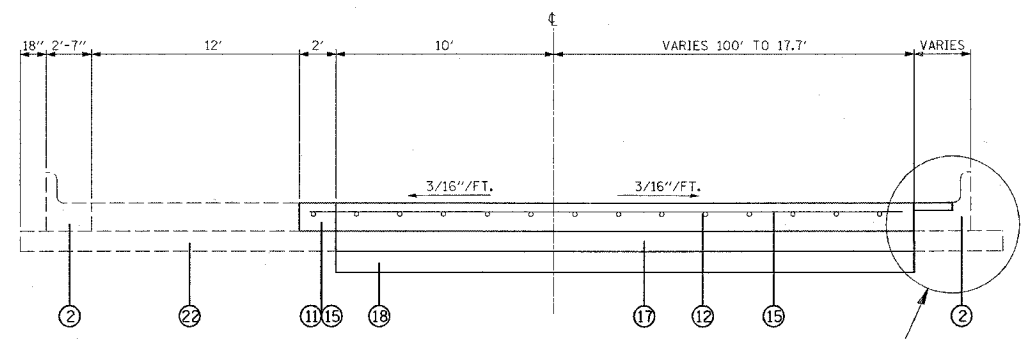

TYPICAL SECTION
CONCRETE WIDENING
CHAIN OF ROCKS RD.
STA. 30+40 TO STA. 33+84

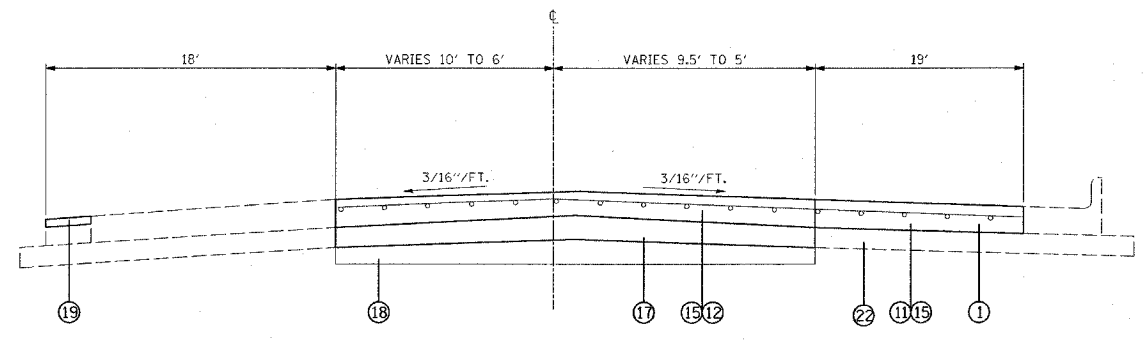

TYPICAL SECTION
CONCRETE WIDENING
CHAIN OF ROCKS RD.
STA. 33+84 TO STA. 36+02

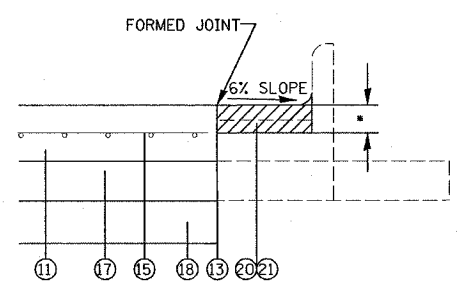
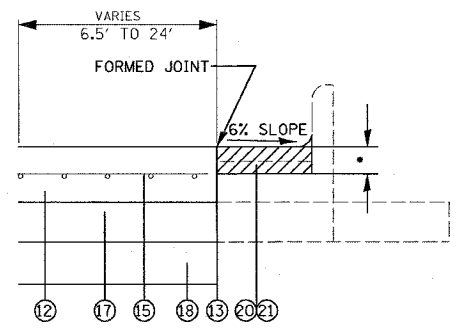

DETAIL "B"
STA. 30+40 TO STA. 31+19
STA. 31+89 TO STA. 32+85
*REMOVE ALL EXISTING HOT MIX ASPHALT MATERIAL

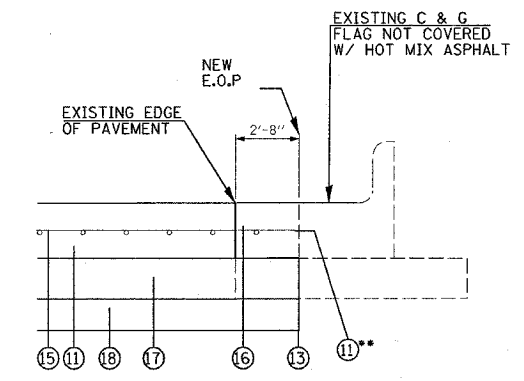

DETAIL "C"
STA. 31+69 TO 31+89
**MONOLITHIC POUR WITH PATCH.

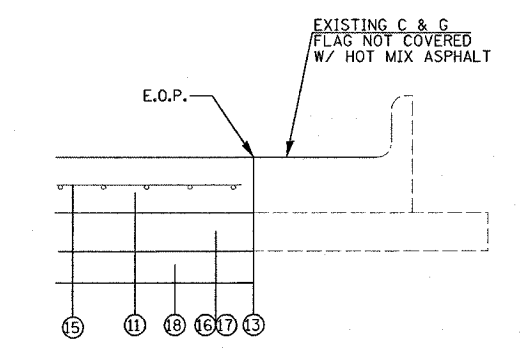

DETAIL "D"
STA. 31+19 TO 31+69
STA. 32+85 TO 33+85

- LEGEND**
- ① EXISTING PCC PAVEMENT
 - ② EXISTING TYPE B-6.24 COMB. CURB & GUTTER.
 - ③ EXISTING HMA SHOULDERS
 - ④ EXISTING HMA SURFACE COURSE
 - ⑤ PROPOSED HMA MATERIALS (PRIME COAT)
 - ⑥ PROPOSED AGGREGATE PRIME COAT
 - ⑦ PROPOSED HMA SURFACE REMOVAL, 4 1/2"
 - ⑧ PROPOSED POLYMERIZED HMA SURFACE COURSE, STONE MATRIX ASPHALT, N80, 4 1/2" INSTALLED IN 2 EQUAL THICKNESS LIFTS.
 - ⑨ PROPOSED PAVEMENT MARKING LINE, 4"
 - ⑩ PROPOSED CLASS B PATCH, TYPE IV, 9" *
 - ⑪ PROPOSED CLASS B PATCH, TYPE IV, 10"*
 - ⑫ PROPOSED CLASS B PATCH, TYPE IV, (24")*
-SEE SPECIAL PROVISIONS-
 - ⑬ SAW CUT.
 - ⑭ SAW CUT. 4 1/2"
 - ⑮ PROPOSED PAVEMENT REINFORCEMENT-FABRIC PER STANDARD 420701
 - ⑯ PROPOSED CURB & GUTTER FLAG EXTENSION REMOVAL INCIDENTAL TO CLASS B PATCH AREA
 - ⑰ PROPOSED AGGREGATE BASE COURSE TYPE A, 14"
 - ⑱ PROPOSED COMPACTED SUBGRADE, INCLUDED IN COST OF AGGREGATE BASE COURSE TYPE A, 14"
 - ⑲ PROPOSED AGGREGATE SHOULDERS, TYPE B
 - ⑳ PROPOSED HMA SURFACE REMOVAL, INCLUDED IN COST OF CLASS B PATCHING, TYPE IV
 - ㉑ PROPOSED C&G FLAGG RESURFACING HMA SURFACE COURSE, MIX "D" N90
 - ②② EXISTING AGGREGATE BASE COURSE TYPE A, 14"
- * PAVEMENT CONSTRUCTED AND JOINTED AS PER STD'S 420001, 420101 AND 442101.

REVISIONS	
NAME	DATE

ILLINOIS DEPARTMENT OF TRANSPORTATION
TYPICAL SECTIONS

FAP ROUTE 582
SECTION 6-3I
MADISON COUNTY

DRAWN BY:
PLOT DATE: 5/4/2007

PLAN
NO. _____
DATE _____
BY _____
CHECKED _____
DATE _____
NO. _____
DATE _____
NO. _____
DATE _____
NO. _____
DATE _____

5/4/2007
5/4/2007
5/4/2007
5/4/2007
5/4/2007

Pavement Patching Schedule - Chain of Rocks Road & IL 111 Shoulder

Patch Reference Label	Direction of Travel	Starting Station	Ending Station	Lane To Be Patched	CLASS B PATCHES TYPE IV, 10 INCH			CLASS B PATCHES TYPE IV			TOTAL PATCH QUANTITY (Sq. Yd.)	Saw Cuts (Ft.)	Pavement Fabric (Sq. Yd.)	# 6 @ 24" Longitudinal & T-P Tie Bars (Eq.)	Class B Expansion Joint (Ft.)	Dowel Bars (Eq.)	Dowel Bar Assemblies (Eq.) *	Aggregate Base Course Type A - 14" (Sq. Yd.)
					Patch Length (Ft.)	Patch Width (Ft.)	Patch Quantity (Sq. Yd.)	Patch Length (Ft.)	Patch Width (Ft.)	Patch Quantity (Sq. Yd.)								
A	WB & EB	35+27	36+02	Center & Driving	75.0	16	99.1	28.0	11	34.2	133.3	182	133.3	113	7	5	34.2	
B	WB & EB	33+84	35+27	Center & Driving	143.0	16	79.4	143.0	11	174.8	254.2	318	254.2	215		10	174.8	
C	EB	33+85	35+34	Right Turn Lane	149.0	12 to 16.5	235.9				235.9	331	235.9	149	27	10	0.0	
D	WB & EB	33+84	33+84	Center & Driving	36.0	2	8.0	36.0	10	40.0	48.0	92	48.0	54	3	3	40.0	
E	EB	32+85	33+48	Driving				63.0	18	126.0	126.0	162	126.0	63	3	4	126.0	
F	WB	30+64	33+47	LTL	283.0	2	62.9	283.0	10	314.4	377.3	586	377.3	142		19	314.4	
G	WB	30+40	30+64	LTL	24.0	2	5.3	24.0	10	26.7	32.0	68	32.0	12	12	2	26.7	
H	EB	30+40	30+64	Driving				24.0	40	106.7	106.7	128	106.7	24	40	2	106.7	
I	NB to EB	206+75	207+35	RTL / Shoulder				60.0	6.5 to 24	101.7	101.7	151	101.7	60		5	101.7	
J	EB	30+64	30+79	Driving				15.0	40 to 29	57.5	57.5	99	57.5	15		1	57.5	
K	EB	30+79	32+85	Driving				206.0	29 to 20	560.8	560.8	461	560.8	206		14	560.8	
Totals -							491	--	--	1543	2033	2578	2033	1052	52	40	75	1543

*Dowel Bar Assemblies will be installed at ALL transverse construction joint which falls between adjacent pavement patches instead of drilling and grouting dowel bars. Quantities are estimated, actual quantities may vary. Assembly lengths to be measured and verified by Contractor.

Pavement Patching Schedule - IL 111 North Bound Lanes

Patch Reference Label	Direction of Travel	Starting Station	Ending Station	Lane To Be Patched	CLASS B PATCHES TYPE IV, 9 INCH			Saw Cuts (Ft.)	Pavement Fabric (Sq. Yd.)	# 6 @ 24" Longitudinal Tie Bars (Eq.)	Dowel Bar Assemblies (Eq.) *
					Patch Length (Ft.)	Patch Width (Ft.)	Patch Quantity (Sq. Yd.)				
L	NB	202+95	207+50	Driving	455.0	12	606.7	934	606.7		30
M	NB	202+95	207+50	Passing	455.0	12	606.7	934	606.7	228	30
Totals -							1213	1868	1213	228	60

*Dowel Bar Assemblies will be installed at ALL transverse construction joint which falls between adjacent pavement patches instead of drilling and grouting dowel bars. Quantities are estimated, actual quantities may vary. Assembly lengths to be measured and verified by Contractor.

Pavement Resurfacing - IL 111 Southbound Lanes

Direction of Travel	Start Station	Ending Station	Lane To Be Resurfaced	Length (Ft.)	Starting Width (Ft.)	Ending Width (Ft.)	HMA Surface Removal - 4 1/2" (Sq. Yd.)	Bituminous Materials - Primecoat (Tons)	Aggregate - Primecoat (Tons)	Polymerized HMA Surface Course - Stone Matrix Asphalt (Tons)
SB	208+00	213+44	Driving	544	12	12	725	0.227	1.1	182.7
SB	208+00	213+44	Passing	544	12	12	725	0.227	1.1	182.7
SB	208+00	208+08	LTL	8	21	21	19	0.006	0.0	4.8
SB	208+08	208+25	LTL	17	21	14	33	0.010	0.0	8.3
SB	208+25	210+47	LTL	222	14	14	345	0.108	0.5	86.9
SB	210+47	213+44	LTL	297	14	2	264	0.083	0.4	66.5
Totals -							2111	1.0	3.1	532.0

C&G Flag Resurfacing Schedule for Northbound IL 111 & Eastbound Chain of Rocks Road

Direction of Travel	Starting Station	Ending Station	Lane To Be Resurfaced	Length (Ft.)	Starting Width (Ft.)	Ending Width (Ft.)	Bituminous Materials - Primecoat (Tons)	Aggregate - Primecoat (Tons)	Polymerized HMA Surface Course - Mix 01, W-90 (Tons)
NB	206+75	207+35	C & G Flag	60	2	2	0.004	0.020	1.8
EB	30+65	31+19	C & G Flag	54	2	2	0.004	0.018	1.7
EB	31+89	32+85	C & G Flag	96	2	2	0.007	0.032	2.9
Totals -							0.015	0.1	6.4
Grand Total -							1.0	3.2	

AGGREGATE SHOULDERS, TYPE B

Direction of Travel	Starting Station	Ending Station	Length (Ft.)	Width (Ft.)	Average Depth (Inches)	Aggregate Shoulders Type A (Tons)
WB	33+75	36+02	227	4	6.5	38

REVISIONS	
NAME	DATE

ILLINOIS DEPARTMENT OF TRANSPORTATION SCHEDULES OF QUANTITIES

FAP ROUTE 582
SECTION 6-31
MADISON COUNTY

DRAWN BY:

PLOT DATE: 5/3/2007

PLAN NO. _____ DATE _____
 CHECKED BY _____
 ALIGNED CHECKED BY _____
 CADD FILE NAME _____

#DATE##
 5/3/2007
 REF

Raised Pavement Markers						
Station		Notes or Direction	Complete Unit Removal and Replacement			
			Removal (Each)	One-Way White (Each)	One-Way Amber (Each)	Two-Way Amber (Each)
From	To					
Chain of Rocks Road						
30+64	32+50	Westbound Lane Line	5	5		
30+64	36+52	Centerline and Gore Area	25		16	9
33+90	35+25	Eastbound Lane Line		4		
IL111 - Northbound & Southbound						
204+85	207+35	Northbound - Left Turn Lane Line	7	7		
204+00	207+35	Northbound - Lane Line	6	6		
208+31	210+46	SB - Left Turn Lane Line	7	7		
208+31	213+44	Southbound - Lane Lines	6	6		
Totals -			56	35	16	9

* Reflectors removed and replaced due to Traffic Control Conflict.

Thermoplastic Pavement Marking Schedule							Short-Term Pavement Marking Tape	Pavement Marking Removal	
Station		Notes or Direction	Single White - 4"	Single Yellow-4"	Skip-Dash White - 4"	Single White - 24"	Symbols White	Lin. Ft.	Sq. Ft.
From	To		Lin. Ft.	Lin. Ft.	Lin. Ft.	Lin. Ft.	Sq. Ft.	Lin. Ft.	Sq. Ft.
Northbound & Southbound IL111									
204+85	207+35	Lane Line for Left Turn Lane	250						
208+31		Stop Bar				44		78	26
208+08	213+44	Left Edge of Pavement		544				120	40
208+00	213+44	Right Edge of Pavement & Lane Lines	544		140				
208+31	210+46	Lane Line for Left Turn Lane	215				47	86	29
Totals -			1009	544	140	44	47	284	95
Grand Total for 4" Line Markings -			1693.0						

Epoxy Pavement Marking Schedule								Short-Term Pavement Marking Tape	Pavement Marking Removal	
Station		Notes or Direction	Single White - 4"	Skip-Dash White - 4"	Double Yellow - 4"	Diagonal * Yellow 12"	Single White - 24"	Symbols White	Lin. Ft.	Sq. Ft.
From	To		Lin. Ft.	Lin. Ft.	Lin. Ft.	Lin. Ft.	Lin. Ft.	Sq. Ft.	Lin. Ft.	Sq. Ft.
Chain of Rocks Road										
30+64		Stop Bar						32	128	43
30+60	31+25	WB Edge of Pavement	65							
31+83	33+00	WB Edge of Pavement	117							
33+75	36+52	WB Edge of Pavement	277							
30+64	32+50	Lane Line	186				47	60	20	
32+50	34+50	Left Turn Lane Taper		50				48	16	
30+60	36+52	EB Centerline			592			90	30	
32+50	36+40	Centerline Gore Area (Addition to Centerline)			390	85		90	30	
30+60	32+85	EB Edge of Pavement	225							
32+85	33+90	EB Right Turn Lane Taper		26				50	17	
33+90	35+25	EB Right Turn Lane - Lane Line	135					50	17	
33+90	35+25	EB Right Turn Lane - Edge of Pavement	135				31			
Northbound IL111										
202+95	207+35	Skip Dash		110				48	16	
202+95	207+35	Edge of Pavement	440					96	32	
207+35		Stop Bar					33	66	22	
Totals -			1580	186	982	85	65	78	726	242
Grand Total for 4" Line Markings -			2748.0							

REVISIONS	
NAME	DATE

ILLINOIS DEPARTMENT OF TRANSPORTATION
SCHEDULES OF QUANTITIES

FAP ROUTE 582
SECTION 6-31
MADISON COUNTY

DRAWN BY: _____

PLOT DATE: 4/21/2007

PLAN NO. _____
DATE _____
BY _____
CHECKED _____
DATE _____
PRINTED _____
FILE NAME _____
NO. OF SHEETS _____
NO. OF SHEETS USED _____
DATE FILED _____

4/21/2007
4/27/2007
c:\p\projects\and01907\plan\p\p01907.dgn
REF
DEF

226
2007
10/21

F.A.P. RTE.	SECTION	COUNTY	TOTAL SHEETS	SHEET NO.
582	6-31	MADISON	18	7
STA. _____		TO STA. _____		
FED. ROAD DIST. NO.	ILLINOIS	FED. AID PROJECT		

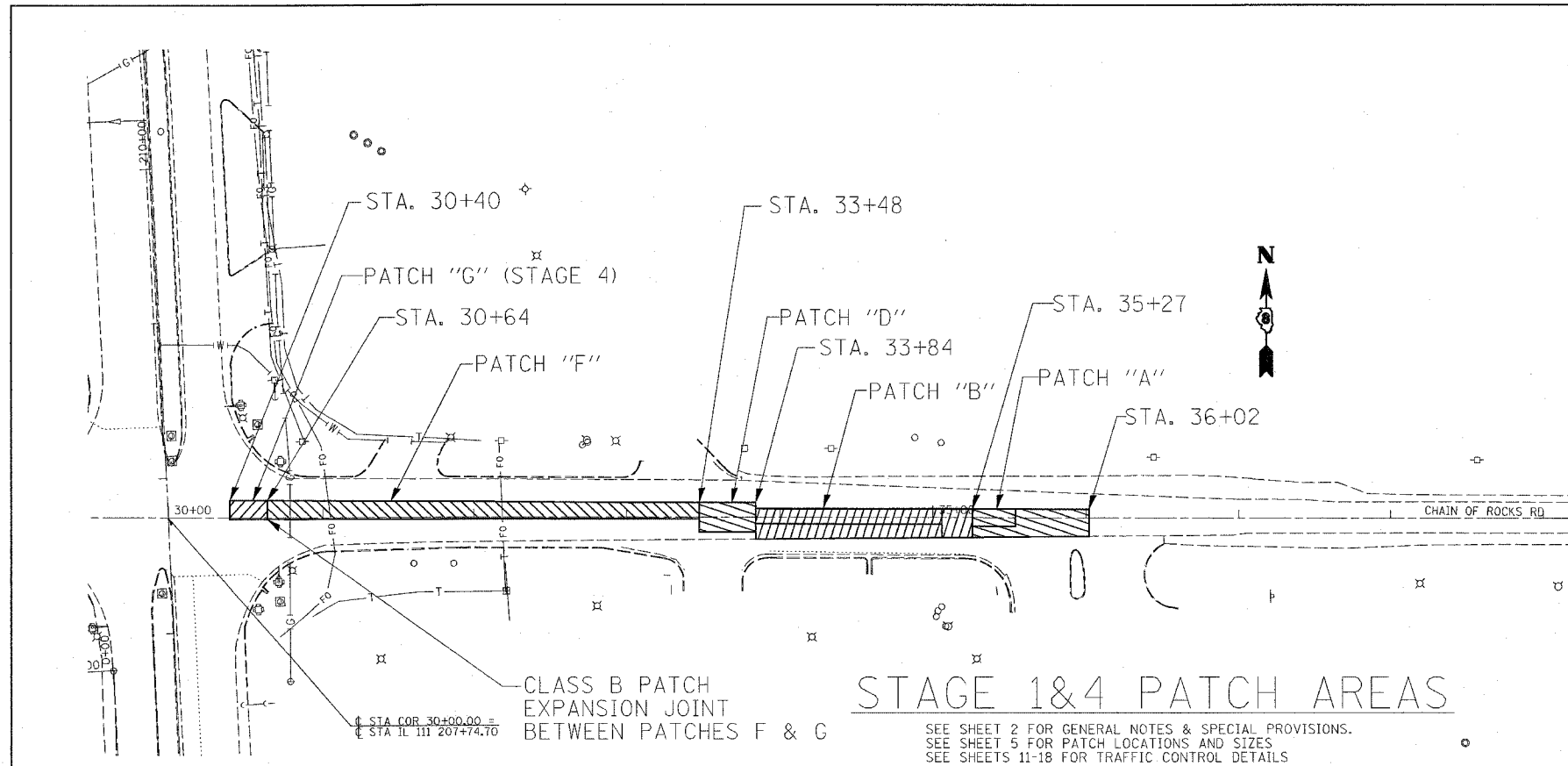

STAGE 1 & 4 PATCH AREAS

SEE SHEET 2 FOR GENERAL NOTES & SPECIAL PROVISIONS.
SEE SHEET 5 FOR PATCH LOCATIONS AND SIZES
SEE SHEETS 11-18 FOR TRAFFIC CONTROL DETAILS

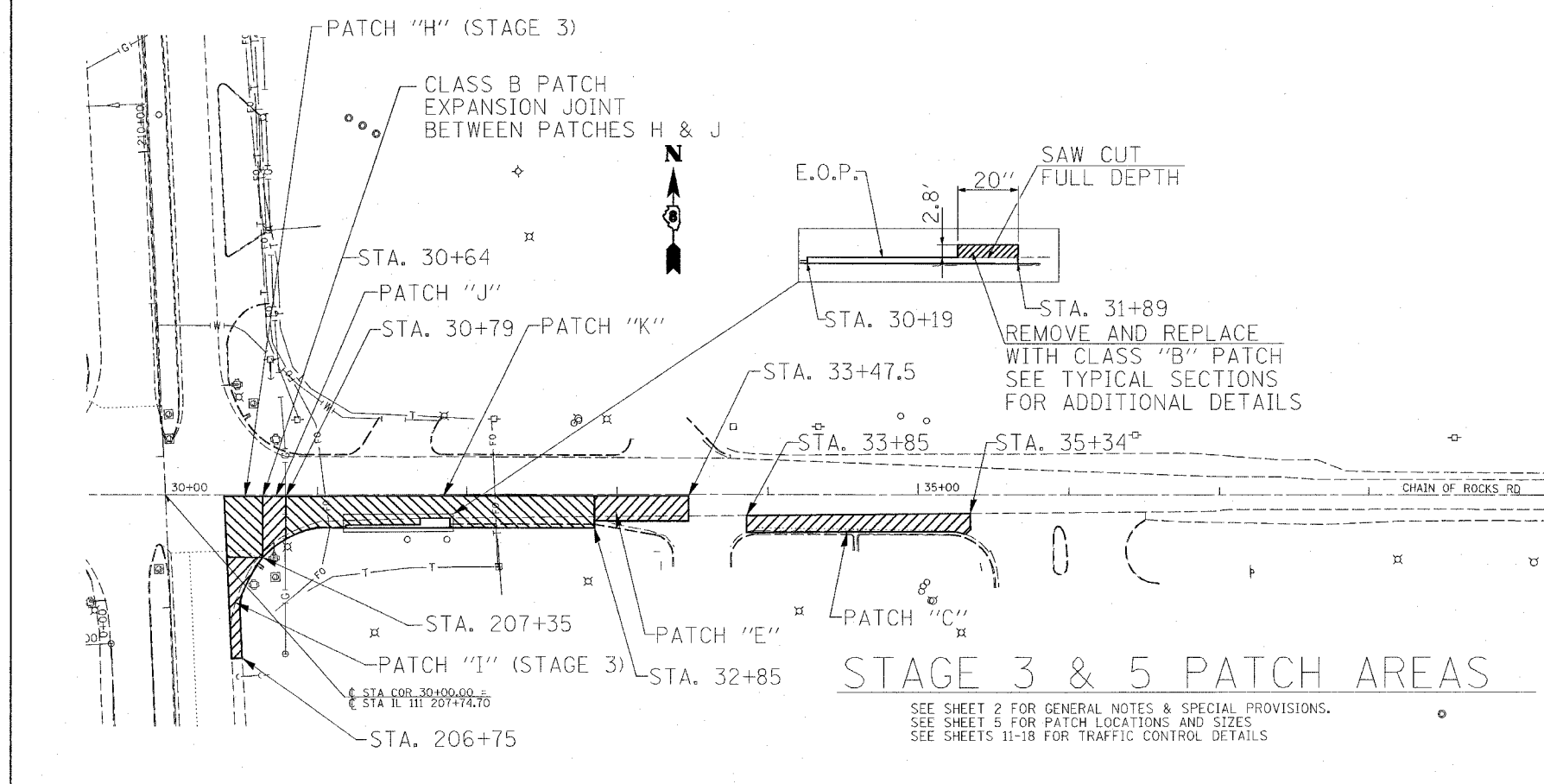

STAGE 3 & 5 PATCH AREAS

SEE SHEET 2 FOR GENERAL NOTES & SPECIAL PROVISIONS.
SEE SHEET 5 FOR PATCH LOCATIONS AND SIZES
SEE SHEETS 11-18 FOR TRAFFIC CONTROL DETAILS

PLOT DATE = 5/1/2007
FILE NAME = c:\nrc\projects\76b02\plan\plan\plan\76b02.dgn
PLOT SCALE = 50.0000 / IN.
REFERENCE = #REF#

REVISIONS	
NAME	DATE

ILLINOIS DEPARTMENT OF TRANSPORTATION
PLAN VIEW
STAGES 1,3,4,5

FAP ROUTE 582
SECTION 6-31
MADISON COUNTY

SCALE: VERT. _____
HORIZ. _____

DRAWN BY _____
CHECKED BY _____

F.A.P. RTE.	SECTION	COUNTY	TOTAL SHEETS	SHEET NO.
582	6-3I	MADISON	18	8
STA. _____		TO STA. _____		
FED. ROAD DIST. NO. _____		ILLINOIS FED. AID PROJECT		

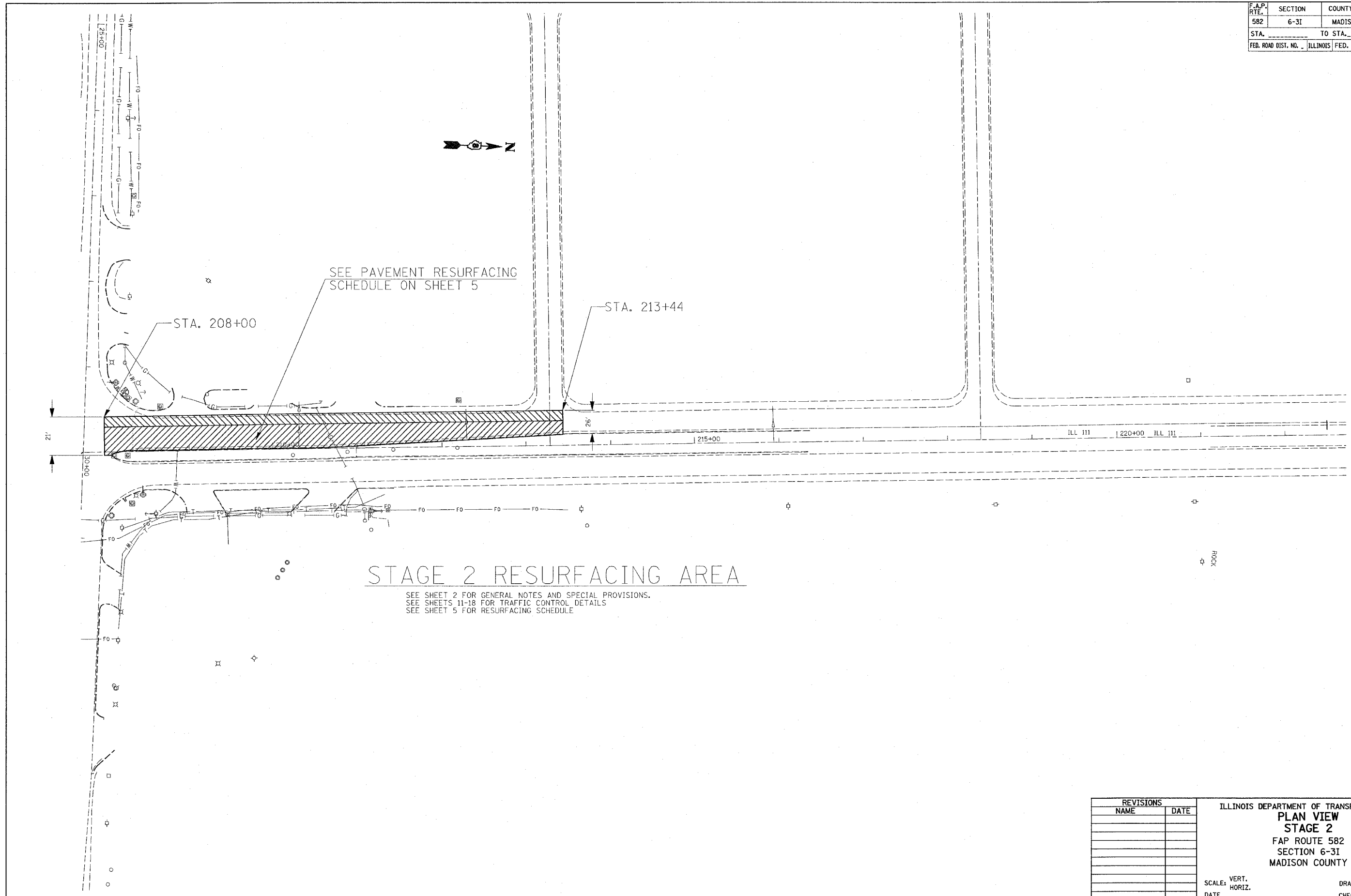

STAGE 2 RESURFACING AREA

SEE SHEET 2 FOR GENERAL NOTES AND SPECIAL PROVISIONS.
 SEE SHEETS 11-18 FOR TRAFFIC CONTROL DETAILS
 SEE SHEET 5 FOR RESURFACING SCHEDULE

REVISIONS	
NAME	DATE

ILLINOIS DEPARTMENT OF TRANSPORTATION
PLAN VIEW
STAGE 2
 FAP ROUTE 582
 SECTION 6-3I
 MADISON COUNTY

SCALE: VERT. _____
 HORIZ. _____
 DATE _____

DRAWN BY _____
 CHECKED BY _____

PLOT DATE = 5/4/2007
 FILE NAME = c:\p\m\m\582\1977\plan\p01907a.dgn
 PLOT NO. = 1977 / IN
 REFERENCE = AREA

SECTION	COUNTY	TOTAL SHEETS	SHEET NO.
6-3I	MADISON	18	9
ROAD DIST. NO. ILLINOIS FED. AID PROJECT			

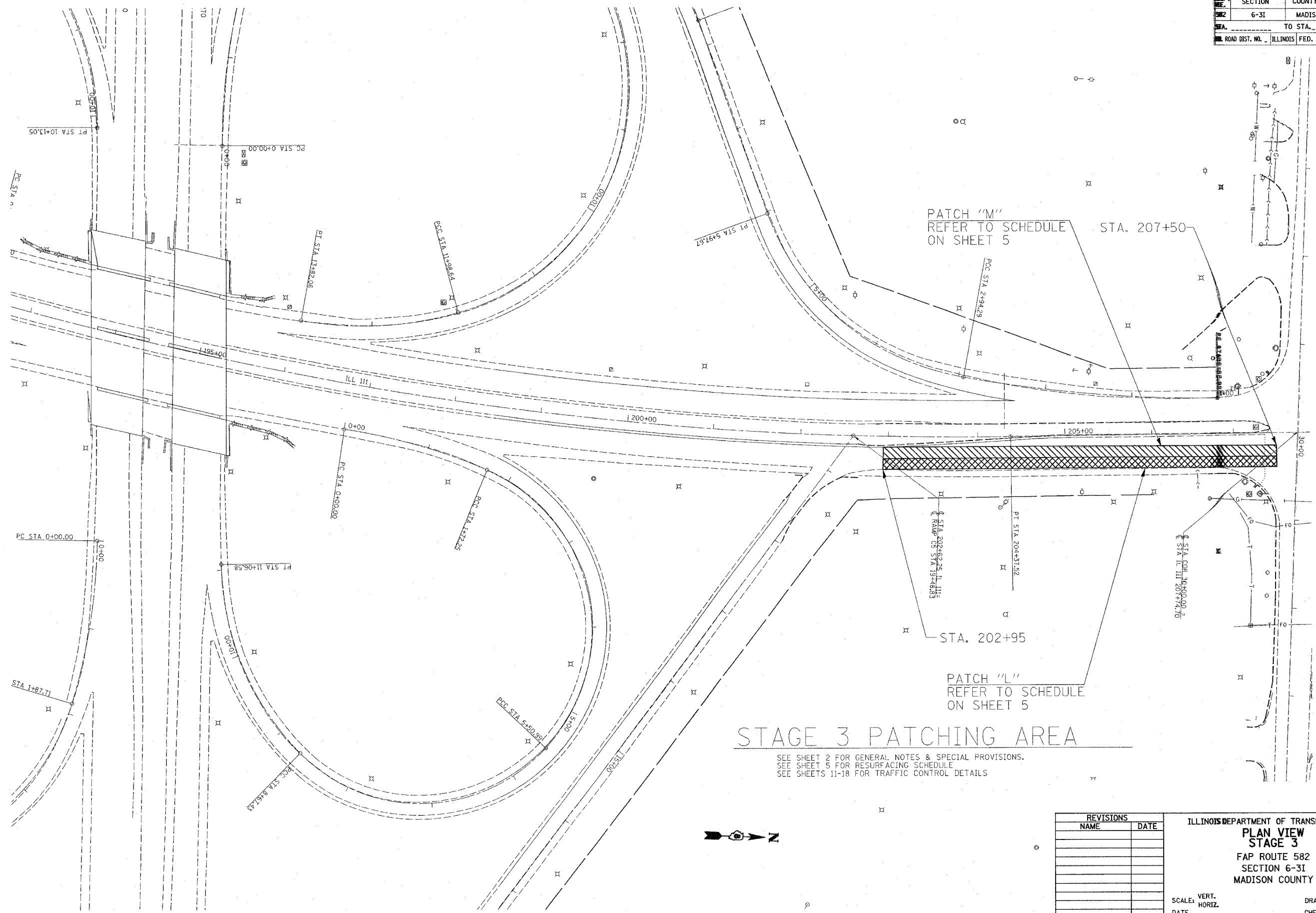

PATCH "M"
REFER TO SCHEDULE
ON SHEET 5

PATCH "L"
REFER TO SCHEDULE
ON SHEET 5

STAGE 3 PATCHING AREA

SEE SHEET 2 FOR GENERAL NOTES & SPECIAL PROVISIONS.
SEE SHEET 5 FOR RESURFACING SCHEDULE
SEE SHEETS 11-18 FOR TRAFFIC CONTROL DETAILS



REVISIONS	
NAME	DATE

ILLINOIS DEPARTMENT OF TRANSPORTATION
**PLAN VIEW
STAGE 3**
FAP ROUTE 582
SECTION 6-3I
MADISON COUNTY

SCALE: VERT. _____
HORIZ. _____
DATE _____ DRAWN BY _____
CHECKED BY _____

PLOT DATE = 6/2/2007
PLOT SCALE = 1/4" = 50.0000' / IN.
REFERENCE = SHEET #

F.A.P. RTE.	SECTION	COUNTY	TOTAL SHEETS	SHEET NO.
582	6-31	MADISON	18	10

STA. _____ TO STA. _____
 FED. ROAD DIST. NO. _____ ILLINOIS FED. AID PROJECT

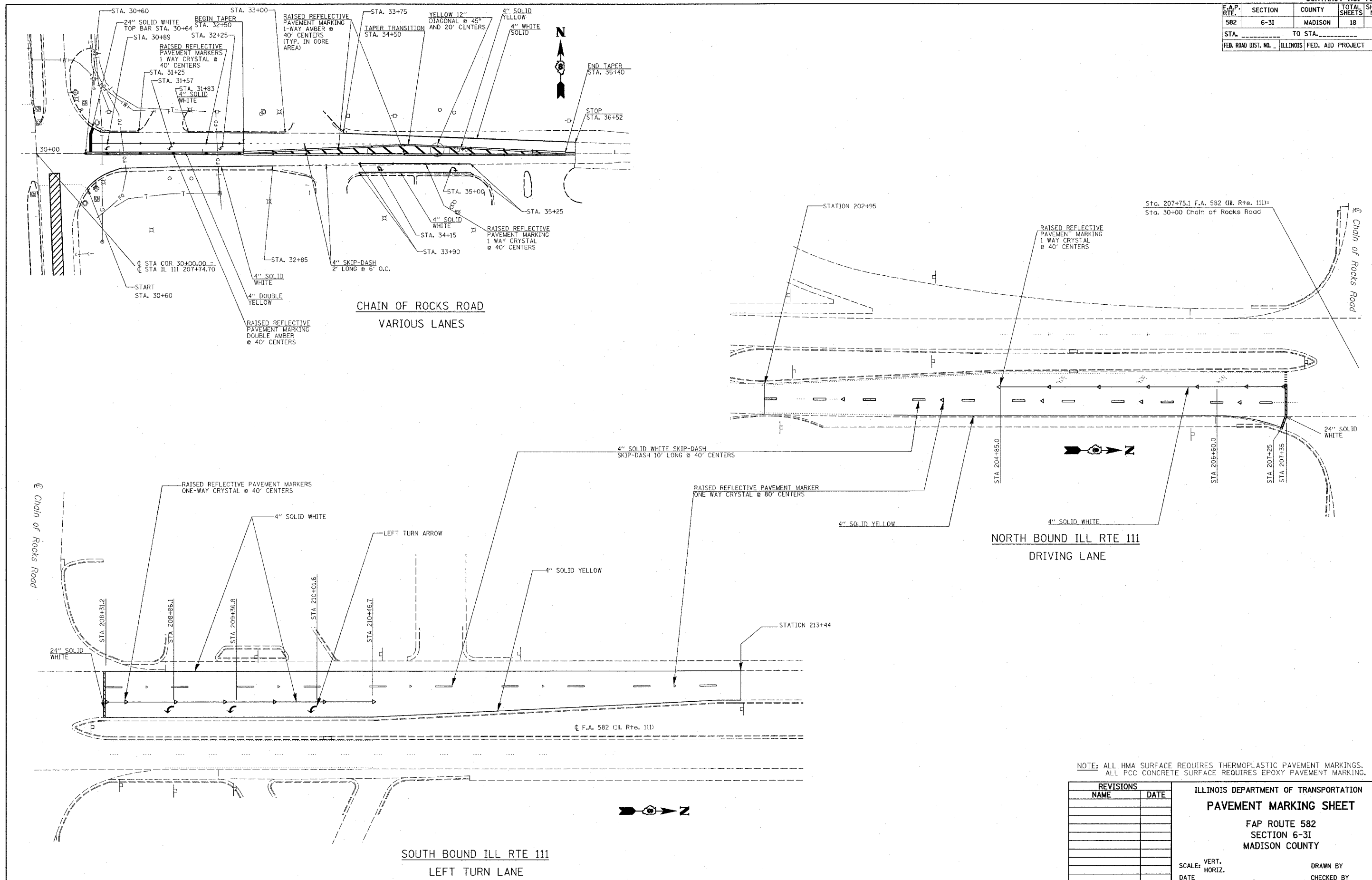

PLOT DATE = 4/27/2007
 FILE NAME = c:\projects\76b02\plan\pmd10107.dgn
 PLOT SCALE = 1" = 40' / IN.
 REFERENCE = BREF

NOTE: ALL HMA SURFACE REQUIRES THERMOPLASTIC PAVEMENT MARKINGS.
 ALL PCC CONCRETE SURFACE REQUIRES EPOXY PAVEMENT MARKING.

REVISIONS	
NAME	DATE

ILLINOIS DEPARTMENT OF TRANSPORTATION
PAVEMENT MARKING SHEET
 FAP ROUTE 582
 SECTION 6-31
 MADISON COUNTY

SCALE: VERT. _____
 HORIZ. _____
 DATE _____

DRAWN BY _____
 CHECKED BY _____

F.A.P. RTE.	SECTION	COUNTY	TOTAL SHEETS	SHEET NO.
582	6-3I	MADISON	18	11
STA. _____		TO STA. _____		
FED. ROAD DIST. NO. _____		ILLINOIS FED. AID PROJECT _____		



END CONSTRUCTION

G20-2a(0)-6024

END WORK ZONE SPEED LIMIT

G20-1103(0)-3660

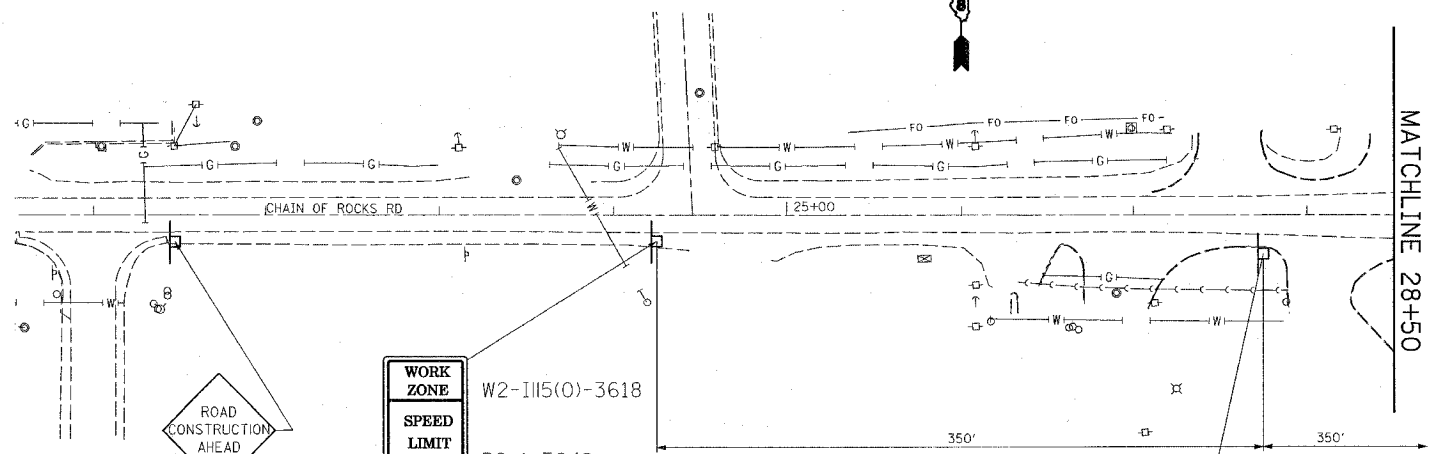

WORK ZONE
SPEED LIMIT
35
BEGINS
XXXX FINE MINIMUM

W2-1115(0)-3618
R2-1-3648
W2-1113(0)-3612
R2-1106-3618

ROAD CONSTRUCTION AHEAD
W20-1(0)-48

FLAGGER
W20-1101-48

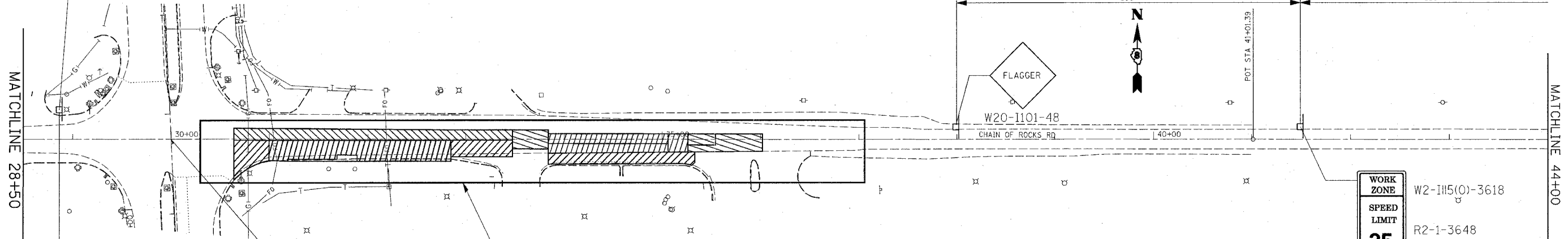

WORK ZONE
SPEED LIMIT
35
BEGINS
XXXX FINE MINIMUM

W2-1115(0)-3618
R2-1-3648
W2-1113(0)-3612
R2-1106-3618

REFER TO SHEET 17 + 18 FOR ADDITIONAL TRAFFIC CONTROL SETUP FOR STAGE 1 & 5 CONSTRUCTION

SYMBOLS

- ↑ ARROW BOARD
- ▨ WORK AREA
- BARRICADE OR DRUM WITH STEADY BURNING MONDIRECTIONAL LIGHT
- I BARRICADE OR DRUM WITHOUT FLASHING LIGHT
- FLAGGER WITH TRAFFIC CONTROL SIGN
- CONE, DRUM OR BARRICADE (CONES FOR DAYTIME USE ONLY)
- ▭ SIGN ON PORTABLE OR PERMANENT SUPPORT

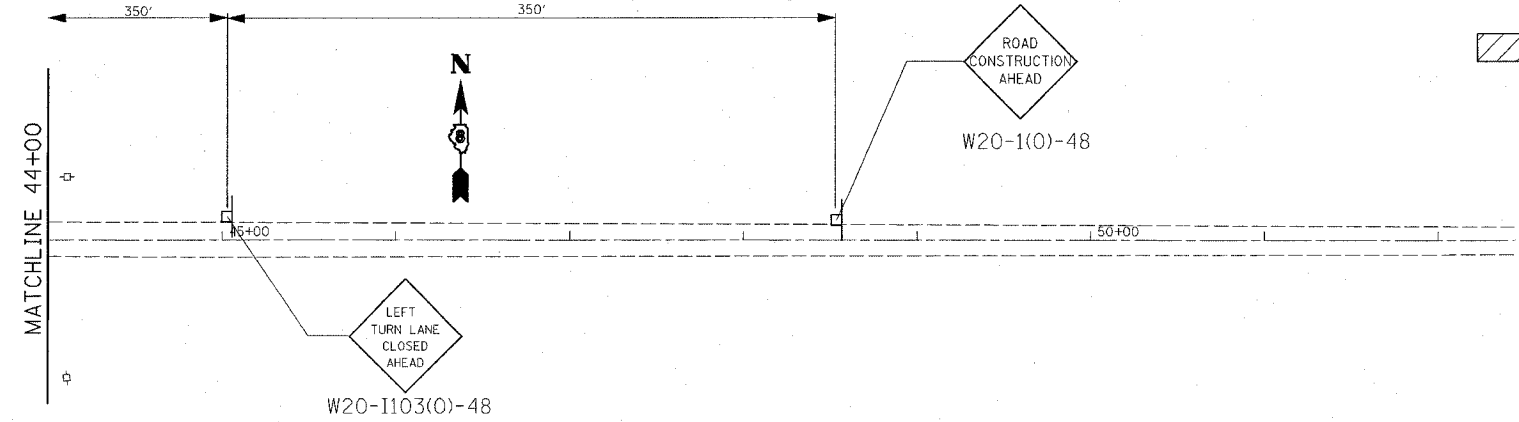

LEFT TURN LANE CLOSED AHEAD
W20-1103(0)-48

REVISIONS	
NAME	DATE

ILLINOIS DEPARTMENT OF TRANSPORTATION
TRAFFIC CONTROL

FAP ROUTE 582
SECTION 6-3I
MADISON COUNTY

SCALE: VERT. _____
HORIZ. _____

DATE _____ DRAWN BY _____
CHECKED BY _____



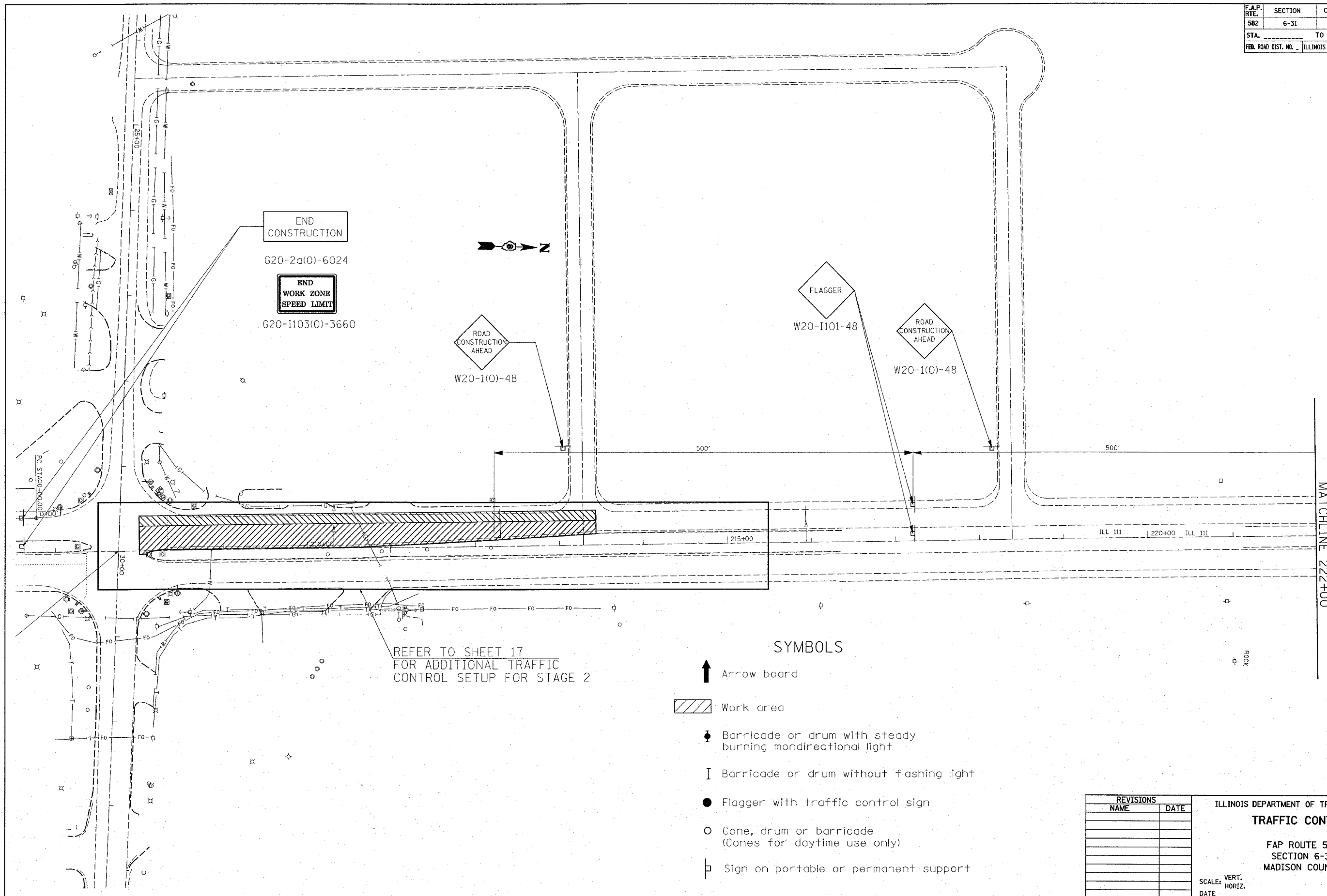

PLOT DATE = 1/18/2007
FILE NAME = C:\Users\jgibson\Documents\76B02\76B02.dgn
PLOT SCALE = 50.0000 / 1" = 100'
REFERENCE = #REF#

CONTRACT NO. 76B02				
F.A.P. RTE.	SECTION	COUNTY	TOTAL SHEETS	SHEET NO.
582	6-3I	MADISON	18	12
STA.		TO STA.		
FED. ROAD DIST. NO.		ILLINOIS	FED. AID PROJECT	

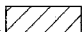

REFER TO SHEET 17
FOR ADDITIONAL TRAFFIC
CONTROL SETUP FOR STAGE 2

SYMBOLS

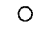
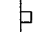
-  Arrow board
-  Work area
-  Barricade or drum with steady burning monidirectional light
-  Barricade or drum without flashing light
-  Flagger with traffic control sign
-  Cone, drum or barricade (Cones for daytime use only)
-  Sign on portable or permanent support

REVISIONS	
NAME	DATE

ILLINOIS DEPARTMENT OF TRANSPORTATION
TRAFFIC CONTROL

FAP ROUTE 582
SECTION 6-3I
MADISON COUNTY

SCALE: VERT. _____
 HORIZ. _____
DATE _____

DRAWN BY _____
CHECKED BY _____

PLOT DATE = 4/23/2007
PLOT SCALE = 50,000 / IN.
REFERENCE = #REF#

F.A.P. RTE.	SECTION	COUNTY	TOTAL SHEETS	SHEET NO.
582	6-3I	MADISON	18	13

STA.	TO STA.
FED. ROAD DIST. NO.	ILLINOIS FED. AID PROJECT

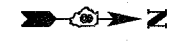
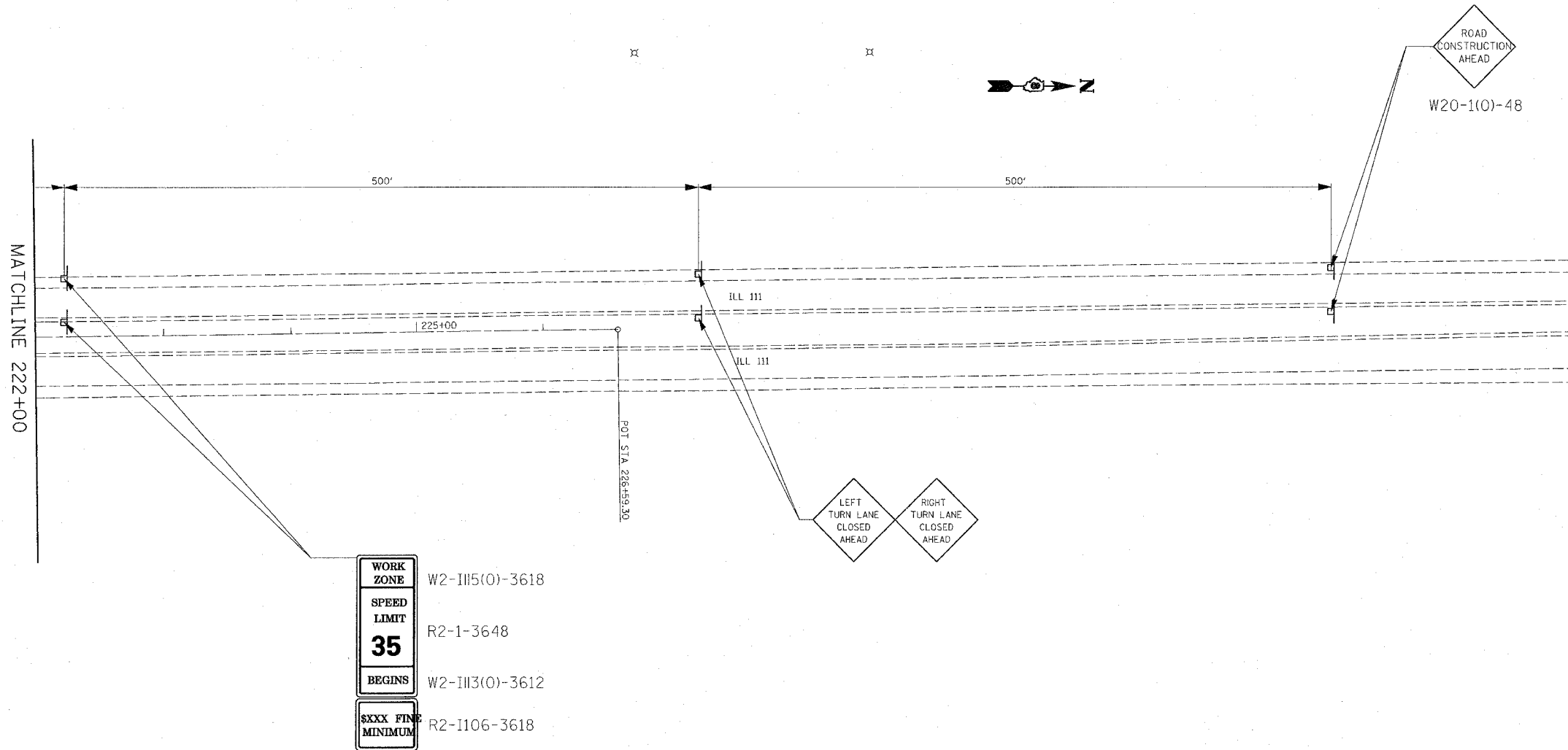

PLOT DATE = 4/27/2007
 FILE NAME = c:\p1\mca\481907\plan\p1\01907.dgn
 PLOT SCALE = 50,000 / IN.
 REFERENCE = #REF#

REVISIONS	
NAME	DATE





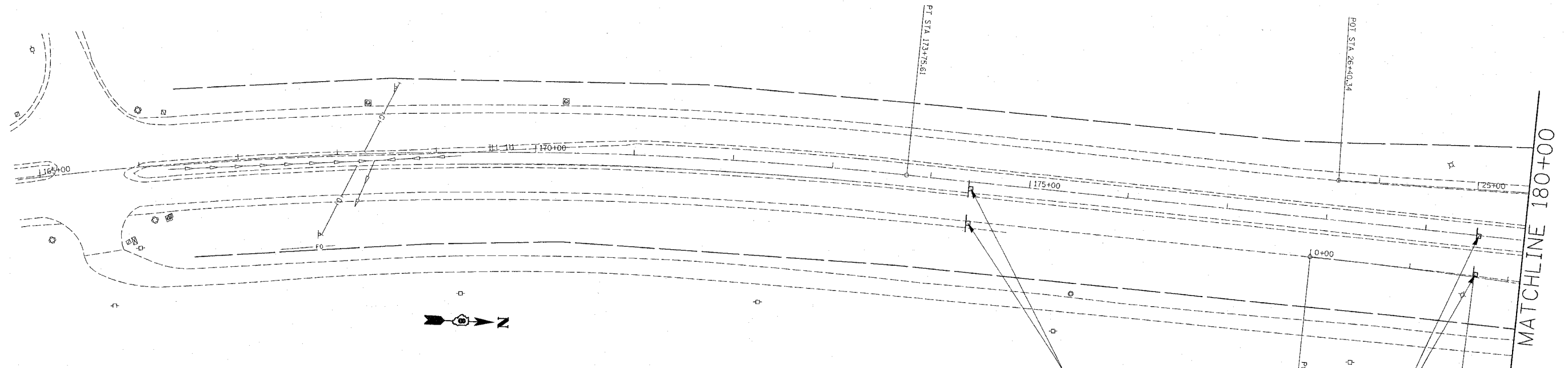

ILLINOIS DEPARTMENT OF TRANSPORTATION
TRAFFIC CONTROL
 FAP ROUTE 582
 SECTION 6-3I
 MADISON COUNTY
 SCALE: VERT. _____
 HORIZ. _____
 DATE _____
 DRAWN BY _____
 CHECKED BY _____

F.A.P. RTE.	SECTION	COUNTY	TOTAL SHEETS	SHEET NO.
582	6-31	MADISON	18	14
STA.		TO STA.		
FED. ROAD DIST. NO.		ILLINOIS FED. AID PROJECT		

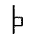

- ① REFER TO SIGN SPACING TABLE FOR DISTANCE.
- ② REQUIRED FOR SPEED > 40 MPH.
- ③ CONES AT 8 M (25') CENTERS FOR 75 M (250'). ADDITIONAL CONES MAY BE PLACED AT 15 M (50') CENTERS. WHEN DRUMS OR TYPE I OR TYPE II BARRICADES ARE USED, THE INTERVAL BETWEEN DEVICES MAY BE DOUBLED.
- ④ USE FLAGGER SIGN ONLY WHEN FLAGGER IS PRESENT.
- ⑤ OMIT THIS SIGN WHEN MEDIAN IS LESS THAN 3 M (10') OR FOR BI-DIRECTIONAL TURN LANES.

SYMBOLS

-  Work area
-  Cone, drum or barricade
-  Sign on portable or permanent support
-  Arrow board
-  Barricade or drum with flashing light
-  Flagger with traffic control sign

ROAD CONSTRUCTION AHEAD
W20-110)-48

LEFT LANE CLOSED AHEAD
RIGHT LANE CLOSED AHEAD

REVISIONS	
NAME	DATE

ILLINOIS DEPARTMENT OF TRANSPORTATION
TRAFFIC CONTROL

FAP ROUTE 582
SECTION 6-31
MADISON COUNTY

SCALE: VERT. _____
 HORIZ. _____
DATE _____

DRAWN BY _____
CHECKED BY _____

PLOT DATE = 4/30/2007
FILE NAME = c:\projects\481197\plan\481197.txdgn
PLOT SCALE = 50.0000' / IN.
REFERENCE = #REF#

F.A.P. RTE.	SECTION	COUNTY	TOTAL SHEETS	SHEET NO.
582	6-31	MADISON	18	15
STA. _____		TO STA. _____		
FED. ROAD DIST. NO. _____		ILLINOIS FED. AID PROJECT		

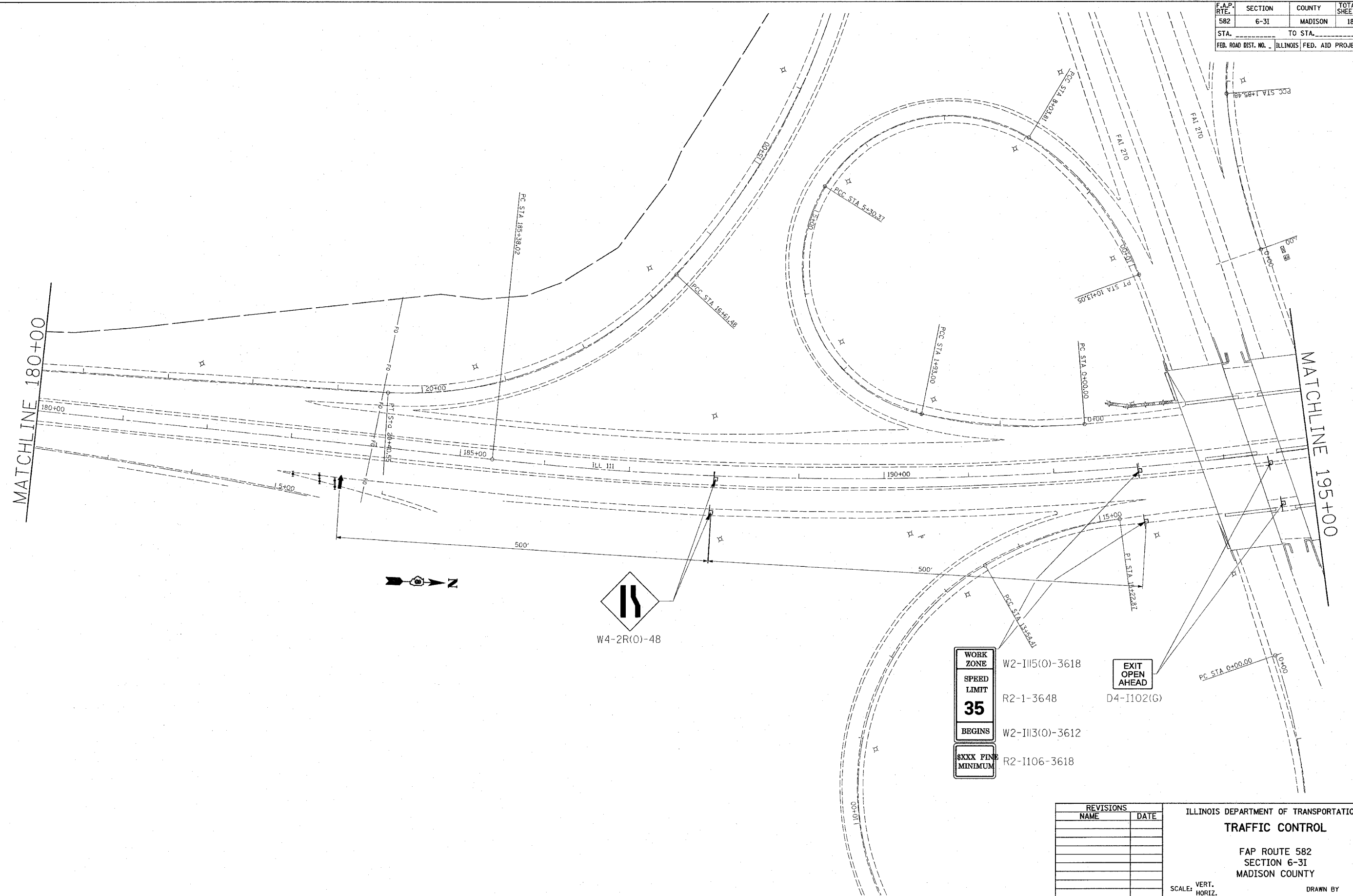

W4-2R(0)-48

WORK ZONE	W2-II15(0)-3618
SPEED LIMIT	R2-1-3648
35	
BEGINS	W2-II13(0)-3612
XXXX PINE MINIMUM	R2-II06-3618

EXIT OPEN AHEAD
D4-II02(G)

REVISIONS	
NAME	DATE

ILLINOIS DEPARTMENT OF TRANSPORTATION
TRAFFIC CONTROL
 FAP ROUTE 582
 SECTION 6-31
 MADISON COUNTY
 SCALE: VERT. _____
 DATE _____
 DRAWN BY _____
 CHECKED BY _____

PLOT DATE = 4/29/2007
 FILE NAME = c:\p0000000\582\1107\plan\plan01907a.dgn
 PLOT SCALE = 5/8"=1'-0"
 REFERENCE = REF#

F.A.P. RTE.	SECTION	COUNTY	TOTAL SHEETS	SHEET NO.
582	6-3I	MADISON	18	16
STA. _____		TO STA. _____		
FED. ROAD DIST. NO. _____		ILLINOIS FED. AID PROJECT		

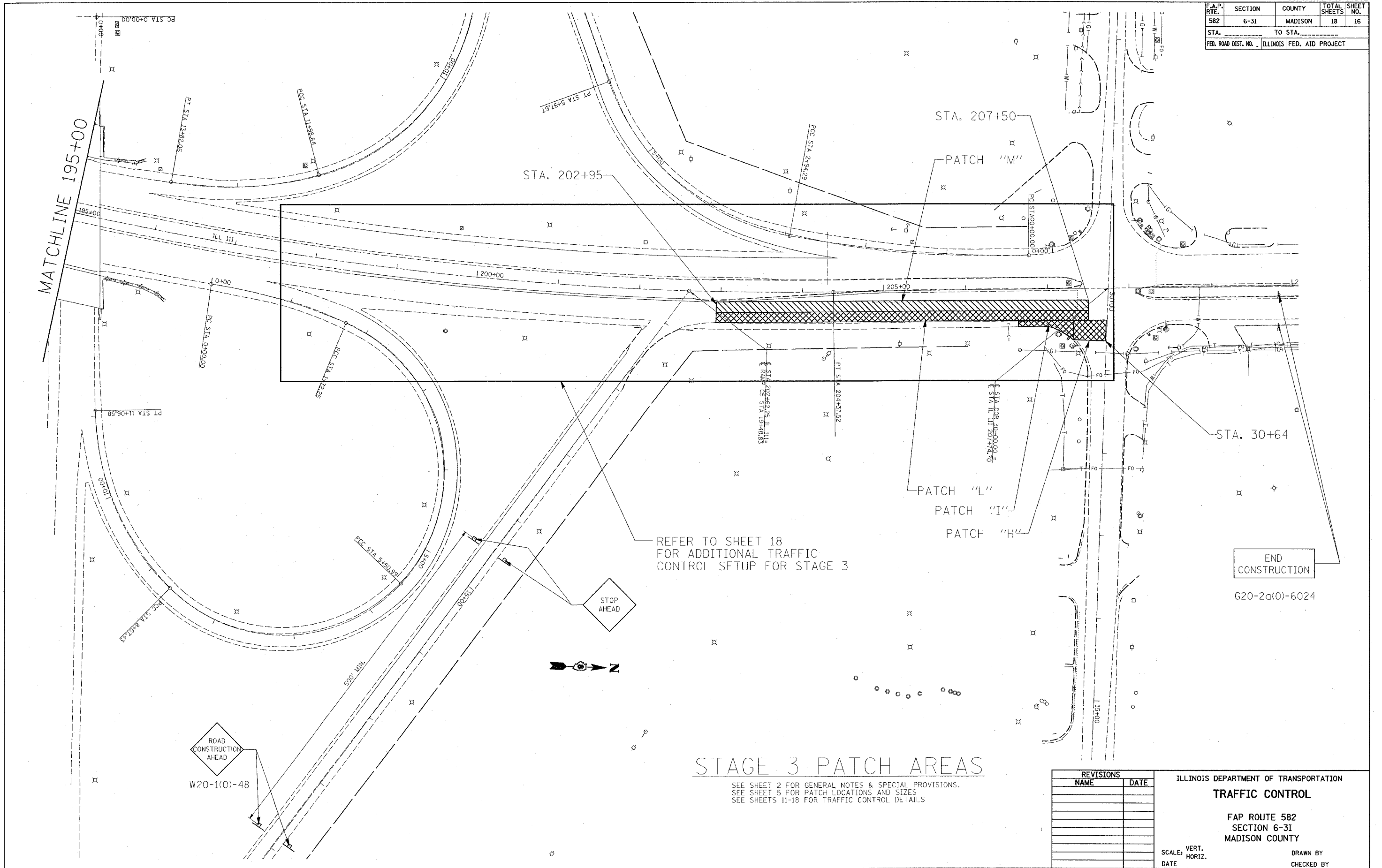

SEE SHEET 2 FOR GENERAL NOTES & SPECIAL PROVISIONS.
 SEE SHEET 5 FOR PATCH LOCATIONS AND SIZES
 SEE SHEETS 11-18 FOR TRAFFIC CONTROL DETAILS

REVISIONS	
NAME	DATE

ILLINOIS DEPARTMENT OF TRANSPORTATION
TRAFFIC CONTROL

FAP ROUTE 582
 SECTION 6-3I
 MADISON COUNTY

SCALE: VERT. _____
 HORIZ. _____

DATE _____

DRAWN BY _____
 CHECKED BY _____

END CONSTRUCTION
 G20-2a(0)-6024

PLOT DATE = 5/3/2007
 PLOT SCALE = 50,000 / IN.
 REFERENCE = #REF#

ROAD CONSTRUCTION AHEAD
 W20-1(0)-48

STOP AHEAD

F.A.P. RTE.	SECTION	COUNTY	TOTAL SHEETS	SHEET NO.
582	6-31	MADISON	18	17
STA. _____		TO STA. _____		
FED. ROAD DIST. NO. _____		ILLINOIS FED. AID PROJECT		

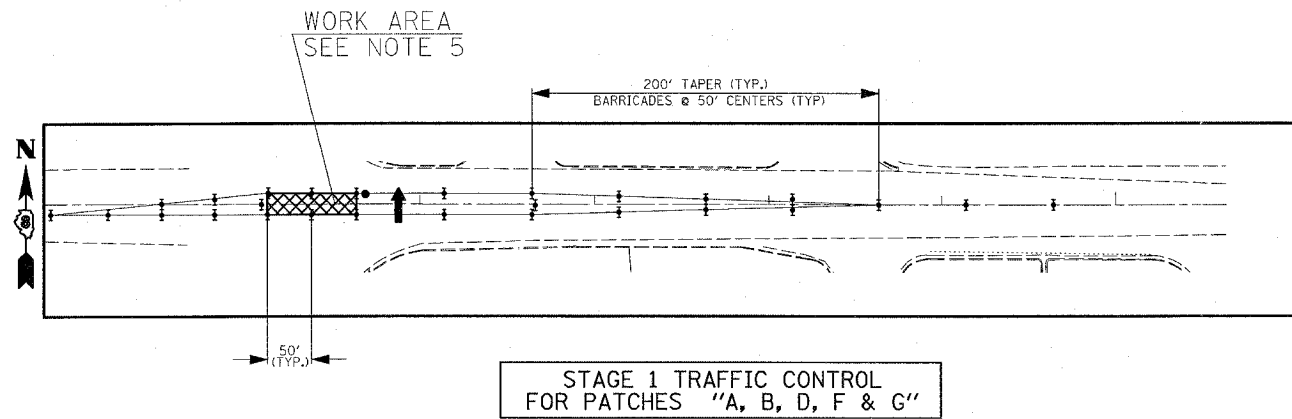

NOTES

- ① SEE SHEET 2 FOR TRAFFIC CONTROL NOTES
- ② TOTAL LENGTH OF LANE CLOSURE TAPERS = 200'
- ③ VERTICAL BARRICADES SHALL BE AT 50' CENTERS (TYP.)
- ④ FLAGGER REQUIRED DURING ALL HOURS OF LANE CLOSURES.
- ⑤ STAGE 1 - AS WORK APPROACHES INTERSECTION, TAPER LENGTH ON WEST END WILL DECREASE.

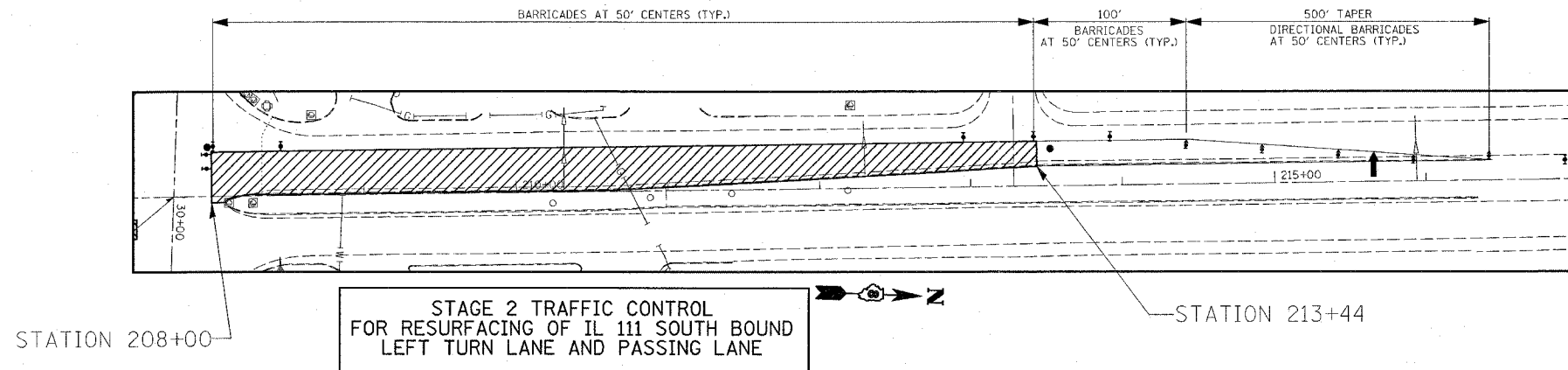

SYMBOLS

- ↑ ARROW BOARD
- ▨ WORK AREA-LENGTH TO BE DETERMINED BY CONTRACTOR AND APPROVED BY RESIDENT ENGINEER
- BARRICADE OR DRUM WITH STEADY BURNING MONDIRECTIONAL LIGHT
- I BARRICADE OR DRUM WITHOUT FLASHING LIGHT
- FLAGGER WITH TRAFFIC CONTROL SIGN
- CONE, DRUM OR BARRICADE (CONES FOR DAYTIME USE ONLY)
- ⊥ SIGN ON PORTABLE OR PERMANENT SUPPORT
- ↑ DIRECTION INDICATOR BARRICADE WITH STEADY BURN MONODIRECTIONAL LIGHT

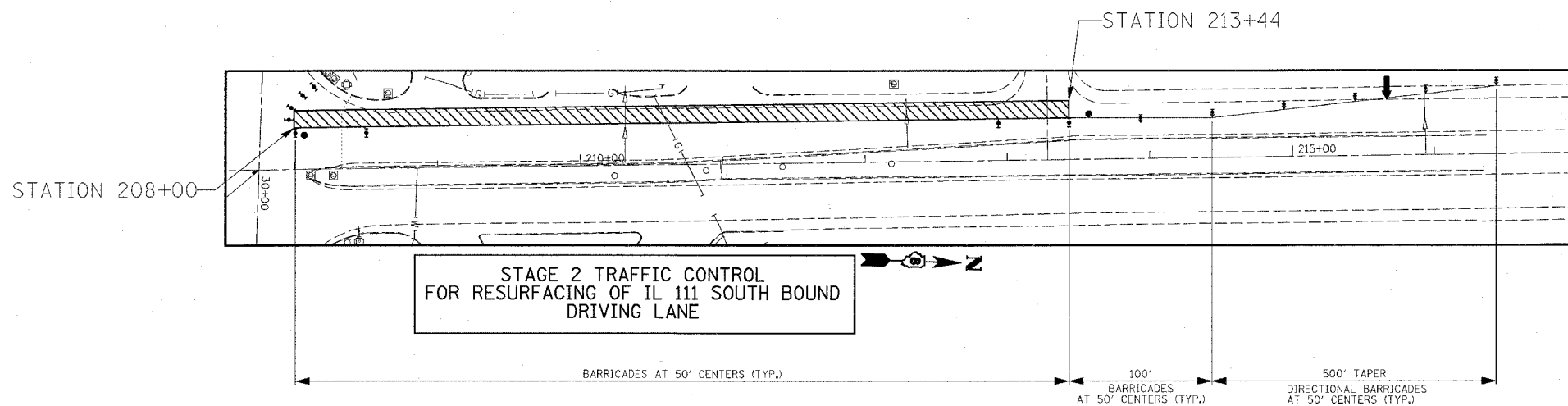

REVISIONS		ILLINOIS DEPARTMENT OF TRANSPORTATION TRAFFIC CONTROL
NAME	DATE	
		FAP ROUTE 582 SECTION 6-31 MADISON COUNTY
SCALE:	VERT. HORIZ.	DRAWN BY
DATE		CHECKED BY

PLOT DATE = 5/2/2007
FILE NAME = c:\projects\76b02\plan\tdr11102.dgn
PLOT SCALE = 50,000 / IN.
REFERENCE = #REF#

F.A.P. RTE.	SECTION	COUNTY	TOTAL SHEETS	SHEET NO.
582	6-31	MADISON	18	18
STA. _____ TO STA. _____		FED. ROAD DIST. NO. _____ ILLINOIS FED. AID PROJECT		

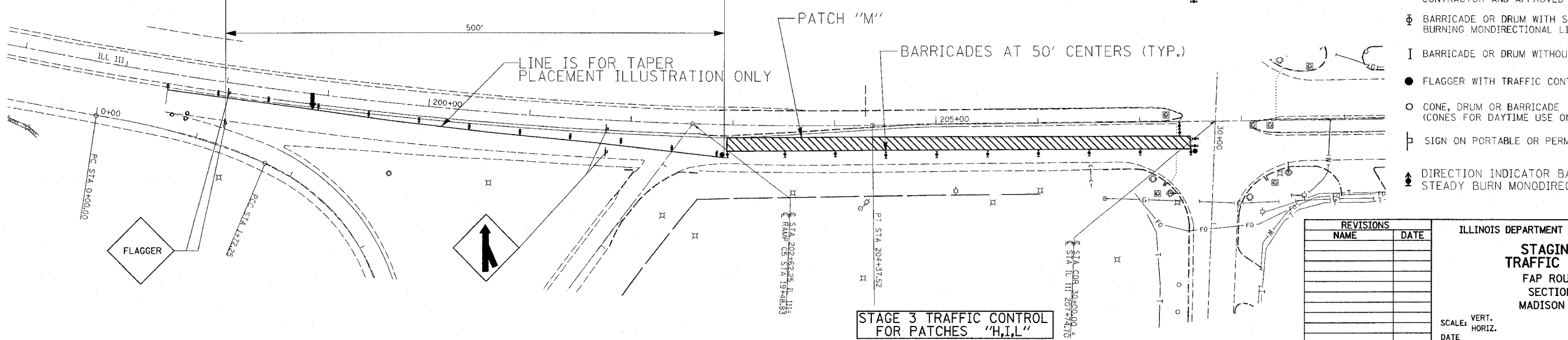
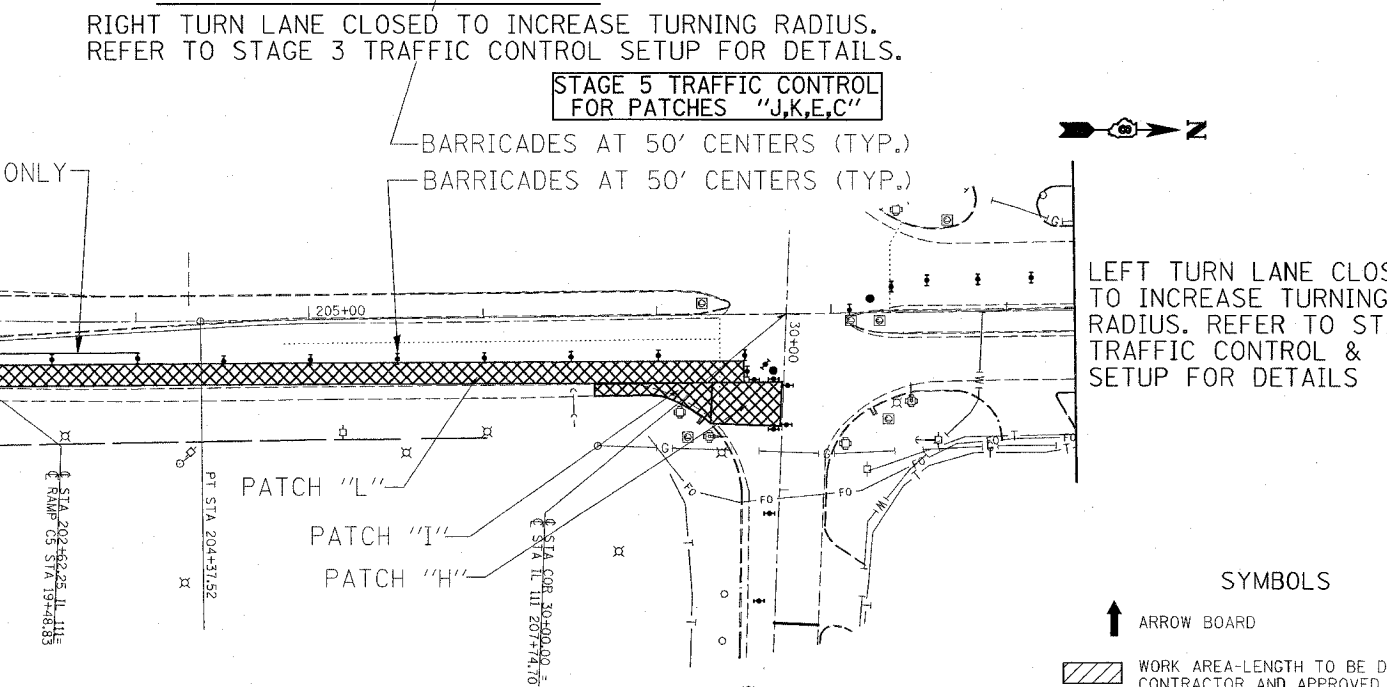
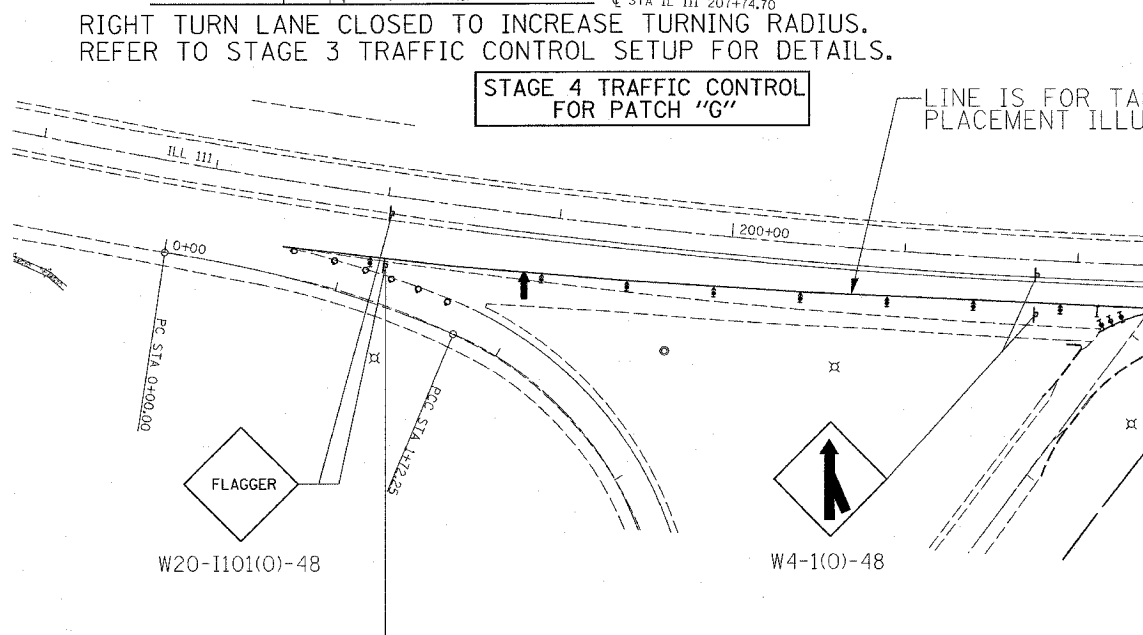
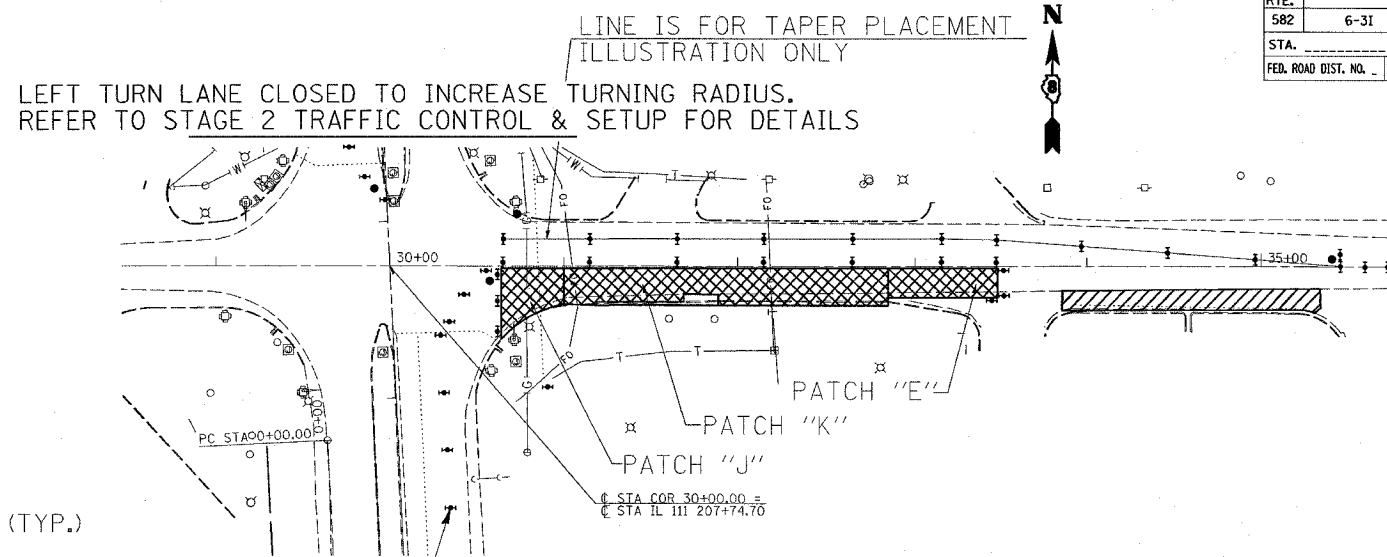
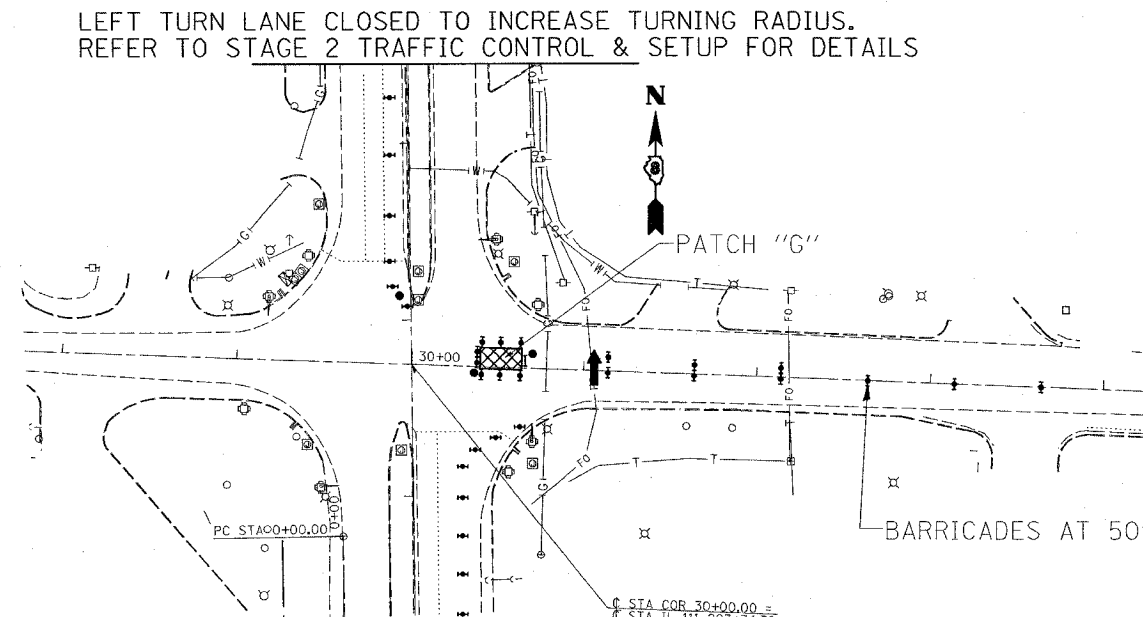

- SYMBOLS**
- ↑ ARROW BOARD
 - ▨ WORK AREA-LENGTH TO BE DETERMINED BY CONTRACTOR AND APPROVED BY RESIDENT ENGINEER
 - ⊕ BARRICADE OR DRUM WITH STEADY BURNING MONODIRECTIONAL LIGHT
 - I BARRICADE OR DRUM WITHOUT FLASHING LIGHT
 - FLAGGER WITH TRAFFIC CONTROL SIGN
 - CONE, DRUM OR BARRICADE (CONES FOR DAYTIME USE ONLY)
 - ⊥ SIGN ON PORTABLE OR PERMANENT SUPPORT
 - ↑ DIRECTION INDICATOR BARRICADE WITH STEADY BURN MONODIRECTIONAL LIGHT

REVISIONS	
NAME	DATE

ILLINOIS DEPARTMENT OF TRANSPORTATION
STAGING AND TRAFFIC CONTROL
 FAP ROUTE 582
 SECTION 6-31
 MADISON COUNTY

SCALE: VERT. _____
 DATE: _____ HORIZ. _____

DRAWN BY _____
 CHECKED BY _____

PLOT DATE = 5/4/2007
 PLOT SCALE = 50.0000' / IN.
 REFERENCE = *REF*