

CONTRACT NO. 83737

F.A.U. RTE.	SECTION	COUNTY	TOTAL SHEETS	SHEET NO.
2509	96-00094-01-WR	KANE	187	29
STA. _____ TO STA. _____		FED. ROAD DIST. NO. _____ ILLINOIS FED. AID PROJECT _____		

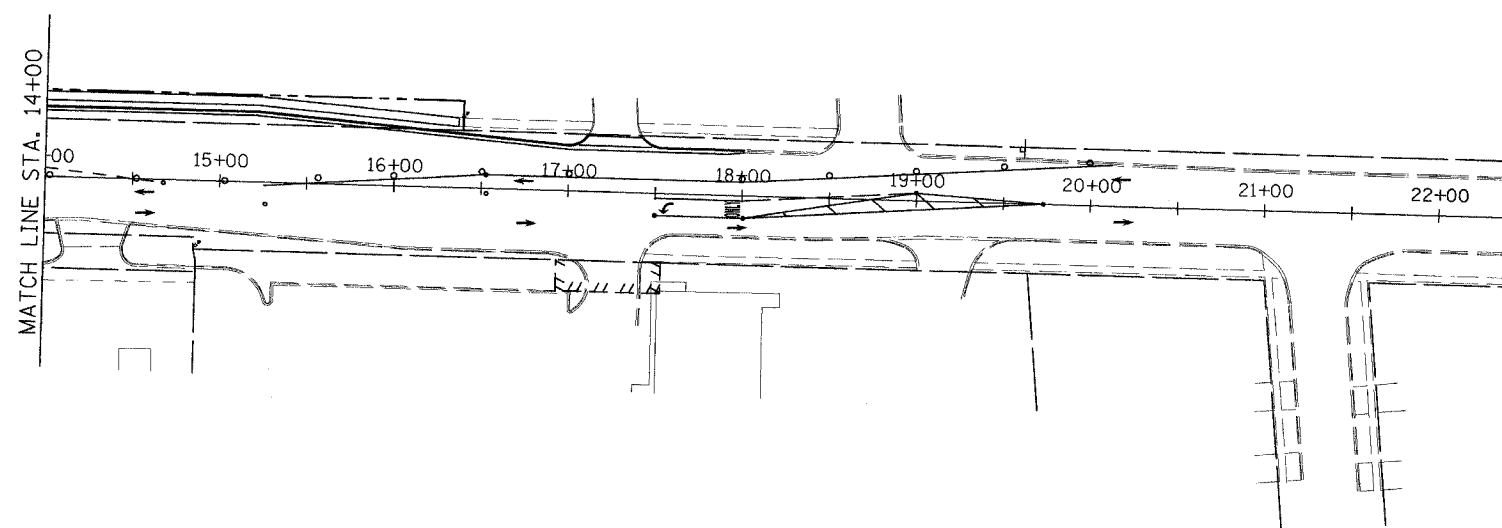

SEE STAGE I SIGN LOCATIONS.

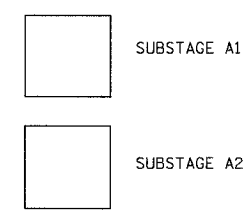

ALL LANES ARE 11 FT WIDTH UNLESS NOTED OTHERWISE.

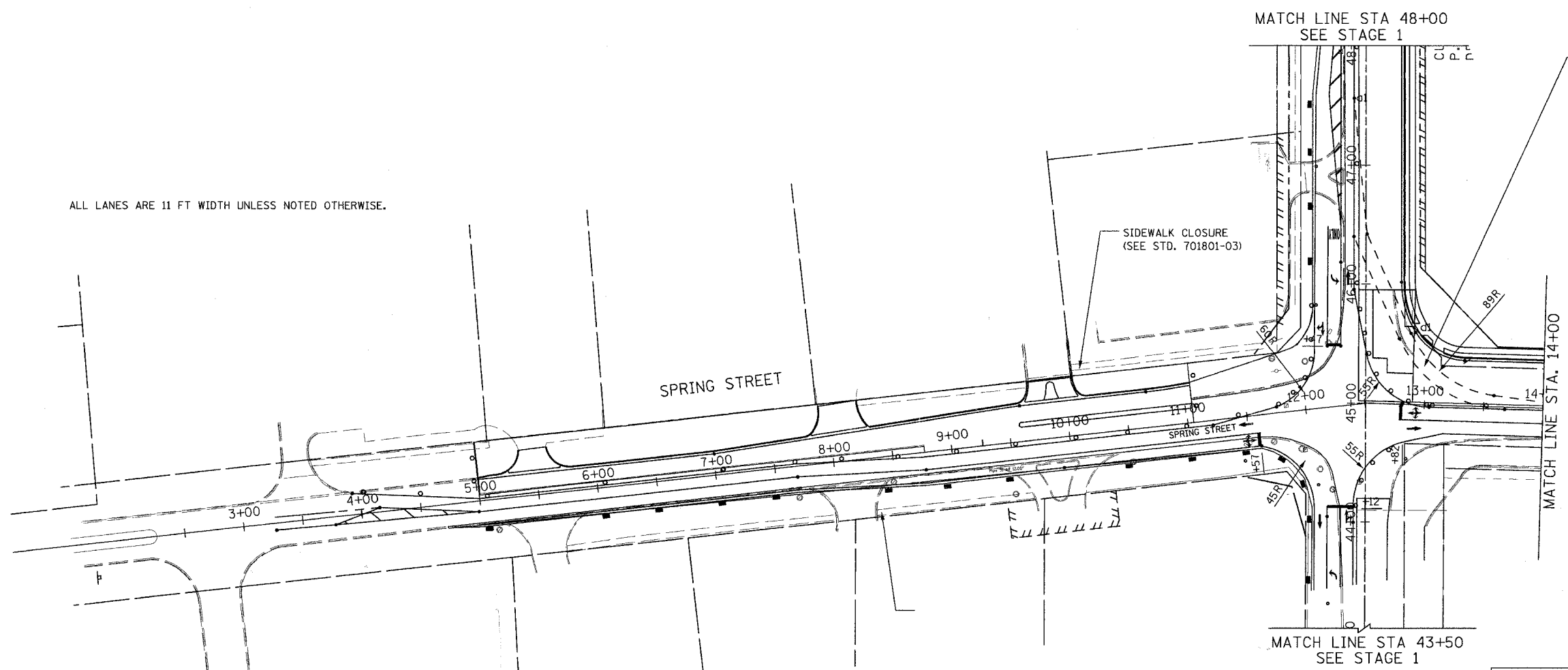

MAINTAIN TEMPORARY PAVEMENT MARKINGS FROM STAGE 1 EXCEPT FOR THE MINOR MODIFICATION NECESSARY FOR SUBSTAGE A1.

FOR PAVEMENT MARKING DESCRIPTION AND LEGEND SEE SHEET NO. 22.

REVISIONS	
NAME	DATE

**URS** 100 SOUTH WACKER DRIVE  
SUITE 500 TEL (312) 939-1000  
CHICAGO, IL 60606 FAX (312) 939-4198

McLEAN BOULEVARD  
  
SUGGESTED MAINTENANCE OF TRAFFIC  
SPRING STREET  
SUBSTAGES A1 AND A2  
  
SCALE: \_\_\_\_\_ DRAWN BY \_\_\_\_\_  
DATE 04/06/2007 CHECKED BY \_\_\_\_\_