

CONTRACT NO. 83737

|                     |                |                  |              |           |
|---------------------|----------------|------------------|--------------|-----------|
| F.A.U. RTE.         | SECTION        | COUNTY           | TOTAL SHEETS | SHEET NO. |
| 2509                | 96-00094-01-WR | KANE             | 187          | 31        |
| STA.                |                | TO STA.          |              |           |
| FED. ROAD DIST. NO. | ILLINOIS       | FED. AID PROJECT |              |           |

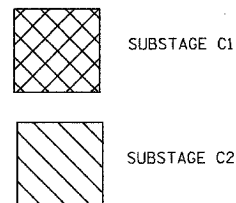

ALL LANES ARE 11 FT WIDTH UNLESS NOTED OTHERWISE.

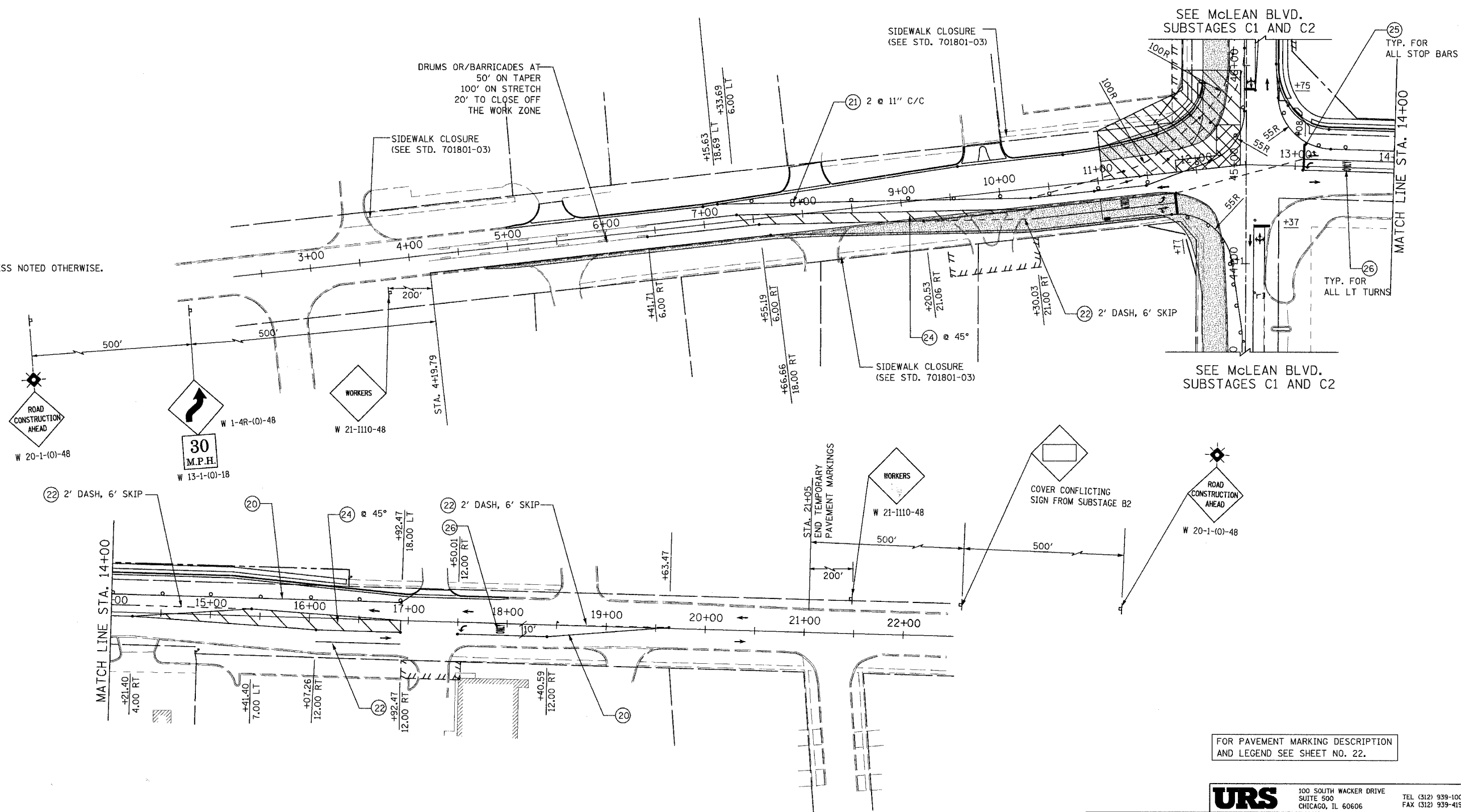

FOR PAVEMENT MARKING DESCRIPTION AND LEGEND SEE SHEET NO. 22.

**URS** 300 SOUTH WACKER DRIVE SUITE 500 CHICAGO, IL 60606 TEL (312) 939-1000 FAX (312) 939-4198

| REVISIONS |      |
|-----------|------|
| NAME      | DATE |
|           |      |
|           |      |
|           |      |
|           |      |
|           |      |
|           |      |
|           |      |
|           |      |
|           |      |
|           |      |

McLEAN BOULEVARD

SUGGESTED MAINTENANCE OF TRAFFIC SPRING STREET SUBSTAGES C1 AND C2

SCALE: DATE 04/06/2007 DRAWN BY CHECKED BY