

CONTRACT NO. 83737				
F.A.U. RTE.	SECTION	COUNTY	TOTAL SHEETS	SHEET NO.
2509	96-00094-01-WR	KANE	187	34
STA.	TO STA.			
FED. ROAD DIST. NO.	ILLINOIS	FED. AID PROJECT		

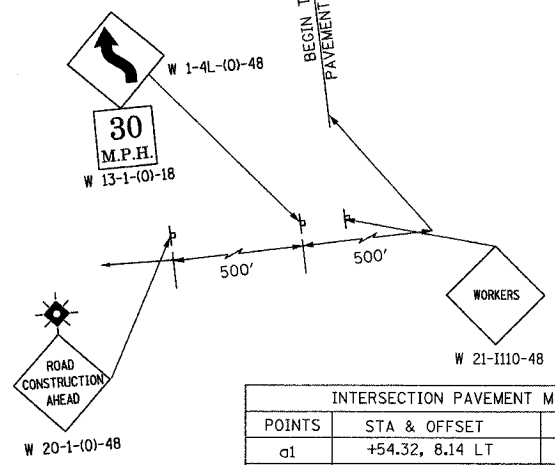

INTERSECTION PAVEMENT MARKING CONTROL POINTS			
POINTS	STA & OFFSET	POINTS	STA & OFFSET
a1	+54.32, 8.14 LT		
b1	+54.34, 10.00 LT		
c1	+70.65, 2.51 RT		
d1	6+98.27, 48.18 RT		
e1	7+16.98, 33.24 RT		
f1	7+53.90, 14.68 RT		
g1	7+63.72, 1.48 RT		
h1	8+20.00, 2.75 LT		

ALL LANES ARE 11 FT WIDTH UNLESS NOTED OTHERWISE.

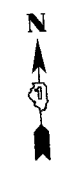
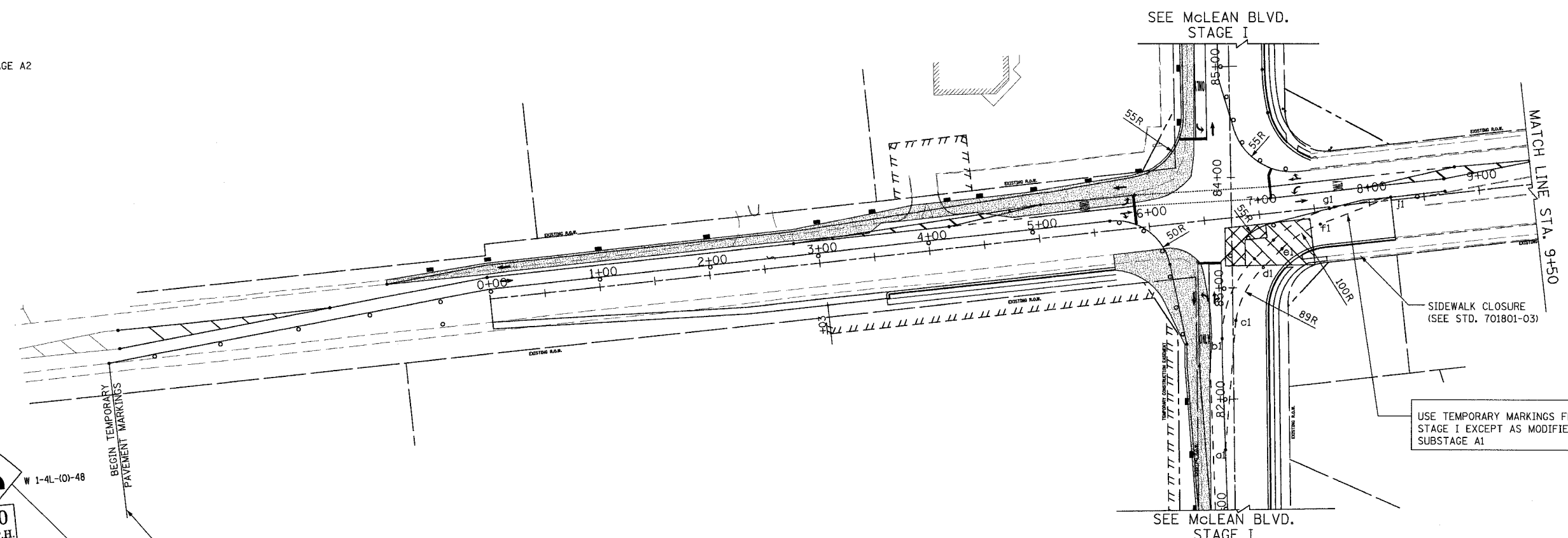
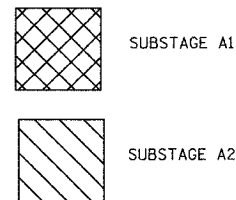
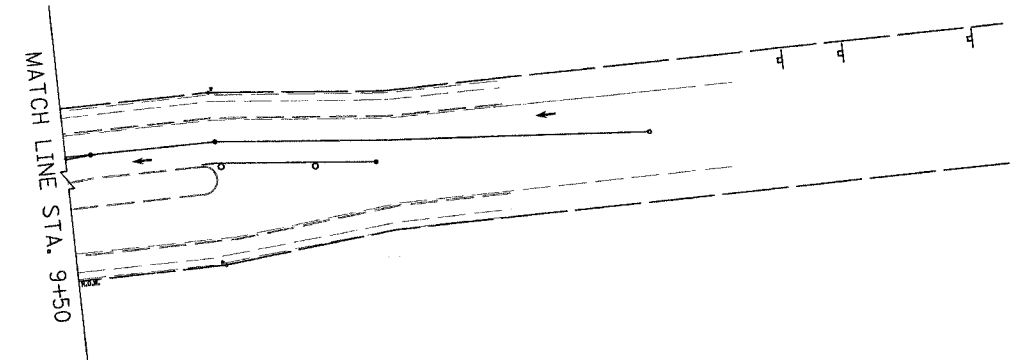

USE TEMPORARY MARKINGS FROM STAGE I EXCEPT AS MODIFIED FOR SUBSTAGE A1

FOR PAVEMENT MARKING DESCRIPTION AND LEGEND SEE SHEET NO. 22.

REVISIONS	
NAME	DATE

URS 100 SOUTH WACKER DRIVE
SUITE 500
CHICAGO, IL 60606 TEL (312) 939-1000
FAX (312) 939-4198

McLEAN BOULEVARD
SUGGESTED
MAINTENANCE OF TRAFFIC
BOWES ROAD
SUBSTAGES A1 AND A2

SCALE: DATE 04/06/2007 DRAWN BY CHECKED BY