

CONTRACT NO. 83737

F.A.J. RTE.	SECTION	COUNTY	TOTAL SHEETS	SHEET NO.
2509	96-00094-01-WR	KANE	187	62
STA.		TO STA.		
FED. ROAD DIST. NO.	ILLINOIS	FED. AID PROJECT		

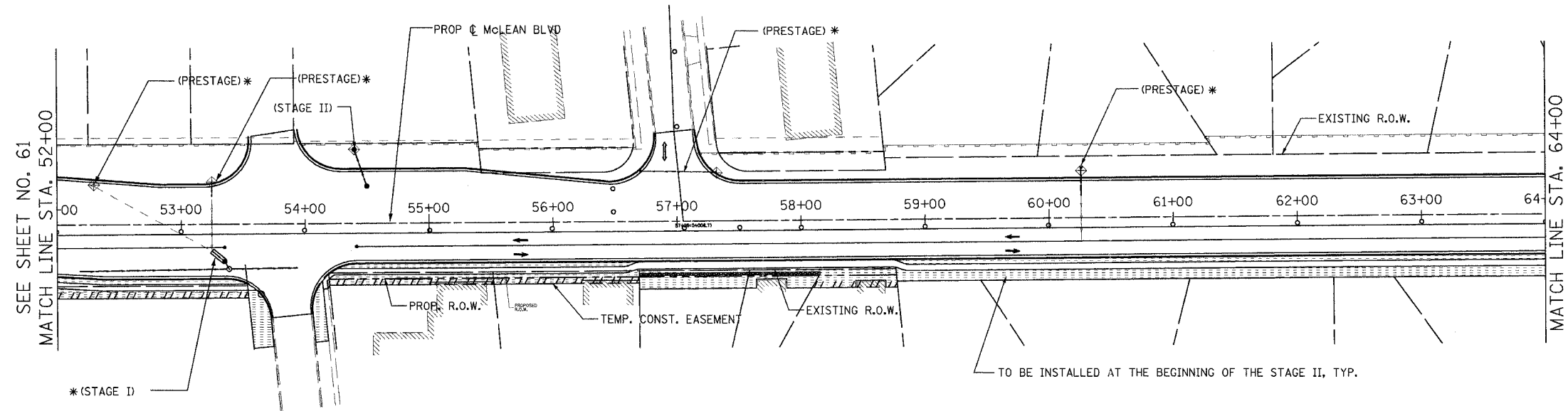

\* MAINTAIN THE PROTECTION AS DIRECTED BY THE ENGINEER UNTIL THE REMOVAL IS NECESSARY.

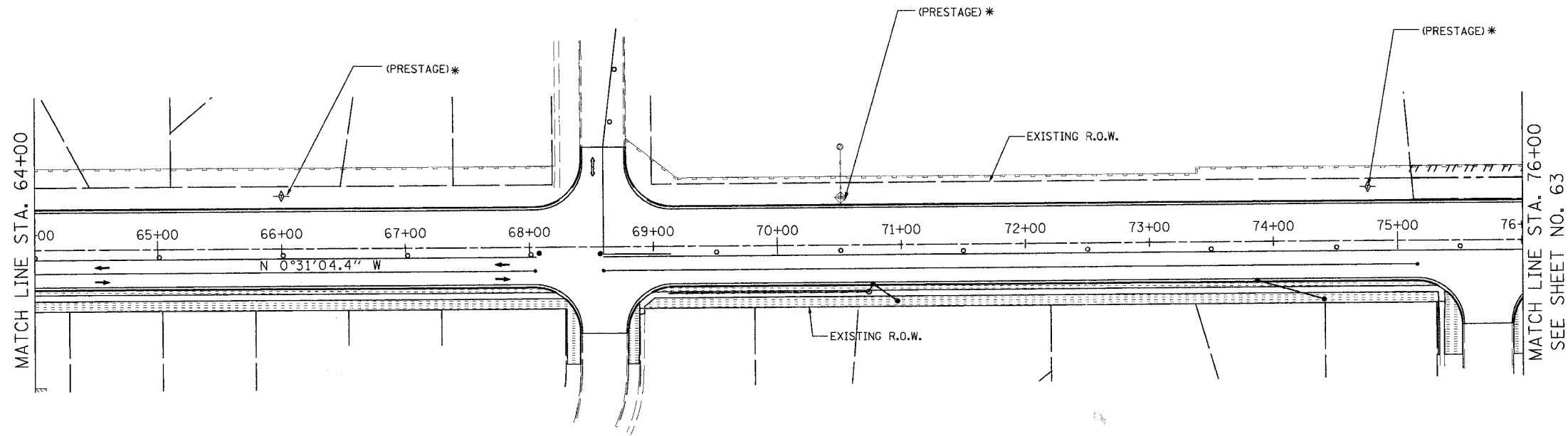

NOTES:

1. THE RESIDENT ENGINEER SHALL HAVE THE FINAL DETERMINATION OF THE PLACEMENT AND LOCATION OF THE PERIMETER EROSION BARRIER
2. SEE SUGGESTED MAINTENANCE OF TRAFFIC PLANS FOR ADDITIONAL INFORMATION REGARDING THE SEQUENCE OF CONSTRUCTION.
3. NOT ALL DRAINAGE STRUCTURES ARE SHOWN. SEE DRAINAGE PLANS FOR ADDITIONAL INFORMATION.
4. FLARED END SECTIONS FOR THE TEMPORARY PIPE CULVERTS ARE OMITTED INTENTIONALLY.
5. MAINTAIN THE PROTECTION MEASURES FROM THE PREVIOUS STAGE UNTIL THE REMOVAL IS ABSOLUTELY NECESSARY.

FOR THE EROSION CONTROL PLAN  
LEGEND SEE SHEET 51.

REVISIONS	
NAME	DATE

**URS** 100 SOUTH WACKER DRIVE  
SUITE 500 CHICAGO, IL 60606 TEL (312) 939-1000 FAX (312) 939-4198

**McLEAN BOULEVARD**

**EROSION CONTROL PLANS**  
**STAGE II**

SCALE: DATE 04/06/2007 DRAWN BY MIA CHECKED BY MHL