

CONTRACT NO. 83737

| | | | | |
|---------------------|----------------|---------------------------|--------------|-----------|
| F.A.U. RTE. | SECTION | COUNTY | TOTAL SHEETS | SHEET NO. |
| 2509 | 96-00094-01-WR | KANE | 187 | 67 |
| STA. | | TO STA. | | |
| FED. ROAD DIST. NO. | | ILLINOIS FED. AID PROJECT | | |

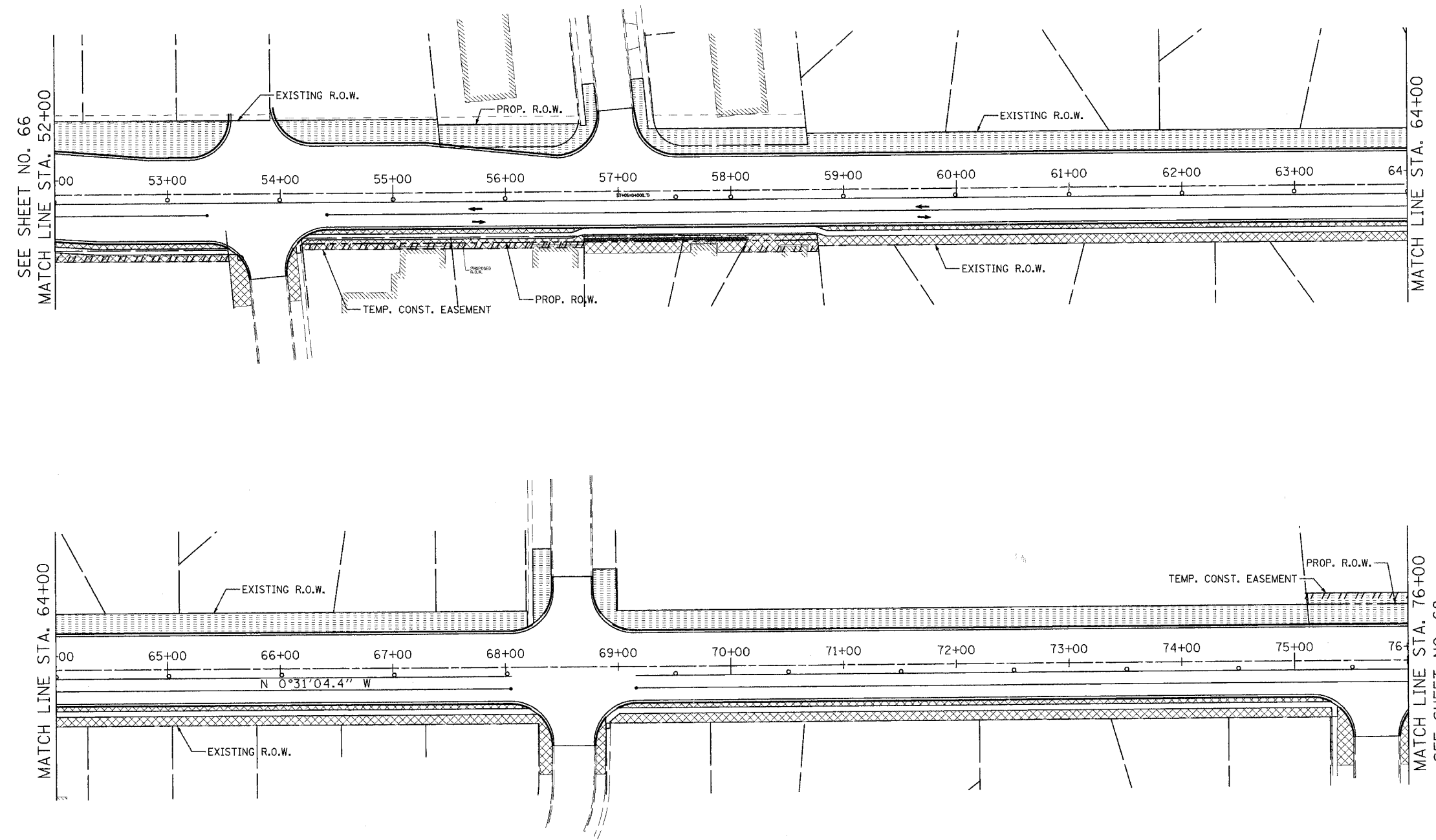
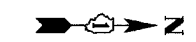

NOTES:

1. THE RESIDENT ENGINEER SHALL HAVE THE FINAL DETERMINATION OF THE PLACEMENT AND LOCATION OF THE PERIMETER EROSION BARRIER
2. SEE SUGGESTED MAINTENANCE OF TRAFFIC PLANS FOR ADDITIONAL INFORMATION REGARDING THE SEQUENCE OF CONSTRUCTION.
3. NOT ALL DRAINAGE STRUCTURES ARE SHOWN. SEE DRAINAGE PLANS FOR ADDITIONAL INFORMATION.
4. FLARED END SECTIONS FOR THE TEMPORARY PIPE CULVERTS ARE OMITTED INTENTIONALLY.
5. MAINTAIN THE PROTECTION MEASURES FROM THE PREVIOUS STAGE UNTIL THE REMOVAL IS ABSOLUTELY NECESSARY.

FOR THE EROSION CONTROL PLAN
LEGEND SEE SHEET 51.

| REVISIONS | |
|-----------|------|
| NAME | DATE |
| | |
| | |
| | |
| | |
| | |
| | |
| | |
| | |
| | |
| | |

URS 100 SOUTH WACKER DRIVE TEL (312) 939-1000
SUITE 500 CHICAGO, IL 60606 FAX (312) 939-4198

McLEAN BOULEVARD

EROSION CONTROL PLANS
STAGE III

SCALE: DATE 04/06/2007 DRAWN BY MIA CHECKED BY MHL