

F.A.U. RTE.	SECTION	COUNTY	TOTAL SHEETS	SHEET NO.
2509	96-00094-01-WR	KANE	187	109
STA.		TO STA.		
FED. ROAD DIST. NO.		ILLINOIS FED. AID PROJECT		

**TEMPORARY TRAFFIC SIGNAL LEGEND**

- TEMPORARY TRAFFIC SIGNAL HEAD SPAN WIRE MOUNTED ORIGINAL LOCATION →
- TEMPORARY TRAFFIC SIGNAL HEAD SPAN WIRE MOUNTED SECONDARY LOCATION →
- TEMPORARY WOOD POLE (CLASS 5 OR BETTER) 45 FOOT (13.7m) MINIMUM ⊗
- TEMPORARY CONTROLLER CABINET ⊠
- TEMPORARY SPAN WIRE, TETHER WIRE, AND CABLE —
- TEMPORARY SERVICE INSTALLATION ⊕
- TEMPORARY PEDESTRIAN SIGNAL HEAD, BRACKET MOUNTED ⊞
- TEMPORARY PEDESTRIAN PUSHBUTTON DETECTOR ⊙
- VIDEO CAMERA ASSEMBLY ⊠
- EMERGENCY VEHICLE LIGHT DETECTOR ⊙
- CONFIRMATION BEACON ⊙
- VEHICLE DETECTOR, INDUCTION LOOP □
- COMMON TRENCH ct
- UNIT DUCT 5
- G.S. CONDUIT IN TRENCH OR PUSHED —
- HANDHOLE ⊠
- HEAVY-DUTY HANDHOLE ⊠
- PROPOSED TEMPORARY LUMINAIRE ON 15' MAST ARM (310 WATTS HPS) 35' MOUNTING HEIGHT ⊠

**EXISTING EQUIPMENT TO BE REMOVED LEGEND**

- EXISTING SIGNAL HEAD TO BE REMOVED →
- EXISTING SERVICE INSTALLATION TO BE REMOVED "E" ⊠
- EXISTING STREET LIGHT, FOUNDATION AND LUMINAIRE TO REMAIN ⊗
- EXISTING CONTROLLER TO BE REMOVED ⊠
- EXISTING HANDHOLE TO BE REMOVED "E" ⊠
- EXISTING PEDESTRIAN SIGNAL HEAD TO BE REMOVED ⊞
- EXISTING PEDESTRIAN PUSH BUTTON TO BE REMOVED ⊙
- EMERGENCY VEHICLE LIGHT DETECTOR TO BE REMOVED ⊙
- CONFIRMATION BEACON TO BE REMOVED ⊙
- EXISTING HEAVY-DUTY HANDHOLE TO BE REMOVED ⊠
- EXISTING SIGNAL POST AND FOUNDATION TO BE REMOVED ⊙
- EXISTING ALUMINUM MAST ARM POLE AND FOUNDATION TO BE REMOVED ⊠
- EXISTING STEEL MAST ARM POLE AND FOUNDATION TO BE REMOVED ⊠
- EXISTING ILLUMINATED SIGN TO BE RELOCATED ⊠

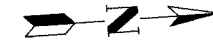

**CONSTRUCTION NOTES**

THE TEMPORARY TRAFFIC SIGNAL INSTALLATION SHALL BE INSTALLED IN CONJUNCTION WITH PROPOSED SEQUENCE-OF-CONSTRUCTION AS DENOTED IN CONSTRUCTION PLAN STAGING NOTES.

TEMPORARY CONTROLLER SETTINGS SHALL BE PROGRAMMED FOR PEAK HOURS AND NON-PEAK HOUR OPERATIONS. ALL PROPOSED TIMINGS SHALL BE APPROVED BY THE ENGINEER AND SHALL BE RE-EVALUATED DURING CONSTRUCTION TO COMPLEMENT CONSTRUCTION SEQUENCING.

A VIDEO DETECTION SYSTEM SHALL BE INCLUDED WITH THE PROPOSED TEMPORARY TRAFFIC SIGNALS AND THEN RELOCATED TO THE PERMANENT TRAFFIC SIGNAL INSTALLATION AS PART OF THE WORK. (CAMERAS SHALL BE TRANSFERRED TO PROPOSED SIGNAL ON SAME DAY AS THE "TURN-ON" AND BETWEEN HOURS OF 9 AM AND 3 PM). ALL ASSOCIATED EQUIPMENT AND ELECTRIC CABLE REQUIRED TO INSTALL THE SYSTEM ON BOTH THE PROPOSED TEMPORARY AND THE PERMANENT TRAFFIC SIGNALS AND PLACING THE SYSTEM IN OPERATION TO THE SATISFACTION OF THE ENGINEER, SHALL BE CONSIDERED INCIDENTAL TO THE COST FOR VIDEO VEHICLE DETECTION SYSTEM, EXCEPT ELECTRIC CABLES FOR ONLY THE PERMANENT SIGNALS SHALL BE PAID SEPARATELY.

PAVEMENT MARKING REVISIONS DEEMED NECESSARY BY THE ENGINEER TO MATCH CONSTRUCTION SEQUENCING SHALL BE PAID AS SEPARATE ITEMS.

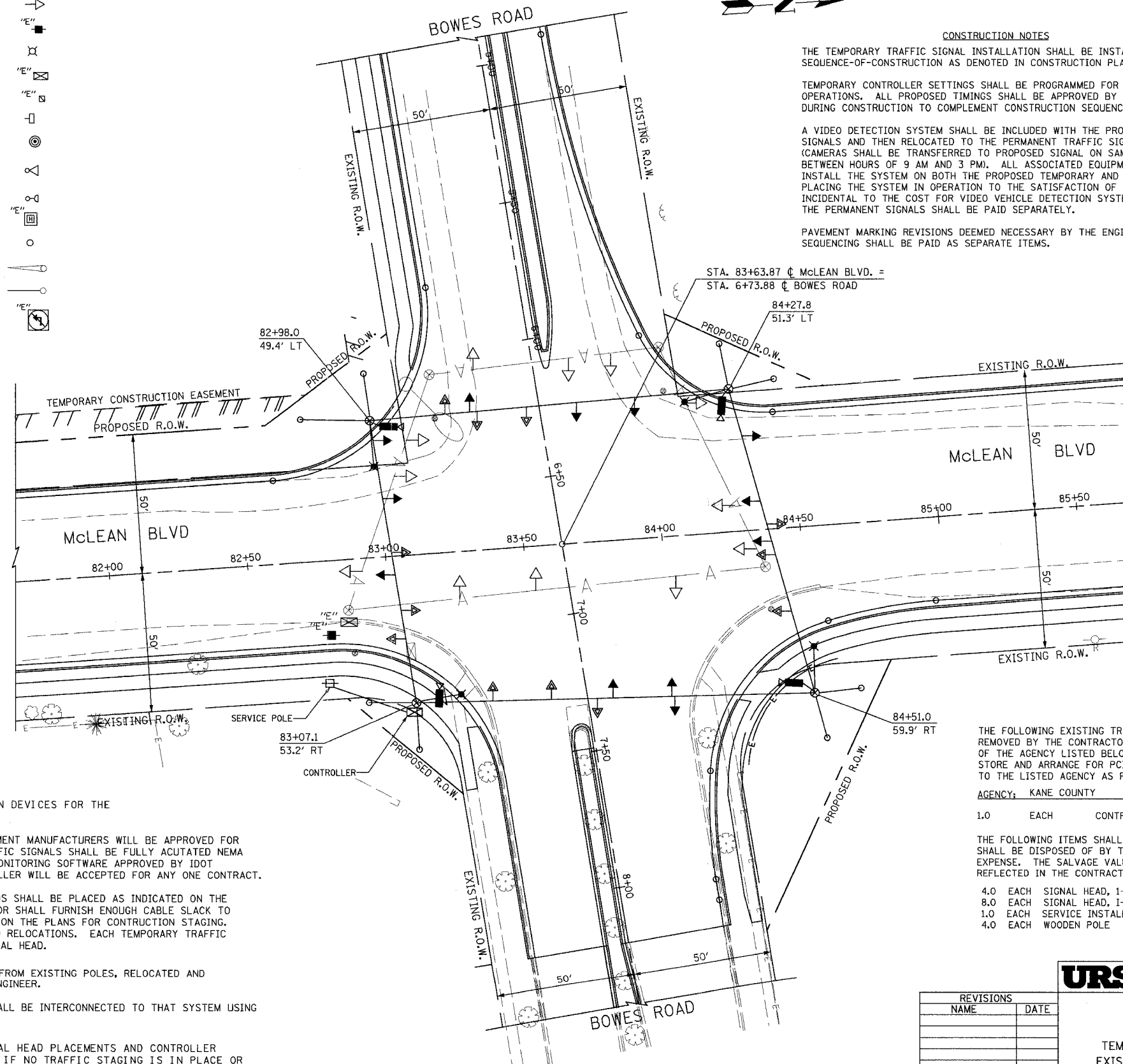

THE CONTRACTOR SHALL COMPLY TO IDOT STANDARD 880001 FOR THE INSTALLATION OF SPAN WIRE MOUNTED SIGNALS SPECIAL ATTENTION TO BE PAID TO MOUNTING GUY WIRE SPANNING OVER SIDEWALK.

**RESTORATION OF WORK AREA.**  
RESTORATION OF THE TRAFFIC SIGNAL WORK AREA SHALL BE INCIDENTAL TO THE RELATED PAY ITEM SUCH AS FOUNDATION, CONDUIT, HANDHOLE, TRENCH AND BACKFILL, ETC., AND NO EXTRA COMPENSATION SHALL BE ALLOWED. ALL ROADWAY SURFACES SUCH AS SHOULDERS, MEDIANS, SIDEWALKS, PAVEMENTS, ETC., SHALL BE REPLACED IN KIND. ALL DAMAGE TO MOWED LAWNS SHALL BE REPLACED WITH AN APPROVED SOD, AND ALL DAMAGE TO UNMOWED FIELDS SHALL BE SEEDED IN ACCORDANCE WITH STANDARD SPECIFICATIONS 252 AND 250 RESPECTIVELY.

THE VIDEO DETECTION CAMERA SHALL BE ITERIS FROM BROWN TRAFFIC PRODUCTS OR AUTOSCOPE.

**NOTES FOR TEMPORARY TRAFFIC SIGNALS**

1. ALL CONTROL EQUIPMENT INCLUDING EMERGENCY PRE-EMPTION AND COMMUNICATION DEVICES FOR THE TEMPORARY TRAFFIC SIGNAL (S) SHALL BE FURNISHED BY THE CONTRACTOR.
2. ONLY CONTROLLERS SUPPLIED BY ONE OF THE DISTRICT APPROVED CLOSED LOOP EQUIPMENT MANUFACTURERS WILL BE APPROVED FOR USE AT TEMPORARY SIGNAL LOCATIONS. ALL CONTROLLERS USED FOR TEMPORARY TRAFFIC SIGNALS SHALL BE FULLY ACUTATED NEMA MICROPROCESSOR BASED WITH RS232 DATA ENTRY PORTS COMPATABLE WITH EXISTING MONITORING SOFTWARE APPROVED BY IDOT DISTRICT 1, INSTALLED IN A NEMA TS1 OR TS2 CABINET. ONLY ONE BRAND OF CONTROLLER WILL BE ACCEPTED FOR ANY ONE CONTRACT.
3. ALL TRAFFIC SIGNAL SECTIONS AND PEDESTRIAN SIGNAL SECTIONS SHALL BE 12". HEADS SHALL BE PLACED AS INDICATED ON THE TEMPORARY TRAFFIC SIGNAL PLAN OR AS INDICATED BY THE ENGINEER. THE CONTRACTOR SHALL FURNISH ENOUGH CABLE SLACK TO RELOCATE HEADS TO ANY POSITION ON THE SPAN WIRE OR AT LOCATIONS ILLUSTRATED ON THE PLANS FOR CONSTRUCTION STAGING. THE TEMPORARY TRAFFIC SIGNAL SHALL REMAIN IN OPERATION DURING ALL SIGNAL HEAD RELOCATIONS. EACH TEMPORARY TRAFFIC SIGNAL HEAD SHALL HAVE ITS OWN CABLE FROM THE CONTROLLER CABINET TO THE SIGNAL HEAD.
4. ALL EXISTING STREET NAME AND INTERSECTION REGULATORY SIGNS SHALL BE REMOVED FROM EXISTING POLES, RELOCATED AND SECURELY FASTENED TO THE SIGNAL SPAN WIRE OR WOOD POLE AS DIRECTED BY THE ENGINEER.
5. ANY TEMPORARY SIGNAL WITHIN AN EXISTING CLOSED LOOP TRAFFIC SIGNAL SYSTEM SHALL BE INTERCONNECTED TO THAT SYSTEM USING SIMILAR BRAND CONTROL EQUIPMENT.
6. THE TEMPORARY TRAFFIC SIGNAL SHALL HAVE THE SIGNAL HEAD DISPLAYS, SIGNAL HEAD PLACEMENTS AND CONTROLLER PHASING MATCH THE EXISTING TRAFFIC SIGNAL, AT THE TIME OF THE TURN ON, IF NO TRAFFIC STAGING IS IN PLACE OR WILL NOT BE STAGED ON THE DAY OF THE TURN ON.

THE FOLLOWING EXISTING TRAFFIC SIGNAL EQUIPMENT SHALL BE REMOVED BY THE CONTRACTOR AND SHALL REMAIN THE PROPERTY OF THE AGENCY LISTED BELOW. THE CONTRACTOR SHALL SAFELY STORE AND ARRANGE FOR PICKUP OF ALL EQUIPMENT TO BE RETURNED TO THE LISTED AGENCY AS PER THE TRAFFIC SIGNAL SPECIFICATIONS

AGENCY: KANE COUNTY

- 1.0 EACH CONTROLLER AND CABINET, COMPLETE

THE FOLLOWING ITEMS SHALL BE REMOVED BY THE CONTRACTOR AND SHALL BE DISPOSED OF BY THEM OUTSIDE THE RIGHT-OF-WAY AT THEIR EXPENSE. THE SALVAGE VALUE OF THE REMOVED EQUIPMENT SHALL BE REFLECTED IN THE CONTRACT BID PRICE.

- 4.0 EACH SIGNAL HEAD, 1-FACE, 3-SECTION
- 8.0 EACH SIGNAL HEAD, 1-FACE, 5-SECTION
- 1.0 EACH SERVICE INSTALLATION
- 4.0 EACH WOODEN POLE

REVISIONS	
NAME	DATE

**URS** 100 SOUTH WACKER DRIVE TEL (312) 939-1000  
SUITE 500 CHICAGO, IL 60606 FAX (312) 939-4198

**McLEAN BOULEVARD**  
TEMPORARY TRAFFIC SIGNAL PLAN  
EXISTING TRAFFIC SIGNAL REMOVAL  
AT BOWES ROAD

SCALE: 1" = 20'  
DATE 04/06/2007  
DRAWN BY VAP  
CHECKED BY RAM