

F.A. RTE.	SECTION	COUNTY	TOTAL SHEETS	SHEET NO.
1681	*	COOK	19	15
STA. 60+50.00		TO STA. 66+50.00		
FED. ROAD DIST. NO.		ILLINOIS		

• 06-00068-00-RS

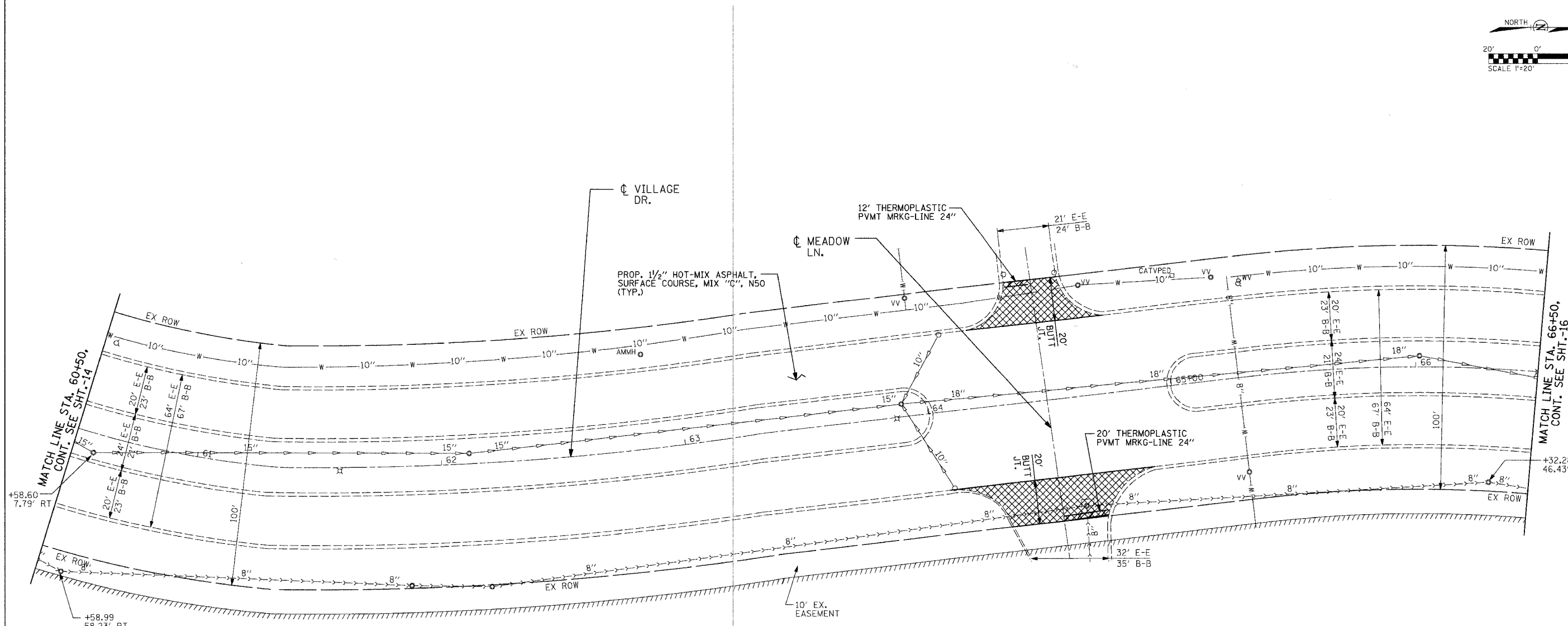
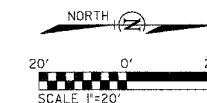

MATCH LINE STA. 60+50,
CONT. SEE SHT. -14

MATCH LINE STA. 66+50,
CONT. SEE SHT. -16

EXISTING LEGEND:

- - - - - STORM SEWER
- - - - - SANITARY SEWER
- - - - - WATER LINE
- - - - - GAS LINE
- - - - - TELEPHONE LINE
- - - - - COMED LINE
- - - - - CABLE LINE
- o - CATCH BASIN
- o - MANHOLE
- o - INLET
- wvo - WATER VALVE
- vvv - VALVE VAULT
- ⊕ - FIRE HYDRANT
- gvo - GAS VALVE
- - GAS VAULT
- ⊗ - LIGHT POLE
- ⊙ - POWER POLE
- ↑ - GUY

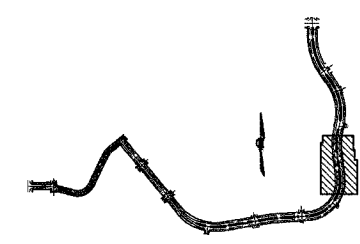

KEY PLAN

PLOT DATE = 03/09/2007
 PLOT SCALE = 3/8"=1'-0"
 SHEET SIZE = 36x24 (IN)

CIVIL / STRUCTURAL ENGINEERS



GLOBETROTTERS INTERNATIONAL,
300 SOUTH WACKER DRIVE, SUITE 200
CHICAGO, IL. 60606

REVISIONS	
NAME	DATE
DOT COMMENTS	02/14/07
DOT COMMENTS	03/12/07

MFT 06-00068-00-RS
VILLAGE DRIVE
EDGEWATER DR. TO 183rd STR.
HAZEL CREST, IL
PROJECT NO. 05726

SCALE: VERT. NONE
HORIZ. 1" = 20'
DATE 03/09/2007

DRAWN BY LS
CHECKED BY CT