

T. A. U. REF.	SECTION	COUNTY	TOTAL SHEETS	SHEET NO.
	03-00108-00-PK	COOK	025	009
STA.	TO STA.			
FED. ROAD DIST. NO.	ILLINOIS	FED. AID PROJECT		

CONTRACT NO. 83912

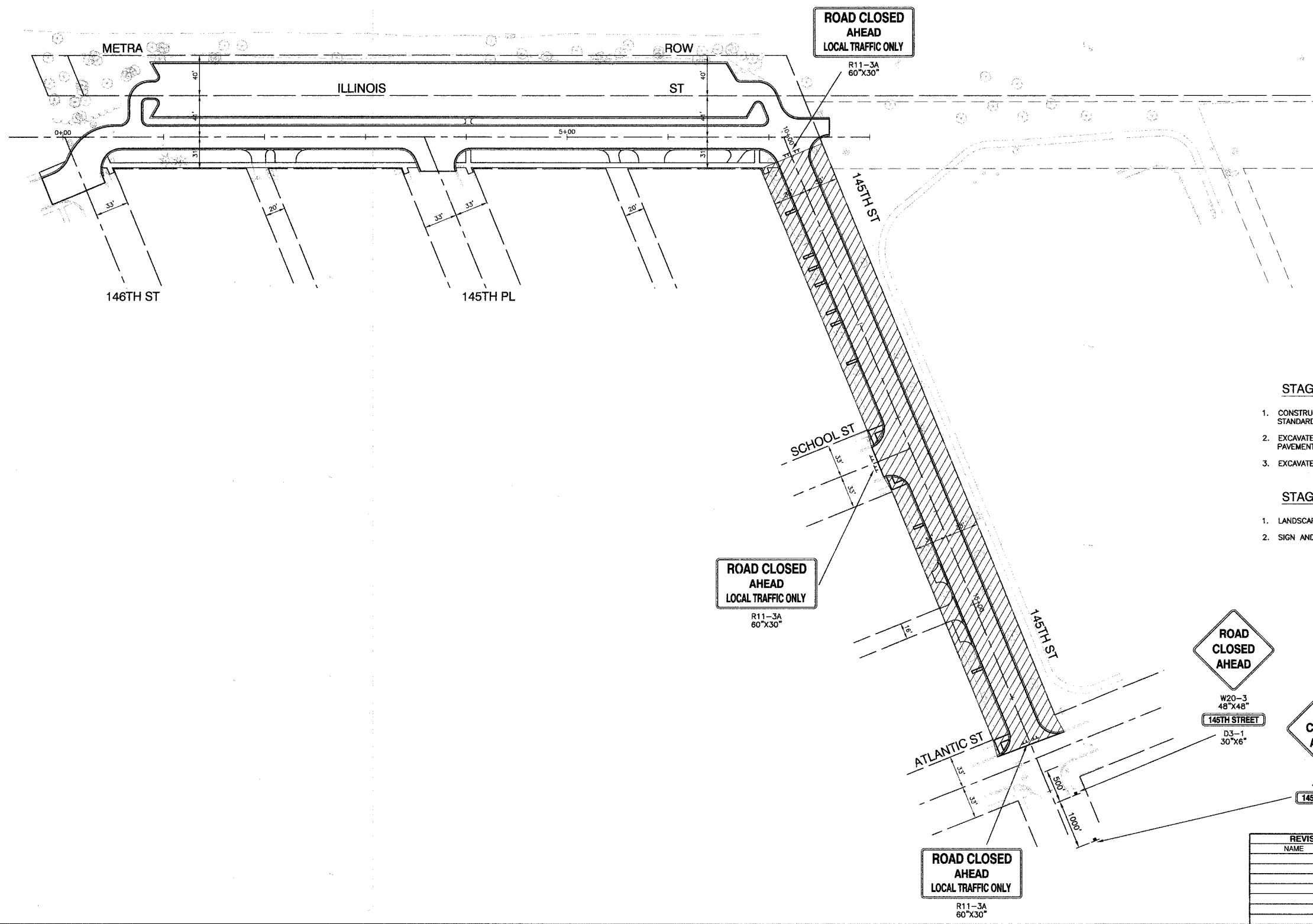
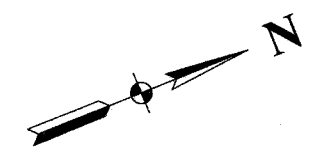

STAGE 3 NOTES

1. CONSTRUCT STORM SEWER ALONG 145TH STREET USING DAILY LANE CLOSURES PER STANDARD 701501-03.
2. EXCAVATE FOR AND CONSTRUCT CURB AND GUTTER ALONG BOTH SIDES OF NEW PAVEMENT USING DAILY LANE CLOSURES PER STANDARD 701501-03.
3. EXCAVATE REMAINDER OF ROADWAY AND CONSTRUCT PAVEMENT UNDER LOCAL TRAFFIC.

STAGE 4 NOTES

1. LANDSCAPE ALL AREAS.
2. SIGN AND STRIPE ALL AREAS.

LEGEND

- WORK AREA
- TYPE III BARRICADE WITH STEADY BURNING LIGHT
- SIGN



REVISIONS	
NAME	DATE

ILLINOIS DEPARTMENT OF TRANSPORTATION

**COMMUTER PARKING
MAINTENANCE OF TRAFFIC
STAGES 3 & 4**

SCALE: VERT. 1"=50'
HORIZ. 1"=50'

DATE: 2/22/07

DRAWN BY: PS
CHECKED BY: PKB

ROBINSON ENGINEERING, LTD.
1700 SOUTH PARK AVENUE, SOUTH HOLLAND, ILLINOIS 60476
708.595.8700 FAX 708.595.9828
ILLINOIS DESIGN FIRM REGISTRATION NO. 156001128 04185-TC00N-03