

F. A. L. NO.	SECTION	COUNTY	TOTAL SHEETS	SHEET NO.
	03-00108-00-PK	COOK	025	011
STA. 11+50	TO STA. 17+64.33			
FED. ROAD DIST. NO.	ILLINOIS	FED. AID PROJECT		

CONTRACT NO. 83912

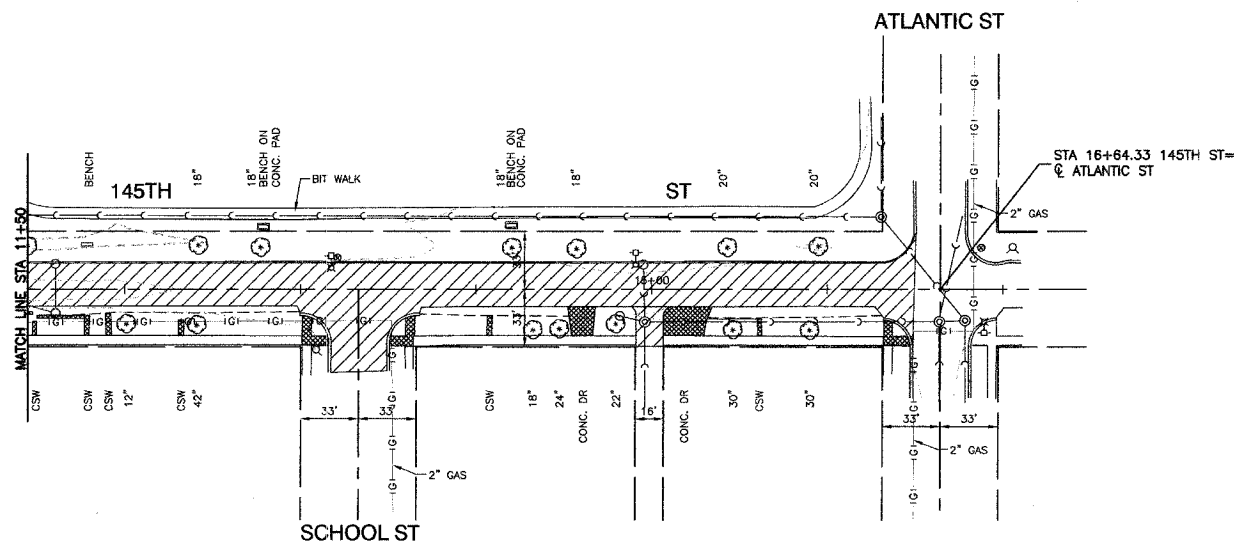

EXISTING CONDITIONS

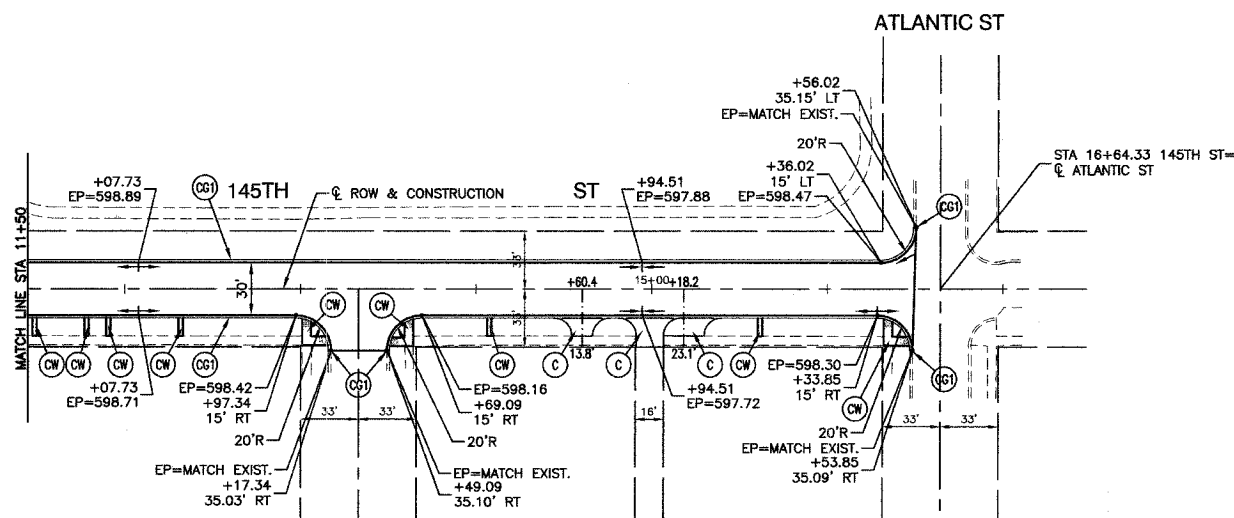

PROPOSED IMPROVEMENT

- LEGEND**
- ☒ TREE TO BE REMOVED
 - CONC CURB AND GUTTER REMOVAL
 - ▨ BITUMINOUS PAVEMENT REMOVAL (PAID AS EARTH EXCAVATION)
 - ▤ CONCRETE REMOVAL
 - DETECTABLE WARNINGS
 - ⊙ P.C.C. SIDEWALK, 5"
 - ⊙ P.C.C. DRIVEWAY, 8"
 - ⊙1 HOT-MIX ASPHALT DRIVEWAY
HOT-MIX ASPHALT BASE COURSE, 6"
HOT-MIX ASPHALT SURFACE COURSE, MIX "C", N50, 2"
 - ⊙2 ALLEY
HOT-MIX ASPHALT BASE COURSE, 6"
HOT-MIX ASPHALT SURFACE COURSE, MIX "C", N50, 2"
 - ⊙3 C & G TYPE B-6.12
 - ⊙4 10' TRANSITION FROM C & G TYPE B-6.12 TO EXISTING CURB AND GUTTER

NOTE:
DETECTABLE WARNINGS SHALL BE INSTALLED PER HIGHWAY STANDARD 424001 AT ALL STREET CROSSINGS WHERE SIDEWALK IS REPLACED.

BENCH MARK
SQUARE CUT IN BACK OF WALK AT ALLEY RETURN AT THE NORTHEAST CORNER OF RESIDENCE #14501 SCHOOL STREET.
ELEVATION = 598.71 NGVD 29 (FEMA)

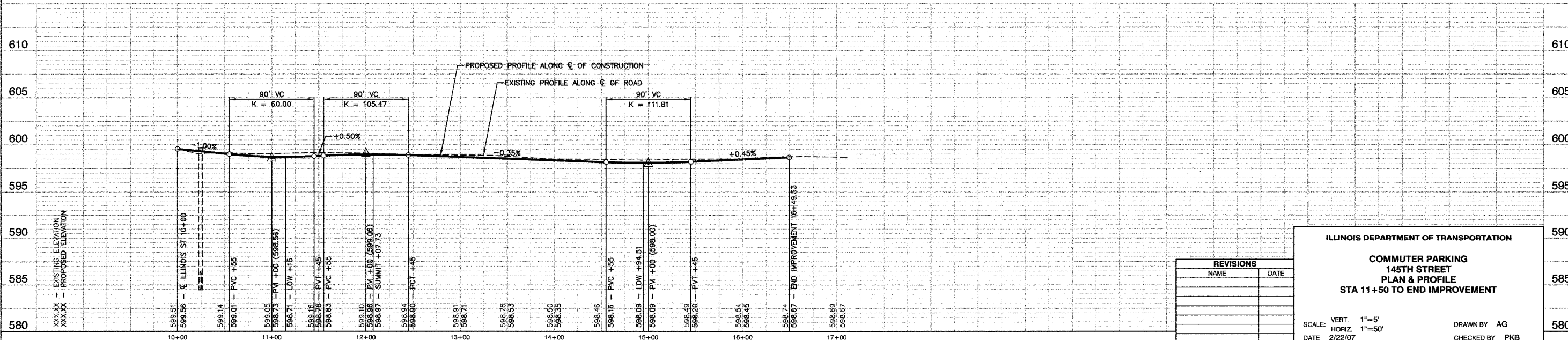

REVISIONS	
NAME	DATE

ILLINOIS DEPARTMENT OF TRANSPORTATION

**COMMUTER PARKING
145TH STREET
PLAN & PROFILE
STA 11+50 TO END IMPROVEMENT**

SCALE: VERT. 1"=5'
HORIZ. 1"=50'

DATE 2/22/07

DRAWN BY AG
CHECKED BY PKB