

F.A.U. RTE.	SECTION	COUNTY	TOTAL SHEETS	SHEET NO.
3869	06-00030-00-FF	MCHENRY	56	10
STA. 300+25.91		TO STA. 302+00		
FED. ROAD DIST. NO. 7		ILLINOIS	FED. AID PROJECT M-8003(641)	

SEE SHEET NO. 21 FOR RESURFACING LIMITS ON ALGONQUIN ROAD

- 1 STA. 300+41.87, 31.24' RT. STRUCTURE TO BE ABANDONED
- 2 STA. 300+92, 35.00' LT. V.V. TO BE RECONSTRUCTED EXIST. RIM = 889.15 PROP. RIM = 888.58
- 3 STA. 300+97, 30.00' LT. FH TO BE MOVED TO STA. 301+00.33, 36.38' LT.
- 3A STA. 302+00, 35' LT CONNECTION TO EXISTING WATER MAIN (NON-PRESSURE)
- 4 STA. 302+00, 52.0' RT. VALVE VAULT, TYPE A, 5'-DIA., TYPE 1 FRAME, CLOSED LID WITH 12" VALVE RIM = 887.24
- ① 12" - DUCTILE IRON WATERMAIN, 12" TBF = 0 CU YD
- ② 78" - DUCTILE IRON WATERMAIN, 12" TBF = 58.4 CU YD

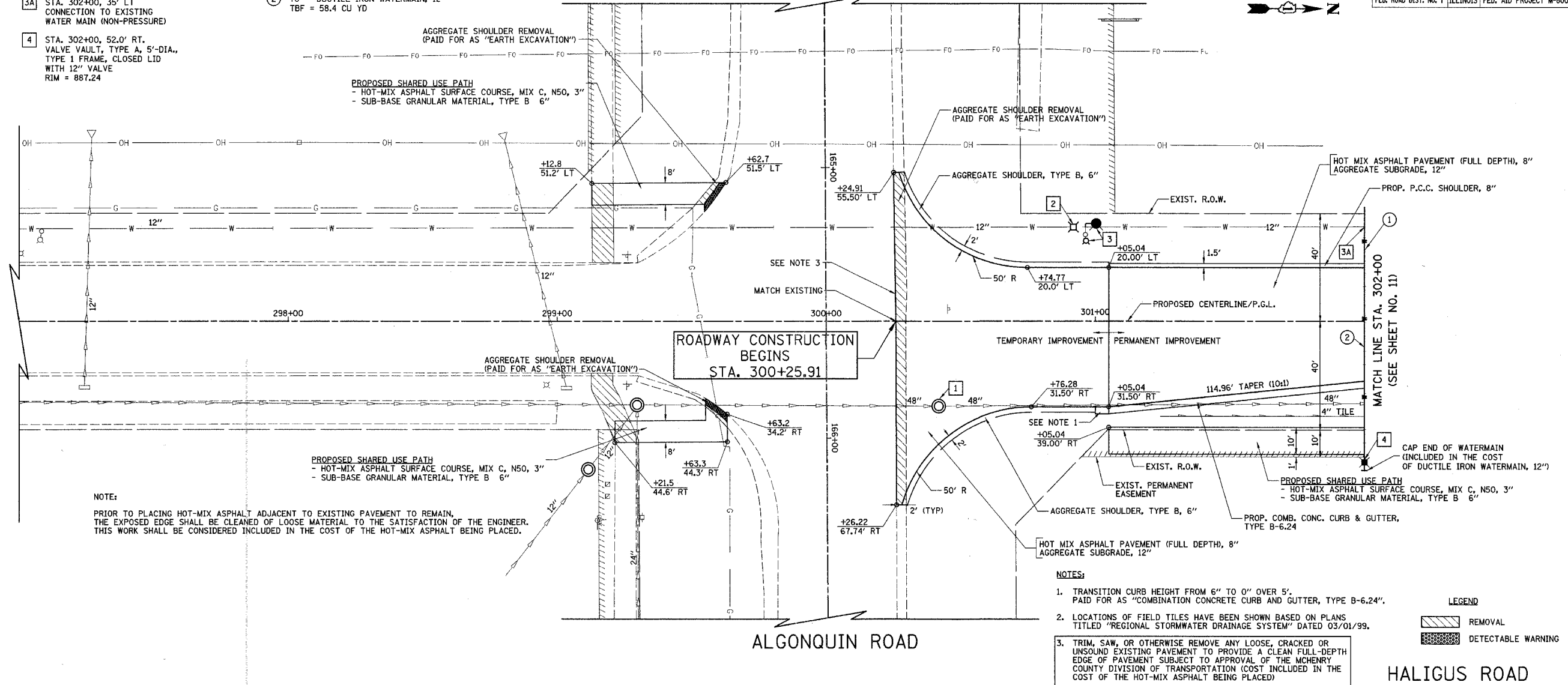

NOTE:
PRIOR TO PLACING HOT-MIX ASPHALT ADJACENT TO EXISTING PAVEMENT TO REMAIN, THE EXPOSED EDGE SHALL BE CLEANED OF LOOSE MATERIAL TO THE SATISFACTION OF THE ENGINEER. THIS WORK SHALL BE CONSIDERED INCLUDED IN THE COST OF THE HOT-MIX ASPHALT BEING PLACED.

- NOTES:
- TRANSITION CURB HEIGHT FROM 6" TO 0" OVER 5'. PAID FOR AS "COMBINATION CONCRETE CURB AND GUTTER, TYPE B-6.24".
 - LOCATIONS OF FIELD TILES HAVE BEEN SHOWN BASED ON PLANS TITLED "REGIONAL STORMWATER DRAINAGE SYSTEM" DATED 03/01/99.
 - TRIM, SAW, OR OTHERWISE REMOVE ANY LOOSE, CRACKED OR UNSOUND EXISTING PAVEMENT TO PROVIDE A CLEAN FULL-DEPTH EDGE OF PAVEMENT SUBJECT TO APPROVAL OF THE MCHENRY COUNTY DIVISION OF TRANSPORTATION (COST INCLUDED IN THE COST OF THE HOT-MIX ASPHALT BEING PLACED)

LEGEND

	REMOVAL
	DETECTABLE WARNING

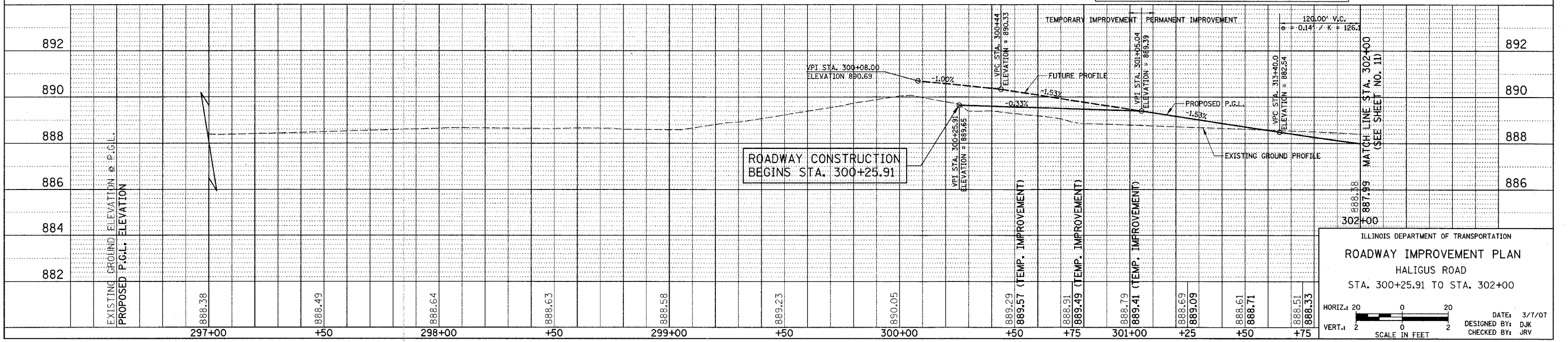

ILLINOIS DEPARTMENT OF TRANSPORTATION
ROADWAY IMPROVEMENT PLAN
HALIGUS ROAD
STA. 300+25.91 TO STA. 302+00

HORIZ. 1" = 20'
VERT. 1" = 2'

SCALE IN FEET

DATE: 3/7/07
DESIGNED BY: DJK
CHECKED BY: JRJ