

PLOT DATE = #DATE*
 PLOT SCALE = #SCALE*
 REFERENCE = #REF*

ORIGINAL SURVEY PLOTTED
 NOTE BOOK NO.
 AREAS CHECKED

FINAL SURVEY PLOTTED
 NOTE BOOK NO.
 AREAS CHECKED

BY DATE

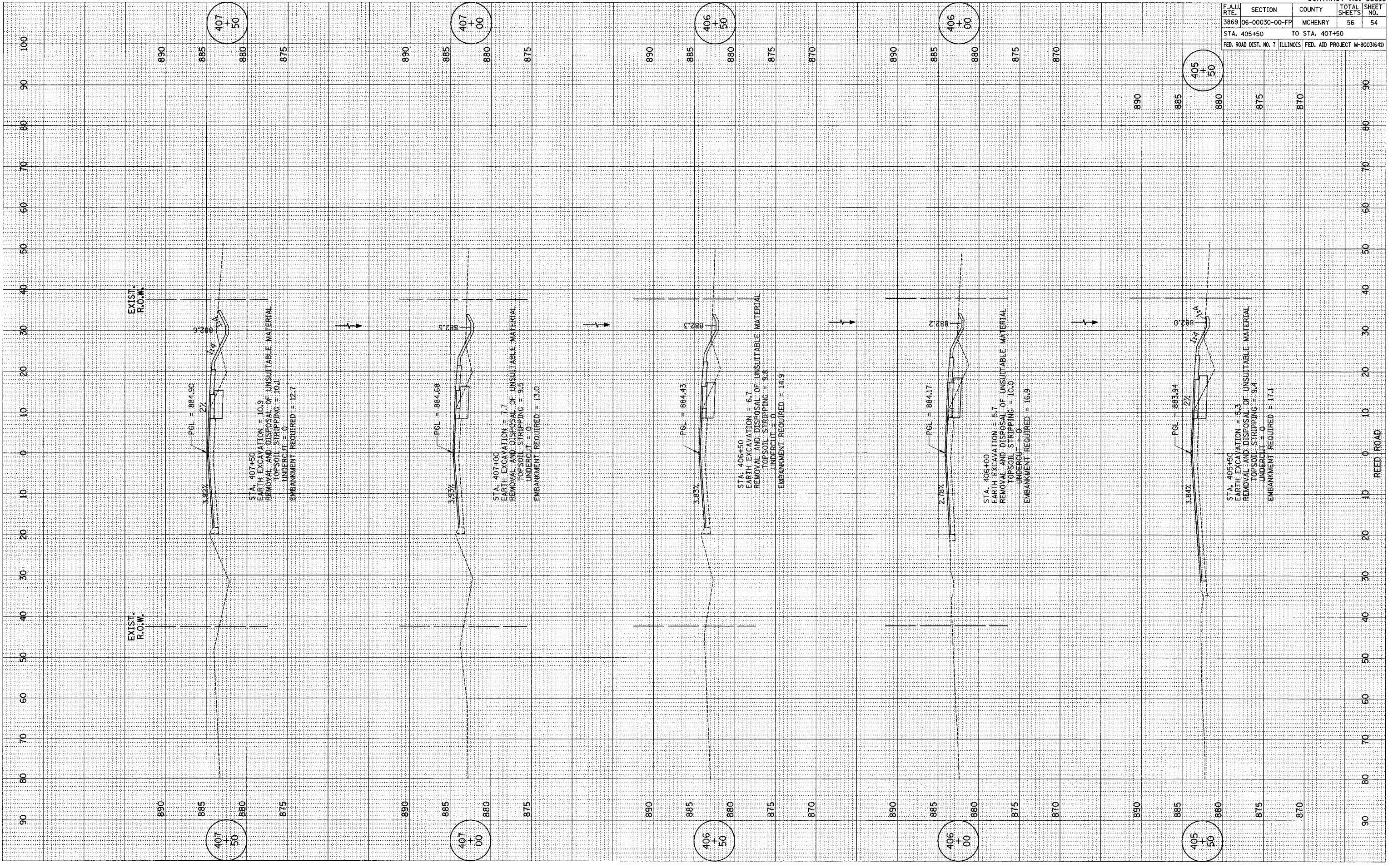

CONTRACT NO. 83919			
F.A.U. RTE.	SECTION	COUNTY	TOTAL SHEETS
3869	06-00030-00-FP	MCHENRY	56
STA. 405+50		TO STA. 407+50	
FED. ROAD DIST. NO. 7 ILLINOIS FED. AID PROJECT M-8003(641)			

EXIST. R.O.W.

PGL = 884.90
2%

STA. 407+50
 EARTH EXCAVATION = 10.9
 REMOVAL AND DISPOSAL OF UNSUITABLE MATERIAL
 TOPSOIL STRIPPING = 10.1
 UNDERCUT = 0
 EMBANKMENT REQUIRED = 12.7

EXIST. R.O.W.

PGL = 884.68
3.93%

STA. 407+00
 EARTH EXCAVATION = 7.7
 REMOVAL AND DISPOSAL OF UNSUITABLE MATERIAL
 TOPSOIL STRIPPING = 9.5
 UNDERCUT = 0
 EMBANKMENT REQUIRED = 13.0

EXIST. R.O.W.

PGL = 884.43
3.83%

STA. 406+50
 EARTH EXCAVATION = 6.7
 REMOVAL AND DISPOSAL OF UNSUITABLE MATERIAL
 TOPSOIL STRIPPING = 9.8
 UNDERCUT = 0
 EMBANKMENT REQUIRED = 14.3

EXIST. R.O.W.

PGL = 884.17
2.78%

STA. 406+00
 EARTH EXCAVATION = 5.7
 REMOVAL AND DISPOSAL OF UNSUITABLE MATERIAL
 TOPSOIL STRIPPING = 10.0
 UNDERCUT = 0
 EMBANKMENT REQUIRED = 16.9

EXIST. R.O.W.

PGL = 883.94
2%

STA. 405+50
 EARTH EXCAVATION = 5.3
 REMOVAL AND DISPOSAL OF UNSUITABLE MATERIAL
 TOPSOIL STRIPPING = 9.4
 UNDERCUT = 0
 EMBANKMENT REQUIRED = 17.1

REED ROAD