

PLAN

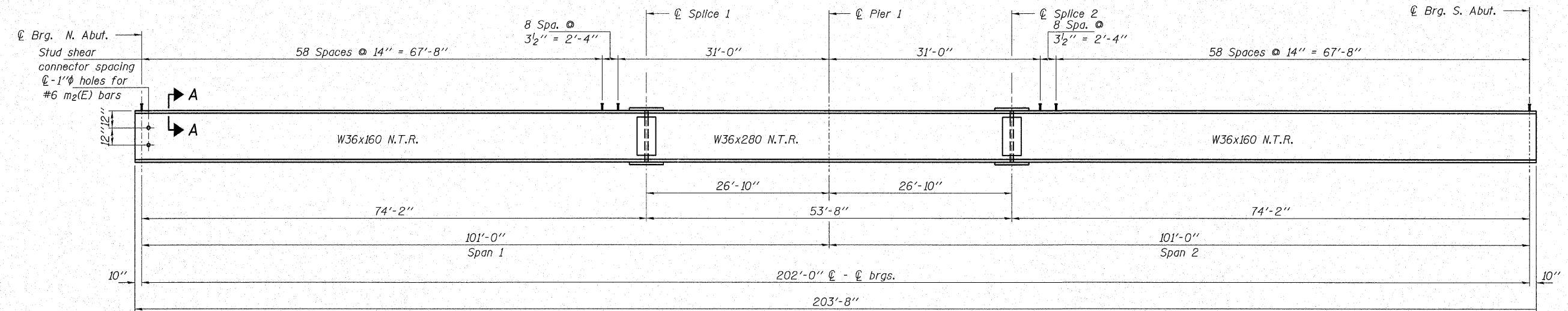

ELEVATION

Notes:  
 Load carrying components designated "N.T.R." shall conform to the Supplemental Requirements for Notch Toughness, Zone 2.  
 All structural steel shall be M270 Grade 50 W.

Location	☉ Brg. N. Abut.	☉ Splice #1	☉ Pier #1	☉ Splice #2	☉ Brg. S. Abut.
BEAM 1	579.226	578.989	578.903	578.817	578.575
BEAM 2	579.346	579.109	579.022	578.936	578.695
BEAM 3	579.465	579.228	579.142	579.056	578.814
BEAM 4	579.585	579.348	579.262	579.176	578.934
BEAM 5	579.454	579.217	579.131	579.045	578.804
BEAM 6	579.324	579.087	579.001	578.915	578.673
BEAM 7	579.194	578.957	578.871	578.785	578.543

**TOP OF BEAM ELEVATIONS**  
 (For fabrication only)  
 (Does not include dead load deflections.)  
 \* Top of beam elevation at splices is given at the top of the W36x280 beam.

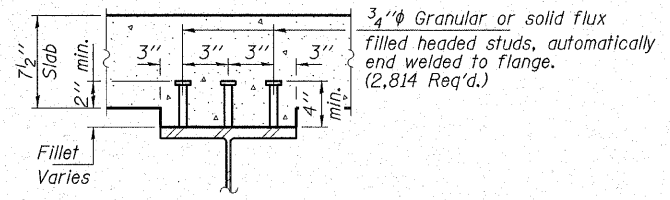

SECTION A-A

**HAMPTON, LENZINI & RENWICK, INC.**  
 CIVIL & STRUCTURAL ENGINEERS

3085 STEVENSON DRIVE, SUITE 201  
 SPRINGFIELD, ILLINOIS 62703  
 (217) 546-3400

ELGIN • SPRINGFIELD

PROJECT NUMBER: 12-06-0030-1 DATE: 03/12/07  
 DESIGNED: S.W.M. CHECKED: M.G.B. DRAWN: D.B.

**STRUCTURAL STEEL**  
 SECTION 96-00044-00-BR  
 FOX RIVER DRIVE / C.H. 15  
 KENDALL COUNTY  
 STRUCTURE NO. 047-3150 / STATION 49+62