

ROUTE NO.	SECTION	COUNTY	TOTAL SHEETS	SHEET NO.
FAS 389	93-00049-00-BR	PEORIA	99	9
FED. ROAD DIST. NO.	7	ILLINOIS PROJECT:	BRS-0389(104)	
CONTRACT NO. 89323				

STAGE 1:
 PLACE ALL APPROPRIATE TRAFFIC CONTROL & PROTECTION MEASURES AT ALL REQUIRED LOCATIONS PERTAINING TO CONSTRUCTION SITE.
 PLACE SIGNS: "TRUCKS ENTERING/LEAVING HIGHWAY" NEAR BRIDGE SITE.
 CONSTRUCT BRIDGE & IMMEDIATE APPROACH ROADWAY FROM APPROX. STA. 24+00 TO APPROX. STA. 40+00.
 RELOCATE WATER LINE & VACATE EXISTING LINE
 CONSTRUCT ALL OTHER ASPECTS OF THE PROJECT AS MUCH TO COMPLETION AS POSSIBLE WITHOUT HAVING TO CLOSE THE ROAD TO THROUGH TRAFFIC, I.E. TREE REMOVAL, GUARDRAIL, PAVED DITCH REMOVAL, EMBANKMENT, TEMPORARY SEEDING, ETC.

STAGE 2:
 PLACE MESSAGE BOARDS AT PFEIFFER & CAMERON INTERSECTIONS 1 WEEK PRIOR TO ROAD CLOSURE INDICATING WHEN THE ROAD WILL BE CLOSED.
 CLOSE ROAD TO THROUGH TRAFFIC WHILE KEEPING OPEN ACCESS TO ALL PRIVATE DRIVES.
 WHILE MAINTAINING PRIVATE ACCESS, FINISH CONSTRUCTION AS MUCH TO COMPLETION AS POSSIBLE ON ALL ASPECTS OF THE PROJECT. AT THE CLOSE OF THIS STAGE, THE PROPOSED ALIGNMENT MUST BE COMPLETELY DRIVEABLE. AFTER REOPENING THE ROAD, ANY ADDITIONAL CONSTRUCTION CONSTRUCTION MUST NOT DISRUPT TRAFFIC FLOW TO THE POINT WHERE THE ROAD WILL HAVE TO BE RE-CLOSED.
 COORDINATION WITH INDIVIDUAL PROPERTY OWNERS WILL DICTATE COMPLETION OF EACH PRIVATE ACCESS DRIVE.

STAGE 3:
 OPEN PROJECT TO THROUGH TRAFFIC.
 FINISH REMAINING ASPECTS OF CONSTRUCTION UNTIL PROJECT IS COMPLETE. CONSTRUCTION ITEMS THAT CAN BE COMPLETED IN THIS STAGE OF CONSTRUCTION INCLUDE FINAL SEEDING, TREE REPLACEMENT, DEMOLISHING EXISTING BRIDGE, INSTALLATION OF ROW MARKERS, REMOVAL OF EXISTING PAVEMENT, ETC.

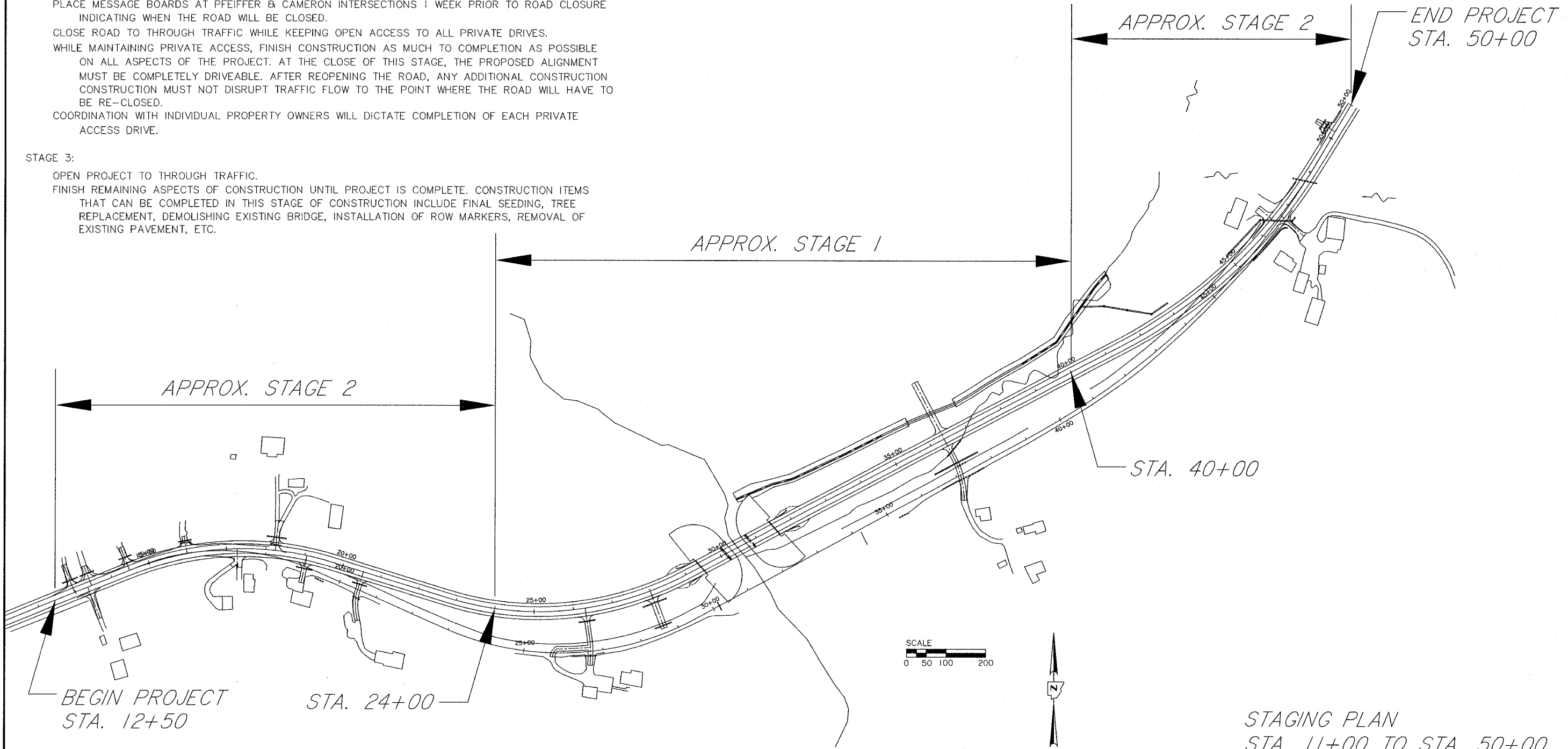

STAGING PLAN
 STA. 11+00 TO STA. 50+00
 PEORIA COUNTY
 STRUCTURE NO. 072-3145