

F.A. RTE.	SECTION	COUNTY	TOTAL SHEETS	SHEET NO.
07-00000-00-SG		TAZEWELL	19	3

FED. ROAD DIST. NO. ILLINOIS FED. AID PROJECT
 * VARIOUS

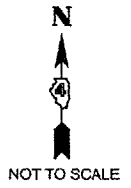

LEGEND	
(TR)	TOWNSHIP ROAD
(CH)	COUNTY HIGHWAY
⊠	EXISTING POWER POLE
⊠	EXISTING POWER POLE W/TRANSFORMER
⊠	EXISTING SIGN
⊠	EXISTING TELEPHONE SPLICE BOX
⊠	EXISTING FLASHING BEACON
⊠	PROPOSED FLASHER CONTROLLER
⊠	PROPOSED GULFBOX JUNCTION
⊠	TRAFFIC SIGNAL HEAD, 1 FACE, 1 SECTION, POST MOUNTED
—	PROPOSED CONDUIT T 1 1/2" PVC/P 1 1/2" PVC
⊠	NO. 14 3C
⊠	PROPOSED SERVICE INSTALLATION, TYPE B
⊠	PROPOSED SIGN POST
⊠	AERIAL SERVICE CABLE (BY OTHERS)

DESCRIPTION	QUANTITY
SIGN PANEL, TYPE I	28 SQ FT
SERVICE INSTALLATION, TYPE B	1 EACH
CONDUIT IN TRENCH, 1 1/2" DIA., PVC	197 FEET
CONDUIT PUSHED, 1 1/2" DIA., PVC	90 FEET
CONDUIT ATTACHED TO STRUCTURE, 1 1/2" DIA, GALVANIZED STEEL	26 FEET
GULFBOX JUNCTION	1 EACH
TRENCH AND BACKFILL FOR ELECTRICAL WORK	197 FEET
FLASHER CONTROLLER	1 EACH
ELECTRIC CABLE IN CONDUIT, SIGNAL NO. 14 3C	517 FEET
SIGNAL HEAD, POLYCARBONATE, LED, 1-FACE, 1-SECTION, POST MOUNTED	2 EACH
FURNISHING AND SETTING WOOD POST	2 EACH
REMOVE EXISTING SIGN POST	2 EACH

- NOTES**
- 1 GROUND CONTROLLER, SERVICE EXPOSED METALLIC CONDUIT IN ACCORDANCE WITH NEC REQUIREMENTS. COST INCLUDED IN CONTRACT.
 - 2 NO. 14 SPARE CONDUCTOR CAN BE USED FOR GROUNDING. COST INCLUDED IN CONTRACT.
 - 3 AERIAL SERVICE CABLE FROM THE EXISTING SERVICE POLE TO THE PROPOSED SERVICE POLE WILL BE PROVIDED BY OTHERS
 - 4 PROPOSED SERVICE POLE SHALL BE LOCATED WITHIN 125 FEET OF THE EXISTING SERVICE POLE

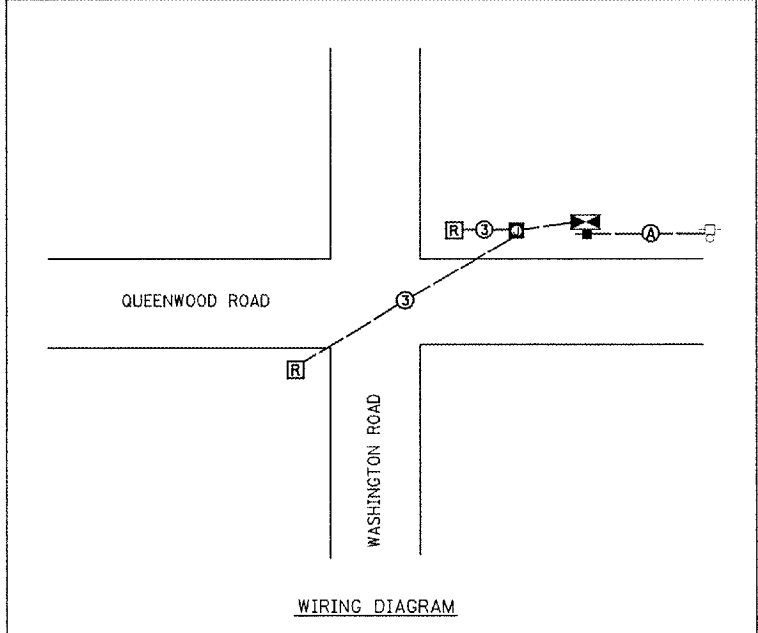
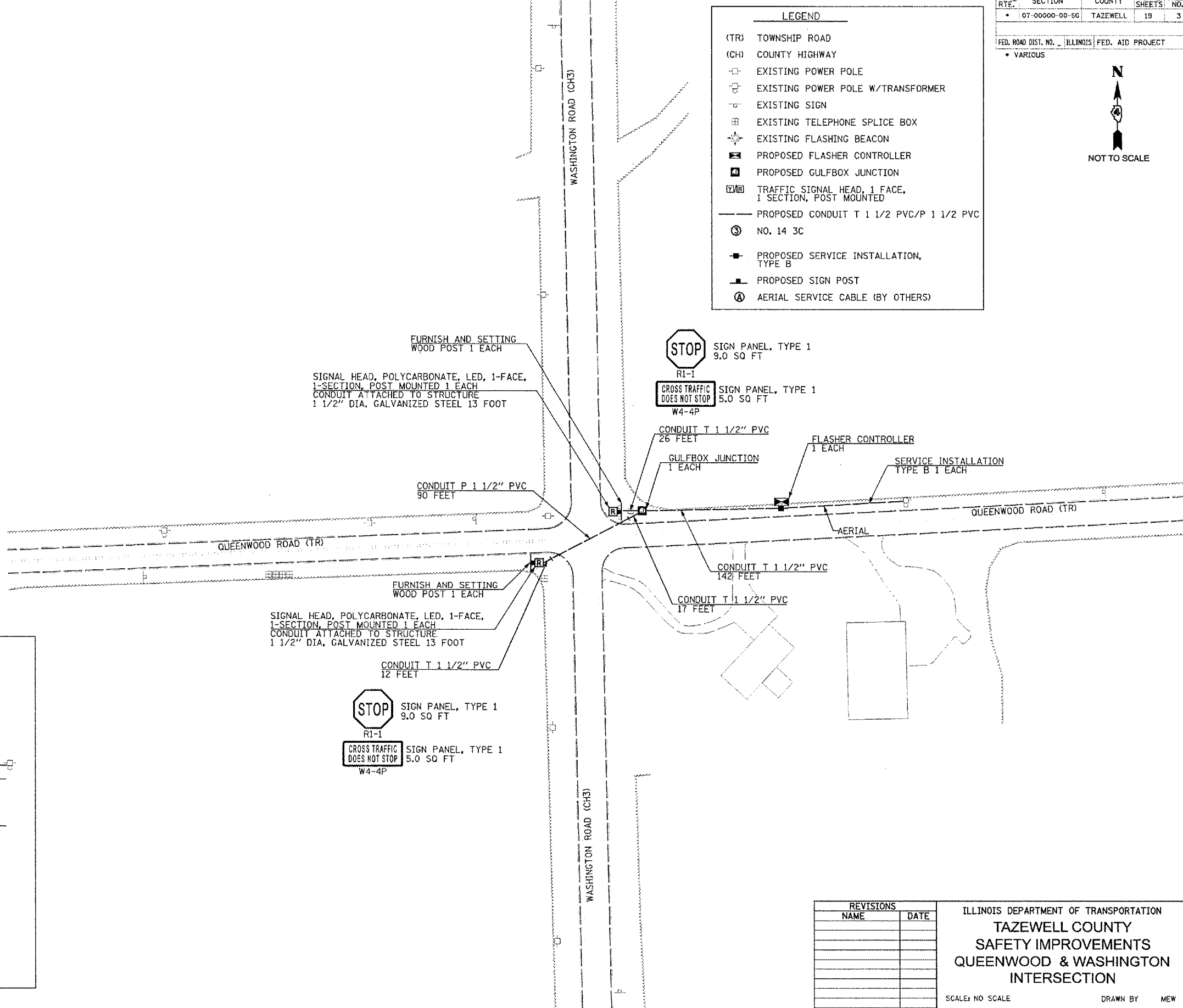

PLOT DATE = 4/7/2007
 FILE NAME = n:\data_projects\89468\job_89468.dwg

D.A.S.
 Consulting Services, LLC
 600 Bessler Lake Drive
 Greeland, Illinois 61535

REVISIONS	
NAME	DATE

ILLINOIS DEPARTMENT OF TRANSPORTATION
TAZEWELL COUNTY
SAFETY IMPROVEMENTS
QUEENWOOD & WASHINGTON INTERSECTION
 SCALE: NO SCALE DRAWN BY MEW
 DATE 03/20/2007 CHECKED BY DLH SDO