

RTE.	SECTION	COUNTY	TOTAL SHEETS	SHEET NO.
F.A.S.1746	*	MONTGOMERY	11	4

PROJECT

\* 03-00122-00-BR

Existing Structure: Single Span Reinforced Concrete Deck with Concrete Curbs on Steel Stringers with a Pratt-Thru Truss. Closed Timber Abutments and Wingwalls with Timber Piles.  $\pm 104'-9"$  Bk.-Bk. Abutments,  $\pm 20'-10"$  Face to Face of Curb. Steel Railings.  $\pm 50'$  Skew Rt. Forward.  
Existing Structure No. 068-3018 - No Salvage

Benchmarks: BM#1 - PK Nail & Washer in Top of Pile Cap (N.W. Wing.)  
Elevation 100.00 (Assumed)  
BM#2 - PK Nail & Washer in Top of Pile Cap (S.E. Wing.)  
Elevation 100.11

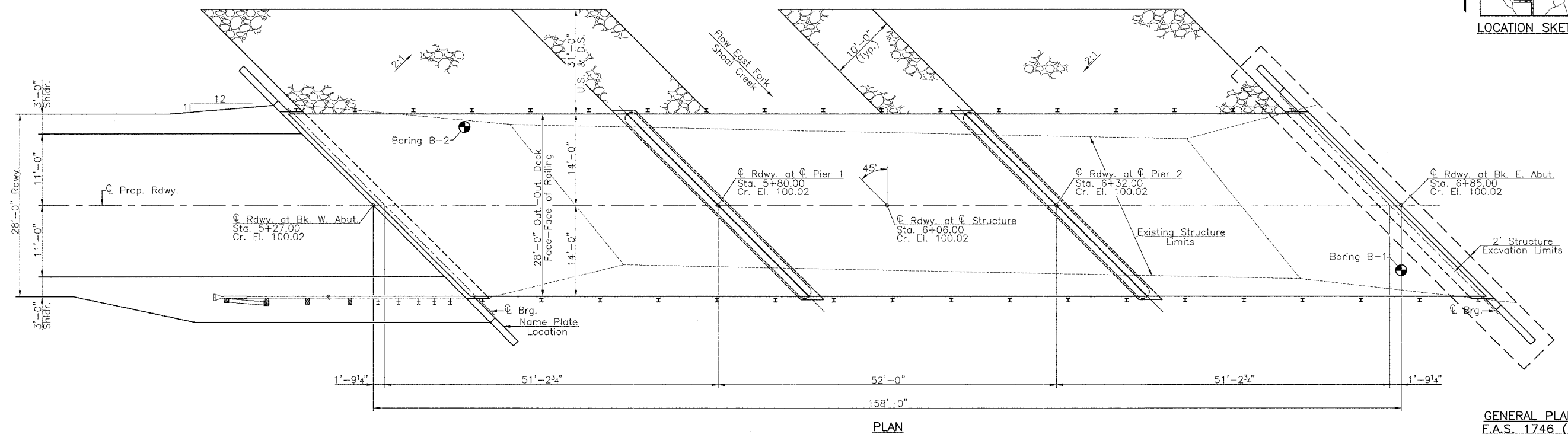
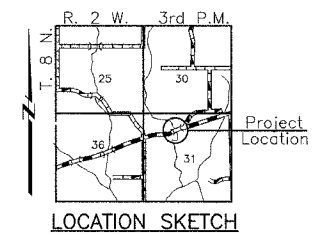
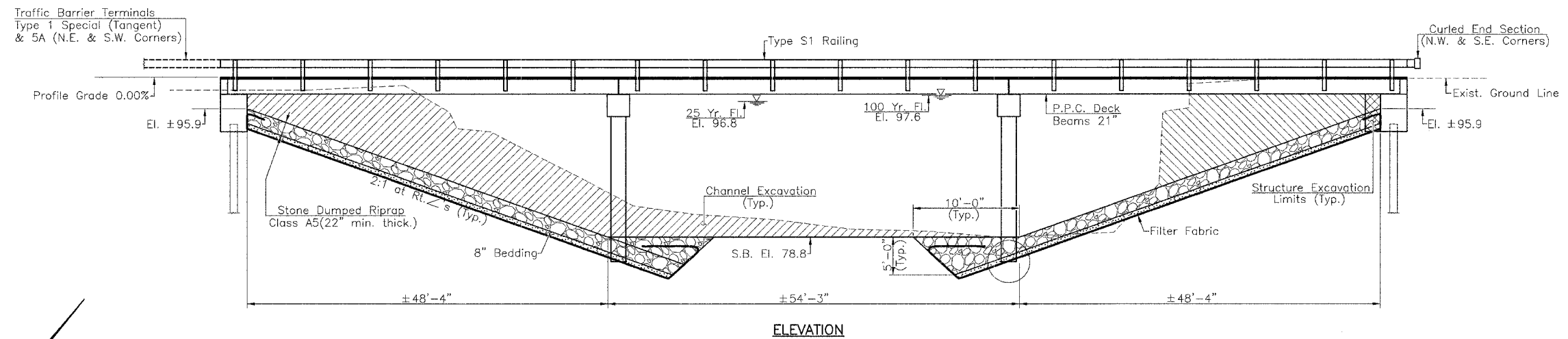

GENERAL PLAN & ELEVATION  
F.A.S. 1746 (COFFEEN ROAD)  
OVER EAST FORK SHOAL CREEK  
SECTION 03-00122-00-BR  
MONTGOMERY COUNTY