

F.A.P. RTE.	SECTION	COUNTY	TOTAL SHEETS	SHEET NO.
95	•	EFFINGHAM	409	23
FED. ROAD DIST. NO. 7 ILLINOIS FED. AID PROJECT				
*6,7Y, RS-1, 6B-1, 7B-1 & 7BR-2				
CONTRACT NO. 94356				

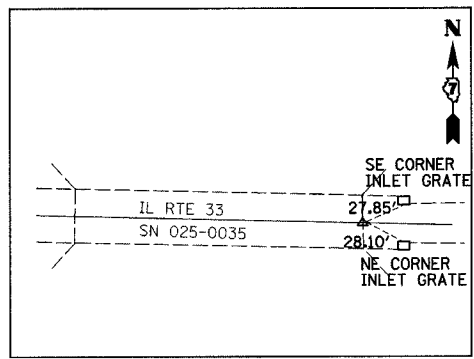

P.O.T. STA. 147+28
(C.C. NAIL W/ SHINER)

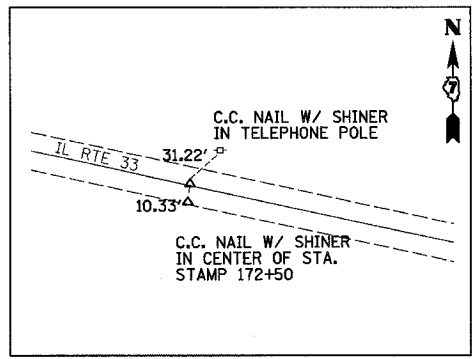

P.I. STA. 172+63.44
(C.C. NAIL W/ SHINER)

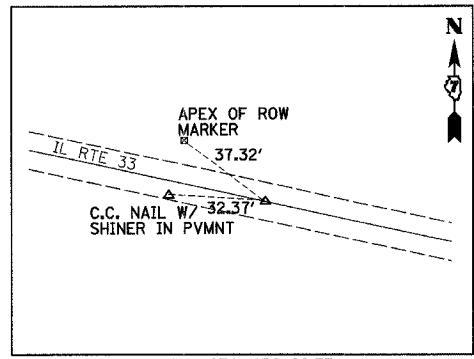

P.C. STA. 176+29.35
(MAG NAIL)

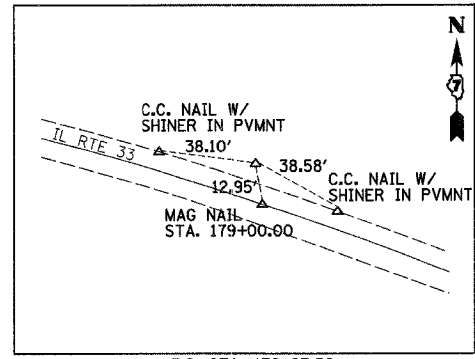

P.I. STA. 178+97.56
(SPIKE NAIL)

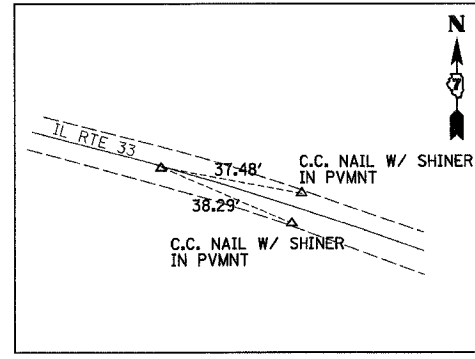

P.T. STA. 181+64.21
(MAG NAIL)

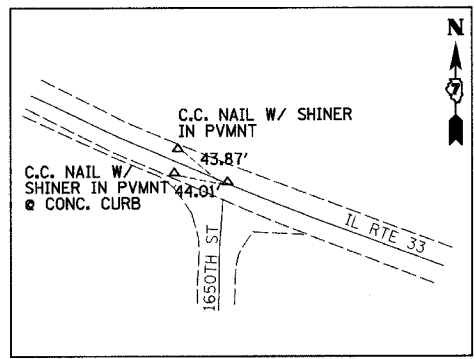

P.C. STA. 197+48.45
(MAG NAIL)

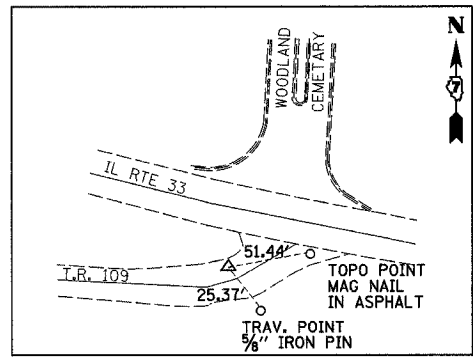

P.I. STA. 201+14.06
(5/8" IRON PIN)

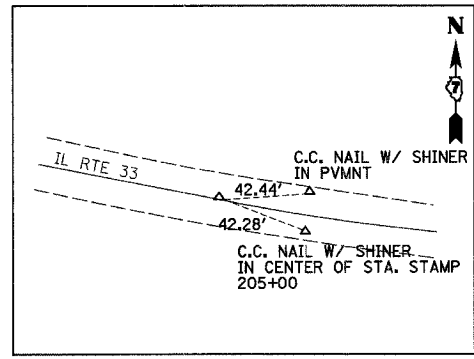

P.T. STA. 204+70.94
(MAG NAIL)

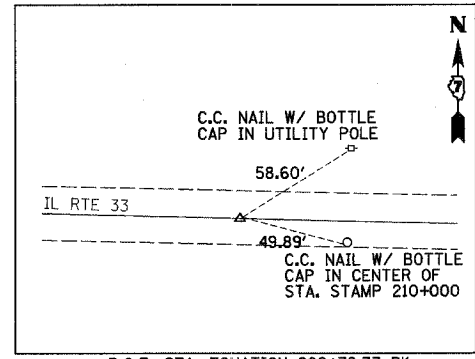

P.O.T. STA. EQUATION 209+78.77 BK
209+67.66 AH
(MAG NAIL)

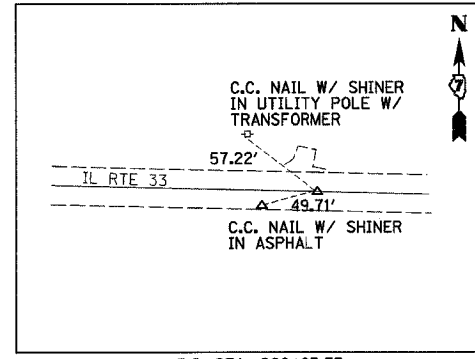

P.I. STA. 260+95.33
(MAG NAIL)

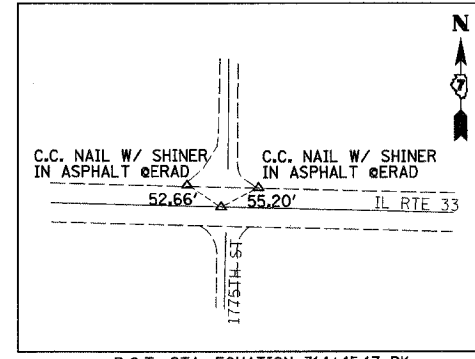

P.O.T. STA. EQUATION 314+45.17 BK
314+13.07 AH
(MAG NAIL)

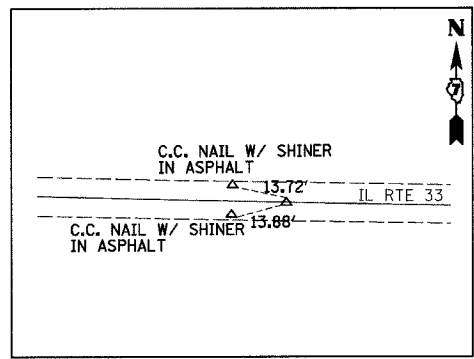

P.C. STA. 323+04.51
(MAG NAIL)

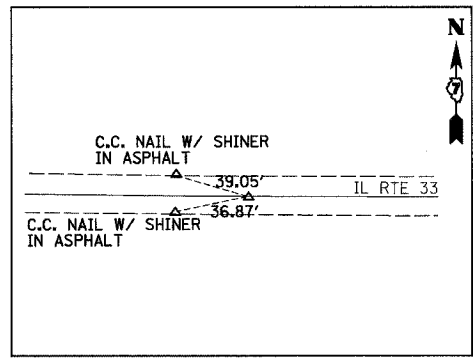

P.I. STA. 326+34.68
(MAG NAIL)

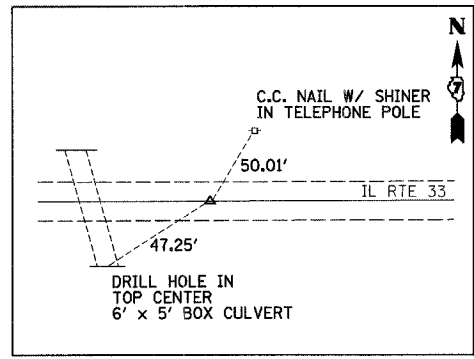

P.T. STA. 329+64.80
(MAG NAIL)

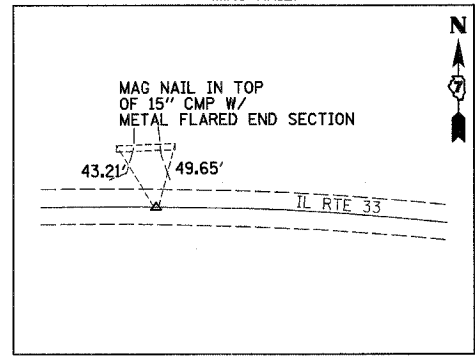

P.C. STA. 339+25.07
(MAG NAIL)

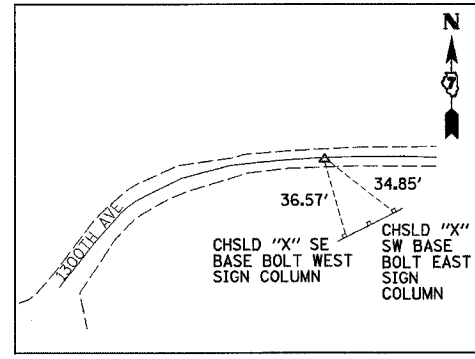

P.I. STA. 347+72.53
(MAG NAIL)

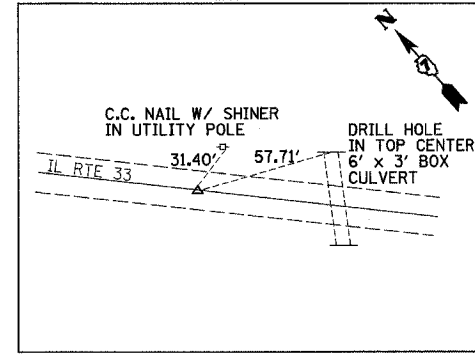

P.T. STA. EQUATION 355+20.31 BK
357+15.38 AH
(MAG NAIL)

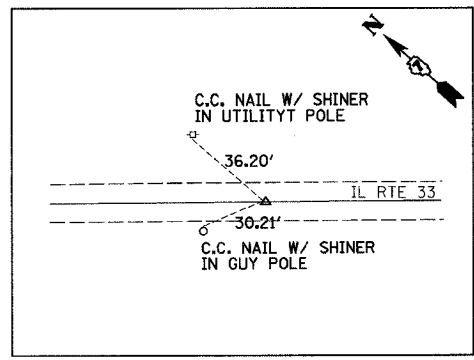

P.C. STA. 390+16.07
(MAG NAIL)

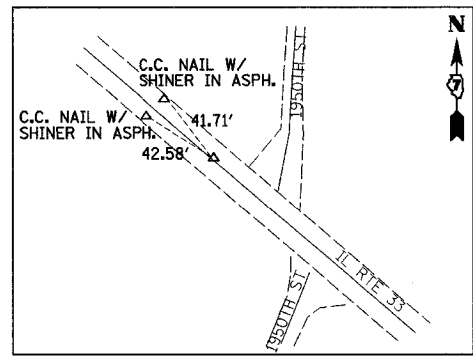

P.T. STA. 408+39.99
(MAG NAIL)

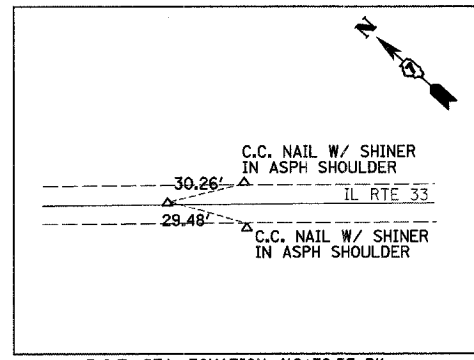

P.O.T. STA. EQUATION 412+78.37 BK
412+74.63 AH
(MAG NAIL)

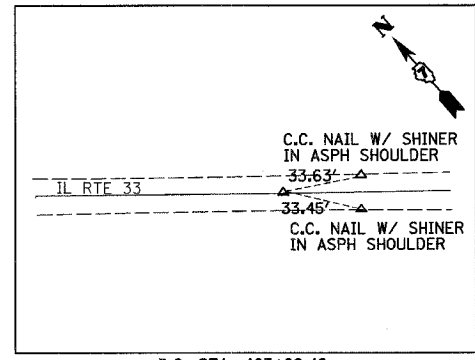

P.C. STA. 463+69.48
(MAG NAIL)

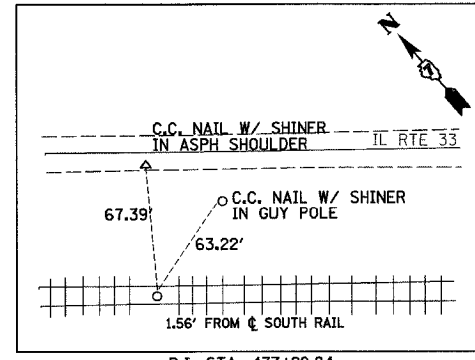

P.I. STA. 477+99.84
(5/8" IRON PIN)

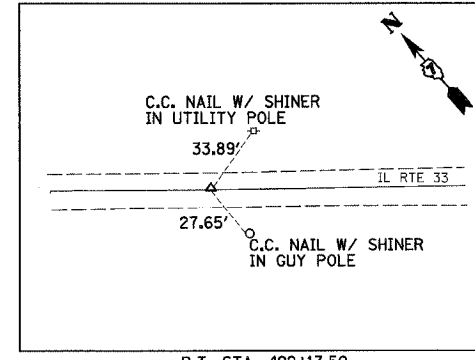

P.T. STA. 492+17.50
(MAG NAIL)

REVISIONS	
NAME	DATE

ILLINOIS DEPARTMENT OF TRANSPORTATION

CONTROL TIES
SHEET 1 OF 2

DATE 5/01

DRAWN BY MLO
CHECKED BY RW