

| | | | | |
|---|---------|-----------|--------------|-----------|
| F.A.P. RTE. | SECTION | COUNTY | TOTAL SHEETS | SHEET NO. |
| 95 | | EFFINGHAM | 409 | 28 |
| FED. ROAD DIST. NO. 7 ILLINOIS FED. AID PROJECT | | | | |
| *(6,7)Y, RS-1, 6B-1, 7B-1 & 7BR-2 | | | | |
| CONTRACT NO. 94356 | | | | |

EXIST CURVE RC2
 PI STA. = 639+28.81
 $\Delta = 7^{\circ} 27' 38''$ (LT)
 $D = 2^{\circ} 12' 13''$
 $R = 2,600.00'$
 $T = 169.51'$
 $L = 338.55'$
 $E = 5.52'$
 P.C. STA. = 637+59.29
 P.T. STA. = 640+97.84

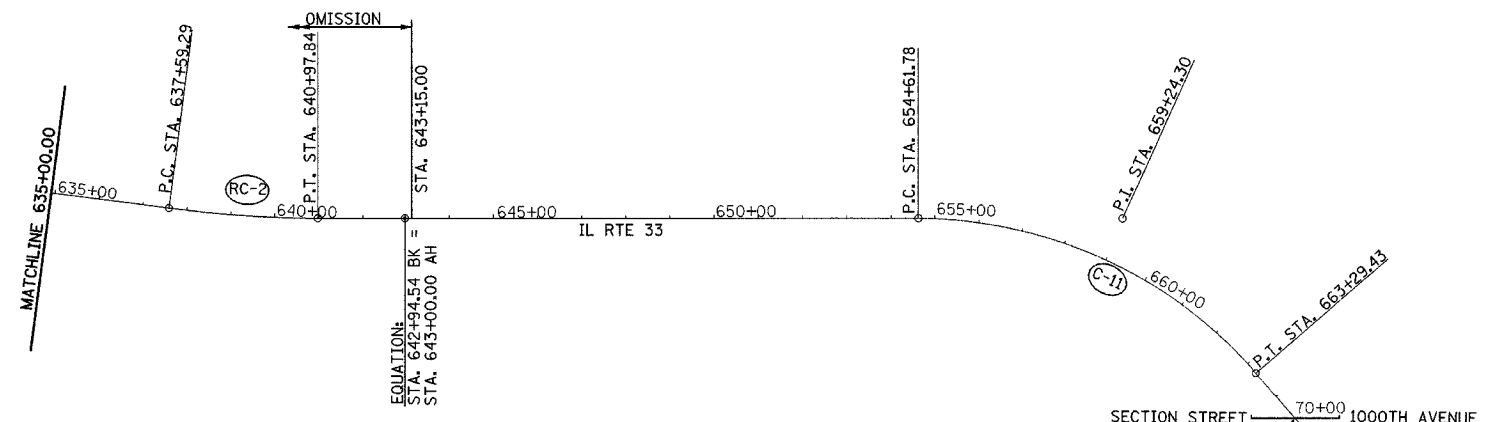

EXIST CURVE C-11
 PI STA. = 659+24.30
 $\Delta = 49^{\circ} 08' 10''$ (RT)
 $D = 5^{\circ} 39' 47''$
 $R = 1011.73'$
 $T = 462.52'$
 $L = 867.65'$
 $E = 100.71'$
 $e = 7.40\%$ (EXIST)
 T.R. = EXIST
 S.E. RUN = EXIST
 P.C. STA. = 654+61.78
 P.T. STA. = 663+29.43

EXIST CURVE C-12
 PI STA. = 683+37.79
 $\Delta = 32^{\circ} 01' 10''$ (LT)
 $D = 3^{\circ} 59' 31''$
 $R = 1435.26'$
 $T = 411.82'$
 $L = 802.08'$
 $E = 57.91'$
 $e = 7.00\%$ (EXIST)
 T.R. = EXIST
 S.E. RUN = EXIST
 P.C. STA. = 679+25.98
 P.T. STA. = 687+28.06

- TBM 1
16' LT STA. 148+09 EL 540.23
CHISELED "□" ON 6" BARRIER CURB EAST OF BIG SALT CREEK BRIDGE. APPROXIMATELY 41' WEST OF THE EAST END OF THE LEFT BRIDGE GUARDRAIL.
- IDOT BM 95033002
20.7' RT STA. 159+26.8 EL 588.14
SOUTHWEST QUAD RTE 33 & LANDFILL GOBBLER, 7'± SOUTH FROM THE BACK OF THE CURB & GUTTER ON RTE 33
- IDOT BM 95033003
711.9' RT STA. 183+39.5 EL 589.04
NO DESCRIPTION
- TBM 30
75' RT STA. 192+40 EL 588.53
"MAG" NAIL SET IN NW CORNER OF BITUMINOUS PARKING LOT
- TBM 4
30' LT STA. 205+74 EL 592.86
RR SPIKE IN POWER POLE
- TBM 31
31' LT STA. 212+42 EL 594.13
RR SPIKE IN POWER POLE
- IDOT BM 95033004
80.7' RT STA. 221+53.0 EL 592.65
SOUTHEAST QUAD RR CROSSING WITH TOWNSHIP RD 1300 NORTH 1600 EAST, 25'± EAST OF RD, 33'± SOUTH OF RR TRACKS
- TBM 5
36' LT STA. 234+28 EL 590.76
RR SPIKE IN POWER POLE
- IDOT BM 95033005
73.1' RT STA. 248+04.9 EL 593.87
SOUTHEAST QUAD RR CROSSING WITH TOWNSHIP RD 1300 NORTH 1650 EAST, SOUTH SIDE OF RR TRACKS
- TBM 32
31' LT STA. 263+07 EL 590.26
RR SPIKE IN POWER POLE
- IDOT BM 95033006
90.4' RT STA. 274+07 EL 586.98
SOUTHWEST QUAD RR CROSSING WITH TOWNSHIP RD 1300 NORTH 1700 EAST, SOUTH SIDE OF RR TRACKS JUST NORTH OF POWER POLE
- TBM 33
31' LT STA. 280+10 EL 592.88
RR SPIKE IN POWER POLE
- IDOT BM 95033007
96.6' RT STA. 300+88.9 EL 588.96
SOUTHWEST QUAD RR CROSSING WITH TOWNSHIP RD 1300 NORTH 1750 EAST, SOUTH SIDE OF RR TRACKS JUST NORTH OF POWER POLE
- TBM 34
41.9' LT STA. 306+85.9 EL 591.20
RR SPIKE IN POWER POLE
- TBM 7
40' RT STA. 315+00 EL 586.73
CHISELED "□" ON BOX CULVERT HEADWALL

- IDOT BM 95033008
109.6' RT STA. 327+28.1 EL 586.81
SOUTHWEST QUAD RR CROSSING WITH TOWNSHIP RD 1300 NORTH 1800 EAST, SOUTH SIDE OF RR TRACKS NORTHWEST OF OLD FENCE CORNER POST
- IDOT BM 95033009
78.9' RT STA. 346+32.4 EL 587.55
NORTHEAST QUAD RR CROSSING WITH WERNING CURVE, 22'± EAST OF ROCK PE & 33'± NORTH OF RR TRACKS
- TBM 35
31.0' LT STA. 355+20 EL 588.63
RR SPIKE IN POWER POLE
- TBM 36
31.0' LT STA. 366+87 EL 589.67
RR SPIKE IN POWER POLE
- TBM 10
25' LT STA. 376+00 EL 588.38
RR SPIKE IN POWER POLE
- IDOT BM 95033010
104.2' RT STA. 383+57.3 EL 585.69
SOUTHWEST QUAD RR CROSSING WITH TOWNSHIP RD 1250 NORTH 1925 EAST, SOUTH SIDE OF RR TRACKS NORTHEAST OF FENCE CORNER
- TBM 11
30' LT STA. 389+98 EL 584.30
RR SPIKE IN POWER POLE
- TBM 12
31' LT STA. 399+21 EL 586.36
RR SPIKE IN POWER POLE
- IDOT BM 95033011
60.5' RT STA. 409+81.9 EL 577.16
NORTHEAST QUAD RR CROSSING WITH TOWNSHIP RD 1250 NORTH 1950 EAST, 20'± NORTH OF TRACKS & 29'± EAST OF RD
- TBM 13
20' RT STA. 415+00 EL 570.60
5/8" Ø IRON PIN
- TBM 14
105' LT STA. 427+00 EL 563.18
TOP OF R.O.W. MARKER
- TBM 37
110.0' LT STA. 434+86 EL 565.85
RR SPIKE IN POWER POLE
- IDOT BM 95033012
61.1' RT STA. 444+01.5 EL 572.08
NORTHEAST QUAD RR CROSSING WITH TOWNSHIP RD 2000 EAST, 20'± NORTH OF RR TRACKS & 24'± EAST OF RD RR CROSSING JUST EAST OF MILE POST 170
- TBM 41
48' LT STA. 451+83 EL 574.20
CHSLD "□" ON TOP OF 36" RCP END SECTION
- TBM 42
88.0' LT STA. 459+95 EL 577.48
5/8" Ø IRON PIN - 6' S OF PETROLEUM WARNING SIGN

- STA. 664+64.86 (IL RTE 33) = STA. 70+00.00 (SECTION STREET)
- IDOT BM 95033013
96.7' RT STA. 471+11.3 EL 585.84
SOUTHWEST QUAD 2ND RR FIELD CROSSING, SOUTH OF RR TRACKS 1/2 MILE EAST OF TOWNSHIP RD 2000 EAST
- TBM 16
30' LT STA. 475+52 EL 587.49
WP 422 TOP OF IRON PIN 584.31
RR SPIKE IN POWER POLE
- TBM 17
30' LT STA. 489+95 EL 589.49
WP 423 TOP OF IRON PIN 586.44
RR SPIKE IN POWER POLE
- IDOT BM 95033014
83.6' RT STA. 491+10.6 EL 585.92
SOUTHEAST QUAD RR CROSSING, 0.34 MILE WEST OF TOWNSHIP RD 1100 NORTH 2100 EAST ON SOUTH SIDE OF RR TRACKS ON EAST SIDE OF PE
- TBM 38
31.0' LT STA. 496+90 EL 589.44
RR SPIKE IN POWER POLE
- IDOT BM 95033015
101.7' RT STA. 509+44.5 EL 586.15
SOUTHEAST QUAD RR CROSSING WITH TOWNSHIP RD 1100 NORTH 2100 EAST, 14'± EAST OF RD 32'± SOUTH OF RR TRACKS
- TBM 19
30' LT STA. 519+72 EL 589.34
RR SPIKE IN POWER POLE
- TBM 20
30' LT STA. 535+20 EL 581.50
RR SPIKE IN POWER POLE
- IDOT BM 95033016
86.8' RT STA. 539+85.4 EL 584.24
SOUTHEAST QUAD RR CROSSING 0.57 MILE EAST OF TOWNSHIP RD 2100 EAST ON EAST SIDE OF FE AND ON SOUTH SIDE OF RR TRACKS
- TBM 39
30.0' RT STA. 554+89 EL 589.44
RR SPIKE IN POWER POLE
- TBM 22
30' LT STA. 564+71 EL 594.19
RR SPIKE IN POWER POLE
- IDOT BM 95033017
90.0' RT STA. 570+29.6 EL 594.45
SOUTHWEST QUAD RR CROSSING WITH TOWNSHIP RD 1050 NORTH 2200 EAST, 15'± SOUTH OF RR TRACKS 15'± WEST OF RD

- TBM 23
32' LT STA. 578+77 EL 598.99
RR SPIKE IN POWER POLE
- IDOT BM 95033018
80.9' RT STA. 594+54.5 EL 606.45
2ND FE ON SOUTH SIDE OF RTE 33 1/2 MILE EAST 95033017 ON SOUTH SIDE OF RR TRACKS 6'±
- TBM 24
31' LT STA. 594+79 EL 608.08
RR SPIKE IN POWER POLE
- TBM 25
31' LT STA. 610+21 EL 605.18
RR SPIKE IN POWER POLE
- IDOT BM 95033019
129.0' RT STA. 617+74.1 EL 597.61
WEST SIDE OF DIETERICH 35'± EAST OF OAK ST 12'± SOUTH OF MAIN RR TRACKS & 15'± WEST OF NORTH WEST CORNER OLD CONC FOUNDATION ON SOUTH SIDE OF TRACKS
- TBM 27
25' RT STA. 644+31 EL 590.83
RR SPIKE IN POWER POLE
- IDOT BM 95033021
34.7' RT STA. 655+62.3 EL 589.78
158'± EAST OF E EAST ENTRANCE TO WINTERROWD AF & AM #664 27'± SOUTH OF RTE 33
- TBM 40
21.0' LT STA. 664+06 EL 599.21
RR SPIKE IN POWER POLE
- IDOT BM 95033023
83.0' RT STA. 689+62.55 EL 592.42
SOUTHEAST QUAD RR CROSSING AT COUNTY LINE RD EAST OF DIETERICH 12'± EAST OF E ROAD 12'± SOUTH OF E TRACKS

| REVISIONS | |
|-----------|------|
| NAME | DATE |
| | |
| | |
| | |
| | |
| | |
| | |
| | |
| | |
| | |
| | |

ILLINOIS DEPARTMENT OF TRANSPORTATION
HORIZONTAL ALIGNMENT PLAN AND BENCHMARKS
 SHEET 4 OF 4
 SCALE: 1"=200'
 DATE 11/14/01
 DRAWN BY TLS
 CHECKED BY RMD