

| | | | | |
|---|---------|-----------|--------------|-----------|
| F.A.P. RTE. | SECTION | COUNTY | TOTAL SHEETS | SHEET NO. |
| 95 | * | EFFINGHAM | 409 | 42 |
| FED. ROAD DIST. NO. 7 (ILLINOIS) FED. AID PROJECT | | | | |
| *(6,7)Y, RS-1, 6B-1, 7B-1 & 7BR-2 | | | | |
| CONTRACT NO. 94356 | | | | |

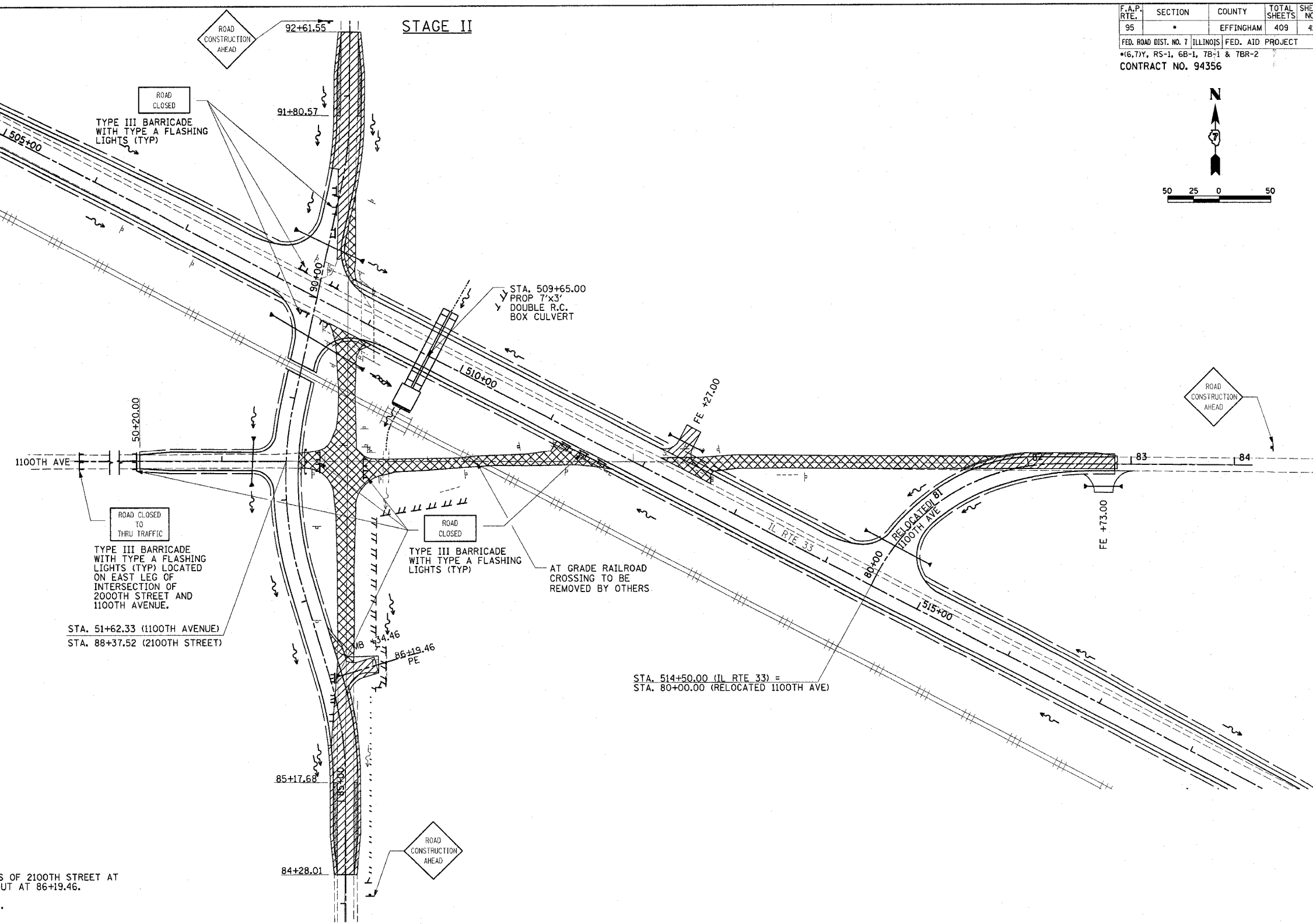
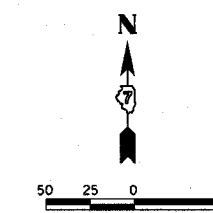

SUGGESTED SEQUENCE OF OPERATIONS

STAGE II:

1. MAINTAIN ACCESS TO ENTRANCES AT ALL TIMES.
2. UTILIZING STAGE CONSTRUCTION, CONSTRUCT ALTERNATE SIDES OF 2100TH STREET AT LOCATIONS SHOWN, INCLUDING ENTRANCE AND MAIL BOX TURNOUT AT 86+19.46.
3. SHIFT 2100TH STREET TRAFFIC TO RELOCATED 2100TH STREET.
4. OPEN 1100TH AVENUE WEST OF 2100TH STREET TO TRAFFIC.
5. UTILIZING STAGE CONSTRUCTION, CONSTRUCT ALTERNATE SIDES OF RELOCATED 1100TH ST INCLUDING FIELD ENTRANCE AT 82+73.00.
6. CONSTRUCT FIELD ENTRANCE AT STA. 512+27.00.
7. REMOVE REMAINING 2100TH STREET PAVEMENT AND A-3 SURFACING AT LOCATIONS SHOWN. REMOVE TEMPORARY CULVERT EXTENSION. REGRADE TO EAST DITCH ON 2100TH STREET (SEE CROSS SECTIONS).
8. REMOVE 1100TH AVENUE PAVEMENT AND A-3 SURFACING AT LOCATIONS SHOWN AND REGRADE (SEE CROSS SECTIONS).

LEGEND

- STAGE II CONSTRUCTION
- BASE COURSE WIDENING
- STAGE II REMOVAL

| REVISIONS | |
|-----------|------|
| NAME | DATE |
| | |
| | |
| | |
| | |
| | |
| | |
| | |
| | |
| | |

ILLINOIS DEPARTMENT OF TRANSPORTATION
STAGE II CONSTRUCTION
2100TH STREET AND 1100TH AVENUE
TRAFFIC CONTROL AND PROTECTION
(SPECIAL), LOCATION 2
 DRAWN BY TLS
 CHECKED BY BKB
 DATE 6/02

Revised 5/2/07