

PIPE CULVERTS, CLASS D, TYPE 1
EQUIVALENT ROUND-SIZE, 15"
STA. 160+04.70, 31' RT
LENGTH = 73'
UPSTREAM FLOWLINE = 587.09
DOWNSTREAM FLOWLINE = 584.98

PCRC 2'x2' EXTENSIONS
STA. 162+82.39
LENGTH = 5' LT
DOWNSTREAM FLOWLINE = 584.56 LT

MANHOLE TYPE A, 6' DIA., TY 1
FRAM & CLOSED LID
STA. 162+82.46, 30' LT
TOP LID = 589.30
30" NORTH = 571.50
2'x2' BOX SOUTH = 584.56

PIPE CULVERTS, CLASS A, TYPE 1, 30"
STA. 162+81.80, 33' LT TO
STA. 162+73.00, 63.2' LT
LENGTH = 31'
UPSTREAM FLOWLINE = 571.50
DOWNSTREAM FLOWLINE = 570.00

FURNISHING AND ERECTING RIGHT-OF-WAY MARKERS

70' LT STA. 156+00.00 1 EACH
70' RT STA. 156+00.00 1 EACH
70' LT STA. 159+00.00 1 EACH
50' LT STA. 160+00.00 1 EACH
70' RT STA. 160+50.00 1 EACH
50' LT STA. 162+00.00 1 EACH
50' RT STA. 162+00.00 1 EACH
70' LT STA. 162+65.00 1 EACH
130' LT STA. 162+65.00 1 EACH
85' LT STA. 163+00.00 1 EACH
130' LT STA. 163+00.00 1 EACH
50' LT STA. 164+00.00 1 EACH
50' RT STA. 169+50.00 1 EACH
TOTAL 13 EACH

| F.A.P. RTE. | SECTION | COUNTY | TOTAL SHEETS | SHEET NO. |
|---|---------|-----------|--------------|-----------|
| 95 | * | EFFINGHAM | 409 | 44 |
| STA. 156+00.00 TO STA. 170+00.00 | | | | |
| FED. ROAD DIST. NO. 7 ILLINOIS FED. AID PROJECT | | | | |
| *6.7Y, RS-1, 6B-1, 7B-1 & 7BR-2 | | | | |
| CONTRACT NO. 94356 | | | | |

END SECTIONS, EQUIVALENT ROUND-SIZE, 15"

32' RT STA. 159+68.22 1 EACH
30' RT STA. 160+41.01 1 EACH
TOTAL 2 EACH

PRECAST REINFORCED CONCRETE FLARED
END SECTION, 30"
STA. 162+73.00, 63.2' LT 1 EACH

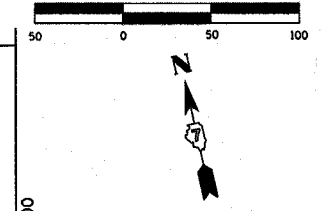
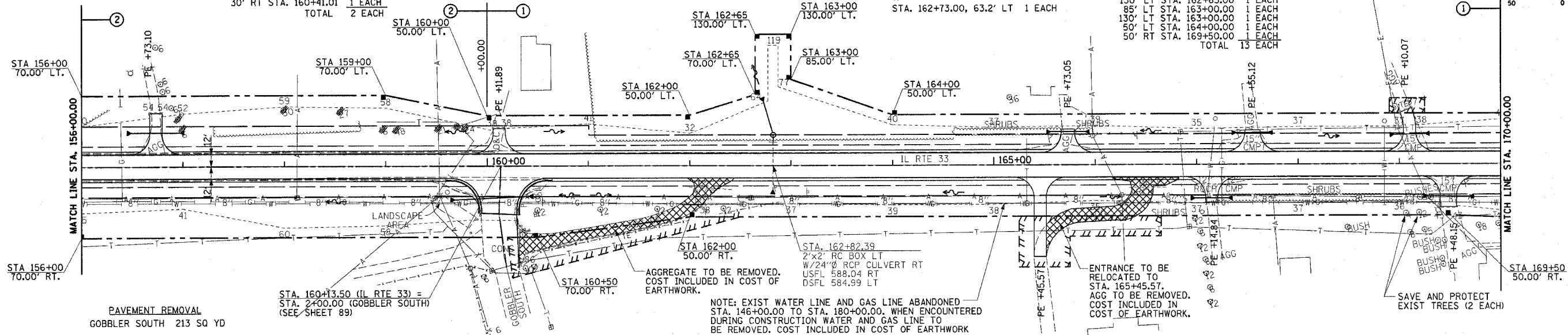

PAVEMENT REMOVAL
GOBBLER SOUTH 213 SQ YD

GUTTER REMOVAL
LT STA. 158+00.00 - STA. 160+10.00 210'
RT STA. 158+00.00 - STA. 160+60.00 260'
TOTAL 470'

COMBINATION CURB AND GUTTER REMOVAL AND REPLACEMENT
RT STA. 159+59.25 - STA. 159+94.14 55 LIN FT
RT STA. 160+29.12 - STA. 160+64.40 53 LIN FT
TOTAL 108 LIN FT

GUARD POST REMOVAL
48' RT STA. 159+93.47 1 EACH
59' RT STA. 160+33.58 1 EACH
62' RT STA. 160+37.04 1 EACH
63' RT STA. 160+41.39 1 EACH
TOTAL 4 EACH

PIPE CULVERTS, CLASS A, TYPE 1, 24" EXTENSIONS
STA. 162+82.39
LENGTH = 2' RT
UPSTREAM FLOWLINE = 588.25 RT

PRC FLARED END SECTION 24"
RT STA. 162+82.39 1 EACH

PERMANENT SURVEY MARKERS, TYPE 1
P.O.T. STA. 160+00.00 1 EACH

NOTE: EXIST WATER LINE AND GAS LINE ABANDONED
STA. 146+00.00 TO STA. 180+00.00. WHEN ENCOUNTERED
DURING CONSTRUCTION WATER AND GAS LINE TO
BE REMOVED. COST INCLUDED IN COST OF EARTHWORK.

ENTRANCE TO BE
RELOCATED TO
STA. 165+45.57.
AGG TO BE REMOVED.
COST INCLUDED IN
COST OF EARTHWORK.

SAVE AND PROTECT
EXIST TREES (2 EACH)

| DATE | BY |
|------|----|
| | |
| | |

| DATE | BY |
|------|----|
| | |
| | |

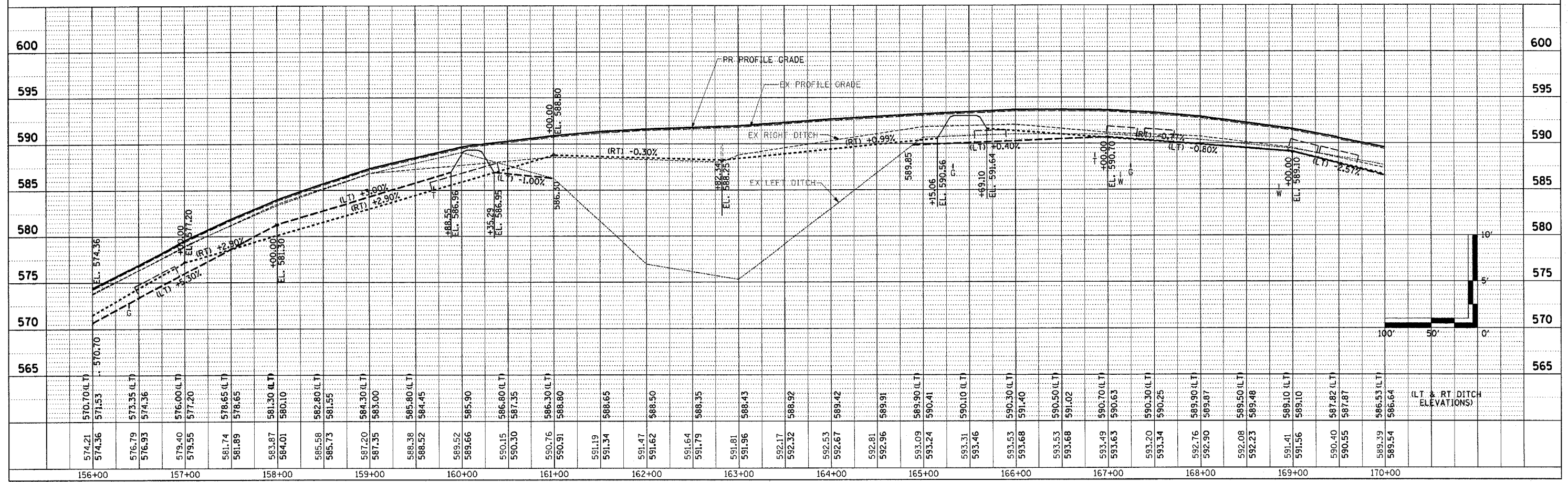

Revised 5/2/07