

DATE	
BY	
PLAN	
NO.	
CHECKED	
DATE	
BY	
NO.	

DATE	
BY	
PROFILE	
NO.	
CHECKED	
DATE	
BY	
NO.	

F.A.P. RTE.	SECTION	COUNTY	TOTAL SHEETS	SHEET NO.
95	*	EFFINGHAM	409	48
STA. 206+00.00 TO STA. 217+00.00				
FED. ROAD DIST. NO. 7 ILLINOIS FED. AID PROJECT				
* (6,7)Y, RS-1, 6B-1, 7B-1 & 7BR-2				
CONTRACT NO. 94356				



PCBC 3'x2' EXTENSIONS
 STA. 215+77.29
 LENGTH = 6' LT
 LENGTH = 10' RT
 UPSTREAM FLOWLINE = 589.45 LT
 DOWNSTREAM FLOWLINE = 588.70 RT

BOX CULVERT END SECTIONS CULV. NO. 7
 LT & RT STA. 215+77.29 2 EACH

REMOVE CONCRETE BOX CULVERT END SECTION
 LT & RT STA. 215+77.29 2 EACH

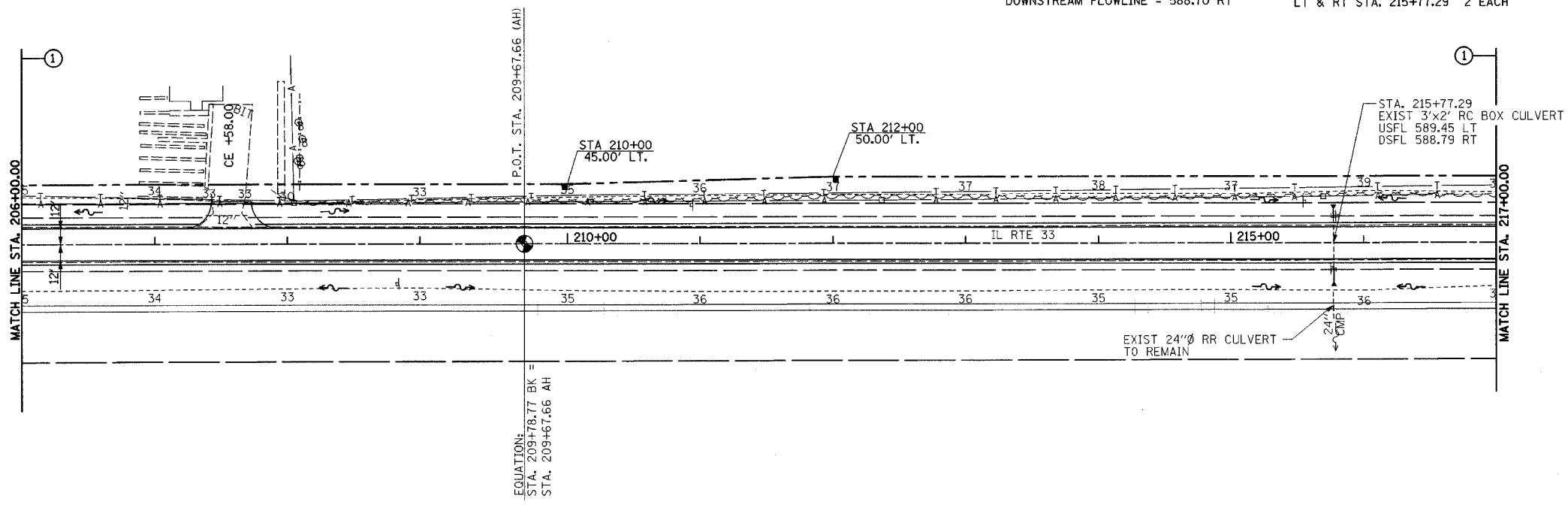

PERMANENT SURVEY MARKERS, TYPE I
 P.O.T. STA. 209+67.66 (AH) 1 EACH

FURNISHING AND ERECTING RIGHT-OF-WAY MARKERS
 45' LT STA. 210+00.00 1 EACH
 50' LT STA. 212+00.00 1 EACH
 TOTAL 2 EACH

