

F.A.P. RTE.	SECTION	COUNTY	TOTAL SHEETS	SHEET NO.
95	*	EFFINGHAM	409	50
STA. 229+00.00		TO STA. 241+00.00		
FED. ROAD DIST. NO. 7		ILLINOIS		FED. AID PROJECT
*(6,7)Y, RS-1, 6B-1, 7B-1 & 7B-2				
CONTRACT NO. 94356				

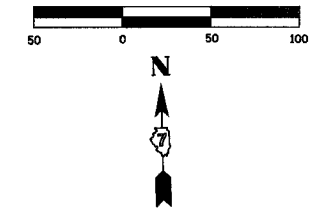

DATE	
BY	
REVISION	
NO.	
PLAN	
NO.	
NO.	
NO.	
NO.	

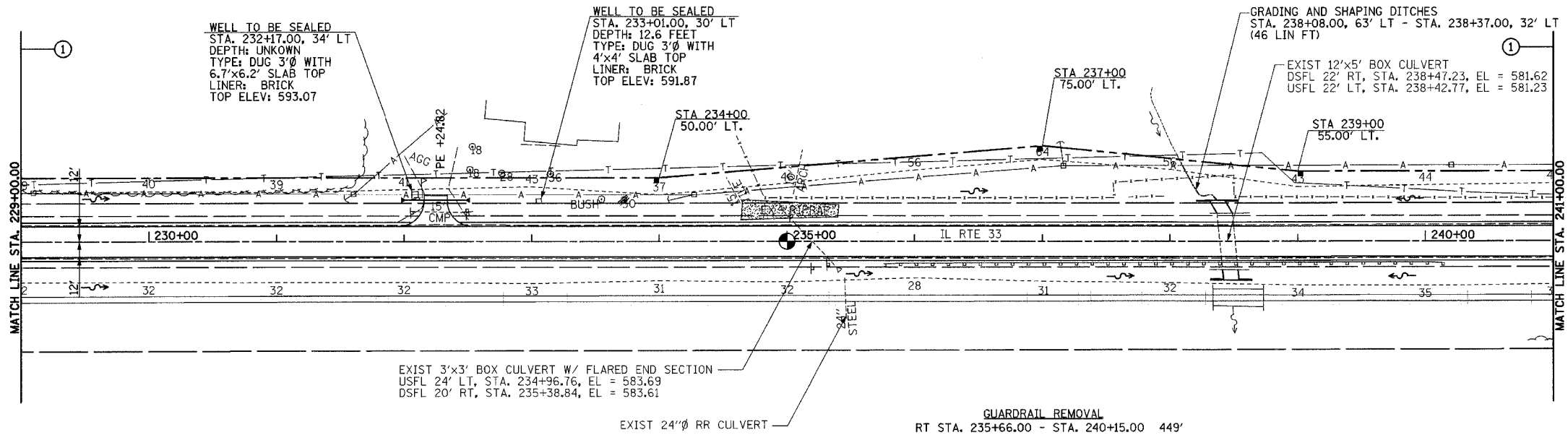

- PERMANENT SURVEY MARKERS, TYPE I**  
P.O.T. STA. 235+00.00 1 EACH
- FURNISHING AND ERECTING RIGHT-OF-WAY MARKERS**  
50' LT STA. 234+00.00 1 EACH  
75' LT STA. 237+00.00 1 EACH  
55' LT STA. 239+00.00 1 EACH  
TOTAL 3 EACH

**SEALING ABANDONED WATER WELLS**  
34' LT STA. 232+17.00 1 EACH  
30' LT STA. 233+01.00 1 EACH  
TOTAL 2 EACH

**FILLING EXISTING CULVERTS**  
C STA. 235+19.52 20 CU YD  
C STA. 235+46.00 4 CU YD  
TOTAL 24 CU YD

**FLARED END SECTION REMOVAL**  
24' LT STA. 234+96.76 1 EACH  
20' RT STA. 235+38.84 1 EACH  
TOTAL 2 EACH

**12'x5' CAST-IN-PLACE CULVERT EXTENSION**  
STA. 238+44.88  
LENGTH = 11.5' LT 30° SKEW (RT FWD)  
LENGTH = 8' RT 6° SKEW (RT FWD)  
UPSTREAM FLOWLINE = 581.70  
DOWNSTREAM FLOWLINE = 581.10  
(SEE DETAIL SHEET 144 & 145)

DATE	
BY	
REVISION	
NO.	
PROFILE	
NO.	
NO.	
NO.	
NO.	

