

F.A.P. RTE.	SECTION	COUNTY	TOTAL SHEETS	SHEET NO.
95	*	EFFINGHAM	409	52
STA. 253+00.00 TO STA. 265+00.00				
FED. ROAD DIST. NO. 7 ILLINOIS FED. AID PROJECT				
* (6,7)Y, RS-1, 6B-1, 7B-1 & 7BR-2				
CONTRACT NO. 94356				

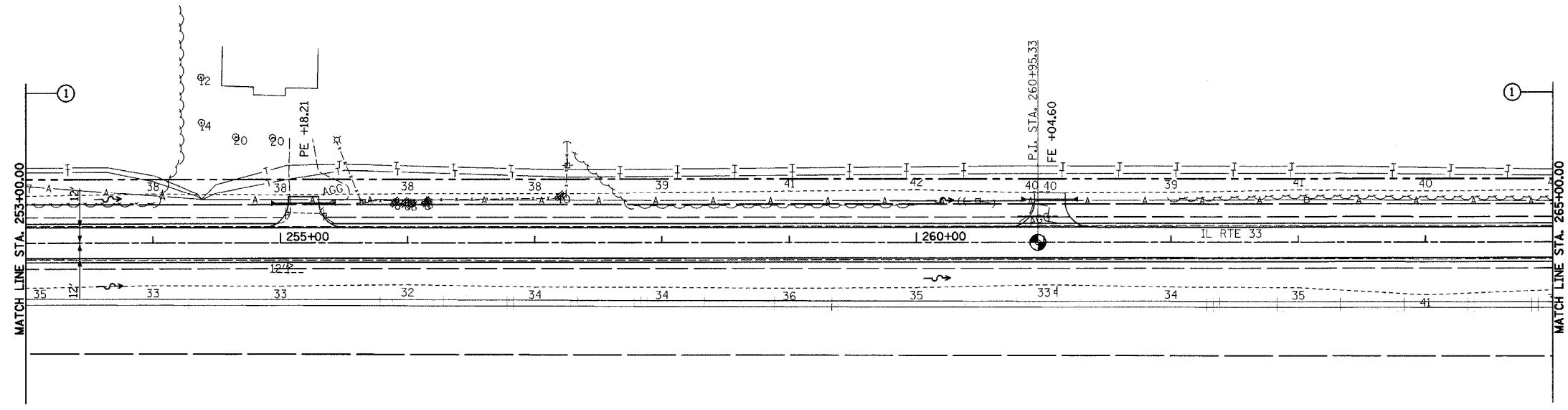

PERMANENT SURVEY MARKERS, TYPE I  
P.I. STA. 260+95.33 1 EACH

PLAN	DATE
DATE	
BY	
PROJECT	
NO.	



PROFILE	DATE
DATE	
BY	
PROJECT	
NO.	

