

DATE	
BY	
PLAN	
REVISIONS	
NO.	
DATE	
BY	
DESCRIPTION	

DATE	
BY	
PROFILE	
REVISIONS	
NO.	
DATE	
BY	
DESCRIPTION	

F.A.P. RTE.	SECTION	COUNTY	TOTAL SHEETS	SHEET NO.
95	*	EFFINGHAM	409	53
STA. 265+00.00 TO STA. 277+00.00				
FED. ROAD DIST. NO. 7 ILLINOIS FED. AID PROJECT				
*(6,7)Y, RS-1, 6B-1, 7B-1 & 7B-2				
CONTRACT NO. 94356				

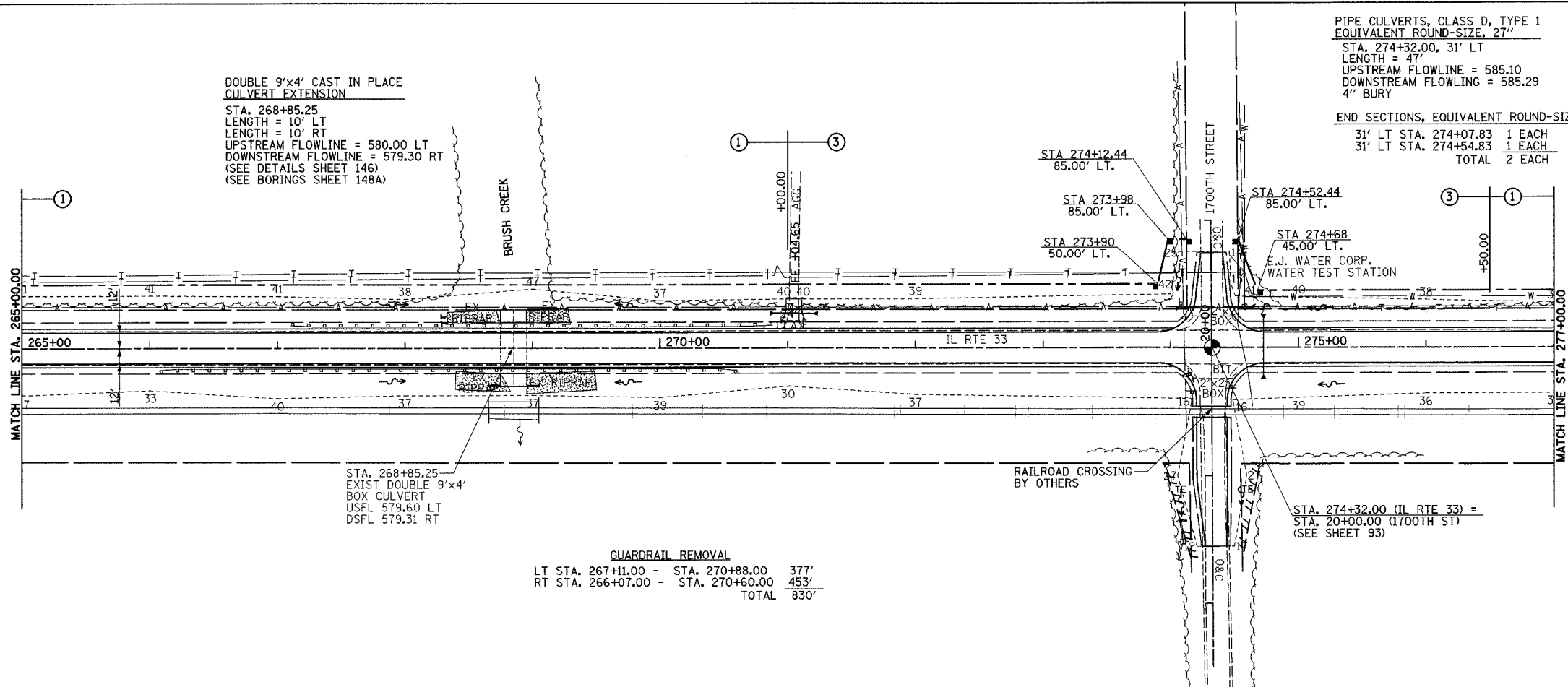
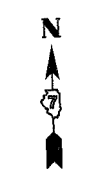

PIPE CULVERTS, TYPE 1 REINFORCED CONCRETE-ELLIPTICAL, EQUIVALENT ROUND SIZE 24"

STA. 274+72.57
LENGTH = 43'
OFFSET = 22' LT - 21' RT
UPSTREAM FLOWLINE = 585.85 RT
DOWNSTREAM FLOWLINE = 585.69 LT

PRC FLARED END SECTIONS ELLIPTICAL, EQUIVALENT ROUND SIZE 24"

LT & RT STA. 274+72.57 2 EACH

BOX CULVERT REMOVAL

1700TH ST N 32'
1700TH ST S 32'
TOTAL 64'

PAVEMENT REMOVAL
1700TH ST S 94 SQ YD

PERMANENT SURVEY MARKERS, TYPE I
P.O.T. STA. 274+32.00 1 EACH

FURNISHING AND ERECTING RIGHT-OF-WAY MARKERS

50' LT STA. 273+90.00 1 EACH
85' LT STA. 273+98.00 1 EACH
85' LT STA. 274+12.44 1 EACH
85' LT STA. 274+52.44 1 EACH
45' LT STA. 274+68.00 1 EACH
TOTAL 5 EACH

GUARDRAIL REMOVAL
LT STA. 267+11.00 - STA. 270+88.00 377'
RT STA. 266+07.00 - STA. 270+60.00 453'
TOTAL 830'

