

DATE	
BY	
PLAN	SURVEYED
	NOTE BOOK
	ALIGNED
	CHECKED
	FILED
	NO.

DATE	
BY	
PROFILE	SURVEYED
	GRADES
	CHECKED
	FILED
	NO.

PIPE CULVERTS, TYPE 1,
REINFORCED CONCRETE
ELLIPTICAL, EQUIVALENT
ROUND-SIZE, 24"
STA. 300+60.00
LENGTH = 52'
OFFSET = 27' LT - 25' RT
UPSTREAM FLOWLINE = 588.05 RT
DOWNSTREAM FLOWLINE = 587.23 LT

FLARED END SECTION REMOVAL
RT STA. 300+89.50 1 EACH

FILLING EXISTING CULVERTS
LT STA. 300+89.50 8 CU YD

PRC FLARED END SECTIONS ELLIPTICAL,
EQUIVALENT ROUND-SIZE, 24"
LT & RT STA. 300+60.00 2 EACH

F.A.P. RTE.	SECTION	COUNTY	TOTAL SHEETS	SHEET NO.
95	*	EFFINGHAM	409	55
STA. 289+00.00		TO STA. 301+00.00		
FED. ROAD DIST. NO. 7		ILLINOIS	FED. AID PROJECT	
* (6,7)Y, RS-1, 6B-1, 7B-1 & 7BR-2		CONTRACT NO. 94356		

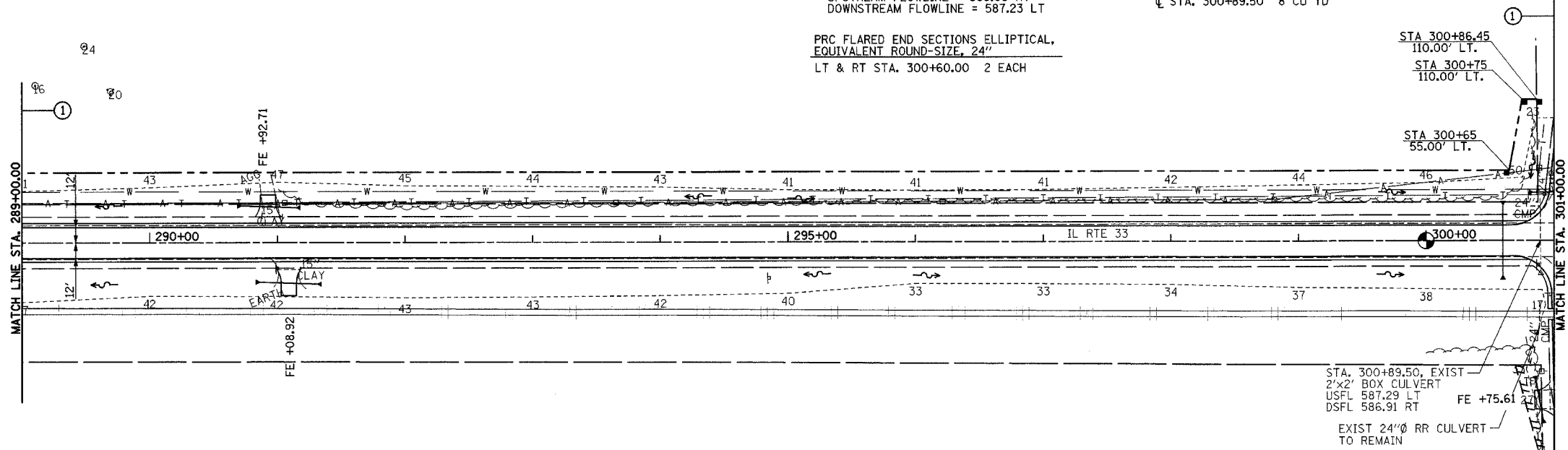
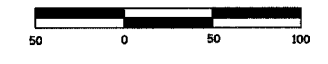

PERMANENT SURVEY MARKERS, TYPE J
P.O.T. STA. 300+00.00 1 EACH

FURNISHING AND ERECTING RIGHT-OF-WAY MARKERS
55' LT STA. 300+65.00 1 EACH
110' LT STA. 300+75.00 1 EACH
110' LT STA. 300+86.45 1 EACH
TOTAL 3 EACH

