

| F.A.P. RTE. | SECTION | COUNTY | TOTAL SHEETS | SHEET NO. |
|---|---------|-----------|--------------|-----------|
| 95 | * | EFFINGHAM | 409 | 65 |
| STA. 409+00.00 TO STA. 420+00.00 | | | | |
| FED. ROAD DIST. NO. 7 ILLINOIS FED. AID PROJECT | | | | |
| *(6,7)Y, RS-1, 6B-1, 7B-1 & 7B-2 | | | | |
| CONTRACT NO. 94356 | | | | |

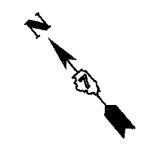

FURNISHING AND ERECTING RIGHT-OF-WAY MARKERS

80' LT STA. 409+00.00 1 EACH
 70' LT STA. 409+50.00 1 EACH
 TOTAL 2 EACH

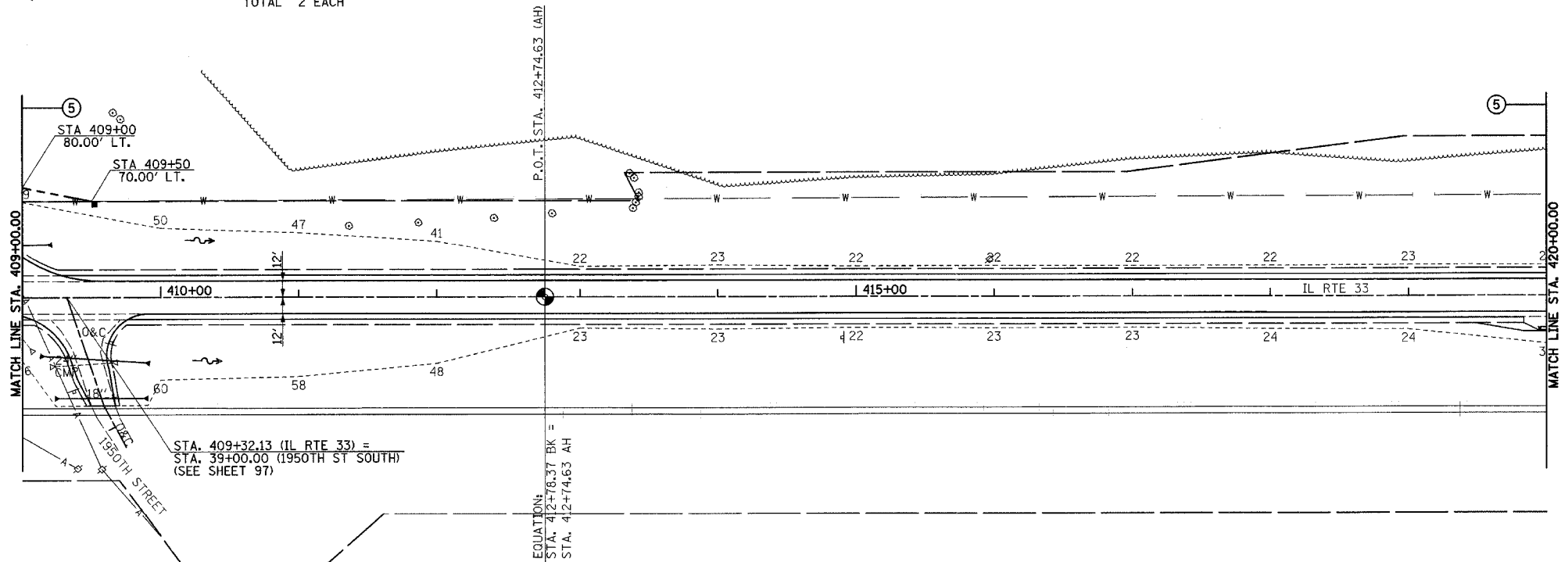

PERMANENT SURVEY MARKERS, TYPE I
 P.O.T. STA. 412+74.63 (AH) 1 EACH

| | |
|----------|--|
| DATE | |
| BY | |
| REVISION | |
| NO. | |

| | |
|----------|--|
| DATE | |
| BY | |
| REVISION | |
| NO. | |

PIPE CULVERTS, CLASS D, TYPE 1, 24"
 STA. 409+52.36, 45' RT
 LENGTH = 71'
 UPSTREAM FLOWLINE = 575.41
 DOWNSTREAM FLOWLINE = 573.33

END SECTIONS, 24"
 43' RT STA. 409+16.46 1 EACH
 47' RT STA. 409+88.27 1 EACH
 TOTAL 2 EACH

PIPE CULVERTS, CLASS D, TYPE 1, 18"
 STA. 409+55.14, 73' RT
 LENGTH = 60'
 UPSTREAM FLOWLINE = 574.50
 DOWNSTREAM FLOWLINE = 573.80

END SECTIONS, 18"
 73' RT STA. 409+27.04 1 EACH
 73' RT STA. 409+87.04 1 EACH
 TOTAL 2 EACH

