

DATE: _____ BY: _____
 SURVEYED _____
 PLAN _____
 NOTE BOOK _____
 RT. OF WAY CHECKED _____
 DATE FILE NAME _____

DATE: _____ BY: _____
 SURVEYED _____
 PROFILE _____
 NOTE BOOK _____
 RT. OF WAY CHECKED _____
 DATE FILE NAME _____

F.A.P. RTE.	SECTION	COUNTY	TOTAL SHEETS	SHEET NO.
95	*	EFFINGHAM	409	78
STA. 563+00.00 TO STA. 575+00.00				
FED. ROAD DIST. NO. 7 ILLINOIS FED. AID PROJECT				
*(6,7)Y, RS-1, 6B-1, 7B-1 & 7BR-2				
CONTRACT NO. 94356				

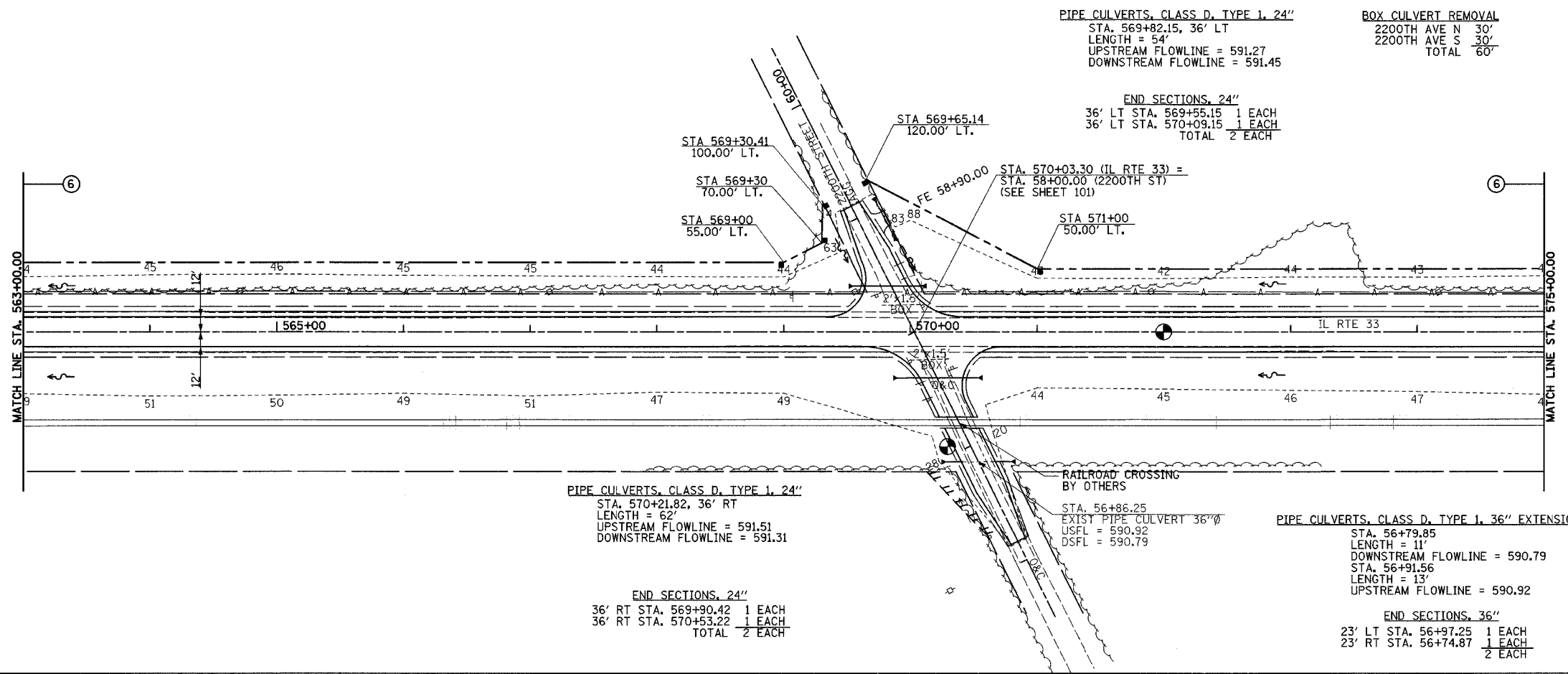
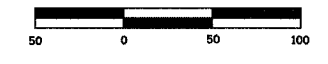

- PERMANENT SURVEY MARKERS, TYPE 1**
 P.O.T. STA. 572+00.00 1 EACH
- FURNISHING AND ERECTING RIGHT-OF-WAY MARKERS**
- 55' LT STA. 569+00.00 1 EACH
 - 70' LT STA. 569+30.00 1 EACH
 - 100.00' LT STA. 569+30.41 1 EACH
 - 120' LT STA. 569+65.14 1 EACH
 - 50' LT STA. 571+00.00 1 EACH
 - TOTAL 5 EACH**

