

F.A.P. RTE.	SECTION	COUNTY	TOTAL SHEETS	SHEET NO.
95	*	EFFINGHAM	409	86
STA. 659+00.00 TO STA. 671+00.00				
FED. ROAD DIST. NO. 7 ILLINOIS FED. AID PROJECT				
* (6,7)Y, RS-1, 6B-1, 7B-1 & 7B-2				
CONTRACT NO. 94356				

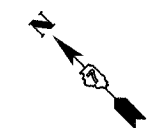

DATE	
BY	
NO.	
PLANNING	
DESIGN	
CHECKING	
DATE	

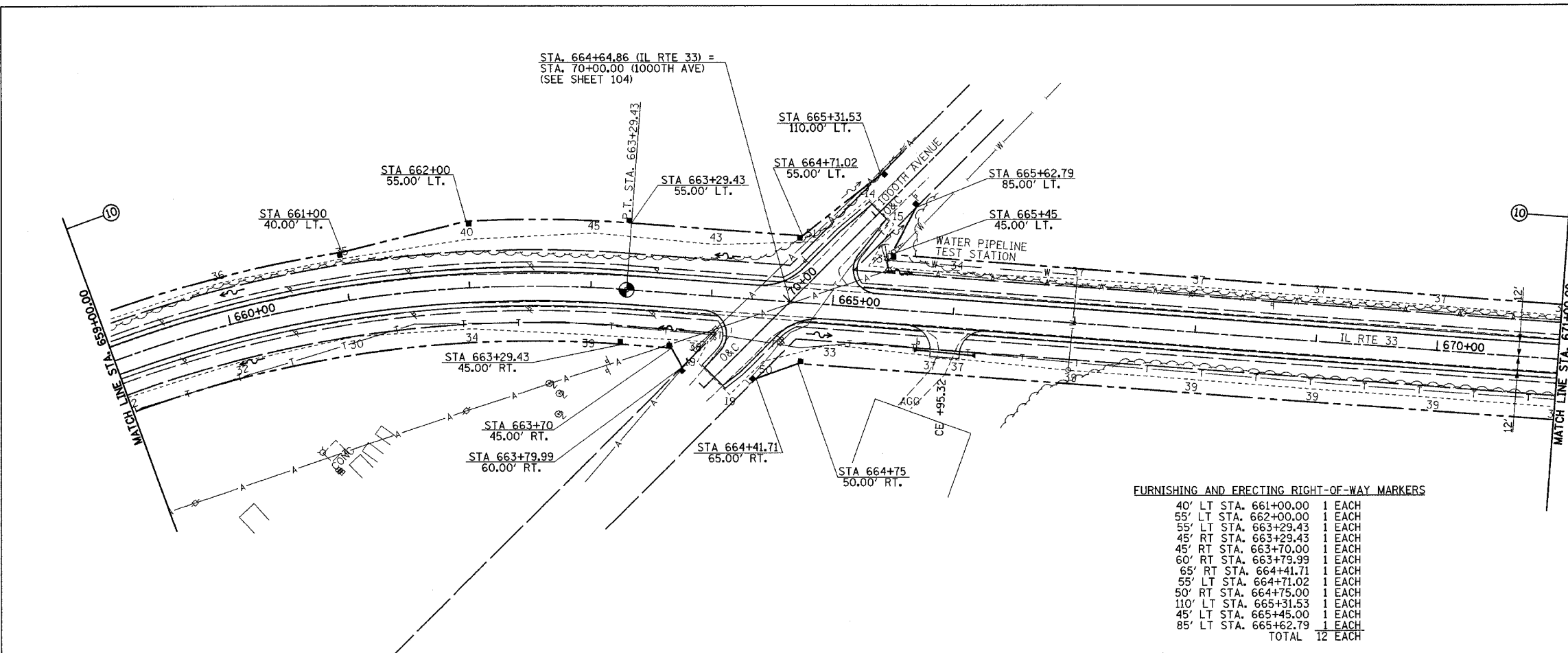

PERMANENT SURVEY MARKERS, TYPE 1
 P.T. STA. 663+29.43 1 EACH
 P.O.T. STA. 671+00.00 1 EACH
 TOTAL 2 EACH

FURNISHING AND ERECTING RIGHT-OF-WAY MARKERS

40' LT STA. 661+00.00	1 EACH
55' LT STA. 662+00.00	1 EACH
55' LT STA. 663+29.43	1 EACH
45' RT STA. 663+29.43	1 EACH
45' RT STA. 663+70.00	1 EACH
60' RT STA. 663+79.99	1 EACH
65' RT STA. 664+41.71	1 EACH
55' LT STA. 664+71.02	1 EACH
50' RT STA. 664+75.00	1 EACH
110' LT STA. 665+31.53	1 EACH
45' LT STA. 665+45.00	1 EACH
85' LT STA. 665+62.79	1 EACH
TOTAL	12 EACH

METER VAULTS TO BE ADJUSTED
 RT STA. 666+97.73 1 EACH

DATE	
BY	
NO.	
PROFILE	
DESIGN	
CHECKING	
DATE	

