

steffenmk  
3/12/2007  
c:\projects\94911d\05403pa.dgn

MILL

FAP EST.	SECTION	COUNTY	TOTAL SHEETS	SHEET NO.
116	123RS-3 122RS-4	RICHLAND	27	8
FED. ROAD DIST. NO. 7		BLMERS	FED. AID PROJECT NO.	

CONTRACT NO. 94911

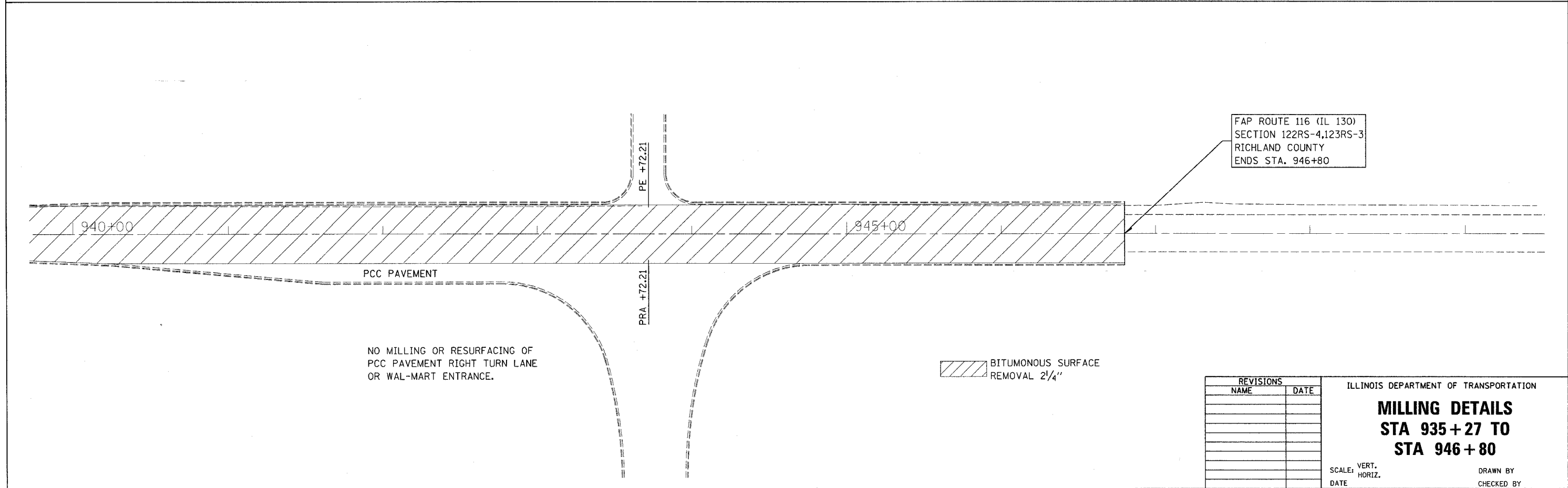
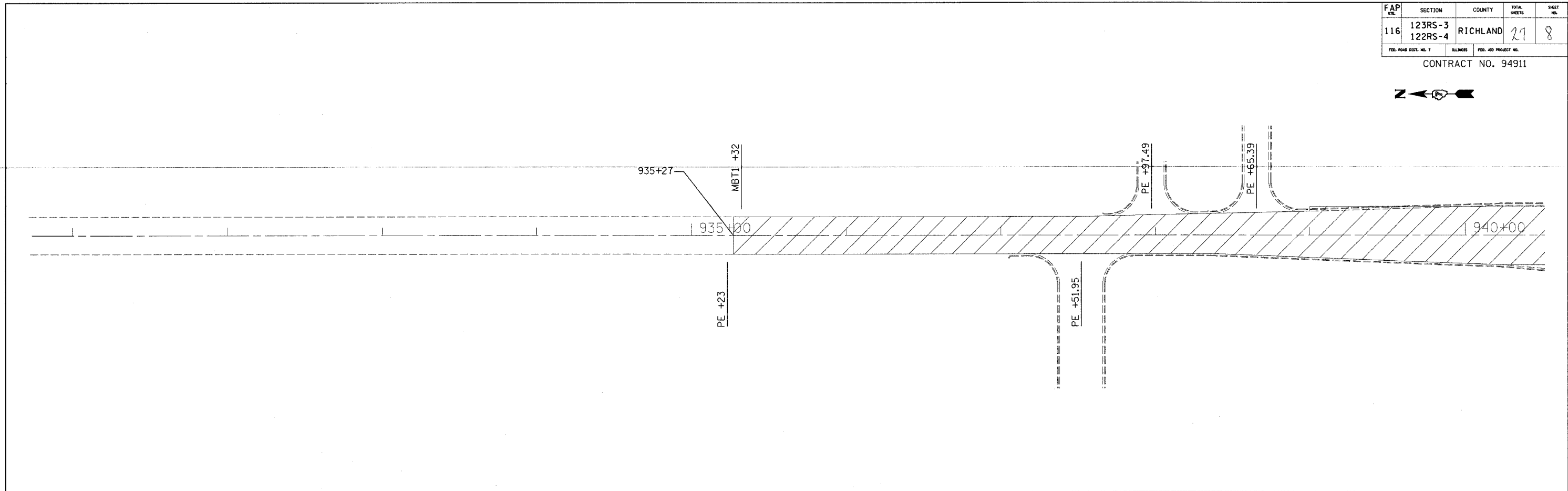
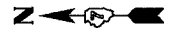

FAP ROUTE 116 (IL 130)  
SECTION 122RS-4,123RS-3  
RICHLAND COUNTY  
ENDS STA. 946+80

NO MILLING OR RESURFACING OF  
PCC PAVEMENT RIGHT TURN LANE  
OR WAL-MART ENTRANCE.

BITUMINOUS SURFACE  
REMOVAL 2 1/4"

REVISIONS	
NAME	DATE

ILLINOIS DEPARTMENT OF TRANSPORTATION

**MILLING DETAILS**  
**STA 935 + 27 TO**  
**STA 946 + 80**

SCALE: VERT.  
HORIZ.  
DATE

DRAWN BY  
CHECKED BY