

F.A.U. RTE.	SECTION	COUNTY	TOTAL SHEETS	SHEET NO.
8419	99-00048-01-PV	FAYETTE	142	52

CONTRACT NO. 95500  
REVISED 4-13-07

ILLINOIS FED. AID PROJECT  
REMOVED

TO STA. 606+60

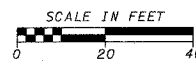
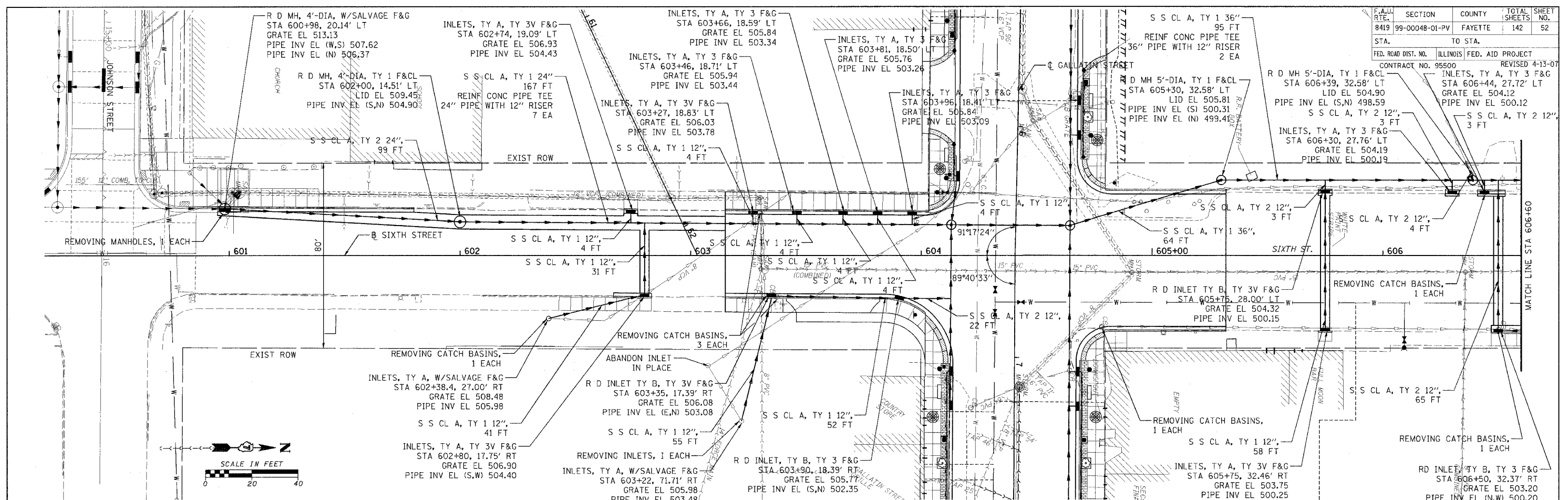

**ABBREVIATIONS**

- S S CL A, TY 1 = STORM SEWERS CLASS A, TYPE 1
- S S CL A, TY 2 = STORM SEWERS CLASS A, TYPE 2
- INLETS, TY A, TY 3V F&G = INLETS, TYPE A, TYPE 3V FRAME AND GRATE
- INLETS, TY B, TY 3V F&G = INLETS, TYPE B, TYPE 3V FRAME AND GRATE
- INLETS, TY A, W/SALVAGE F&G = INLETS, TYPE A, WITH SALVAGE FRAME AND GRATE
- R D INLET TY B, TY 3V F&G = RESTRICTED DEPTH INLET TYPE B, TYPE 3V FRAME AND GRATE
- R D INLET TY B, TY 1 F&CL = RESTRICTED DEPTH INLET TYPE B, TYPE 1 FRAME AND CLOSED LID
- R D MH, 4'-DIA, TY 1 F&CL = RESTRICTED DEPTH MANHOLE, 4'-DIAMETER, TYPE 1 FRAME AND CLOSED LID
- R D MH, 5'-DIA, TY 1 F&CL = RESTRICTED DEPTH MANHOLE, 5'-DIAMETER, TYPE 1 FRAME AND CLOSED LID
- R D MH, 4'-DIA, W/SALVAGE F&G = RESTRICTED DEPTH MANHOLE, 4'-DIAMETER, WITH SALVAGE FRAME AND GRATE

**LEGEND**

- PROPOSED SEWER
- ⊙ PROPOSED MANHOLE
- PROPOSED INLET

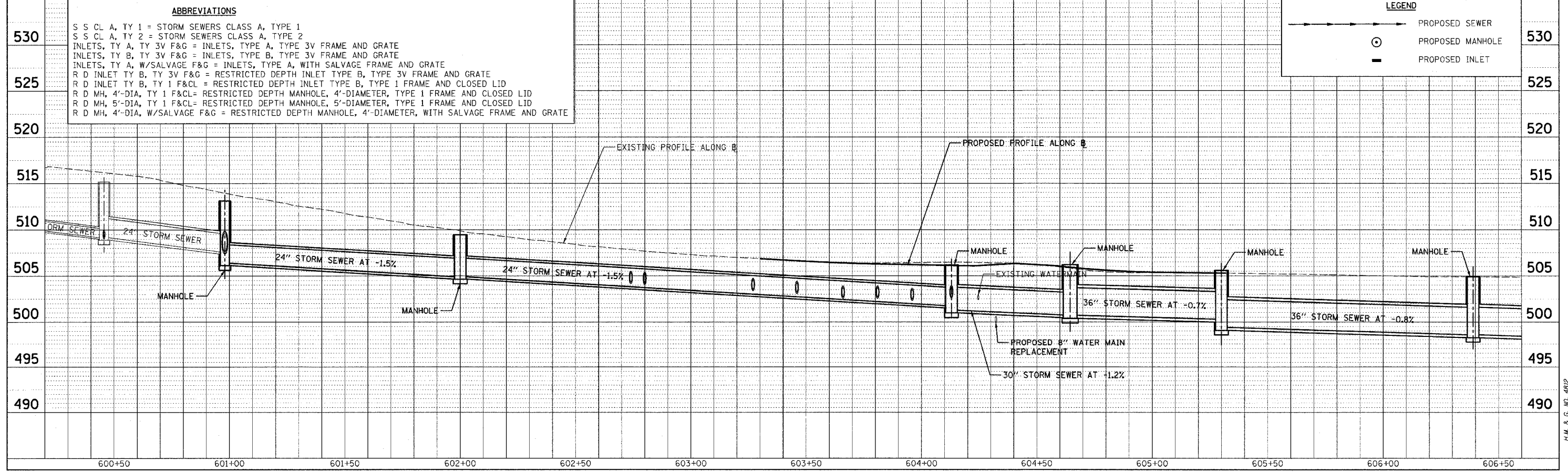

PLAN	DATE
REVISION	
NO.	
BY	
DATE	

PROFILE	DATE
REVISION	
NO.	
BY	
DATE	

CADD FILE: /4812/ss-S14th-01.dgn  
PLOTTED: 5/9/2007

H.M. & G. INC. 4812