

CENTERLINE CURVE DATA
 P.I. STA. = 127+60.32
 Δ = 21°-32'-17"
 D = 11'-30"-00"
 R = 3819.72'
 L = 726.51'
 T = 1435.87'
 E = 68.48'
 S.E. = 3/16"/FT.
 S.A. = STA. 119+00 TO STA. 121+00
 S.R. = STA. 133+00 TO 135+00

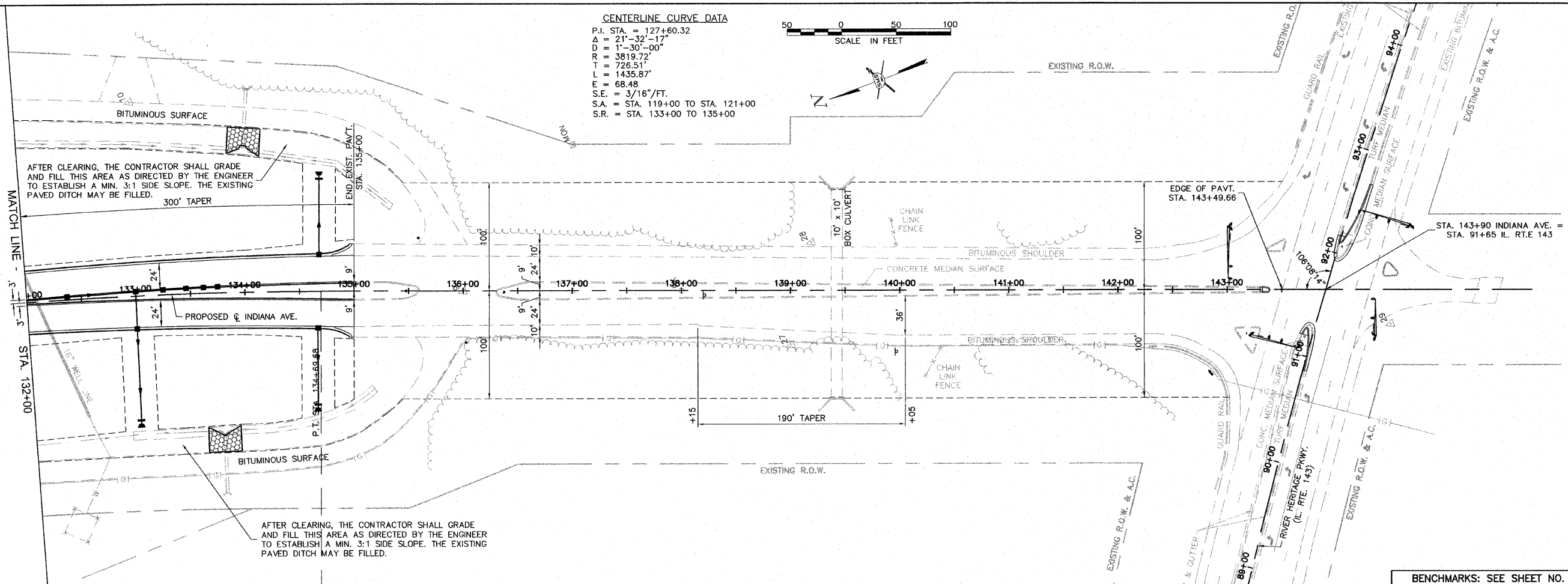
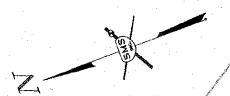
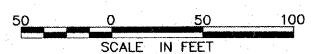

AFTER CLEARING, THE CONTRACTOR SHALL GRADE AND FILL THIS AREA AS DIRECTED BY THE ENGINEER TO ESTABLISH A MIN. 3:1 SIDE SLOPE. THE EXISTING PAVED DITCH MAY BE FILLED.

AFTER CLEARING, THE CONTRACTOR SHALL GRADE AND FILL THIS AREA AS DIRECTED BY THE ENGINEER TO ESTABLISH A MIN. 3:1 SIDE SLOPE. THE EXISTING PAVED DITCH MAY BE FILLED.

BENCHMARKS: SEE SHEET NO. 2

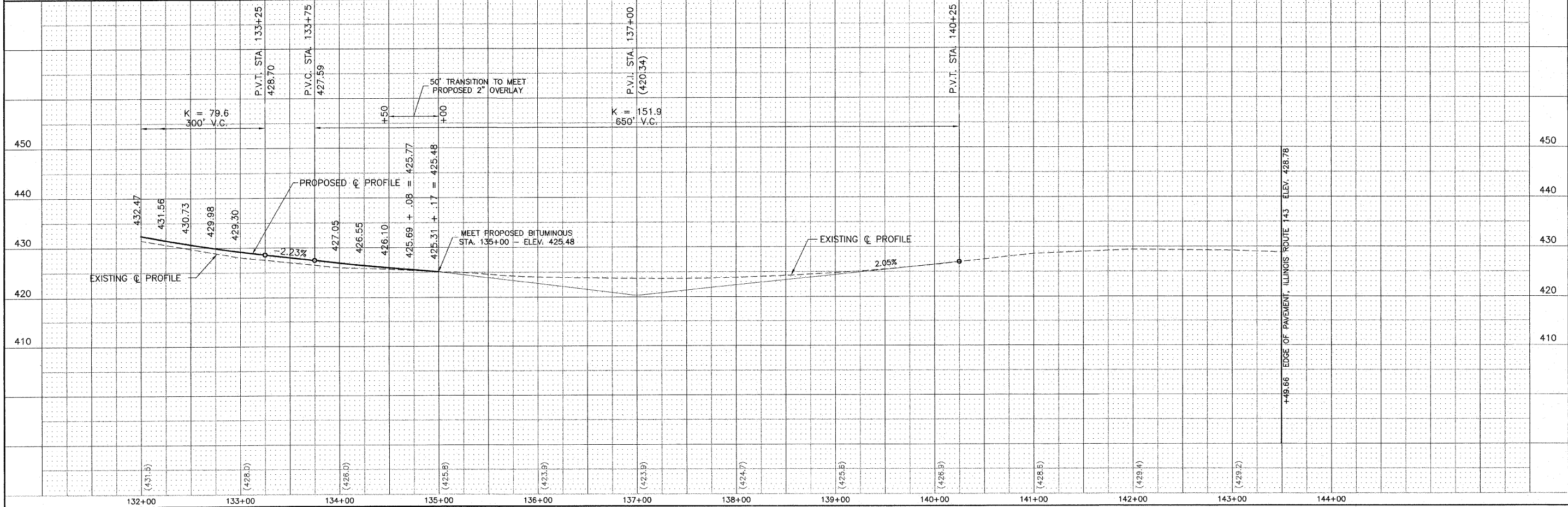

NO.	DESCRIPTION

SMS ENGINEERS
 Sheppard, Morgan & Schwaab, Inc.
 CONSULTING ENGINEERS AND LAND SURVEYORS
 215 Market Street, P.O. Box E, Alton, IL 62002 618462-2755 E-mail: mail@smsengineers.com
 10 Central Industrial Drive, Granite City, IL 62040 618377-2700 E-mail: mail@smsengineers.com
 DESIGN FIRM # 184-000992

CITY OF ALTON, ILLINOIS
 SECTION 06 - 00208 - 02 - RP
 CPL. CHRIS BELCHIK MEMORIAL EXPRESSWAY
 PLAN AND PROFILE

DWG. NO.	PH III 132-BERM PP.DWG
REF. BK.	INDIANA AVE.
JOB NO.	406365.1
DSN. BY:	DEG
DWN. BY:	CAD
CHK. BY:	DEG
DATE:	OCTOBER, 2006
SCALE:	1" = 50' H. 1" = 10' V.
SHEET	15 OF 61

S:\Land Projects\Alton Indiana Ph III 406365.dwg\Ph III 132-Berm PP.dwg 2/19/2007 11:55:22 AM Jman 150