

EXISTING R.O.W.

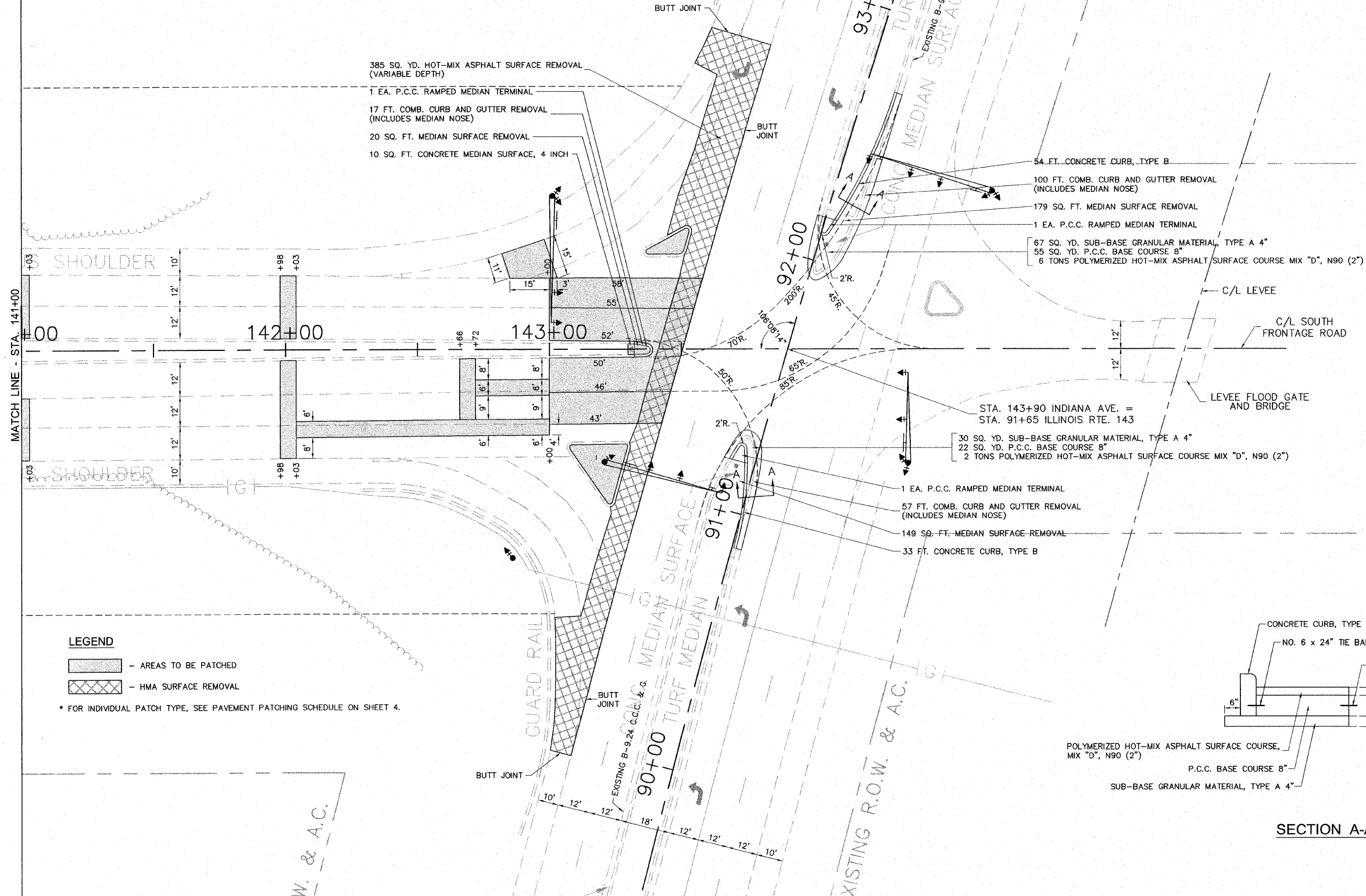
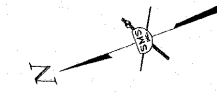
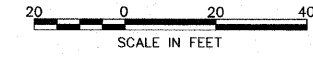

- 385 SQ. YD. HOT-MIX ASPHALT SURFACE REMOVAL (VARIABLE DEPTH)
- 1 EA. P.C.C. RAMPED MEDIAN TERMINAL
- 17 FT. COMB. CURB AND GUTTER REMOVAL (INCLUDES MEDIAN NOSE)
- 20 SQ. FT. MEDIAN SURFACE REMOVAL
- 10 SQ. FT. CONCRETE MEDIAN SURFACE, 4 INCH

- 54 FT. CONCRETE CURB, TYPE B
- 100 FT. COMB. CURB AND GUTTER REMOVAL (INCLUDES MEDIAN NOSE)
- 179 SQ. FT. MEDIAN SURFACE REMOVAL
- 1 EA. P.C.C. RAMPED MEDIAN TERMINAL
- 67 SQ. YD. SUB-BASE GRANULAR MATERIAL, TYPE A 4"
- 55 SQ. YD. P.C.C. BASE COURSE 8"
- 6 TONS POLYMERIZED HOT-MIX ASPHALT SURFACE COURSE MIX "D", N90 (2")

- STA. 143+90 INDIANA AVE. = STA. 91+65 ILLINOIS RTE. 143
- 30 SQ. YD. SUB-BASE GRANULAR MATERIAL, TYPE A 4"
- 22 SQ. YD. P.C.C. BASE COURSE 8"
- 2 TONS POLYMERIZED HOT-MIX ASPHALT SURFACE COURSE MIX "D", N90 (2")

- 1 EA. P.C.C. RAMPED MEDIAN TERMINAL
- 57 FT. COMB. CURB AND GUTTER REMOVAL (INCLUDES MEDIAN NOSE)
- 149 SQ. FT. MEDIAN SURFACE REMOVAL
- 33 FT. CONCRETE CURB, TYPE B

LEGEND

- [Hatched pattern] - AREAS TO BE PATCHED
- [Cross-hatched pattern] - HMA SURFACE REMOVAL
- * FOR INDIVIDUAL PATCH TYPE, SEE PAVEMENT PATCHING SCHEDULE ON SHEET 4.

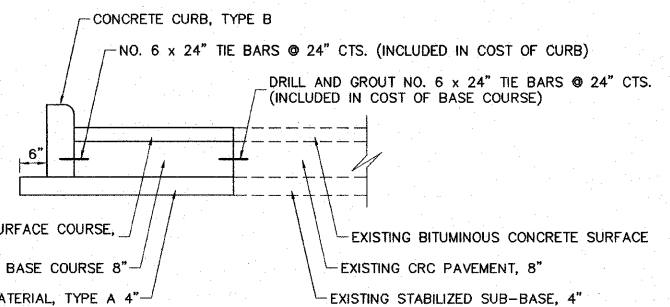

SECTION A-A

REVISIONS

SMS ENGINEERS
 Sheppard, Morgan & Schwaab, Inc.
 CONSULTING ENGINEERS AND LAND SURVEYORS
 215 Market Street, P.O. Box E, Alton, IL 62002 618/462-9755 E-mail: ms@smsengr.com
 10 Central Industrial Drive, Granite City, IL 62040 618/877-5700 E-mail: ms@smsengr.com
 DESIGN FIRM # 184-000992

CITY OF ALTON, ILLINOIS
 SECTION 06 - 00208 - 02 - RP
 CPL. CHRIS BELCHIK MEMORIAL EXPRESSWAY
 DETAILED PLANS

DWG. NO.	PH III PATCHING 141-BERM.DWG
REF. BK.	INDIANA AVE.
JOB NO.	406365.1
DSN. BY:	DEC
DWN. BY:	CAD
CHK. BY:	DEC
DATE:	OCTOBER, 2006
SCALE:	1" = 20'
SHEET	24 OF 61

S:\Land Projects\Alton Indiana Ph III 406365.dwg (P) III Patching 141-Berm.dwg 2/19/2007 12:35:16 PM jman.120