

ROUTE NO.	SECTION	COUNTY	TOTAL SHEETS	SHEET NO.
FAU-8086	06-00208-02-BR	MADISON	61	37
FED. ROAD DIST. NO.		PROJECT		

- ELECTRICAL KEYED NOTES:
- 1 UNIT DUCT, 2#4 XLP, 1#4G. XLP, 1" C. IN TRENCH.
 - 2 UNIT DUCT, 2#6 XLP, 1#8G. XLP, 1" C. IN TRENCH.
 - 3 NOT USED.
 - 4 EXISTING CONDUIT EMBEDDED IN STRUCTURE, 2" C.
 - 5 2#4 XLP, 1#4G. XLP, EXISTING CONDUIT

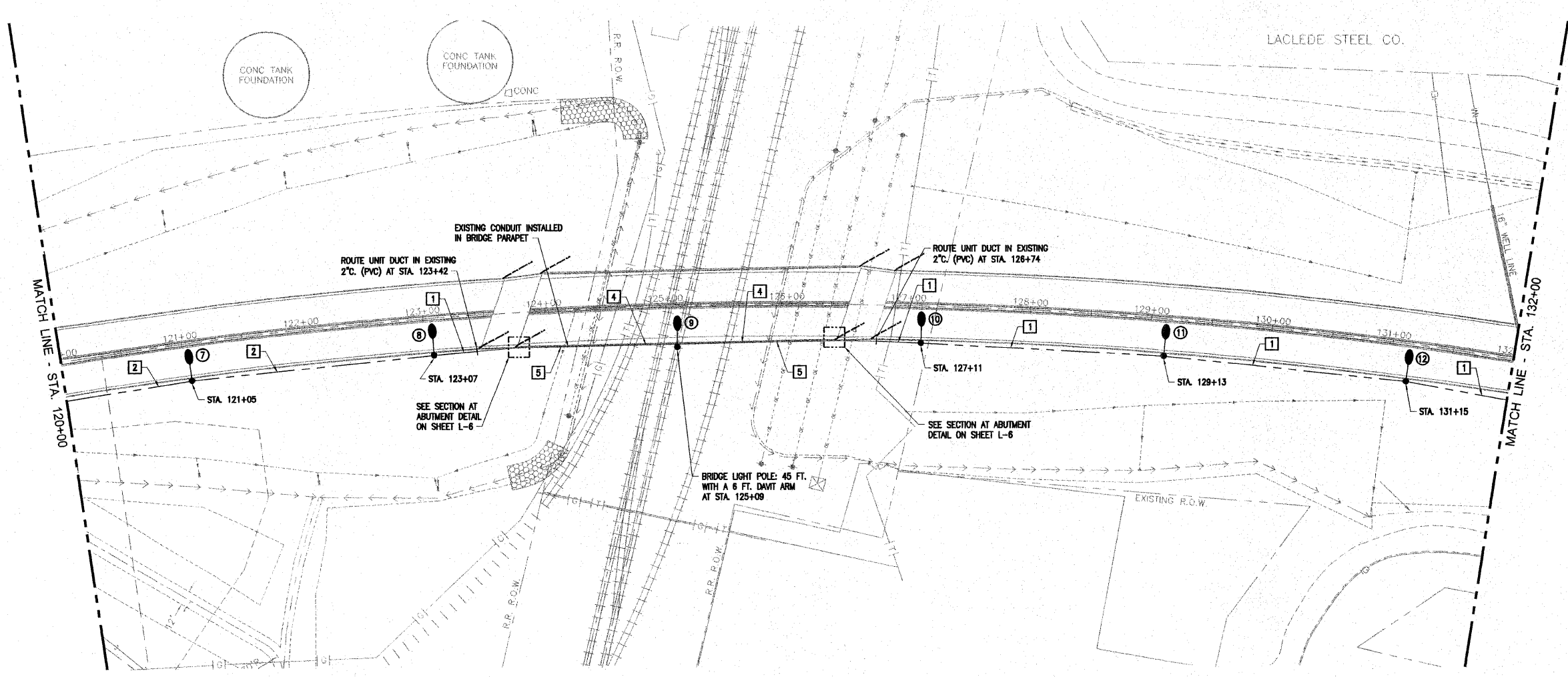

LIGHTING PLAN

50 0 50 100
HORIZONTAL SCALE IN FEET (1:50)

N

THE LOCATION, SIZE AND TYPE OF MATERIAL OF EXISTING UNDERGROUND UTILITIES INDICATED ON THE PLANS IS NOT REPRESENTED AS BEING ACCURATE, SUFFICIENT OR COMPLETE. IT SHALL BE THE CONTRACTOR'S RESPONSIBILITY TO DETERMINE THE ACTUAL LOCATION OF ALL SUCH FACILITIES, INCLUDING THE SERVICE CONNECTIONS TO UNDERGROUND UTILITIES. PRIOR TO CONSTRUCTION THE CONTRACTOR SHALL NOTIFY THE UTILITY COMPANIES OF HIS OPERATIONAL PLANS AND SHALL OBTAIN FROM THE RESPECTIVE UTILITY COMPANIES DETAILED INFORMATION AND ASSISTANCE RELATIVE TO THE LOCATION OF THEIR FACILITIES AND THE WORKING SCHEDULE OF THE COMPANIES FOR REMOVAL OR ADJUSTMENT WHERE REQUIRED. IN THE EVENT AN UNEXPECTED UTILITY INTERFERENCE IS ENCOUNTERED DURING CONSTRUCTION, THE CONTRACTOR SHALL IMMEDIATELY NOTIFY THE UTILITY COMPANY OF JURISDICTION. THE ENGINEER SHALL ALSO BE IMMEDIATELY NOTIFIED. ANY SUCH MANS AND SERVICES SHALL BE RESTORED TO SERVICE AT ONCE AND PAID FOR BY THE CONTRACTOR AT NO ADDITIONAL COST TO THE CONTRACT.

LIGHTING FIXTURE SCHEDULE						
FIXT. TYPE	DESCRIPTION	MANUFACTURER & CAT. NO.	LAMPS/WATTS	VOLTS	MOUNTING	REMARKS
F1	POLE MOUNTED HPS COBRA HEAD ROADWAY LUMINAIRE, HEAVY GAUGE EXTRUDED ALUMINUM HOUSING, FULLY GASKETED FOR WEATHER AND BUG TIGHTNESS, BAKED ON GRAY POLYESTER POWDER COAT FINISH, ANODIZED ALUMINUM TYPE III CUTOFF OPTICS, TEMPERED GLASS PRISMATIC REFRACTOR, HORIZONTALLY MOUNTED MEDIUM BASE PORCELAIN SOCKET, HPF CWA TYPE BALLAST	GE-MSCL-40-S-3-P-1-F-MC3-X OR APPROVED EQUAL	1-400W HPS ANSI CODE NO. S81 465 TOTAL INPUT WATTS	480	MOUNTED ON TOP OF A 50'-0" POLE WITH A 6'-0" DAVIT ARM	SUPPLY A 100 MPH RATED POLE AT 200% OF THE RATED EPA OF THE FIXTURE AND MAST ARM PROVIDED. SPECIFIED FIXTURE EPA RATING EQUALS 1.1 SQ FT EACH

INDIANA AVENUE EXTENSION
CITY OF ALTON, IL
ROADWAY LIGHTING
PLAN

LAYOUT DRAWN REVIEWED	FJT ANC FJT	 Copyright Hanson Professional Services Inc. 2005 Hanson Professional Services Inc. 1525 South Sixth Street Springfield, Illinois 62703-2886 ILLINOIS LICENSED PROFESSIONAL SERVICES CORPORATION #184-001084	JOB NO. 95510081
L-2			DATE 08-16-06

S:\Land Projects\Alton Indiana Ph III 406365.1\dwg\hanson\EC102.dwg, 10/11/2006 8:52:44 AM, jman, 1:50

S:\LAND PROJECTS\ALTON INDIANA PH III 406365.1\DWG\HANSON\EC102.DWG