

STATE OF ILLINOIS  
DEPARTMENT OF TRANSPORTATION  
DIVISION OF HIGHWAYS

| ROUTE | SECTION        | COUNTY | TOTAL SHEETS | SHEET NO. |
|-------|----------------|--------|--------------|-----------|
| CH 30 | 03-00122-00-RS | MARION | 4            | 1         |

FAS 2826 CONTRACT #97303

INDEX OF SHEETS

|   |   |
|---|---|
| COVER SHEET   | 1 |
| SUMMARY OF QUANTITIES, GENERAL NOTES, AND UTILITIES | 2 |
| TYPICAL SECTION DETAILS                             | 3 |
| SCHEDULES   | 4 |

STANDARDS

- 000001-04 STANDARD SYMBOLS, ABBREVIATIONS AND PATTERNS
- 442201-02 CLASS C AND D PATCHES
- 701201-02 LANE CLOSURE, 2L, 2W, DAY ONLY, FOR SPEEDS > 45 MPH
- 701301-02 LANE CLOSURE, 2L, 2W, SHORT TIME OPERATIONS
- 701306-01 LANE CLOSURE, 2L, 2W, SLOW MOVING OPERATIONS-DAY ONLY FOR SPEEDS > 45 MPH
- 701311-02 LANE CLOSURE, 2L, 2W, SLOW MOVING OPERATIONS-DAY ONLY
- 701501-03 URBAN LANE CLOSURE, 2L, 2W, UNDIVIDED
- 702001-06 TRAFFIC CONTROL DEVICES
- 780001-01 TYPICAL PAVEMENT MARKINGS

**PROPOSED LOCAL AGENCY  
FEDERAL-AID SECONDARY PROJECT**

TRUCK ACCESS ROUTE PROGRAM / STR PROGRAM

**ROUTE** FAS 2826, CH 30  
**SECTION** 03-00122-00-RS  
**PROJECT** RS 2826(104)  
**MARION COUNTY**  
C-98-328-07

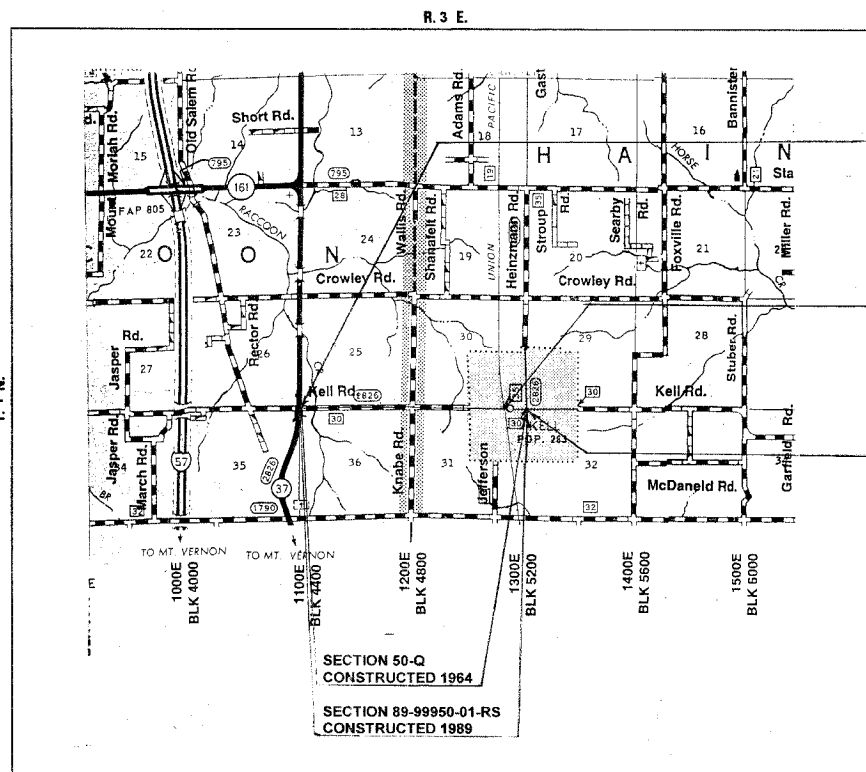
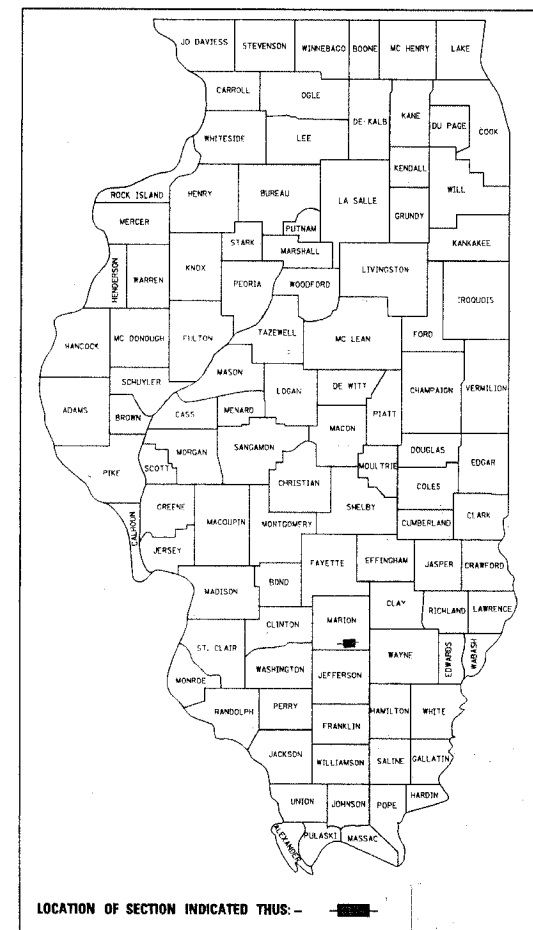

BEGIN SEC. 03-00122-00-RS  
STA 10+22

OMMISSION  
STA. 108+21.01 TO STA. 108+44.25

END SEC. 03-00122-00-RS  
STA 118+40

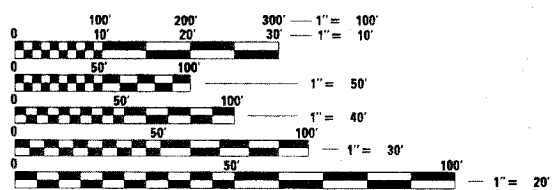

FULL SIZE PLANS HAVE BEEN PREPARED USING STANDARD ENGINEERING SCALES. REDUCED SIZED PLANS WILL NOT CONFORM TO STANDARD SCALES. IN MAKING MEASUREMENTS ON REDUCED PLANS, THE ABOVE SCALES MAY BE USED.

J.U.L.I.E.  
JOINT UTILITY LOCATION INFORMATION FOR EXCAVATION  
1-800-892-0123

2007 ADT = 950

GROSS LENGTH 10,818 FT., 2.049 MILES  
NET LENGTH 10,794.76 FT., 2.044 MILES

THESE PLANS WERE PREPARED BY ME OR A FULL-TIME MEMBER OF MY STAFF UNDER MY PERSONAL SUPERVISION.

*James E. Quinn*  
COUNTY ENGINEER, MARION COUNTY  
ILLINOIS LICENSED PROFESSIONAL ENGINEER  
NO. 062-31357  
LICENSE EXPIRES 11.30.07

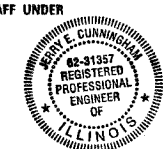

STATE OF ILLINOIS  
DEPARTMENT OF TRANSPORTATION  
DIVISION OF HIGHWAYS

APPROVED *20 March*, 2007  
*James E. Quinn*  
MARION COUNTY, COUNTY ENGINEER

PASSED *March 22*, 2007  
*Janice Oberknecht*  
DISTRICT EIGHT ENGINEER OF LOCAL ROADS & STREETS

RELEASED FOR BID  
BASED ON LIMITED REVIEW *March 22*, 2007  
*Mary C. Lemie*  
DEPUTY DIRECTOR OF HIGHWAYS, REGION FIVE ENGINEER

SUMMARY OF QUANTITIES

| CODE NO.        | PAY ITEM                                     | UNIT     | QUANTITY |
|-----------------|--|----------|----------|
| 40600100        | BITUMINOUS MATERIALS (PRIME COAT)            | GALLON   | 2918     |
| 40600300        | AGGREGATE (PRIME COAT)                       | TON      | 58       |
| 40600635        | LEVEL BINDER (MACHINE METHOD), N70           | TON      | 2025     |
| 40600982        | HOT-MIX ASPHALT SURFACE REMOVAL-BUTT JOINT   | SQ YD    | 122      |
| 40600990        | TEMPORARY RAMP                               | SQ YD    | 41       |
| 40603320        | HOT-MIX ASPHALT SURFACE COARSE, MIX "C", N90 | TON      | 2455     |
| 44201737        | CLASS D PATCHES, TYPE I, 8 INCH              | SQ YD    | 11       |
| 44201741        | CLASS D PATCHES, TYPE II, 8 INCH             | SQ YD    | 39       |
| 44201745        | CLASS D PATCHES, TYPE III, 8 INCH            | SQ YD    | 67       |
| 44201747        | CLASS D PATCHES, TYPE IV, 8 INCH             | SQ YD    | 160      |
| 48101200        | AGGREGATE SHOULDERS, TYPE B                  | TON      | 635      |
| 60255500        | MANHOLES TO BE ADJUSTED                      | EACH     | 11       |
| 67100100        | MOBILIZATION                                 | LUMP SUM | 1        |
| 70100450        | TRAFFIC CONTROL & PROTECTION                 | LUMP SUM | 1        |
|                 | STANDARD 701201                              |          |          |
| 70100460        | TRAFFIC CONTROL & PROTECTION                 | LUMP SUM | 1        |
|                 | STANDARD 701306                              |          |          |
| 70102620        | TRAFFIC CONTROL & PROTECTION                 | LUMP SUM | 1        |
|                 | STANDARD 701501                              |          |          |
| 70300100        | SHORT-TERM PAVEMENT MARKING                  | FOOT     | 3246     |
| 70301000        | WORK ZONE PAVEMENT MARKING REMOVAL           | SQ FT    | 358      |
| 78001100        | PAINT PAVEMENT MARKING-LETTERS AND SYMBOLS   | SQ FT    | 122      |
| 78001110        | PAINT PAVEMENT MARKING-LINE 4"               | FOOT     | 24719    |
| 78001150        | PAINT PAVEMENT MARKING-LINE 12"              | FOOT     | 114      |
| 78001180        | PAINT PAVEMENT MARKING-LINE 24"              | FOOT     | 66       |
| Z0048665        | RAILROAD PROTECTIVE LIABILITY INSURANCE      | LUMP SUM | 1        |
| Z0055300        | RUMBLE STRIP                                 | EACH     | 3        |
| XX006922        | RUMBLE STRIP REMOVAL                         | EACH     | 3        |
| SPECIALTY ITEMS |  |          |          |

GENERAL NOTES

THIS SECTION SHALL BE CONSTRUCTED IN ACCORDANCE WITH THE PLANS, THE "STANDARD SPECIFICATIONS FOR ROAD AND BRIDGE CONSTRUCTION", ADOPTED JANUARY 1, 2007, THE "SUPPLEMENTAL SPECIFICATIONS AND RECURRING SPECIAL PROVISIONS", AND THE SPECIAL PROVISIONS INCLUDED IN THE PROPOSAL.

THE PROPOSED PROJECT ON F.A.S. 2832, COUNTY HIGHWAY 30, BEGINS AT THE EAST EDGE OF PAVEMENT OF ILLINOIS ROUTE 37 AT STATION 10+22 AND EXTENDS IN AN EASTERLY DIRECTION FOR A DISTANCE OF 2.04 MILES TO A POINT JUST EAST OF HEINZMANN ROAD, COUNTY HIGHWAY 35, AT STATION 118+40.

THE WORK INCLUDED IN THIS PROJECT CONSISTS OF PAVEMENT PATCHING, 1 1/2" LEVEL BINDER (MACHINE METHOD), 1 1/2" HOT-MIX ASPHALT SURFACE COURSE, AGGREGATE SHOULDERS, AND ANY OTHER WORK NECESSARY TO COMPLETE THE PROJECT.

THE EXISTING GRADE, ALIGNMENT, DRAINAGE STRUCTURES, BASE AND SURFACE WERE CONSTRUCTED UNDER THE ILLINOIS DEPARTMENT OF TRANSPORTATION'S DESIGN REQUIREMENTS FOR LOCAL ROUTES AT THE TIME OF THEIR INITIAL CONSTRUCTION. THE ORIGINAL PLANS ARE AVAILABLE FOR INSPECTION AT THE MARION COUNTY HIGHWAY DEPARTMENT, 901 WEST ELM STREET, SALEM, ILLINOIS.

COMPUTATION OF BITUMINOUS QUANTITIES IS BASED UPON 112 POUNDS/SQUARE YARD/1" THICK.

COMPUTATION OF AGGREGATE SHOULDER, TYPE B, IS BASED UPON 2.05 TONS/CUBIC YARD.

THE FOLLOWING MIXTURE REQUIREMENTS ARE APPLICABLE FOR THIS PROJECT:

| MIXTURE USE                         | SURFACE        | LEVEL BINDER   |
|-------------------------------------|----------------|----------------|
| AC/PG                               | PG 64-22       | PG 64-22       |
| RAP % (MAX)                         | 10%            | 15%            |
| DESIGN AIR Voids                    | 4.0% @ Ndes=60 | 4.0% @ Ndes=70 |
| MIX COMPOSITION (GRADATION MIXTURE) |                |                |
| FRICITION AGG                       | MIX "C"        | MIX "C"        |

UTILITIES

Members:  
 AMTC1A SBC  
 CVS10A CHARTER COMMUNICATIONS  
 DWSC0A DIX-KELL WATER SEWER  
 IPC0A AMEREN IP  
 RACCOA RACCOON WATER CO  
 RCTV0A BECKS/RILEY CATV

JOAN GRAY  
 EDDIE PRIOR  
 RHODA J. WATTS  
 STEVE RALSTON  
 JIM GREEN  
 LARRY K. BECK

847-898-4702  
 618-242-9512x215  
 618-266-7701  
 618-236-6207  
 618-532-8569  
 618-423-2844

| ROUTE | SECTION        | COUNTY | TOTAL SHEETS | SHEET NO. |
|-------|----------------|--------|--------------|-----------|
| CH 30 | 03-00122-00-RS | MARION | 4            | 3         |

CONTRACT #97303

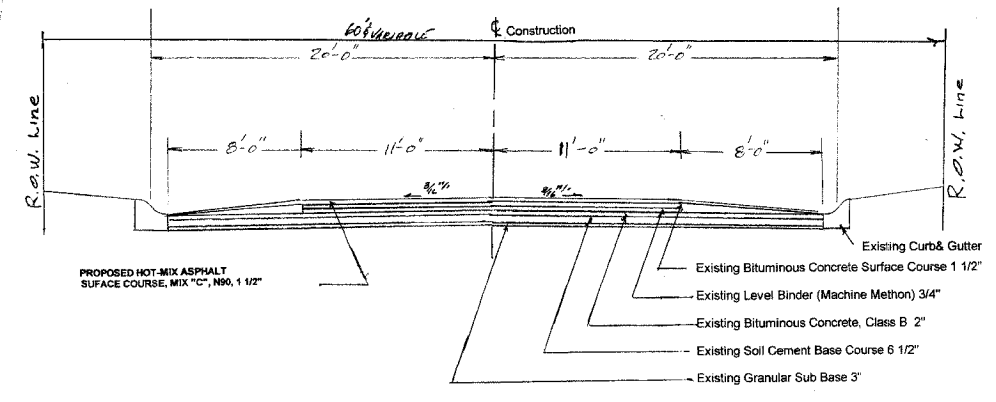

TYPICAL SECTION  
STATION 103+00 TO STATION 118+40

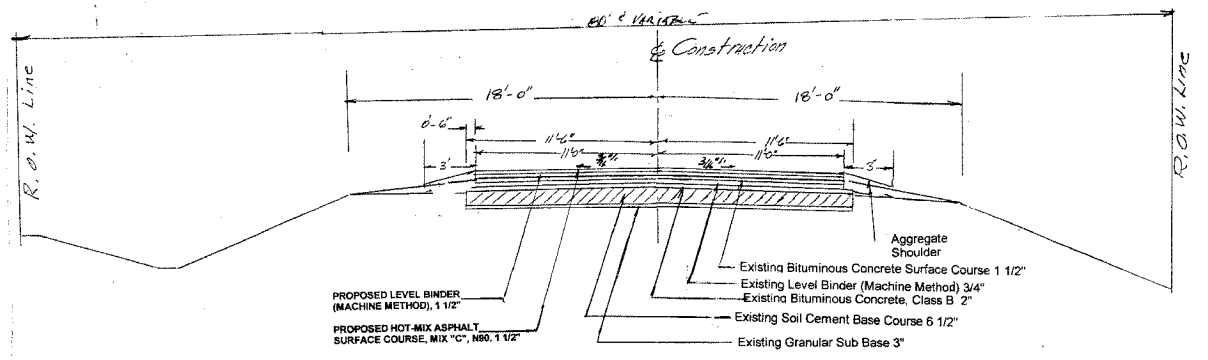

TYPICAL SECTION  
STATION 10+22 TO STATION 103+00

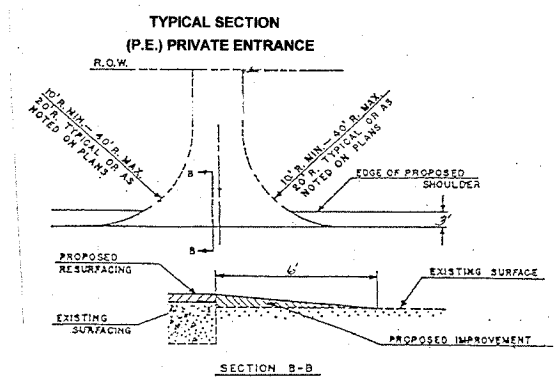
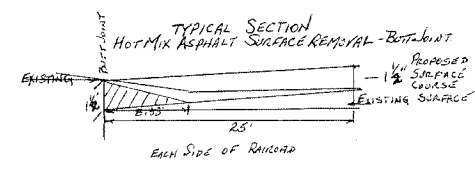

SECTION B-B

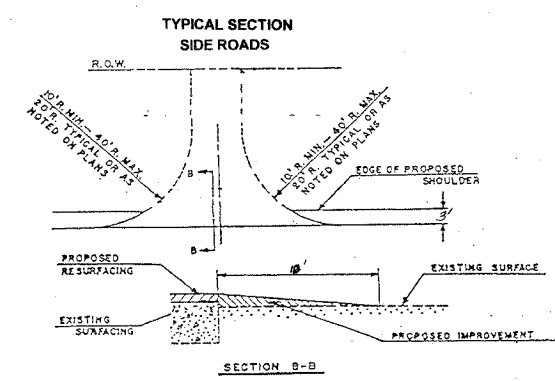

SECTION B-B

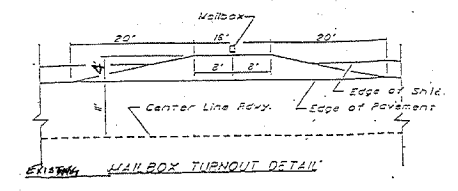

TYPICAL RUMBLE STRIP APPLICATION IN ADVANCE OF AN INTERSECTION

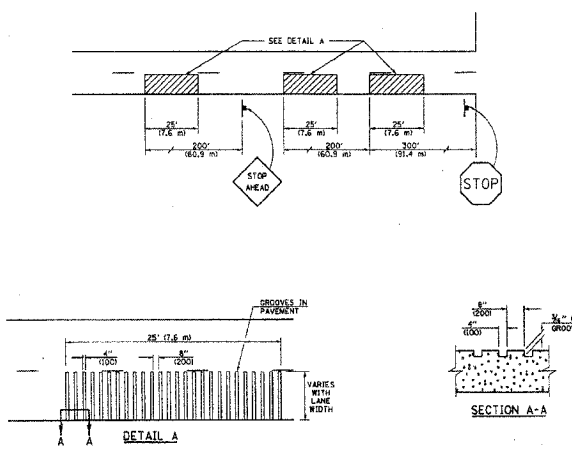

TYPICAL SECTION  
OF  
RUMBLE STRIP REMOVAL

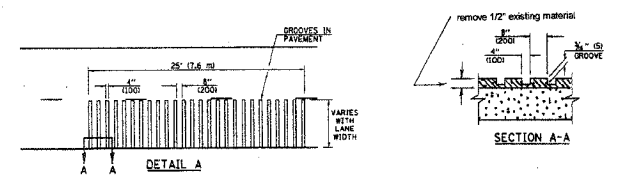

GENERAL NOTES

1. This work shall consist of the removal of the existing rumble strip by grinding or milling to the depth specified or any variable depth and replacing the ground or milled material with Hotmix Asphalt Surface Course.
2. This work will be measured for payment per each 25' (7.6 m) individual rumble strip removed and paid for at the Contract Unit Price for EACH RUMBLE STRIP REMOVAL, which price shall include all equipment, material labor and other items required to remove each individual rumble strip.

- GENERAL NOTES
1. ALL GROOVES SHALL BE CONSTRUCTED USING A 4" (100 mm) MILLING HEAD OR SERIES OF 4" (100 mm) MILLING HEADS CAPABLE OF CUTTING TO THE SPECIFIED DEPTH OR ANY VARIABLE DEPTH.
  2. THIS WORK WILL BE MEASURED FOR PAYMENT PER EACH 25' (7.6 m) INDIVIDUAL RUMBLE STRIP APPLIED AND PAID FOR AT THE CONTRACT UNIT PRICE EACH FOR RUMBLE STRIP, WHICH PRICE SHALL INCLUDE ALL EQUIPMENT, MATERIAL LABOR AND OTHER ITEMS REQUIRED TO INSTALL EACH INDIVIDUAL RUMBLE STRIP.

ENTRANCE SCHEDULE

| SIDE      | STATION | TYPE | HOTMIX ASPHALT<br>SURFACE COARSE,<br>MIX "C", N90<br>TON |
|-----------|---------|------|--|
| LT        | 10+69   | CE   | 3.5  |
| RT        | 10+69   | CE   | 3.5  |
| RT        | 11+30   | PE   | 1.4  |
| LT        | 11+39   | PE   | 1.5  |
| RT        | 12+56   | PE   | 1.1  |
| RT        | 14+11   | PE   | 1.0  |
| RT        | 15+20   | PE   | 1.0  |
| LT        | 15+50   | PE   | 1.0  |
| RT        | 16+24   | PE   | 1.0  |
| RT        | 16+04   | PE   | 1.0  |
| LT        | 16+30   | PE   | 1.0  |
| RT        | 18+50   | PE   | 1.0  |
| LT        | 21+40   | PE   | 1.0  |
| RT        | 23+53   | PE   | 1.0  |
| LT        | 25+95   | PE   | 1.0  |
| LT        | 26+50   | PE   | 1.0  |
| LT        | 26+89   | PE   | 1.0  |
| LT        | 28+16   | PE   | 1.0  |
| RT        | 35+05   | PE   | 1.0  |
| RT        | 36+75   | PE   | 1.0  |
| RT        | 44+30   | PE   | 1.1  |
| LT        | 55+15   | PE   | 1.2  |
| LT        | 57+43   | PE   | 1.1  |
| LT        | 76+30   | PE   | 1.2  |
| RT        | 76+30   | PE   | 1.1  |
| RT        | 83+21   | PE   | 1.5  |
| RT        | 84+92   | PE   | 1.7  |
| LT        | 85+90   | PE   | 1.0  |
| LT        | 87+06   | PE   | 1.3  |
| RT        | 91+29   | PE   | 1.5  |
| RT        | 97+82   | PE   | 1.0  |
| LT        | 98+25   | PE   | 1.2  |
| RT        | 98+90   | PE   | 1.2  |
| RT        | 100+25  | PE   | 1.2  |
| RT        | 100+67  | PE   | 1.2  |
| RT        | 101+71  | PE   | 1.3  |
| LT        | 102+05  | PE   | 1.2  |
| RT        | 102+60  | PE   | 1.2  |
| TOTAL TON |         |      | 48.2   |

SCHEDULE OF SIDE ROADS

| NAME       | SIDE | STATION | HOTMIX ASPHALT<br>SURFACE COARSE,<br>MIX "C", N90<br>TON |
|------------|------|---------|--|
| KNOBE ROAD | LT   | 64+58   | 3.5  |
| KNOBE ROAD | RT   | 64+58   | 3.4  |
| TOTAL TON  |      |         | 6.9  |

| SCHEDULE OF CLASS D PATCH, 6 INCH |                       |                       |                       |
|-----------------------------------|-----------------------|-----------------------|-----------------------|
| TYPE I                            | TYPE II               | TYPE III              | TYPE IV               |
| RT 52+85<br>5' X 8'               | RT 53+85<br>11' X 12' | LT 54+00<br>19' X 11' | LT 77+50<br>200' X 6' |
| RT 53+65<br>5' X 8'               | RT 54+00<br>20' X 5'  | LT 57+45<br>40' X 5'  | LT 77+50<br>40' X 6'  |
| LT 53+95<br>4' X 5'               | LT 54+05<br>11' X 11' | RT 57+45<br>40' X 5'  |                       |

| SCHEDULE OF MANHOLES TO BE ADJUSTED |          |        |
|-------------------------------------|----------|--------|
| STATION                             | LOCATION | NUMBER |
| 103+00                              | C        | 1      |
| 105+10                              | 12'LT    | 1      |
| 107+63                              | C        | 1      |
| 109+12                              | 2'RT     | 1      |
| 105+40                              | C        | 1      |
| 110+91                              | C        | 1      |
| 112+20                              | C        | 2      |
| 112+80                              | C        | 1      |
| 114+52                              | C        | 1      |
| 118+07                              | C        | 1      |
| TOTAL                               |          | 11     |

SCHEDULE OF PAINT PAVEMENT MARKING LINE-4"

| TYPE OF LINE           | LENGTH YELLOW (FT) | LENGTH WHITE (FT) |
|------------------------|--------------------|-------------------|
| Centerline Stripe      | 2,691              |                   |
| No Passing Zone Stripe | 500                |                   |
| EdgeLine               |                    | 21,528            |
| Totals                 |                    | 3,191             |
|                        |                    | 21,528            |

THE RESIDENT ENGINEER SHALL MATCH EXISTING PAVEMENT MARKING LAYOUT.