

F.A.U. RTE.	SECTION	COUNTY	TOTAL SHEETS	SHEET NO.
9306	04-00042-00-PV	MONROE	22	8
STA.		TO STA.		
TRAFFIC CONTROL PLAN				
CONTRACT NO. 97304				
FEDERAL AID PROJECT				

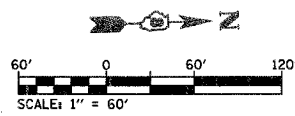

LEGEND

- 1 ROAD CLOSED AHEAD-W20-3(O)
- 2 ROAD CONSTRUCTION AHEAD-W20-1(O)
- 3 BARRICADE AHEAD
- 4 LEFT TURN LANE CLOSED AHEAD-W20-1103(O)
- 5 WORKERS-W21-1a(O)
- 6 TYPE III BARRICADES, R-11-4-6030 (ROAD CLOSED TO THRU TRAFFIC) SIGNS, AND TYPE A LOW INTENSITY FLASHING LIGHTS
- 7 24" x 24"
- 8 24" x 24"
- 9 24" x 12"
- 10 TYPE A LOW INTENSITY FLASHING LIGHT
- WORK ZONE (TYP)
- LANE CLOSURE (TYP)
- 48" x 48" FLUORESCENT ORANGE

NOTES

- TYPE III BARRICADES AND ROAD CLOSURE SIGNS SHALL BE POSITIONED AS SHOWN, IN ACCORDANCE WITH HIGHWAY STANDARD 702001 AND AS DIRECTED BY THE ENGINEER.
- TYPE A LOW INTENSITY FLASHING WARNING LIGHTS SHALL BE USED ON THE FIRST SIGN IN ADVANCE OF THE WORK SITE AND TYPE III BARRICADES DURING HOURS OF DARKNESS.
- ALL WARNING SIGNS SHALL BE A MINIMUM OF 48" x 48" AND HAVE A BLACK LEGEND AND BORDER ON A FLUORESCENT ORANGE REFLECTORIZED BACKGROUND.
- SPACE WARNING SIGNS APPROXIMATELY 200' APART (UNLESS OTHERWISE NOTED). EXACT LOCATION OF WARNING SIGNS AND BARRICADES SHALL BE STAKED IN THE FIELD FOR APPROVAL BY THE ENGINEER PRIOR TO INSTALLATION.
- THE CONTRACTOR SHALL MAINTAIN ACCESS TO ENTRANCES AT ALL TIMES.
- ALL TYPE III BARRICADES UTILIZED FOR ROAD CLOSURES SHALL HAVE A LOW INTENSITY FLASHING LIGHT MOUNTED ON TOP OF EACH BARRICADE.
- ALL RESIDENTS FRONTING THE PROJECT SHALL BE NOTIFIED AT LEAST 48 HOURS PRIOR TO ROAD CLOSURES AFFECTING THEIR ACCESS.
- SEE HIGHWAY STANDARD 701501 FOR DAYTIME SINGLE LANE CLOSURES.

REVISIONS	
NAME	DATE

CARL STREET
TRAFFIC CONTROL
PLAN

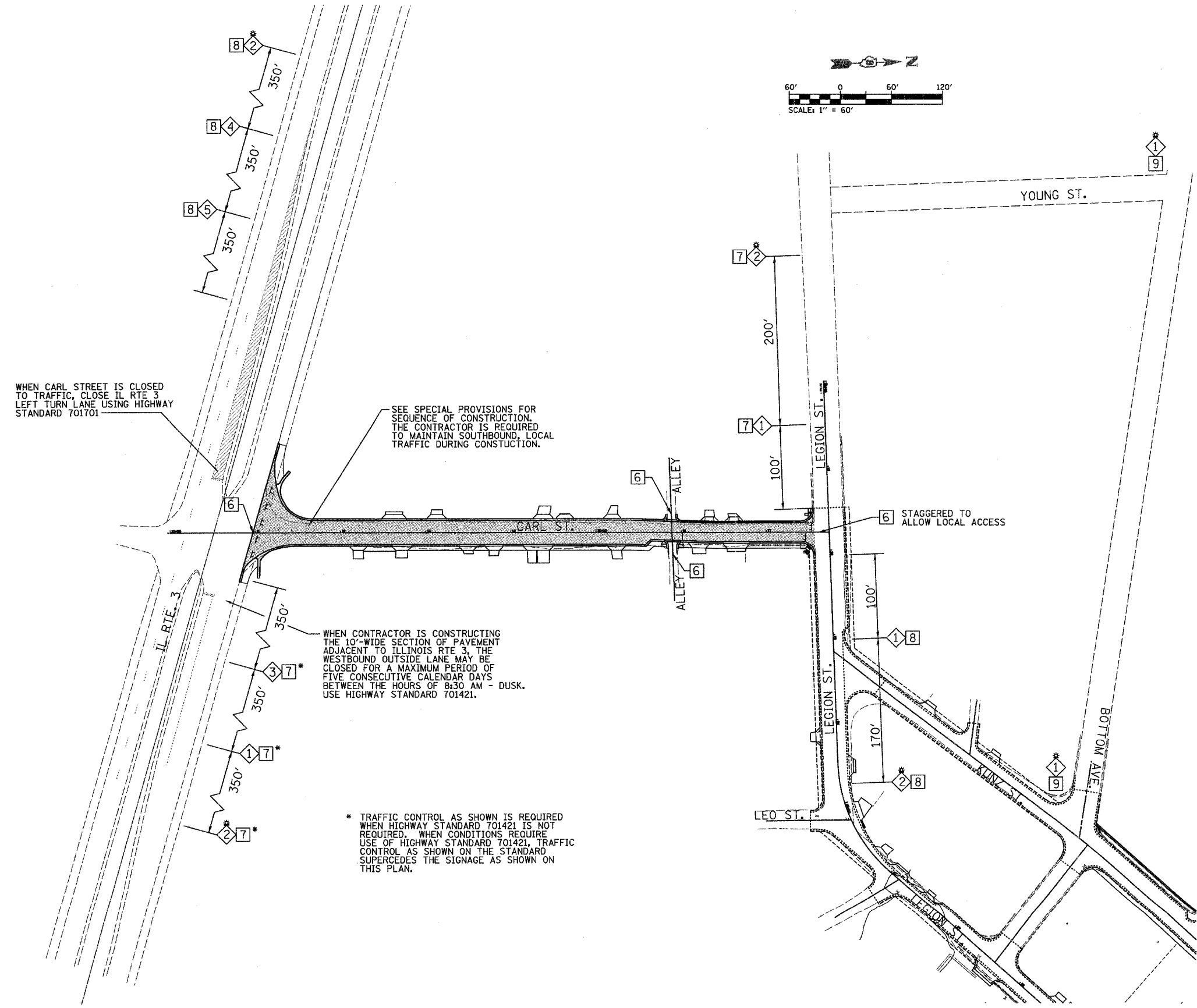

WHEN CARL STREET IS CLOSED TO TRAFFIC, CLOSE IL RTE 3 LEFT TURN LANE USING HIGHWAY STANDARD 701701

SEE SPECIAL PROVISIONS FOR SEQUENCE OF CONSTRUCTION. THE CONTRACTOR IS REQUIRED TO MAINTAIN SOUTHBOUND, LOCAL TRAFFIC DURING CONSTRUCTION.

WHEN CONTRACTOR IS CONSTRUCTING THE 10'-WIDE SECTION OF PAVEMENT ADJACENT TO ILLINOIS RTE 3, THE WESTBOUND OUTSIDE LANE MAY BE CLOSED FOR A MAXIMUM PERIOD OF FIVE CONSECUTIVE CALENDAR DAYS BETWEEN THE HOURS OF 8:30 AM - DUSK. USE HIGHWAY STANDARD 701421.

* TRAFFIC CONTROL AS SHOWN IS REQUIRED WHEN HIGHWAY STANDARD 701421 IS NOT REQUIRED. WHEN CONDITIONS REQUIRE USE OF HIGHWAY STANDARD 701421, TRAFFIC CONTROL AS SHOWN ON THE STANDARD SUPERCEDES THE SIGNAGE AS SHOWN ON THIS PLAN.

PLOT DATE = 04/24/2007
 FILE NAME = I:\V\26865\Microstation\TrafControl.dgn
 PLOT SCALE = 28.50000 / IN.
 USER NAME = MUSER