



CORPORATE OFFICE
4940 OLD COLLINGSVILLE RD.
SWANSEA, ILLINOIS 62226
TEL (618) 624-4488
FAX (618) 624-6688
corp@twm-inc.com

WATERLOO OFFICE
113 SOUTH MAIN STREET
WATERLOO, ILLINOIS 62298
TEL (618) 939-5060
FAX (618) 939-8988
waterloo@twm-inc.com

ST. LOUIS OFFICE
1001 CRAIG ROAD, SUITE 290
ST. LOUIS, MISSOURI 63146
TEL (314) 238-4062
FAX (314) 872-2194
stlouis@twm-inc.com

PROFESSIONAL REGISTRATIONS	LICENSE NO.
ILLINOIS PROFESSIONAL DESIGN FIRM	184-02220
PROFESSIONAL ENGINEERING CORP.	03-00070
PROFESSIONAL PHYSICIAN ENG. CORP.	01-00002
ILLINOIS FLOOD ELEVATION CORP.	046-00008
MISSOURI PROFESSIONAL ENGR. CORP.	110-00008
MISSOURI LAND SURVEYING CORP.	110-00044

SEAL

This Professional Seals certifies to the correct
Illinois Minimum Standards for a Boundary Survey

Signature: _____
Expiration Date: _____

STATEMENT OF RESPONSIBILITY
I hereby certify that the documents herein to be
authenticated by my seal is related to this sheet,
and I hereby disclaim any responsibility for all other
drawings, specifications, estimates, reports or other
documents or instruments related to or intended to
be utilized for any other part of the architectural,
engineering or survey project.

**TEMPORARY EROSION CONTROL
DETAILS**
STA 33 + 39.32 TO STA 38 + 00

PROJECT: SEIBERT ROAD
RECONSTRUCTION - PHASE IV
VILLAGE OF SHILOH
ST. CLAIR COUNTY, ILLINOIS

REV.	DATE	DESCRIPTION
△		
△		
△		

DRAWN BY: MJJ	SHEET
DESIGNED BY: MJJ	17
CHECKED BY: XXX	
APPROVED BY: XXX	
PROJECT NUMBER: D20010479	
OF 38 SHEETS	
<input type="checkbox"/> ISSUED FOR REVIEW	<input type="checkbox"/> ISSUED FOR BIDDING
<input type="checkbox"/> ISSUED FOR CONSTR.	<input type="checkbox"/> FIELD DRAWING

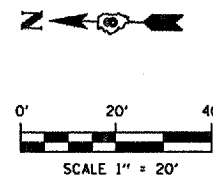
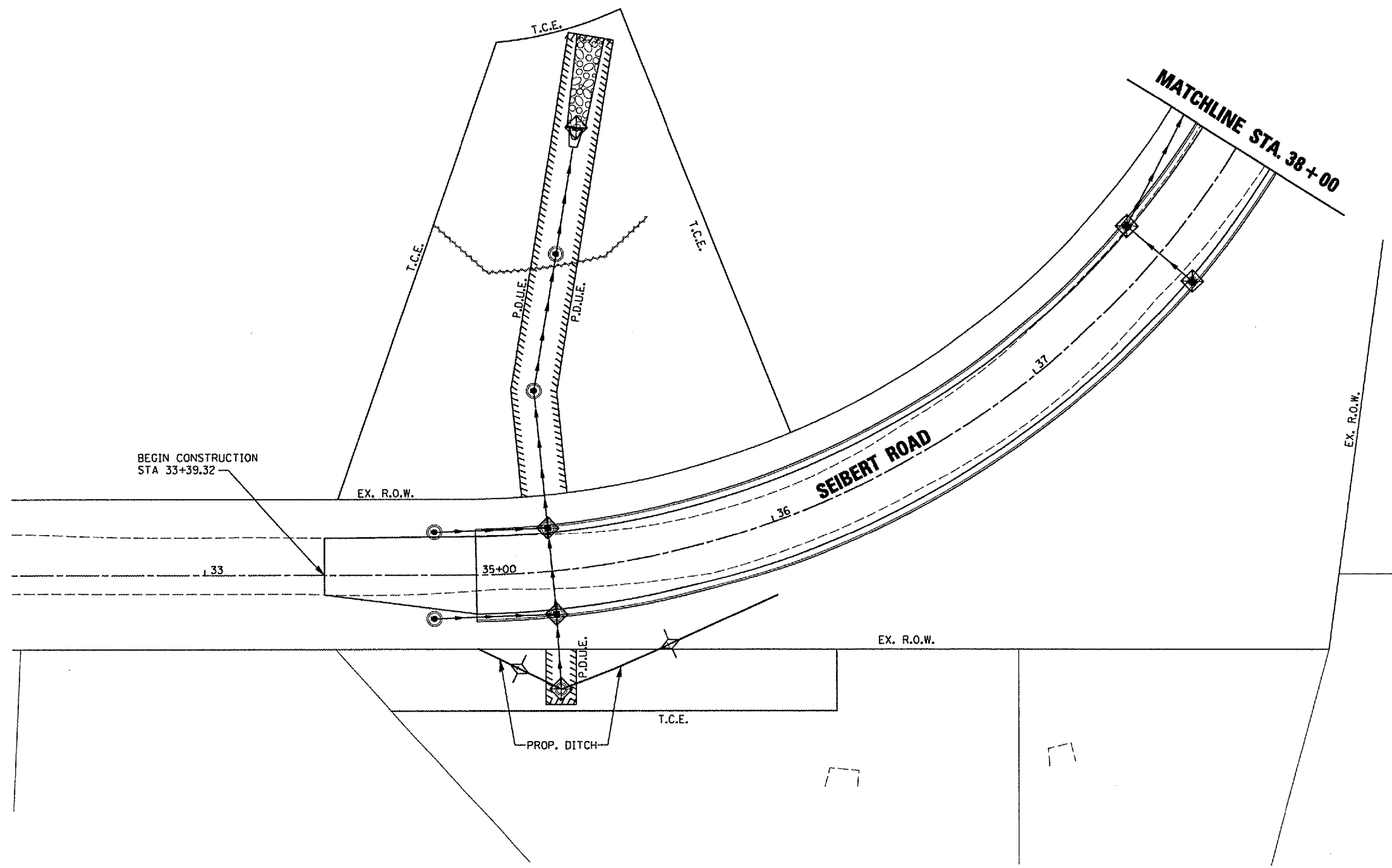

	PERIMETER EROSION BARRIER
	TEMPORARY DITCH CHECK
	INLET & PIPE PROTECTION

PLOT DATE = 3/21/2007
FILE NAME = F:\1010479\1010479.dgn
USER = abj955