



- CORPORATE OFFICE**  
4840 OLD COLLINSVILLE RD.  
SWANSEA, ILLINOIS 62226  
TEL (618) 624-4488  
FAX (618) 624-6888  
corp@twm-inc.com
- WATERLOO OFFICE**  
118 SOUTH MAIN STREET  
WATERLOO, ILLINOIS 62286  
TEL (618) 989-5060  
FAX (618) 989-9988  
waterloo@twm-inc.com
- ST. LOUIS OFFICE**  
1001 CRAIG ROAD, SUITE 280  
ST. LOUIS, MISSOURI 63146  
TEL (314) 294-6052  
FAX (314) 872-3184  
stlouis@twm-inc.com

PROFESSIONAL REGISTRATIONS	LICENSE NO.
ILLINOIS PROFESSIONAL DESIGN FIRM	18-0228
PROFESSIONAL ENGINEERING CORP.	08-00079
PROFESSIONAL STRUCTURAL ENGINEER CORP.	08-00024
ILLINOIS FIRM LAND SURVEYING CORP.	08-00028
MISSOURI PROFESSIONAL ENGINEER CORP.	NO 00028
MISSOURI LAND SURVEYING CORP.	NO 00044

Signature: \_\_\_\_\_  
Registration Date: \_\_\_\_\_  
**STATEMENT OF RESPONSIBILITY**  
I hereby certify that the documents herein to be authorized by my seal is restricted to this sheet, and I hereby disclaim any responsibility for all other drawings, specifications, estimates, reports or other documents or instruments relating to or intended to be utilized for any other part of the architectural, engineering or survey project.

**TITLE**  
STORM SEWER PLAN AND PROFILE  
RIGHT SIDE - STA. 35+00 TO 37+00

**PROJECT**  
SEIBERT ROAD  
RECONSTRUCTION - PHASE IV  
VILLAGE OF SHILOH  
ST. CLAIR COUNTY, ILLINOIS

REV.	DATE	DESCRIPTION
△		
△		
△		

DRAWN BY: MJJ	SHEET
DESIGNED BY: MJJ	
CHECKED BY: XXX	<b>20</b>
APPROVED BY: XXX	
PROJECT NUMBER: D20010479	OF 38 SHEETS
<input checked="" type="checkbox"/> ISSUED FOR REVIEW	<input type="checkbox"/> ISSUED FOR BIDDING
<input type="checkbox"/> ISSUED FOR CONSTR.	<input type="checkbox"/> RECORD DRAWING

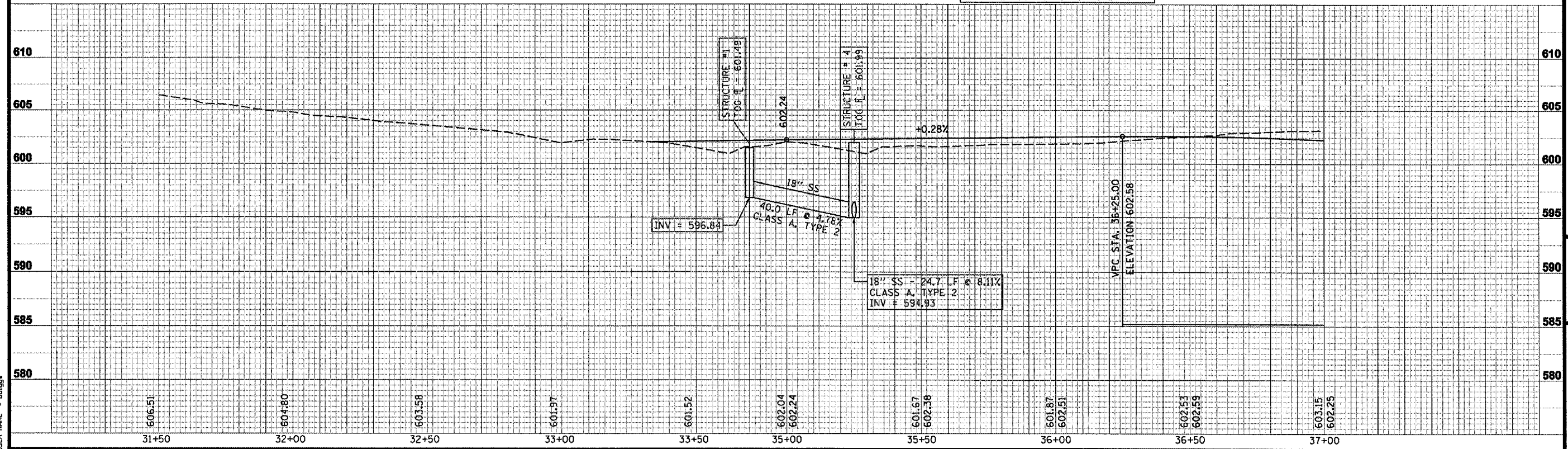
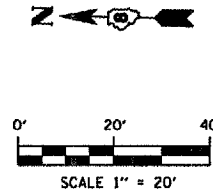
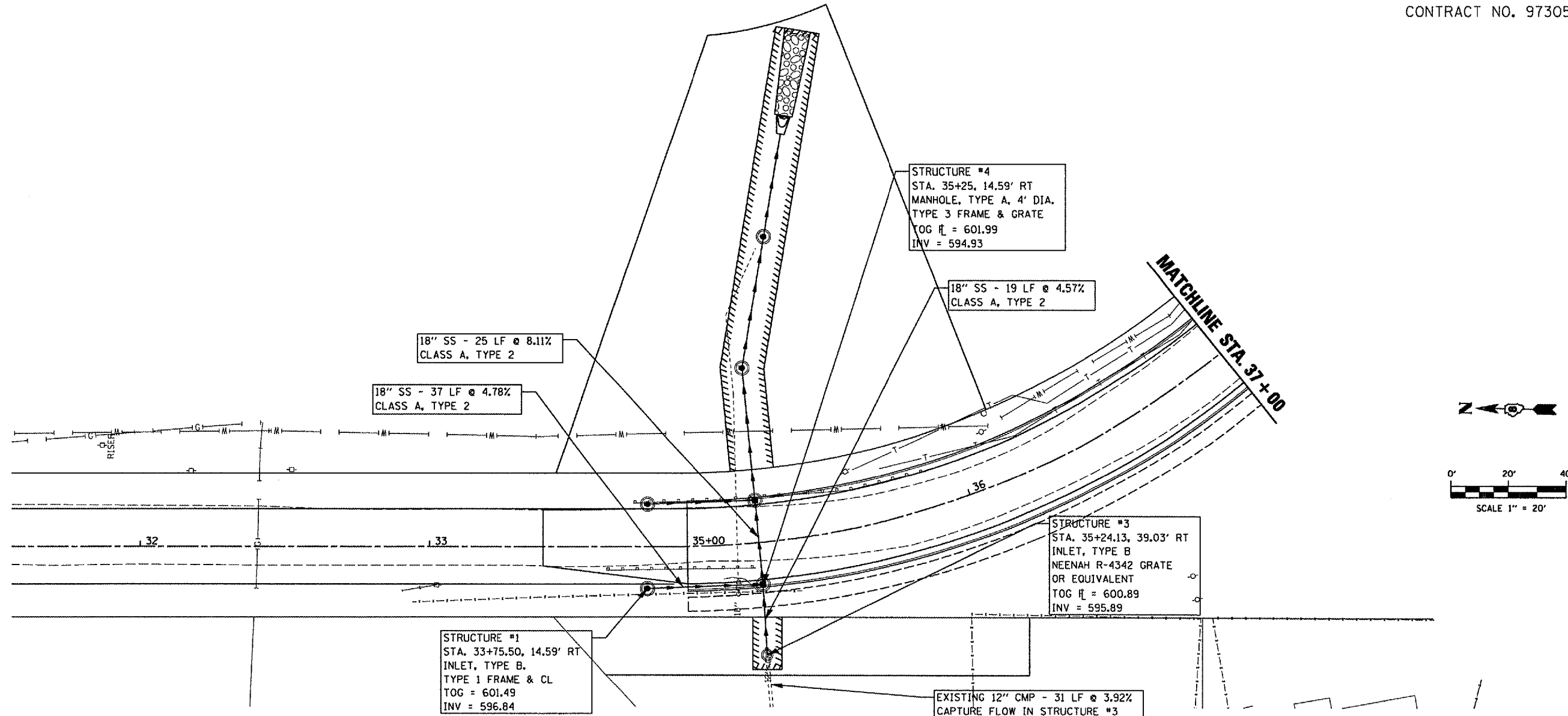

PLOT DATE = 3/21/2007  
FILE NAME = P:\010479\Storm\Phase IV Plans-REVISED 2-16-07\010479SPST-4.dgn  
PLOT SCALE = 48.0000 / IN.  
USER NAME = dbjg