



CORPORATE OFFICE
4940 OLD COLLINSVILLE RD.
SWANSEA, ILLINOIS 62226
TEL (618) 624-4488
FAX (618) 624-9688
corp@twm-inc.com

WATERLOO OFFICE
118 SOUTH MAIN STREET
WATERLOO, ILLINOIS 62296
TEL (618) 938-5050
FAX (618) 938-9888
waterloo@twm-inc.com

ST. LOUIS OFFICE
1001 CRAIG ROAD, SUITE 260
ST. LOUIS, MISSOURI 63146
TEL (314) 286-6052
FAX (314) 872-2194
stlouis@twm-inc.com

PROFESSIONAL REGISTRATIONS	LICENSE NO.
ILLINOIS PROFESSIONAL ENGINEER	184-02328
PROFESSIONAL ENGINEERING CORP.	03-00070
PROFESSIONAL STRUCTURAL ENGINEER CORP.	03-00022
ILLINOIS PROF. LAND SURVEYING CORP.	043-00028
MISSOURI PROFESSIONAL ENGINEER CORP.	NO 00028
MISSOURI LAND SURVEYING CORP.	NO 00064

SEAL

Signature: _____
Signature Date: _____
Expiration Date: _____

STATEMENT OF RESPONSIBILITY
I hereby confirm that the documents herein to be authorized by my seal is restricted to this plan, and I hereby declare my responsibility for all other drawings, specifications, estimates, reports or other documents or instruments relating to or intended to be utilized for any other part of the architectural, engineering or survey project.

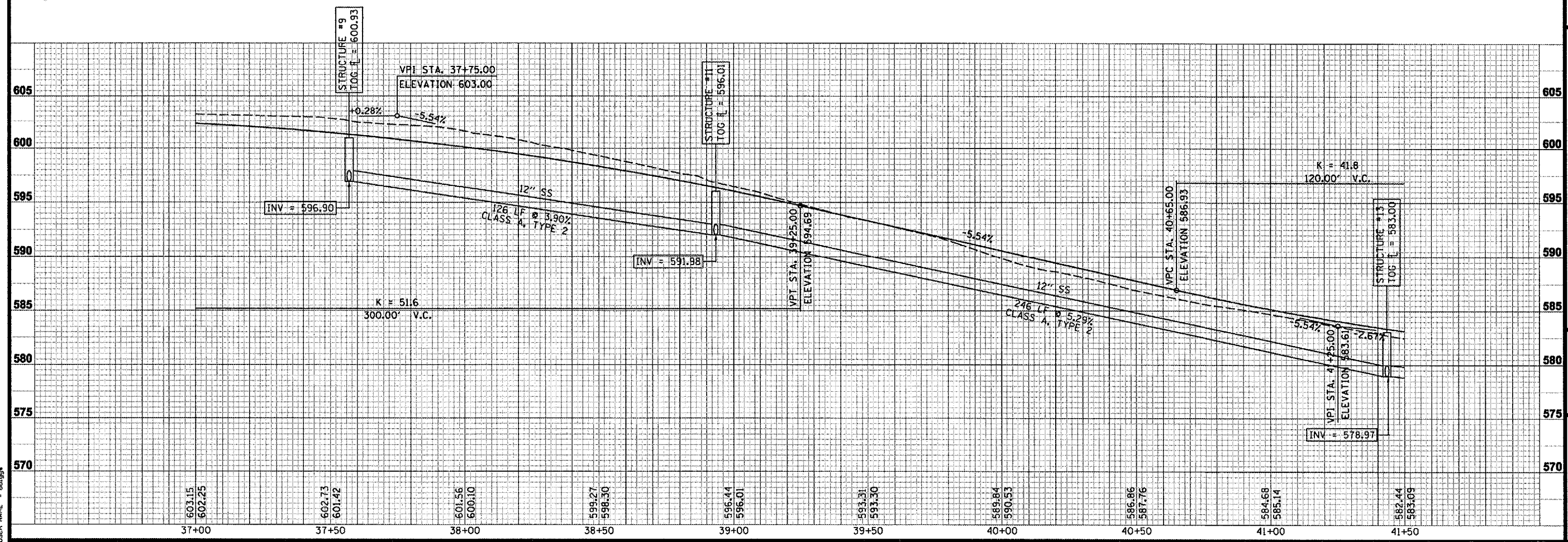
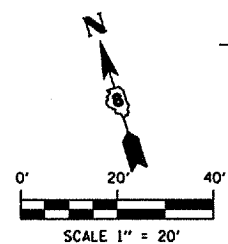
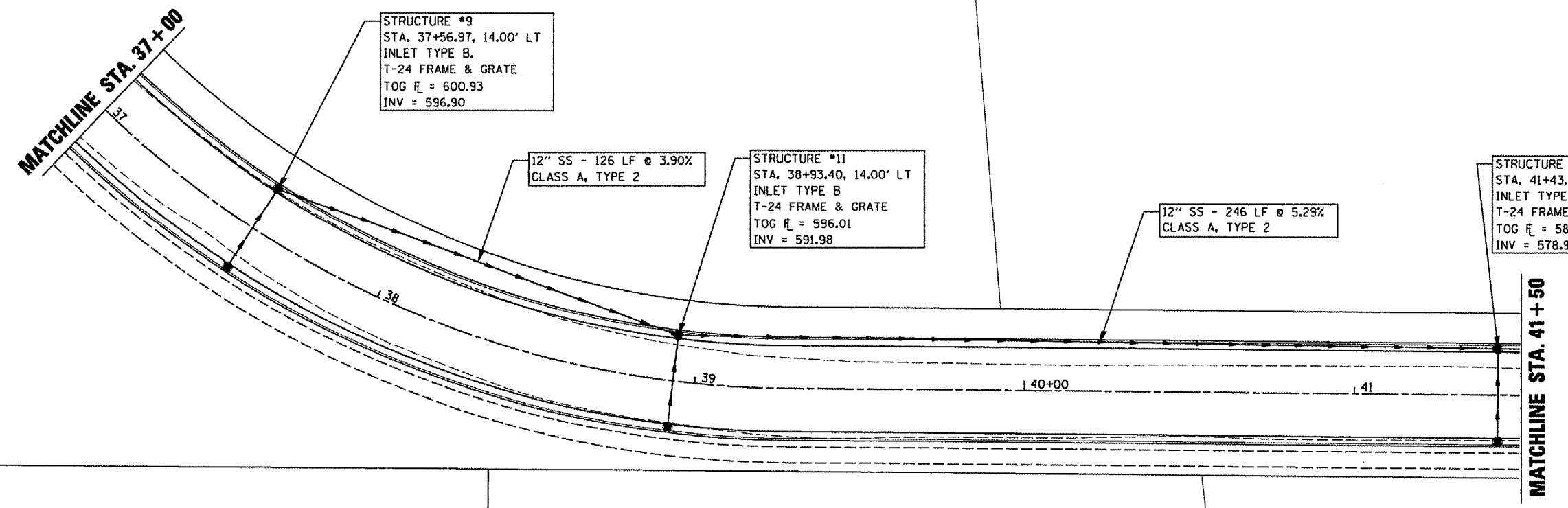

PLOT DATE = 3/21/2007
FILE NAME = P:\10470PPST\Phase IV Plans\REVISED 2-16-07\10470PPST_4.dgn
PLOT SCALE = 40.0000 / IN.
USER NAME = dbjgg

TITLE: **STORM SEWER PLAN AND PROFILE**
LEFT SIDE - STA. 37+00 TO 41+50

PROJECT: **SEIBERT ROAD
RECONSTRUCTION - PHASE IV
VILLAGE OF SHILOH
ST. CLAIR COUNTY, ILLINOIS**

REV.	DATE	DESCRIPTION
△		
△		
△		

DRAWN BY: MJJ	SHEET
DESIGNED BY: MJJ	21
CHECKED BY: XXX	
APPROVED BY: XXX	
PROJECT NUMBER: D20010479	

OF 38 SHEETS

ISSUED FOR REVIEW ISSUED FOR BIDDING
 ISSUED FOR CONSTR. RECORD DRAWING