

F.A.I. RTE.	SECTION	COUNTY	TOTAL SHEETS	SHEET NO
57	77-03, 4-1, 4-2RS-2	PULASKI	52	33
STA.	TO STA.			
FED. ROAD DIST. NO.	ILLINOIS	FED. AID PROJECT		
		CONTRACT NO. 98829		

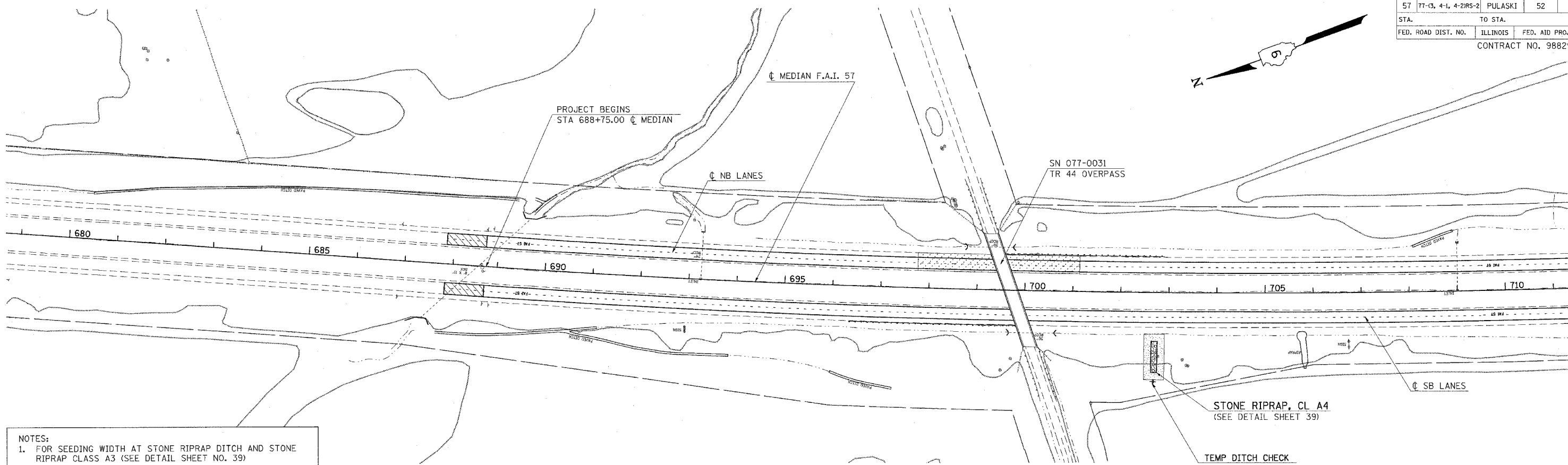

NOTES:  
 1. FOR SEEDING WIDTH AT STONE RIPRAP DITCH AND STONE RIPRAP CLASS A3 (SEE DETAIL SHEET NO. 39)  
 2. A QUANTITY OF TEMPORARY EROSION CONTROL SEEDING HAS BEEN INCLUDED AND SHALL BE APPLIED AS PER ARTICLE 280 OF THE STANDARD SPECIFICATIONS.

LEGEND

	SEEDING, CLASS 2 (MODIFIED); SEEDING, CLASS 7; MULCH METHOD 2
	EROSION CONTROL BLANKET

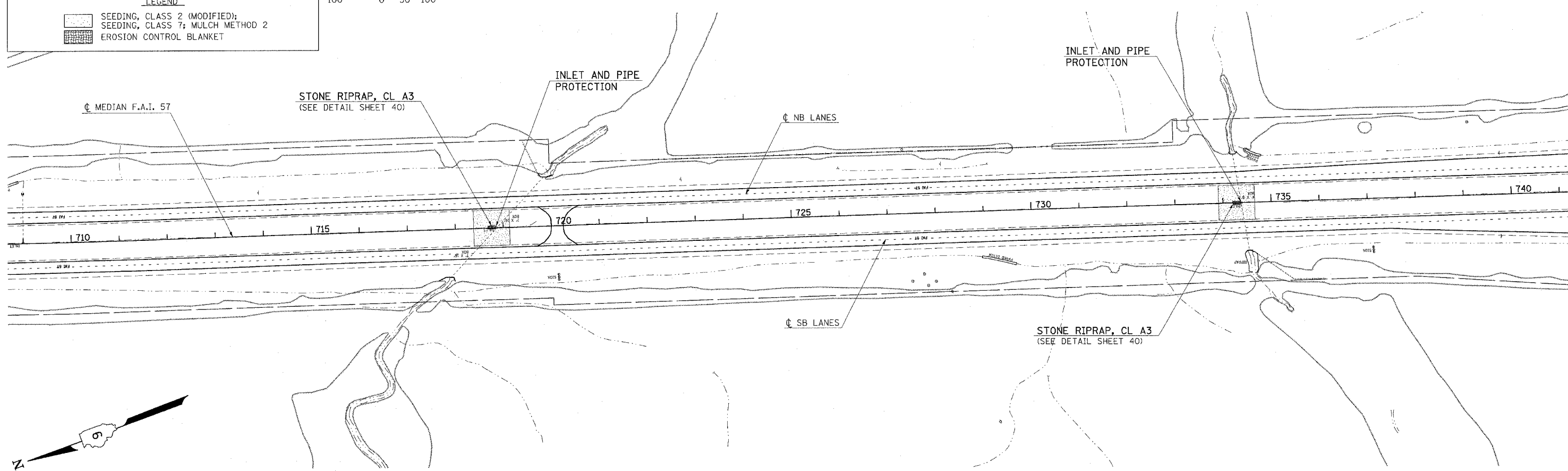
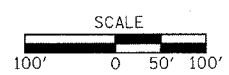

PLOT DATE = 3/21/2007  
 FILE NAME = c:\p\projects\98829\98829.dwg  
 PLOT SCALE = 1/8" = 100'  
 USER NAME = bhonahy

**EROSION CONTROL PLAN STA 680+00 TO 740+00**