

F.A.I. RTE.	SECTION	COUNTY	TOTAL SHEETS	SHEET NO.
57/64	(41-3)HBK	JEFFERSON	518	086
STA.	TO STA.			
FED. ROAD DIST. NO.	ILLINOIS	FED. AID PROJECT		

PROPOSED RAMP 'C' CURVE DATA

PROP. CURVE RAMPC-1  
 PI STA. = 504+92.65  
 $\Delta$  = 29° 08' 19" (LT)  
 D = 12° 19' 18"  
 R = 465.00'  
 T = 120.86'  
 L = 236.48'  
 E = 15.45'  
 e = 8.0%  
 S.E. RUN = 220  
 ATTAIN STA 502+25.12 TO STA 504+45.12  
 REMOVE STA 505+34.95 TO STA 507+54.95  
 P.C. STA. = 503+71.79  
 P.T. STA. = 506+08.28

PROP. CURVE RAMPC-2  
 PI STA. = 514+86.36  
 $\Delta$  = 26° 27' 14" (RT)  
 D = 7° 32' 20"  
 R = 760.00'  
 T = 178.63'  
 L = 350.90'  
 E = 20.71'  
 e = 8.0%  
 S.E. RUN = 260'  
 ATTAIN STA 511+34.40 TO STA 513+94.40  
 REMOVE SEE HIGHWAY STANDARD 406001-02  
 P.C. STA. = 513+07.73  
 P.T. STA. = 516+58.63

PROPOSED RAMP 'D' CURVE DATA

PROP. CURVE RAMPD-1  
 PI STA. = 605+56.69  
 $\Delta$  = 15° 16' 10" (RT)  
 D = 7° 32' 20"  
 R = 760.00'  
 T = 101.87'  
 L = 202.54'  
 E = 6.80'  
 e = 8.0%  
 S.E. RUN = 260  
 ATTAIN SEE HIGHWAY STANDARD 406101-02  
 REMOVE STA 605+70.69 TO STA 608+30.69  
 P.C. STA. = 604+54.82  
 P.T. STA. = 606+57.36

STA 44+02.08  $\oslash$  VETERANS MEM DR  
 STA 500+00.00  $\oslash$  PROPOSED RAMP 'C'

COORDINATES FOR RAMP 'C'

DESCRIPTION	COORDINATES	
	NORTHING	EASTING
POT STA 500+00.00	595,226.7782	807,745.6264
PC STA 503+71.19	594,870.7546	807,852.7620
PT STA 506+08.28	594,670.8961	807,974.3596
PC STA 513+07.73	594,184.0189	808,476.5403
PT STA 516+58.63	593,891.2167	808,664.2237
POT STA 528+08.82	592,806.5481	809,046.8868

COORDINATES FOR RAMP 'D'

DESCRIPTION	COORDINATES	
	NORTHING	EASTING
POT STA 600+00.00	596,991.9918	807,652.1757
PC STA 604+54.82	596,551.2380	807,764.4135
PT STA 606+57.36	596,350.6542	807,787.8062
POT STA 617+80.70	595,227.4772	807,768.5388

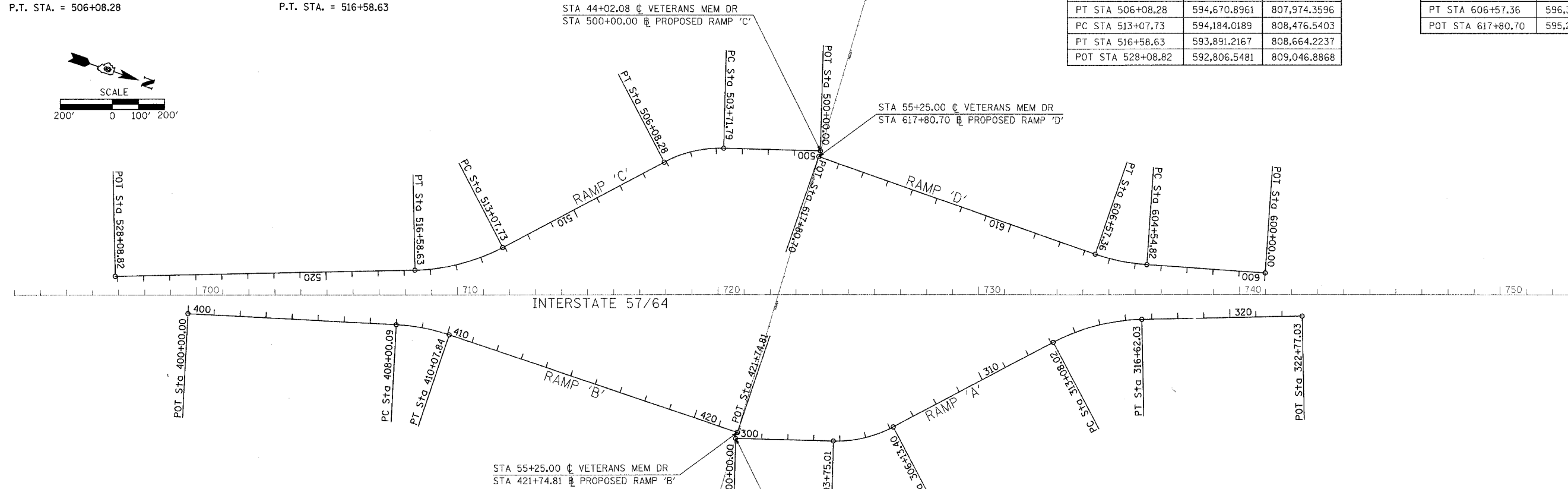
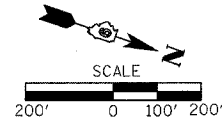

PROPOSED RAMP 'B' CURVE DATA

PROP. CURVE RAMPB-1  
 PI STA. = 409+04.61  
 $\Delta$  = 15° 39' 45" (RT)  
 D = 7° 32' 20"  
 R = 760.00'  
 T = 104.53'  
 L = 207.75'  
 E = 7.15'  
 e = 8.0%  
 S.E. RUN = 260'  
 ATTAIN SEE HIGHWAY STANDARD 406101-02  
 REMOVE STA 409+21.17 TO STA 411+81.17  
 P.C. STA. = 408+00.09  
 P.T. STA. = 410+07.84

STA 55+25.00  $\oslash$  VETERANS MEM DR  
 STA 421+74.81  $\oslash$  PROPOSED RAMP 'B'

COORDINATES FOR RAMP 'B'

DESCRIPTION	COORDINATES	
	NORTHING	EASTING
POT STA 400+00.00	593,116.7095	809,096.0496
PC STA 408+00.09	593,888.6977	808,885.8784
PT STA 410+07.84	594,094.0811	806,859.2100
POT STA 421+74.81	595,261.0222	808,868.0272

COORDINATES FOR RAMP 'A'

DESCRIPTION	COORDINATES	
	NORTHING	EASTING
POT STA 300+00.00	595,261.7427	808,891.6453
PC STA 303+75.01	595,620.8441	808,783.5850
PT STA 306+13.40	595,822.0280	808,660.6160
PC STA 313+08.02	596,303.4935	808,159.9276
PT STA 316+62.03	596,598.4592	807,970.0037
POT STA 322+77.03	597,178.4252	807,765.3959

PROPOSED RAMP 'A' CURVE DATA

PROP. CURVE RAMPA-1  
 PI STA. = 304+96.88  
 $\Delta$  = 29° 22' 25" (LT)  
 D = 12° 19' 18"  
 R = 465.00'  
 T = 121.88'  
 L = 238.39'  
 E = 15.71'  
 e = 8.0%  
 S.E. RUN = 220'  
 ATTAIN STA 302+28.34 TO STA 304+48.34  
 REMOVE STA 305+40.07 TO STA 307+60.07  
 P.C. STA. = 303+75.01  
 P.T. STA. = 306+13.40

PROP. CURVE RAMPA-2  
 PI STA. = 314+88.30  
 $\Delta$  = 26° 41' 20" (RT)  
 D = 7° 32' 20"  
 R = 760.00'  
 T = 180.28'  
 L = 354.01'  
 E = 21.09'  
 e = 8.0%  
 S.E. RUN = 260'  
 ATTAIN STA. 312+18.35 TO STA 314+78.35  
 REMOVE SEE HIGHWAY STANDARD 406001-03  
 P.C. STA. = 313+08.02  
 P.T. = 316+62.03

VETERANS MEMORIAL DRIVE

PLOT DATE = 08/21/2007 07:54 AM  
 FILE NAME = I:\98\981982\2019\A\1\DOT RAMPS\UPR050605.mxd  
 PLOT SCALE = 200.00000 / IN.  
 USER NAME = Kae