

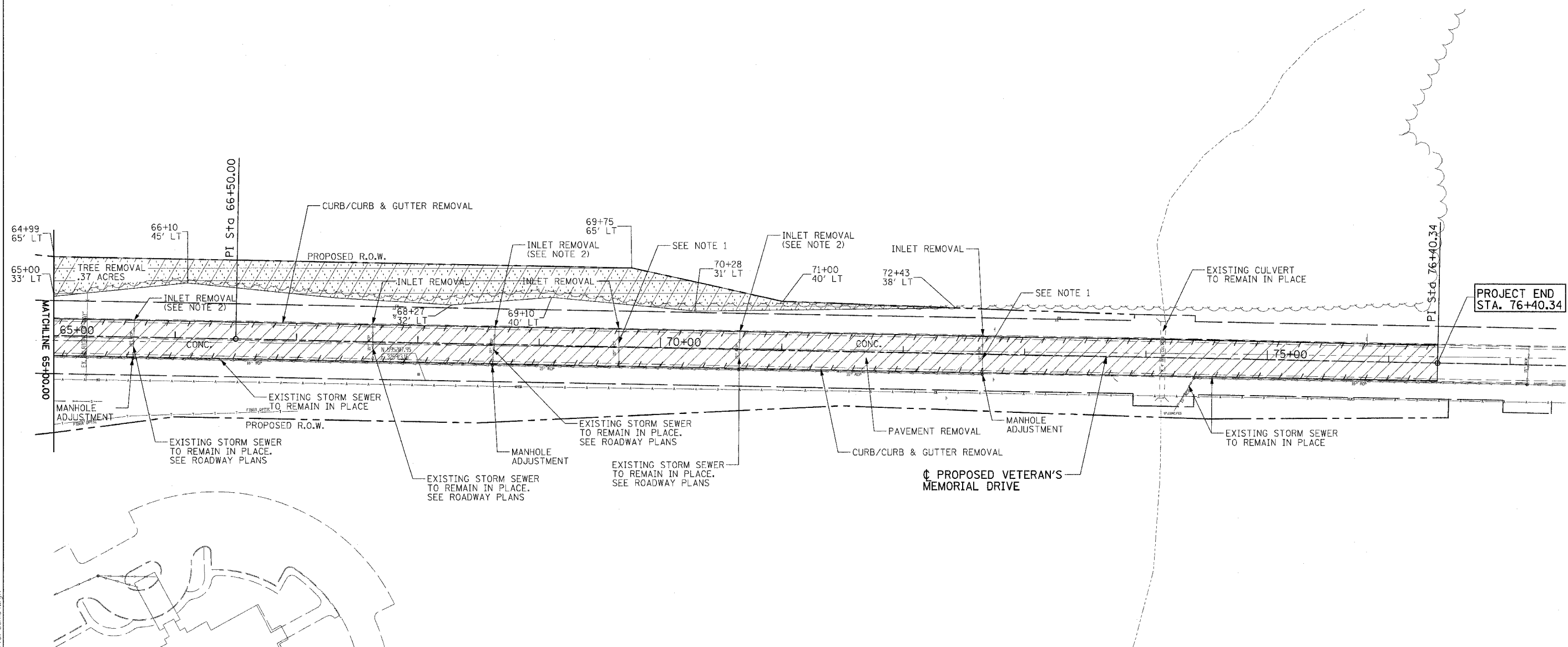

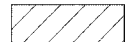

F.A.I. RTE.	SECTION	COUNTY	TOTAL SHEETS	SHEET NO.
57/64	(41-3)HBK	JEFFERSON	518	141
STA.	TO STA.			
FED. ROAD DIST. NO.	ILLINOIS FED. AID PROJECT			
CONTRACT NO. 98963				

© Copyright Hanson Professional Services Inc. 2687
HANSON
 Hanson Professional Services Inc.

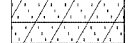

LEGEND

-  PAVEMENT REMOVAL
-  EXIST. CONC. PAVEMENT TO BE BROKEN AND REMAIN IN PLACE (COST INCLUDED WITH PAVEMENT REMOVAL)
-  CURB & GUTTER REMOVAL
-  TREE REMOVAL, ACRES
-  TREE REMOVAL UNIT DIAMETER

NOTE 1: ABANDON STORM SEWER PIPE IN-PLACE. SEE SPECIAL PROVISIONS.
 2. EXISTING STRUCTURES TO BE REMOVED. EXISTING PIPE TO BE REMOVED TO NEAREST BELL TO ALLOW CONNECTION OF NEW PIPE.

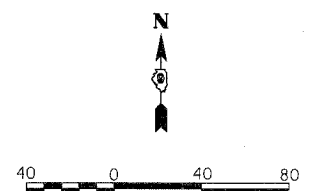

LAYOUT	RLT	02/26/04
DRAWN	JED	06/12/04
REVIEWED	MTM	03/22/07

03-22-2007 03:05 PM
 J:\98\jobs\98s2019a\Road\Sheet\c-01-demol.dwg

REVISIONS	
NAME	DATE

ILLINOIS DEPARTMENT OF TRANSPORTATION
DEMOLITION PLAN
 STA. 65+00.00 TO STA. 76+40.34
VETERANS MEMORIAL DRIVE INTERCHANGE
 SECTION (41-3)HBK
 SCALE: 1"=40'
 DATE 3-22-07
 DRAWN BY RLT
 CHECKED BY MTM