



F.A.I. RTE.	SECTION	COUNTY	TOTAL SHEETS	SHEET NO.
57/64	(41-3)HBK	JEFFERSON	518	168
STA.		TO STA.		
FED. ROAD DIST. NO.		ILLINOIS FED. AID PROJECT		

LEGEND

-  DRUM WITH STEADY BURNING LIGHT
-  VERTICAL PANEL

G20-I103(O)-3660
END WORK ZONE
SPEED LIMIT

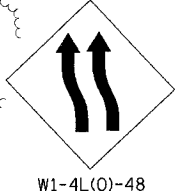
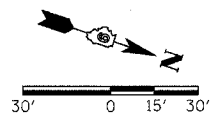
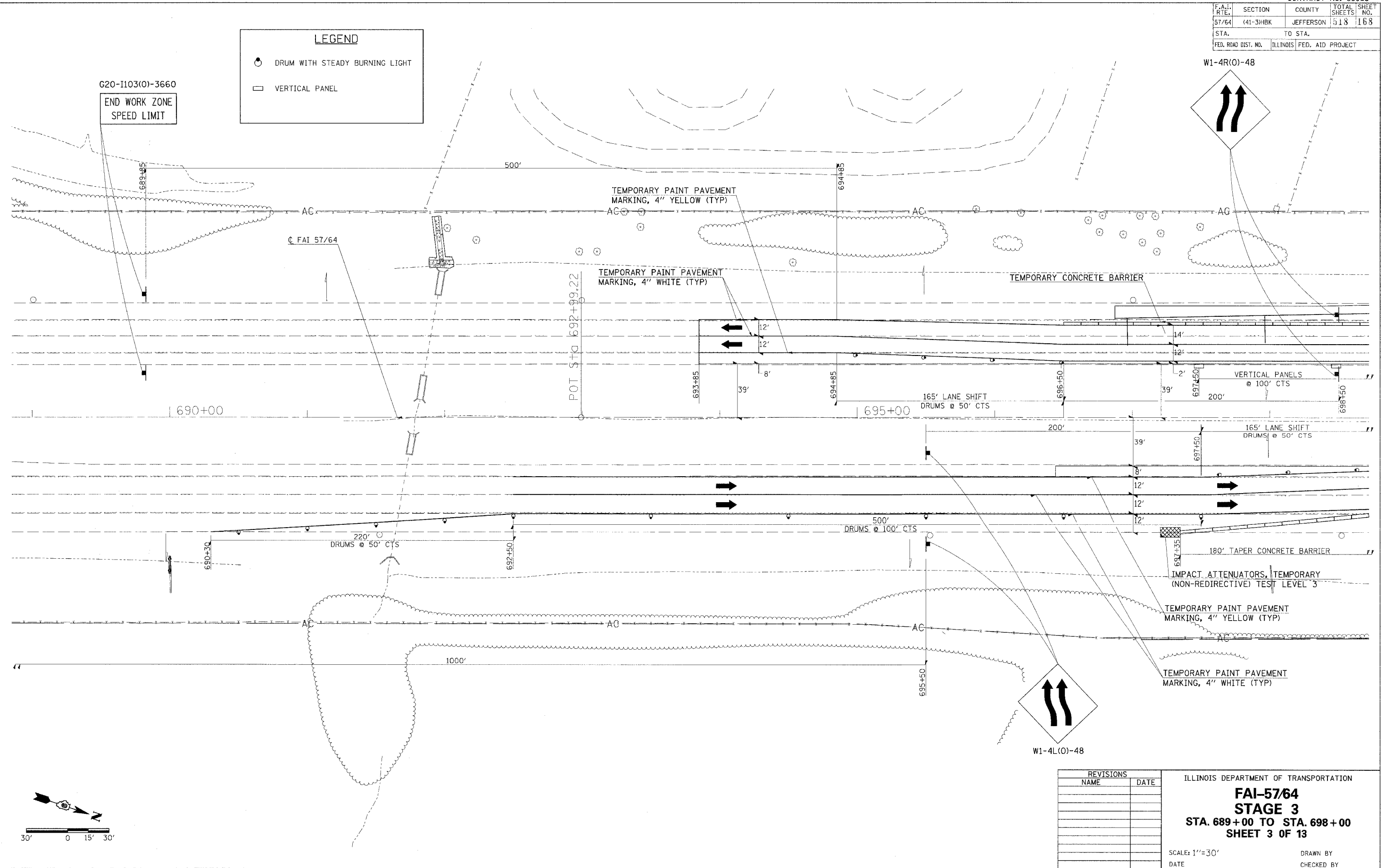
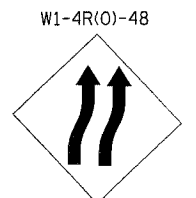

REVISIONS	
NAME	DATE

ILLINOIS DEPARTMENT OF TRANSPORTATION
FAI-57/64
STAGE 3
STA. 689+00 TO STA. 698+00
SHEET 3 OF 13

SCALE: 1"=30'
DATE _____ DRAWN BY _____
CHECKED BY _____

8/3/22 2:00 PM
 D:\98963\5764\5764.DWG
 8/3/22 2:00 PM
 RLT