

F.A.I. RTE.	SECTION	COUNTY	TOTAL SHEETS	SHEET NO.
57/64	(41-3)HBK	JEFFERSON	518	173
STA.	TO STA.			
FED. ROAD DIST. NO.	ILLINOIS FED. AID PROJECT			

**LEGEND**

- ☉ DRUM WITH STEADY BURNING LIGHT
- VERTICAL PANEL

R2-1-4860  
G20-I102(O)-48

**SPEED LIMIT**  
**55**  
**WORK ZONE**

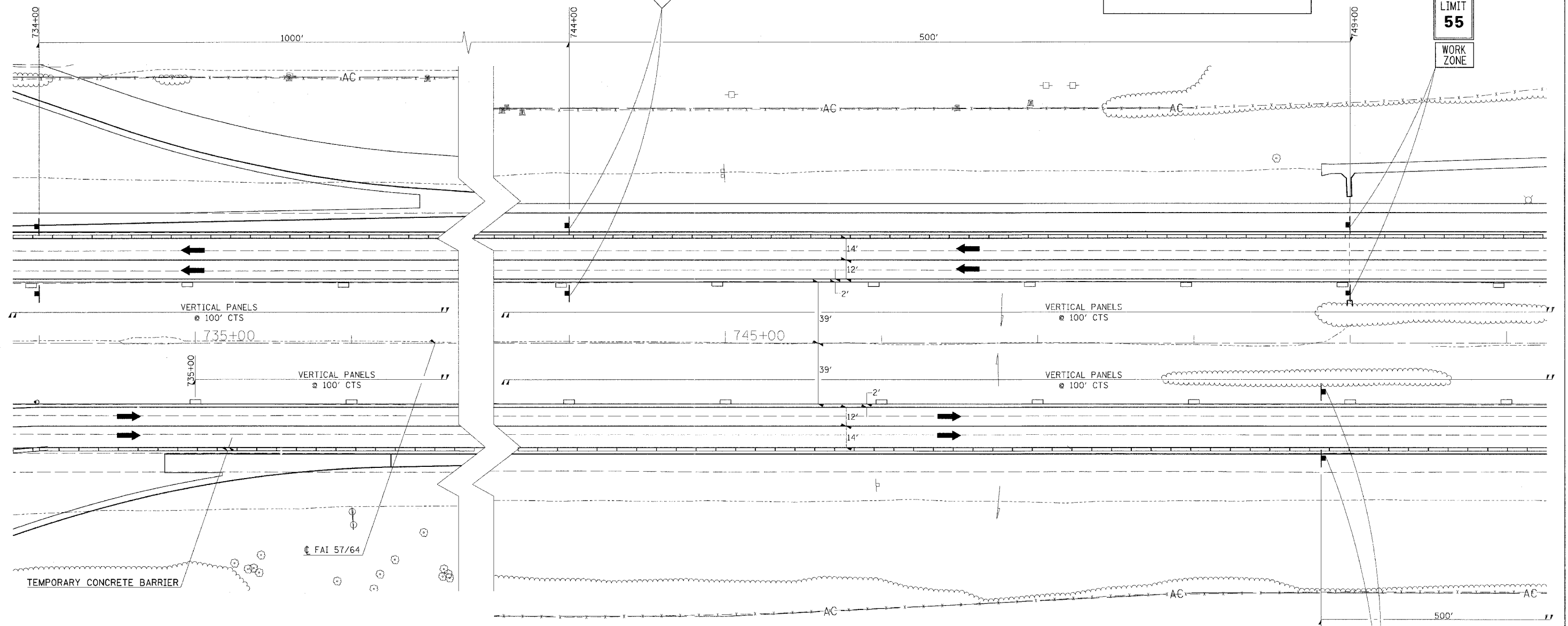
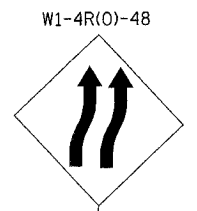

**EXIT OPEN AHEAD**  
D4-I102(G)

REVISIONS	
NAME	DATE

ILLINOIS DEPARTMENT OF TRANSPORTATION  
**FAI-57/64**  
**STAGE 3**  
**STA. 734+00 TO STA. 750+00**  
**SHEET 8 OF 13**  
 SCALE: 1"=30'  
 DATE \_\_\_\_\_ DRAWN BY \_\_\_\_\_  
 CHECKED BY \_\_\_\_\_

03/21/2007 8:52:55 PM  
 C:\WORK\2007\FAI\DD1\FAI57\revs\stage3.dwg  
 3/21/2007 8:52:55 AM  
 RLJ