

F.A.I. RTE.	SECTION	COUNTY	TOTAL SHEETS	SHEET NO.
57/64	(41-3)HBK	JEFFERSON	318	213
STA.		TO STA.		
FED. ROAD DIST. NO.		ILLINOIS FED. AID PROJECT		
CONTRACT NO. 98963				

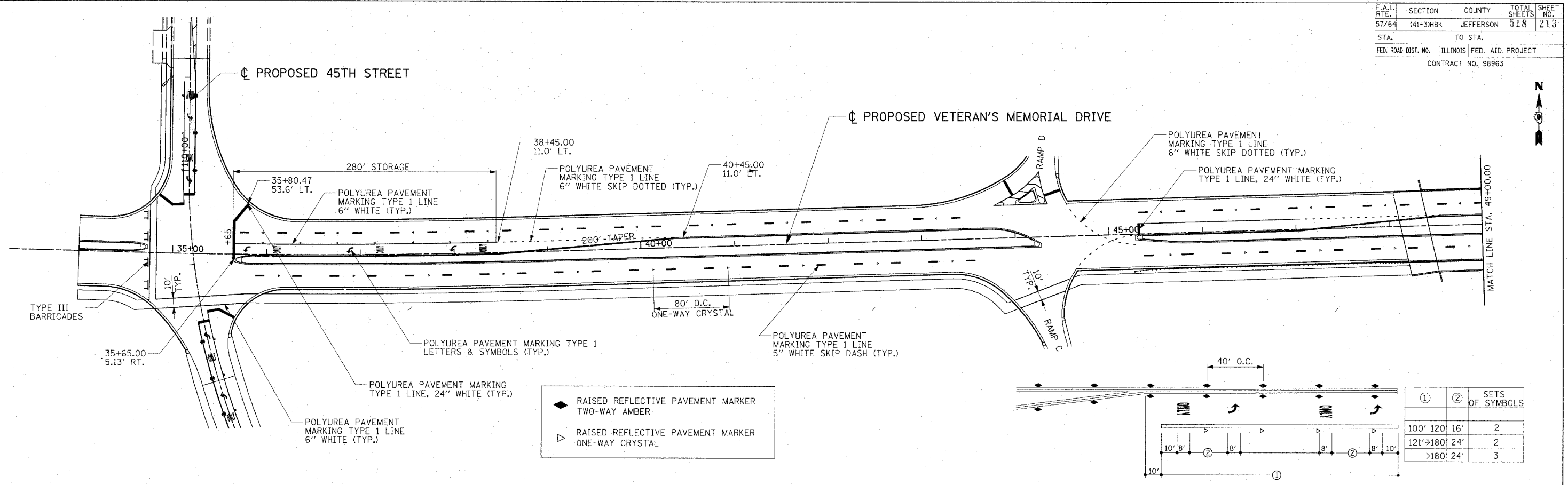

- ◆ RAISED REFLECTIVE PAVEMENT MARKER TWO-WAY AMBER
- ▷ RAISED REFLECTIVE PAVEMENT MARKER ONE-WAY CRYSTAL

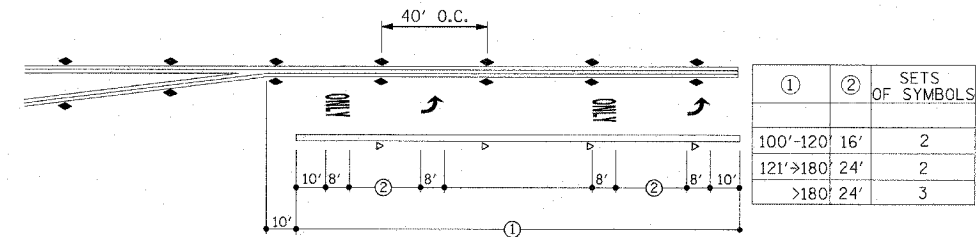

NOTE:
TRAFFIC SIGNS INCLUDING STOP, SPEED LIMIT AND ANY OTHER REGULATORY SIGNS WILL BE FURNISHED AND INSTALLED BY THE CITY OF MT. VERNON.

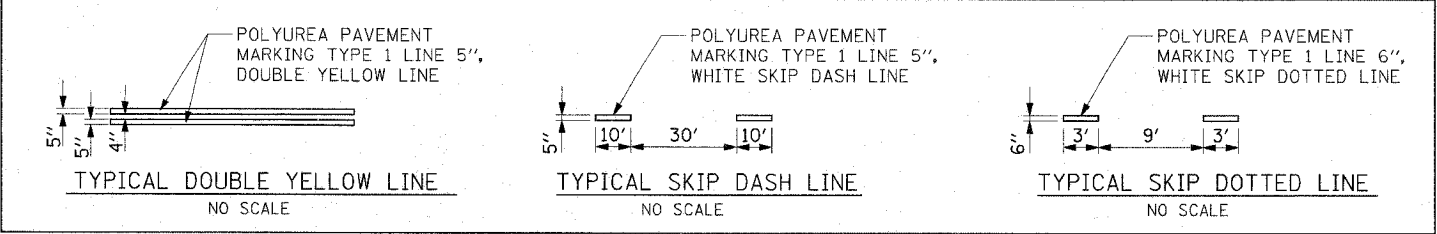
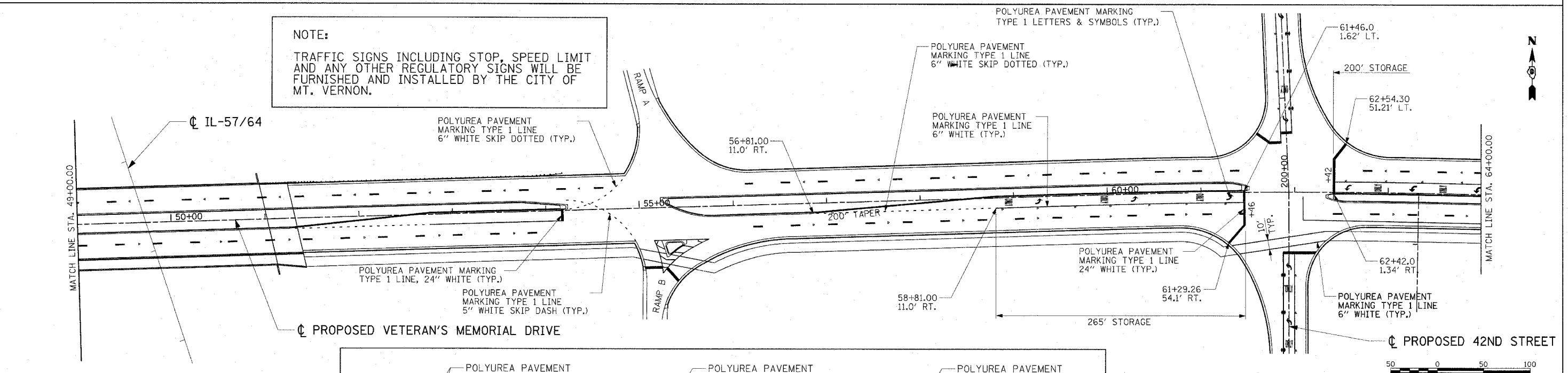

REVISIONS	
NAME	DATE

ILLINOIS DEPARTMENT OF TRANSPORTATION
PAVEMENT MARKING PLAN
 STA. 34+00.00 TO 64+00.00
VETERANS MEMORIAL DRIVE INTERCHANGE
 SECTION (41-3)HBK
 SCALE: 1"=50'
 DATE 3-22-07
 DRAWN BY RL
 CHECKED BY MTM

03/22/2007 11:36 AM
 I:\987\98963\98963\Road\Sheet\41-3\PM.dwg
 LAYOUT RL 02/26/04
 DRAWN JED 04/22/04
 REVIEWED MTM 03/22/07
 Copyright Hanson Professional Services Inc. 2007
HANSON
 Hanson Professional Services Inc.